

1964

1964 Southern Illinois University Bulletin Edwardsville Campus (Schedule of Classes for the Winter and Spring Quarters)

Southern Illinois University Carbondale

Follow this and additional works at: http://opensiuc.lib.siu.edu/ua_bcc

Recommended Citation

, . "1964 Southern Illinois University Bulletin Edwardsville Campus (Schedule of Classes for the Winter and Spring Quarters)." (Jan 1964).

This Article is brought to you for free and open access by the University Archives at OpenSIUC. It has been accepted for inclusion in SIU Bulletins and Course Catalogs by an authorized administrator of OpenSIUC. For more information, please contact opensiuc@lib.siu.edu.

Southern Illinois University

Bulletin

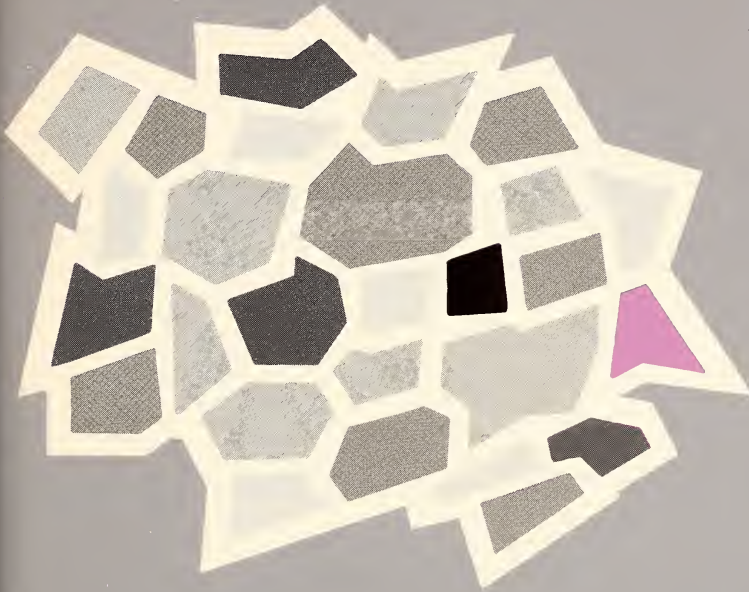

Schedule of Classes Winter-Spring

EDWARDSVILLE CAMPUS 1964

Schedule of Classes
Winter and Spring Quarters, 1964
Edwardsville Campus



SOUTHERN ILLINOIS UNIVERSITY BULLETIN
Volume 5 Number 8 September, 1963
Second-class postage paid at Carbondale, Illinois. Pub-
lished by Southern Illinois University, monthly, except
June and July.

The following issues of the *Southern Illinois University Bulletin* may be obtained without charge from Central Publications, Southern Illinois University, Carbondale, Illinois.

General Information
Summer Session (Carbondale)
Summer Session (Edwardsville)
Schedule of Classes (Carbondale)
Schedule of Classes (Edwardsville)
Divisional Announcements (Edwardsville)
Graduate School
College of Education
College of Liberal Arts and Sciences
School of Agriculture
School of Business
School of Communications
School of Fine Arts
School of Home Economics
Division of Technical and Adult Education

All intending students should have the General Information bulletin (issued once a year), plus the special bulletins of the various educational units in which they are most interested.

Board of Trustees

	TERM EXPIRES
JOHN PAGE WHAM, <i>Chairman</i> , Centralia	1965
KENNETH L. DAVIS, <i>Vice-Chairman</i> , Harrisburg	1969
MELVIN C. LOCKARD, <i>Secretary</i> , Mattoon	1965
MARTIN VAN BROWN, Carbondale	1967
HAROLD R. FISCHER, Granite City	1969
ARNOLD H. MAREMONT, Winnetka	1967
LINDELL W. STURGIS, Metropolis	1965
RAY PAGE (<i>Ex-officio</i>), Springfield	
LOUISE MOREHOUSE, <i>Recorder</i>	

Officers of Instruction

DELYTE W. MORRIS, *President*
CHARLES D. TENNEY, *Vice-President for Instruction*

EDWARDSVILLE CAMPUS

CLARENCE W. STEPHENS, *Vice-President for Operations*
WILLIAM T. GOING, *Dean of Instruction*
JOHN H. SCHNABEL, *Registrar and Director of Admissions*

Business Division, JOHN J. GLYNN, *Head*
Education Division, CAMERON W. MEREDITH, *Head*
Fine Arts Division, ANDREW J. KOCHMAN, *Head*
Humanities Division, JAMES C. AUSTIN, *Acting Head*
Science and Technology Division, KERMIT G. CLEMANS, *Head*
Social Sciences Division, ROBERT F. ERICKSON, *Head*

This Bulletin

contains the schedule of classes to be offered on the Edwardsville Campus for the winter and spring quarters of the 1963-64 school year. It also provides information relative to advisement and registration. It does not cover all questions concerning Southern Illinois University. For additional information about the Edwardsville Campus the prospective student should refer to the General Information bulletin and Divisional Announcements (Edwardsville).

Table of Contents

Registration Calendar, Winter Quarter, 1964	vi
Registration Calendar, Spring Quarter, 1964	vii
University Calendar, 1963-1964	viii
Calendar of Events, 1963-1964	ix
Final Examination Schedules	x
GENERAL INFORMATION	1
Admission	1
Required Tests	1
Advisement	2
Change of Field of Concentration	3
Registration	3
Social Security Identification Number	3
Fees	3
Auditing of Courses	4
Program Changes	5
Withdrawal from School	5
Cancellation of Registration	6
Academic Load	6
Personal Data Changes	6
Veterans' Information	7
Sign-Up Periods	7
Maps of Alton Center and East St. Louis Center	8
SCHEDULE OF CLASSES	10
Listing of Courses	10
Course Number and Hours	11
Prerequisites	11
Section Number, Time, and Days	11
Free Bus Transportation	12
Explanation of Entries	12
Winter Schedule	12
Spring Schedule	39

Registration Calendar

Winter Quarter, 1964

October 21– November 29	Monday through Friday, 8:30 to 11:30 A.M., 1:30 to 4:00 P.M. Advance registration period for students enrolled in the 1963 fall quarter and for new and re-entry students who have cleared their admission status. Students in school during fall quarter who do not advance register must wait until Friday, January 3, 1964, and be assessed a \$3 late registration fee.
November 11–15	Evening and graduate students may register 5:00 to 7:00 P.M.
November 15	Students will receive fee statements by mail if registered by this date.
November 18–29	Students must pay fees at time of registration if registering between these dates.
December 6	Students will have their advance registration cancelled if fees are not paid at the Bursar's Office by 4:00 P.M. on this date. Cancelled students must wait until Friday, January 3, 1964, to register again and will be assessed a \$3 late registration fee.
January 2	Winter quarter begins. Last day of regular registration period. <i>Only new and re-entering students</i> will be advised and registered. Students registering at Alton will report to the auditorium building to pick up authorization-to-register permits. Students registering at East St. Louis will report to the west (9th Street) door of the main building for authorization-to-register permits.
January 3	Classes begin 8:00 A.M.
January 7	Program Change Day: 9:00 A.M. to 12:00 NOON, 1:00 to 4:00 P.M., 5:00 to 7:00 P.M. All program changes must be completed this day. Only class drops will be accepted after this date.
January 14	Last day to withdraw from school to be eligible for a refund of fees.
January 16	Last day for refund applications to be submitted to the Registrar's Office for refund of fees for winter quarter.
January 29	Last day to withdraw from a course without receiving a letter grade.
March 1	Last day to drop a class or withdraw from school except under exceptional conditions.

Registration Calendar

Spring Quarter, 1964

January 20– February 28	Monday through Friday, 8:30 to 11:30 A.M., 1:30 to 4:00 P.M. Advance registration period for students enrolled in the 1964 winter quarter and for new and re-entry students who have cleared their admission status. Students in school during winter quarter who do not advance register must wait until Thursday, March 26, 1964, and be assessed a \$3 late registration fee.
February 17–21	Evening and graduate students may register 5:00 to 7:00 P.M.
February 21	Students will receive fee statements by mail if registered by this date.
February 24–28	Students must pay fees at time of registration if registering between these dates.
March 6	Students will have their advance registration cancelled if fees are not paid at the Bursar's Office by 4:00 P.M. on this date. Cancelled students must wait until Thursday, March 26, 1964, to register again and will be assessed a \$3 late registration fee.
March 25	Spring quarter begins. Last day of regular registration period. <i>Only new and re-entering</i> students will be advised and registered. Students registering at Alton will report to the auditorium building to pick up authorization-to-register permits. Students registering at East St. Louis will report to the west (9th Street) door of the main building for authorization-to-register permits.
March 26	Classes begin 8:00 A.M.
March 31	Program Change Day: 9:00 A.M. to 12:00 NOON, 1:00 to 4:00 P.M., 5:00 to 7:00 P.M. All program changes must be completed this day. Only class drops will be accepted after this date.
April 9	Last day to withdraw from school to be eligible for a refund of fees.
April 10	Last day for applications to be submitted to the Registrar's Office for refund of fees.
April 23	Last day to withdraw from a course without receiving a letter grade.
May 29	Last day to drop a class or withdraw from school except under exceptional conditions.

University Calendar, 1963-1964

Revised January 1963

1963 SUMMER SESSION

Session Begins	Monday, June 17
Independence Day Holiday	Thursday, July 4
Final Examinations (8-week Session)	Wednesday-Thursday, August 7-8
Summer Commencements	Friday, August 9
Final Examinations (Summer Quarter)	Monday-Saturday, August 26-31

1963 FALL QUARTER

New Student Week	Sunday-Tuesday, September 22-24
Quarter Begins	Wednesday, September 25
Thanksgiving Vacation	Wednesday, 12 noon-Monday, 8 A.M. November 27-December 2
Final Examinations	Wednesday-Tuesday, December 11-17

1964 WINTER QUARTER

Quarter Begins	Thursday, January 2
Final Examinations	Wednesday-Tuesday, March 11-17

1964 SPRING QUARTER

Quarter Begins	Wednesday, March 25
Memorial Day Holiday	Saturday, May 30
Final Examinations	Thursday-Wednesday, June 4-10
Commencement (Edwardsville)	Thursday, June 11
Commencement (Carbondale)	Friday, June 12

Summer classes begin on Tuesday, June 18. During the fall, winter, and spring quarters, day classes begin on the second day of the quarter.

Calendar of Events, 1963-1964

DECEMBER 1963

20 Friday New Student Orientation.

JANUARY 1964

30 Thursday Southern Illinois University Scholarship and Activity Award applications for spring quarter due.

FEBRUARY 1964

13 Thursday National Defense Loan applications for spring quarter due.

15 Saturday American College Test, 8:00 A.M., Alton, Student Union Building, and East St. Louis, Room 113.

MARCH 1964

20 Friday New Student Orientation.

21 Saturday Graduate Admissions Examination (Objective Test) 8:30 A.M. East St. Louis.

APRIL 1964

22 Wednesday Southern Illinois University Scholarship and Activity Award applications for summer quarter due.

25 Saturday American College Test, 8:00 A.M., Alton Student Union Building, and East St. Louis, Room 113.

MAY 1964

4 Monday Southern Illinois University Scholarship and Activity Award applications for 1964 fall quarter due.

6 Wednesday National Defense Loan applications for summer quarter due.

JUNE 1964

19 Friday Graduate Admissions Examination (Objective Test) 6:00 P.M., Alton.

20 Saturday American College Test, 8:00 A.M., Alton, Student Union Building, and East St. Louis, Room 113.

Final Examination Schedules

Examinations for one- and two-credit-hour courses will be held during the last regularly scheduled class period prior to the formal final examination period. Three-, four-, and five-credit-hour courses will meet at the times listed below.

Classes meeting after 4:20 p.m. will meet through examination week (through March 17 or June 10) with final examination held during the last scheduled meeting.

A student who finds he has more than three examinations on one day may petition, and a student who has two examinations scheduled at one time should petition, the registrar for approval to take an examination during the make-up examination period on the last day. Provision for such a make-up examination period does not mean that a student may decide to miss his scheduled examination time and expect to make it up during this make-up period. This period is to be used only for a student whose petition has been approved.

A student who must miss a final examination may not take an examination before the time scheduled for the class examination.

Unless permission is granted by the Dean of Instruction, no change may be made in the examination schedules.

Winter: Wednesday, March 11, 1964. Spring: Thursday, June 4, 1964.

8:00 A.M. Classes that meet at 8:00 A.M.

10:10 A.M. GSD 153, day sections

1:00 P.M. Classes that meet at 1:00 P.M.

4:00 P.M. Classes that meet at 4:00 P.M.

Winter: Thursday, March 12, 1964. Spring: Friday, June 5, 1964.

8:00 A.M. Day sections of GSD 152 (winter) or GSC 151 (spring)

1:00 P.M. Classes that meet at 2:00 P.M.

Winter: Friday, March 13, 1964. Spring: Monday, June 8, 1964.

8:00 A.M. Classes that meet at 9:00 A.M.

10:10 A.M. GSC 152, day sections

12:50 P.M. Classes that meet at 12:00 NOON

3:00 P.M. Classes that meet at 3:00 P.M.

Winter: Saturday, March 14, 1964. Spring: Saturday, June 6, 1964.

8:00 A.M. Day sections of GSB 152 (winter) or GSB 153 (spring)

10:10 A.M. Saturday only classes

Winter: Monday, March 16, 1964. Spring: Tuesday, June 9, 1964.

8:00 A.M. Classes that meet at 10:00 A.M.

1:00 P.M. Classes that meet at 11:00 A.M.

Winter: Tuesday, March 17, 1964. Spring: Wednesday, June 10, 1964.

8:00 A.M. Make-up examination period for day classes

6:30 P.M. Make-up examination period for evening classes

General Information

THIS BULLETIN contains the schedule of classes to be offered at the Alton and East St. Louis centers of the Edwardsville Campus for the winter and spring quarters of the 1963-64 school year. It also provides the student with information relative to advisement and registration, fees, various calendars of events, and allied information.

Classes offered during the summer and fall on the Edwardsville Campus will appear in separate bulletins. Class schedule information for the Carbondale Campus may be secured from Central Publications, Southern Illinois University, Carbondale, Illinois.

ADMISSION

A student must be officially admitted to the University before registration in classes will be permitted. *Students who have not completed the admission requirements by the start of the registration period will not be permitted to register.* The student, to be permitted to attend classes at Southern Illinois University, must have completed registration, which includes admission, advisement, sectioning, and payment of fees.

Admission policies for undergraduate students are stated in the General Information issue of the *Southern Illinois University Bulletin*. Admission policies for graduate students appear in the Graduate School issue. Either issue may be obtained from Central Publications.

Inquiries concerning admission to Southern Illinois University should be directed to the Admissions Office at Edwardsville. Applications for admission are accepted any time during the calendar year but should be initiated by December 1, 1963, for the winter quarter and March 1, 1964, for the spring quarter.

REQUIRED TESTS

All entering freshmen must take the American College Testing Program prior to advisement and registration. Illinois residents who ranked

in the lowest third of their graduating class must take the test battery before they can be considered for admission. Out-of-state students who rank in the lower one-half of their graduating classes must take the tests prior to admission. High school students are encouraged to take the American College Testing Program during the spring of their senior year and thus be ready for academic advisement during the summer. A complete set of dates and test centers is available from the Registrar's Office. Students who are not able to take the tests in the spring may make arrangements to be tested on one of the dates listed below.

TESTING DATE	DEADLINE FOR RECEIPT OF REGISTRATION FORM
November 9, 1963.....	October 12, 1963
February 15, 1964.....	January 18, 1964
April 25, 1964	April 4, 1964
June 20, 1964.....	May 31, 1964

Transfer students are expected to take the tests unless they have their scores forwarded from their former school. These scores are not normally sent with one's transcript and should be requested from the appropriate office of the former school before the registration period.

ADVISEMENT

After a student has been admitted to the University, he should talk with an adviser about his educational plans and complete his registration for the quarter he expects to enter Southern.

To insure that an undergraduate student is properly advised concerning the choice of a course of study which will fulfill the requirements of the University and prepare him for his chosen career, academic advisement has been made the special responsibility of a selected group from the teaching faculty. During his first two years he will receive prime advice from a chief academic adviser for his campus and, if he has selected a field of concentration, secondary advice from a representative of that field. Later, after formally declaring his field of concentration, he will receive prime advice from a representative of that field.

Each student must assume responsibility for his progress by keeping an up-to-date record of the courses he has taken and by checking periodically with his adviser and the Registrar's Office. Responsibility for errors in program or in interpretation of regulations of the University rests entirely with the student.

CHANGE OF FIELD OF CONCENTRATION

Every student currently registered in the University will be continued in his present curriculum unless he initiates a change in his field of concentration. He initiates such a change with his adviser, and the registrar's copy of the change form should accompany the student's registration. No change of concentration made after a registration has been processed will be reflected in the student's record until the next registration.

REGISTRATION

At Southern, a program of advance registration is in operation. The period of time from the third through the tenth week of each quarter and from the third through the seventh week of the eight-week summer session is used for advisement and registration for the following quarter. For example, a student who plans to attend during the winter quarter may register between the third and tenth week, inclusive, of the fall quarter. All students are urged to take advantage of the advance registration period. A one-day general registration is also held the first day of each quarter for new and re-entering students.

SOCIAL SECURITY IDENTIFICATION NUMBER

The University will require students to present social security numbers for student identification in the fall of 1964. Students should be prepared to present their social security card bearing the identification number at the time of registration for the 1964 winter and spring quarters. Persons who do not have social security numbers should apply to their local social security offices or to the Social Security Office in the Germania Savings Building, 543 East Broadway, Alton, Illinois, or 435 Missouri Avenue, East St. Louis, Illinois.

FEES

A student who advance registers will receive his fee statement and receipt card by mail and his fees may be paid either by mail or in person by the deadline date specified in the Registration Calendar. Upon payment of fees, the fee statement and receipt card will be stamped by the bursar and returned to the student. This card which serves as the official authorization to attend classes as scheduled must be presented to obtain textbooks and

activity cards and to process program changes. It should be carried at all times. If fees are paid in person, the card will be given to the student at the time of payment. If paid by mail, the card may be picked up at any time thereafter at the Bursar's Office.

A student who does not advance register must pay his fees at the time he registers.

Illinois students taking more than 8 hours will pay the following regular fees:

Tuition	\$42.00
Book rental	5.00
Activity fee	9.50
Student union building fund	5.00
Total	<u>\$61.50</u>

Illinois students taking 8 or fewer hours will pay the following fees:

Tuition	\$21.00
Book rental	2.50
Student union building fund	5.00
Total	<u>\$28.50</u>

The activity fee of \$9.50 is optional for part-time students. Once an option has been made by a student at the time of registration as to whether or not to pay the activity fee, such option is irrevocable.

Out-of-state students will pay an additional \$50 if they take more than 8 hours, or an additional \$25 if they take 8 hours or fewer.

In addition to the above, there are some physical education classes that require a special fee.

Students having special fee status, such as scholarship holders, faculty, and staff, will pay their respective fees according to the particular status.

The University reserves the right to change fees and have the change go into effect whenever the proper authorities so determine.

AUDITING OF COURSES

A student may register for courses in an "audit" status. He receives no letter grade and no credit for such courses. An auditor's registration card must be marked accordingly. He pays the same fees as though he were registering for credit. He is expected to attend regularly and is to determine from the instructor the amount of work expected of him. If an auditing student does not attend regularly, the instructor may determine that the student should not have the audited course placed on his record card main-

tained in the Registrar's Office. A student registering for a course for credit may not later change to an audit status or vice versa except for fully justified reasons. Such a change will ordinarily require the academic dean's approval.

PROGRAM CHANGES

Mere attendance does not constitute registration in a class, nor will attendance in a class for which a student is not registered be a basis for asking that a program change be approved permitting registration in that class. A student is officially registered for only those courses appearing on his registration cards. Any change therefrom can be made only after fees are paid and must be made through an official program change. A student is considered officially registered after he has cleared his payment of fees at the Bursar's Office.

A program change must be made in order to drop or add a course. A student may not drop a course merely by stopping attendance. If a student desires to drop a course during the second, third, or fourth week of a quarter, the change will be approved only when the reasons appear valid. If a student desires to drop a course after the fourth week, the change will be approved only under unusual conditions. In the last three weeks changes will be approved only in extreme emergencies.

A student desiring to make a program change must initiate his request at the Enrollment Center of the Registrar's Office. He is required to present his fee receipt program card and must complete the following procedure. After having been cleared with the Enrollment Center, program changes for which a program change fee is assessed must be presented to the Business Office for payment. The student immediately returns the program change to the Enrollment Center in the Registrar's Office for final processing. *A student has not completed his program change until he presents it to the Enrollment Center in the Registrar's Office.* No change is official until the preceding procedure is complete.

A program change day is listed in the Registration Calendar.

WITHDRAWAL FROM SCHOOL

A student who finds it necessary to withdraw from school while the quarter is in progress must report to the Enrollment Center in the Registrar's Office to initiate official withdrawal action. No withdrawal will be permitted during the last two weeks of a quarter except under exceptional conditions. A refunding of fees is permitted only if a withdrawal is officially completed within the first two weeks of a quarter and if the application for

a refund is received in the Registrar's Office within two weeks following the last regular registration period. See the Registration Calendar for the specific dates concerning withdrawal and refunding of fees.

CANCELLATION OF REGISTRATION

A registration including the payment of tuition and fees may be considered invalid if the student is declared to be ineligible to register due to scholastic reasons. The same situation may exist due to financial or disciplinary reasons if certified to the registrar by the director of the Student Affairs Office.

ACADEMIC LOAD

The normal class load is 16 quarter hours for undergraduate students and 12 quarter hours for graduate students. The maximum load for both is 18 hours. A student with a 4.25 average or above for the preceding quarter may be allowed by the chief academic adviser of the center or by the head of his division to take as many as 21 hours. In no case may a student carry or be credited with more than 21 hours in any quarter. A student on probation may not take more than 14 hours.

A person may not register for more than 8 hours if he is employed full time.

The Selective Service System requires a minimum of 12 hours to qualify for a student deferment.

The National Defense Education Act requires a minimum of 12 hours to qualify for a student loan.

PERSONAL DATA CHANGES

1. A CHANGE IN ADDRESS, whether local, home, or parents', is to be reported by the student to the Registrar's Office as soon as possible after the change occurs. The above addresses for a student are obtained from his initial application for admission. Address changes are not made thereafter unless they are reported by the student.

2. A CHANGE IN NAME is to be reported to the Enrollment Center in the Registrar's Office. A change for marital reasons will be made on the basis of a signed statement. Other changes may require the presenting of legal evidence.

3. A CHANGE IN MARITAL STATUS is to be reported to the Registrar's

Office. A change will be made if it is based upon incorrect coding or punching. Any other change must be accompanied by a signed statement.

4. A CHANGE IN LEGAL RESIDENCE (whether an Illinois or out-of-state resident) is to be requested on the Application to be Declared an Illinois Resident form in the Registrar's Office. Before the request is honored, the registrar must be satisfied that the student has met the regulations governing residency status as established by the Board of Trustees.

VETERAN'S INFORMATION

The Edwardsville Campus is approved for veterans. Veterans eligible to receive benefits under the GI bill should contact the University veterans' adviser during registration periods. Public Law 550 expires in 1965. War orphans should discuss Public Law 634 benefits with the veterans' adviser.

Veterans enrolled under Public Law 550 and war orphans under Public Law 634 are subject to the following regulations regarding academic load required for proportional subsistence for the regular quarter.

TYPE OF ENROLLMENT	NUMBER OF HOURS REQUIRED			
	<i>Undergraduate</i>		<i>Graduate</i>	
	<i>Quarter</i>	<i>8-Week</i>	<i>Quarter</i>	<i>8-Week</i>
Full-time enrollment	14	10	10	7
3/4-time enrollment	10-13	7-9	8-9	6
1/2-time enrollment	7-9	5-6	5-7	4-5
Less than 1/2-time enrollment	6 or less	4 or less	4 or less	3 or less

To be eligible for the benefits of Public Law 550 or Public Law 634, the student must be fully admitted and enrolled as a regular classified student making satisfactory progress in a degree program.

Veterans attending under one of the public laws should note that the Registrar's Office will certify enrollment and attendance to the Veteran's Administration for subsistence purposes only as of the date when fees were cleared at the Bursar's Office.

SIGN-UP PERIODS

Veterans and war orphans eligible for benefits will sign a monthly attendance certification on the last Thursday of each month starting January 30, 1964, at the Registrar's Office in Alton or East St. Louis.

Veterans who fail to sign on the specified date will probably experience delay in receiving the check for that period.

EAST ST. LOUIS CENTER

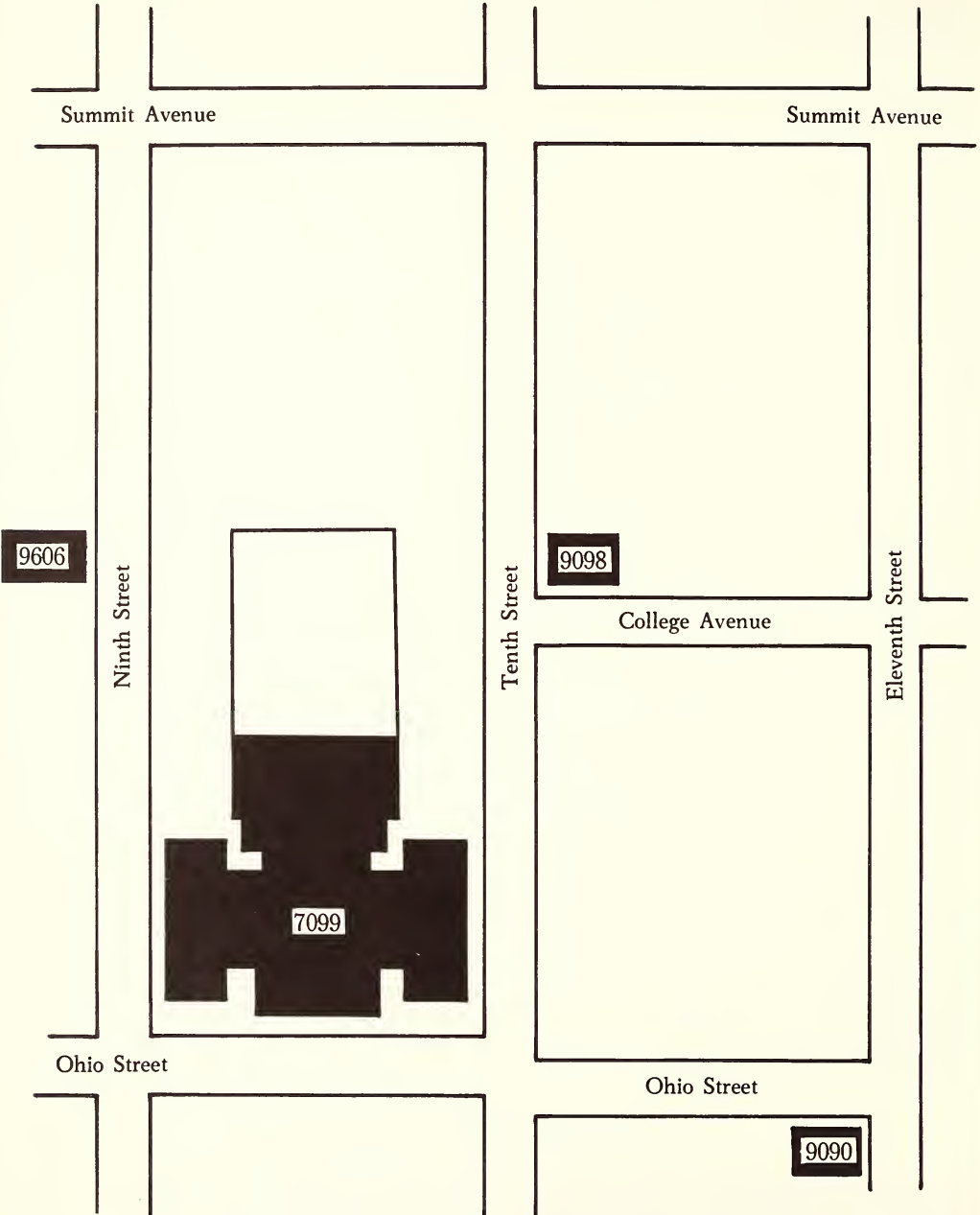

LEGEND: Building 7099: Main Building
Building 9090: Faculty Offices
Building 9096: Faculty Offices
Building 9098: Faculty Offices

ALTON CENTER

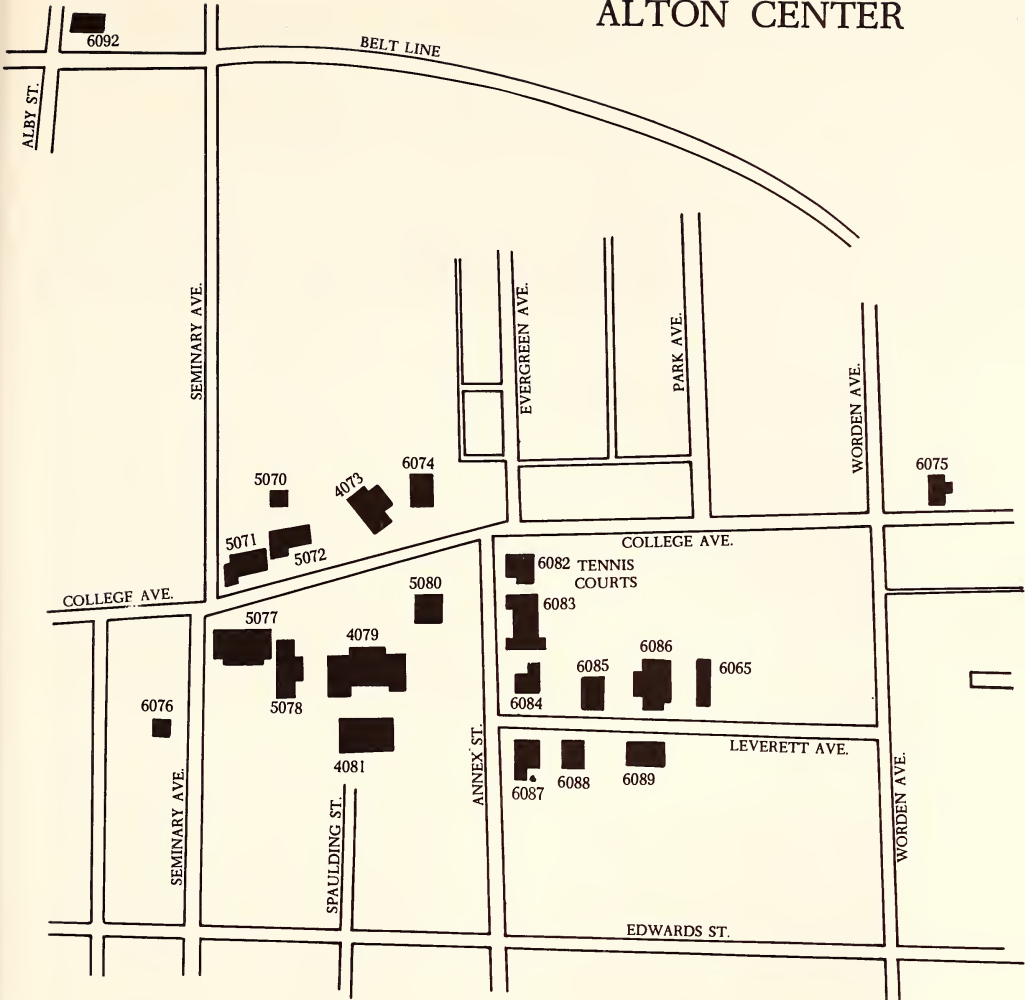

- 4073 Student Union (SU)
Student Affairs
Student Employment and Placement
Health Service
- 4079 Science (SCI)
- 4081 Gymnasium (GYM)
- 5070 Storage
- 5071 Registrar's Office and Business Office
- 5072 University Store
- 5077 Library
- 5078 Fine Arts A (FAA)
- 5080 Auditorium (AUD)
- 6065 Graduate and Advisement Office
- 6074 Fine Arts C (FAC)

- 6075 Education
- 6076 Language Laboratory (LL)
- 6082 Annex B (ANB)
- 6083 Annex A (ANA)
- 6084 Fine Arts B (FAB)
- 6085 Humanities (HUM)
- 6086 Administration
General Office
Division Heads' Office
- 6087 Science and Technology (S & T)
- 6088 Social Sciences (SS)
- 6089 Business Faculty Offices
- 6092 Brick Yard Building (BY)
Madison County Mental Health Clinic

Schedule of Classes

LISTING OF COURSES

The University reserves the right to change or cancel any class.

Courses are listed numerically within each subject-matter area. Areas in which courses are offered in this schedule are listed below in the order of their appearance in the schedule. Beside each area is its code (in parentheses) used for registration purposes. A single letter following the area's code letters indicates one of the six divisions: B indicates the Business Division, E the Education Division, F the Fine Arts Division, H the Humanities Division, T the Science and Technology Division, and S the Social Sciences Division.

SUBJECT AREA	CODE	DIVISION	SUBJECT AREA	CODE	DIVISION
General Studies Area A (GSA)			Health Education	(H Ed)	E
General Studies Area B... (GSB)			History	(Hist)	S
General Studies Area C (GSC)			Humanities	(Hum)	H
General Studies Area D... (GSD)			Instructional Materials (I M)		E
General Studies Area E (GSE)			Journalism	(Jrnl)	H
Accounting	(Acct)	B	Management	(Mgt)	B
Anthropology	(Anth)	S	Marketing	(Mktg)	B
Applied Science	(Ap Sci)	T	Mathematics	(Math)	T
Art	(Art)	F	Music	(Mus)	F
Botany	(Bot)	T	Nursing	(Nurs)	
Chemistry	(Chem)	T	Philosophy	(Phil)	H
Comparative Literature ... (C Lt)		H	Physical Education—		
Economics	(Econ)	B	Men	(PEM)	E
Education		E	Physical Education—		
Administration	(Ed Ad)	E	Women	(PEW)	E
Elementary	(Ed El)	E	Physics	(Phys)	T
Secondary	(Ed Sec)	E	Physiology	(Phsl)	T
Special	(Ed Sp)	E	Psychology	(Psyc)	E
English	(Eng)	H	Radio and Television (R-T)		F
Foreign Languages	(F L)	H	Secretarial and		
French	(Fr)	H	Business Education (Sec)		B
German	(Ger)	H	Sociology	(Soc)	S
Russian	(Russ)	H	Speech	(Spch)	F
Spanish	(Span)	H	Speech Correction	(Sp C)	F
Geography	(Geog)	S	Theater	(Thea)	F
Government	(Gov)	S	Zoology	(Zool)	T
Guidance	(Guid)	E			

COURSE NUMBER AND HOURS

The column containing this information shows the number of the course first, followed by the number of hours of credit. Course numbers are three-digit numbers. In some cases the three digits may be followed by a letter which is also part of the course number. The number appearing after the hyphen denotes the hours of credit for the course. In some cases there may be more than one number following the course number such as 599-2 to 5. This represents a variable-hour course in which the student decides the number of hours for which he is going to register in consultation with his adviser.

The course numbering system is as follows:

- 000-099 Course not properly falling in the following categories
- 100-199 For freshmen
- 200-299 For sophomores
- 300-399 For juniors and seniors
- 400-499 For seniors and graduate students
- 500-600 For graduate students only

PREREQUISITES

For the guidance of students many courses list the courses which need to have been taken before the one under question can be taken. These prerequisites may be listed in a number of different ways. If only a number appears, it refers to a course in the same subject area. If the course is in another subject area, that area will be listed prior to the number. On advanced course levels, registration in a course may require the consent of the instructor.

SECTION NUMBER, TIME, AND DAYS

Alton classes are indicated by section numbers between 1 and 49, East St. Louis between 51 and 99, and Edwardsville above 100.

A letter prefixed to a section number has one of the following interpretations: *E* means beginning at 5:30 P.M. or later, *B* means scheduled for inter-campus bus transportation, and *S* means meeting on Saturdays.

Students registering for courses listed as "to be arranged" should consult with the division head to determine time and place of meeting.

FREE BUS TRANSPORTATION

To provide students with a broader program, certain upper division classes have been scheduled around a bus transportation schedule. Free bus service will be provided between Alton and East St. Louis on Mondays, Tuesdays, Wednesdays, and Thursdays at times given on the back cover.

Classes scheduled for inter-campus bus transportation meet twice weekly for periods of one and one-half or two hours.

The bus will depart from East St. Louis on the Ohio Street side and from Alton on College and Seminary Streets.

Students taking courses on the bus schedule will not need to travel during the week of final examinations to take their tests. The examination will be proctored at the other center by the chief academic adviser or a member of his staff.

Likewise, students will not need to travel to return their textbooks. The bookstore at either center will accept texts for courses on the bus schedule provided that the student makes clear this situation to the attendant at the time of book return; otherwise confusion will result.

EXPLANATION OF ENTRIES

The entry for each course is arranged as follows:

First Line: The course's identification number is followed by the number of quarter hours of credit and the descriptive title. A dotted line separates the title from the prerequisite, which appears at the right-hand end of the first line and sometimes continues to the second line.

Second Line: Special registration information, explanations, or any other remarks about the course appear on the second line. Sometimes the second line is not used.

Section-Number Lines: The first column lists the section numbers for classes offered at Alton; the second lists sections offered at East St. Louis. Following each section number are the time the class begins (between 8:00 A.M. and 4:20 P.M. for daytime classes) and the time it ends. Each evening class is indicated by the letter *E* prefixed to its section number. The days on which the class meets, the place where it meets, and the instructor's last name complete the entry.

Course No. & Hours		Descriptive Title			Prerequisite
Alton	E. St. Louis	Time	Days	Place	Instructor

GENERAL STUDIES AREA A—MAN'S PHYSICAL ENVIRONMENT and BIOLOGICAL INHERITANCE (GSA)

151-3 Introduction to Physical Science I Category A on A.C.T.
Math test or C in Math 100 or pass placement exam.

Student enrolls in lecture and one lab. Labs meet every other week.

Lect	9:00-9:50	Tu ThF	AUD 200	McAneny
Lab 1	3:00-4:50	Tu	SCI 7	McAneny
Lab 2	11:00-12:50	W	SCI 7	Boedeker
Lab 3	1:00-2:50	W	SCI 7	McAneny
Lab 4	3:00-4:50	W	SCI 7	McAneny

Course No. & Hours	Descriptive Title	Days	Place	Prerequisite
Alton	E. St. Louis	Time		Instructor
	Lect	9:00-9:50	Tu ThF	113 staff
	Lab 51	9:00-10:50	M	124 staff
	Lab 52	9:00-10:50	W	124 staff
152-3	Introduction to Physical Science II			151
	Lect	3:00-3:50	Tu ThF	AUD 200 Zurheide
	Lab 1	1:00-2:50	M	SCI 7 Zurheide
	Lab 2	3:00-4:50	M	SCI 7 Boedeker
	Lab 3	10:00-11:50	Tu	SCI 7 Zurheide
	Lab 4	12:00-1:50	Tu	SCI 7 Zurheide
	Lect	3:00-3:50	Tu ThF	AUD staff
	Lab 51	1:00-2:50	M	124 staff
	Lab 52	3:00-4:50	M	124 staff
	E53	8:20-10:10	M W	124 staff
251-3	Man's Biological Inheritance			153 or high school physics and chemistry
	Day student enrolls in lecture and one lab.			
	Lect	10:00-10:50	Tu Th	SCI 102 Axtell
	Lab 1	10:00-11:50	M	SCI 101 staff
	Lab 2	10:00-11:50	W	SCI 101 staff
	E3	6:20-8:10	Tu Th	SCI 101 staff
	Lect	6:20-8:10	M	113 staff
	Lab 51	4:20-6:10	M	124 staff
	Lab 52	4:20-6:10	W	124 staff
	Lab 53	6:20-8:10	W	124 staff
252-3	Man's Biological Inheritance			251
	Day student enrolls in lecture and one lab.			
	Lect	10:00-10:50	M W	ANA 104 Frost
	Lab 1	10:00-11:50	Tu	SCI 101 staff
	Lab 2	10:00-11:50	Th	SCI 101 staff
	Lab 3	10:00-11:50	F	SCI 101 staff
	Lab 4	2:00-3:50	Th	SCI 100 staff
	E5	6:20-8:10	M W	SCI 101 Frost
	Lect	3:00-3:50	M W	AUD staff
	Lab 51	12:00-1:50	Th	116 staff
	Lab 52	2:00-3:50	Th	116 staff
	Lab 53	10:00-11:50	F	116 staff
255-3	Earth Science			Option with 252-3 or 253-3
	1	12:00-12:50	Tu Th	ANA 104 Vogel
		8:00-9:50	F	ANA 110 Vogel
	2	12:00-12:50	Tu Th	ANA 104 Vogel
		2:00-3:50	F	ANA 110 Vogel
	51	2:00-2:50	Tu Th	225 Schwartz
		2:00-3:50	F	225 Schwartz
	52	2:00-2:50	Tu Th	225 Schwartz
		8:00-9:50	Th	225 Schwartz
	E53	8:20-9:35	Tu Th	225 Snaden
363-3	Philosophy of Science			
	B1	1:00-2:25	M W	ANA 110 Morrison

GENERAL STUDIES AREA B—MAN'S SOCIAL INHERITANCE AND SOCIAL RESPONSIBILITIES (GSB)

151-3	Survey of Western Tradition: Geographic Background			
	1	12:00-1:15	M W	ANA 104 Baker
	2	3:00-4:15	Tu Th	ANA 104 Baker
	51	11:00-11:50	M W F	113 Guffy
152-3	Introduction to the Western Tradition			151
	1	12:00-12:50	M W F	AUD 200 Kimball
	2	2:00-2:50	M W F	AUD 200 staff

Course No. & Hours	Descriptive Title			Days	Place	Prerequisite
	Alton	E. St. Louis	Time			
GSB 152 (Continued)						
E3			6:20-7:45	M W	AUD 103	staff
	51		12:00-12:50	M W F	AUD	Keleher
	E52		6:20-7:45	Tu Th	204A	Keleher
153-3	Introduction to the Western Tradition					152
1			4:00-4:50	M W F	AUD 200	staff
E2			6:20-7:45	Tu Th	AUD 103	staff
	51		9:00-9:50	M W F	204	Haas
	52		3:00-3:50	M W F	204	Keleher
	53		8:20-9:45	M W	204	staff
252-3	The Study of Man: Culture, Society, and the Individual					251
1			1:00-2:15	Tu Th	ANA 104	Campbell
E2			6:20-7:45	M W	SCI 102	staff
	51		9:00-9:50	M W F	AUD	Rudwick
	E52		6:20-7:45	Tu Th	224	Seymour
253-3	The Study of Man: Culture, Society, and the Individual					Not open
						to students who have had Psyc 201
1			12:00-12:50	M W F	SCI 200	Kuenzli
	51		2:00-2:50	M W F	204	Dameron
255-3	Political Economy I					
1			11:00-11:50	M W F	ANA 104	Van Dahm
	51		1:00-1:50	MTu Th	113	Cohen
256-3	Political Economy II					255
1			12:00-1:15	Tu Th	AUD 101	Mace
E2			8:20-9:35	M W	AUD 101	Mace
	51		10:00-10:50	M W F	113	Stahnke
	E52		8:20-9:35	M W	106	Lovell
331-3	The American Educational Systems					
1			10:00-10:50	M W F	SCI 2	Wheat
B2			11:00-12:25	Tu Th	ANB 201	Wheat
	E51		5:30-8:10	Tu	104	Jung
	B52		10:00-11:25	M W	105	Schmid
357-3	Economic Development of the United States (Replaces Econ. 317-4.)					255
1			8:00-8:50	M W F	ANA 104	staff
	51		2:00-2:50	M W F	113	Sauber
	E52		5:30-8:10	W	212	Sauber

GENERAL STUDIES AREA C—MAN'S INSIGHTS AND APPRECIATIONS (GSC)

151-3	Introduction to Poetry					Recommended: GSD 151 and 152
1			12:00-12:50	M W F	AUD 102	staff
E2			6:20-7:35	M W	AUD 102	staff
	51		1:00-1:50	M W F	104	staff
	E52		8:20-9:35	M W	202B	staff
152-3	Logic					
	Day student enrolls in lecture and one quiz section.					
Lect			11:00-11:50	Tu Th	ANA 104	Morrison
1			10:00-10:50	M	AUD 102	Morrison
2			10:00-10:50	W	AUD 102	Morrison
3			10:00-10:50	F	AUD 102	Morrison
E4			8:20-9:35	Tu Th	AUD 102	Morrison
Lect			10:00-10:50	Tu Th	113	Linden
	51		8:00-8:50	M	221	Linden
	52		8:00-8:50	W	221	Linden
	53		8:00-8:50	F	221	Linden
	E54		8:20-9:35	Tu Th	222	Linden

Course No.	& Hours	Descriptive Title	Days	Place	Prerequisite Instructor
Alton	E. St. Louis	Time			
153-3	Art Appreciation				
1		10:00-10:50	M W F	FAA 100	Huntley
2		11:00-11:50	M W F	FAA 100	Richardson
3		1:00-1:50	M W F	FAA 100	Marcell
E4		6:20-7:45	Tu Th	FAA 100	Buddemeyer
	51	9:00-9:50	M W F	221	Kemper
	52	2:00-3:35	Tu Th	103	staff
	53	4:20-5:35	Tu Th	221	staff
154-3	Music Understanding				
1		11:00-11:50	M W F	AUD 200	Boldt
	51	10:00-10:50	M W F	212	staff
	E52	5:30-8:10	M	212	staff
252-3	Literary and Philosophical Masterpieces II				
1		10:00-10:50	M W F	AUD 200	Ades
E2		6:20-7:35	Tu Th	AUD 200	Shea
	51	10:00-10:50	M W F	AUD	Hornback
	E52	8:20-9:35	M W	AUD	Murdoch
254-3	Introduction to the Theater				
E1		1:00-2:15	Tu Th	ANB 102	Kochman
255-3	Music in History				
	51	11:00-11:50	M W F	212	staff
352-4	History of World Art II			.9 hours second level	GSC
1		12:00-12:45	MTuWTh	FAA 100	Richardson
354-3	History of the Theater to the Italian Renaissance				254
	51	1:00-1:50	M W F	212A	Birdman
357-3	Music History and Literature I				255
1		2:00-2:50	M W F	FAC 201	Tulloss
363-3	Philosophy of Science				
B1		1:00-2:25	M W	ANA 110	Morrison

GENERAL STUDIES AREA D—ORGANIZATION AND COMMUNICATION OF IDEAS (GSD)

151-3	English Composition			A.C.T score necessary for all sections.	
	1B	8:00-8:50	MTu ThF	AUD 100	staff
	2B	9:00-9:50	MTu ThF	AUD 100	staff
	3B	1:00-1:50	MTu ThF	AUD 100	staff
	E4B	8:20-10:10	W W	AUD 100	staff
	E5B	8:20-10:10	Tu Th	AUD 100	staff
	51B	8:00-8:50	MTu ThF	222	staff
	52B	9:00-9:50	MTu ThF	222	staff
	53B	12:00-12:50	MTu ThF	222	staff
	E54B	8:20-10:10	M W	222	staff
	E55B	6:20-8:10	Tu Th	222	staff
152-3	English Composition				151
	1A	9:00-9:50	MTu F	AUD 102	staff
	2A	11:00-11:50	MTu F	AUD 100	staff
	3A	1:00-1:50	MTu F	AUD 102	staff
	4B	8:00-8:50	MTu ThF	AUD 102	staff
	5B	8:00-8:50	MTu ThF	AUD 101	staff
	6B	10:00-10:50	MTu ThF	AUD 100	staff
	7B	11:00-11:50	MTu ThF	AUD 102	staff
	8B	12:00-12:50	MTu ThF	AUD 100	staff
	9B	1:00-1:50	MTu ThF	AUD 101	staff
	10B	2:00-2:50	MTu ThF	AUD 100	staff
	11B	2:00-2:50	MTu ThF	AUD 102	staff
	12B	3:00-3:50	MTuWTh	AUD 102	staff
	E13B	6:20-8:10	M W	AUD 100	staff

Course No. & Hours	Descriptive Title	Days	Place	Prerequisite Instructor
Alton	E. St. Louis	Time		
GSB 152 (Continued)				
E14B		8:20-10:10	M W	AUD 102 staff
E15B		6:20-8:10	Tu Th	AUD 100 staff
	51A	9:00-9:50	M W F	201B staff
	52A	11:00-11:50	MTu F	222 staff
	53A	1:00-1:50	MTu F	201B staff
	54B	8:00-8:50	MTu ThF	201B staff
	55B	10:00-10:50	MTu ThF	222 staff
	56B	11:00-11:50	MTu ThF	201B staff
	57B	12:00-12:50	MTu ThF	201B staff
	58B	1:00-1:50	MTu ThF	222 staff
	59B	2:00-2:50	MTu ThF	222 staff
	60B	2:00-2:50	MTu ThF	201B staff
	61B	3:00-3:50	MTuWTh	222 staff
	E62B	6:20-8:10	M W	201B staff
	E63B	8:20-10:10	M W	201B staff
	E64B	8:20-10:10	Tu Th	105 staff

153-3 Oral Communication of Ideas

Day students enroll for the lecture and one of the practice sections.

Lect		11:00-11:50	Tu	AUD 200	Hawkins
1		8:00-8:50	M W F	ANB 101	Lyle
2		9:00-9:50	M W F	ANB 101	Lyle
3		9:00-9:50	M W F	ANB 201	Hawkins
4		10:00-10:50	M W F	ANB 201	Hawkins
5		11:00-11:50	M W F	ANB 201	White
6		1:00-1:50	M W F	ANB 201	Smith
7		2:00-2:50	M W F	ANB 201	White
8		3:00-4:15	Tu Th	ANB 201	staff
9		4:20-6:10	M W	ANB 201	Lyle
E10		6:20-8:10	M W	ANB 201	Smith
E11		6:20-8:10	Tu Th	ANB 201	staff
Lect		11:00-11:50	Th	AUD	Cornwell
51		8:00-8:50	M W F	106	Cornwell
52		9:00-9:50	M W F	106	Bell
53		10:00-10:50	M W F	106	Bell
54		10:00-10:50	M W F	112	Cornwell
55		11:00-11:50	M W F	106	Birdman
56		1:00-1:50	M W F	106	Bell
57		2:00-2:50	M W F	106	staff
58		4:20-6:10	M W	106	staff
E59		6:20-8:10	Tu Th	106	staff

155-3 Introduction to Mathematics Score on A.C.T. Math test or C in Math 100.

Day student enrolls in lecture and one lab section. Tests on second and fourth Fridays.

Lect		8:00-8:50	Tu ThF	SCI 102	Forcade
1		8:00-8:50	M W	SCI 102	staff
2		9:00-9:50	M W	S&T 101	staff
E3		6:20-8:10	M W	SCI 103	staff
Lect		8:00-8:50	M W F	AUD	Williams
51		8:00-8:50	Tu Th	205	staff
52		12:00-12:50	M W	205	staff
53		12:00-12:50	Tu Th	205	staff
54		3:00-3:50	Tu Th	205	staff
E55		6:20-8:10	Tu Th	205	Rutledge

156-3 Introduction to Mathematics 155

Day student enrolls in lecture and one lab section.

Lect		8:00-8:50	M W F	AUD 200	Phillips
1		8:00-8:50	Tu Th	S&T 101	staff
2		8:00-8:50	Tu Th	SCI 3	staff

Course No. & Hours	Descriptive Title	Time	Days	Place	Prerequisite Instructor	
Alton	E. St. Louis					
3		8:00-8:50	Tu Th	AUD 103	staff	
4		2:00-2:50	Tu Th	ANB 202	staff	
E5		8:20-10:10	Tu Th	S&T 101	Broadbooks	
	Lect	8:00-8:50	Tu ThF	204	Bennewitz	
	51	8:00-8:50	M W	205	staff	
	52	8:00-8:50	M W	204	staff	
	53	12:00-12:50	M W	224	staff	
	54	12:00-12:50	Tu Th	224	staff	
	E55	8:20-10:10	M W	205	staff	
164-3	College Algebra I	Three Semesters of High School Algebra				
	1	3:00-3:50	M W F	SCI 103	staff	
	E51	6:55-8:10	Tu Th	220	Wang	
174-3	Elementary French					173
	One hour of lab per week to be arranged.					
	1	10:00-10:50	MTu Th	HUM 100	staff	
	2	11:00-11:50	MTu Th	HUM 100	staff	
	3	2:00-2:50	MTu Th	HUM 100	staff	
	4	4:20-5:35	M W	HUM 100	staff	
	E5	8:20-9:35	M W	HUM 100	staff	
177-3	Elementary German					176
	One hour of lab per week to be arranged.					
	1	10:00-10:50	MTu Th	SCI 201	staff	
	2	1:00-1:50	MTu Th	HUM 100	staff	
	3	2:00-2:50	MTu Th	AUD 101	staff	
	E4	6:20-7:35	Tu Th	S&T 102	staff	
	51	9:00-9:50	MTu Th	212	staff	
	52	10:00-10:50	MTu Th	221	staff	
	53	3:00-3:50	MTu Th	221	staff	
	E54	8:20-9:35	M W	220	staff	
187-3	Elementary Russian					186
	One hour of lab per week to be arranged.					
	B1	1:00-2:25	Tu Th	SS 200	staff	
	E51	8:20-9:35	Tu Th	201B	staff	
191-3	Elementary Spanish					190
	One hour of lab per week to be arranged.					
	1	11:00-11:50	MTu Th	HUM 205	staff	
	2	3:00-3:50	MTu Th	HUM 205	staff	
	51	1:00-1:50	MTu Th	201A	staff	
	E52	6:20-7:35	Tu Th	201B	staff	

GENERAL STUDIES AREA E—HEALTH AND PHYSICAL DEVELOPMENT (GSE)

251-3	Healthful Living					
	1	1:00-1:50	M W F	AUD 200	Spear	
	E2	4:45-6:10	M W	SCI 102	Moehn	
	51	3:00-3:50	M W F	113	Klein	

See physical education (PEM and PEW) for required physical education courses.

ACCOUNTING (ACCT)

251-4	Elementary Accounting I					
	1	11:00-11:50	TuWThF	ANA 100	Dwyer	
	E2	6:20-8:10	Tu Th	ANA 100	staff	
	E51	8:20-10:10	M W	221	Terre	
252-4	Elementary Accounting II					251
	1	8:00-8:50	MTuWTh	ANA 100	Milles	
	2	10:00-10:50	TuWThF	ANA 100	Dwyer	

Course	No. & Hours	Descriptive Title	Time	Days	Place	Prerequisite Instructor
Alton	E. St. Louis					
	3		2:00-2:50	MTuWTh	ANA 100	Schmitt
	E4		6:20-8:10	M W	ANA 100	staff
	E5		8:20-10:10	Tu Th	ANA 100	staff
		51	9:00-9:50	MTuW F	203	Davison
		52	11:00-11:50	M WThF	203	Bedel
		53	2:00-2:50	MTu ThF	221	Small
		E54	6:20-8:10	M W	203	Terre
		E55	8:20-10:10	Tu Th	221	Terre
331-5	Tax Accounting 253					
	E1		5:55-8:10	Tu Th	ANA 101	staff
		51	3:00-3:50	MTuWThF	203	Small
341-3	Cost Accounting 253					
	1		1:00-1:50	Tu ThF	ANA 100	Dwyer
		E51	5:30-8:10	W	104	Bedel
352-4	Advanced Accounting II 253					
	1		12:00-12:50	MTuWTh	ANA 100	Schmitt
	E2		8:20-10:10	M W	ANA 100	staff
		51	1:00-1:50	MTuW F	221	Davison
		E52	6:20-8:10	Tu Th	221	Bedel
432-4	Problems in Federal Taxation 331					
	B1		9:00-10:50	M W	S&T 102	Milles
		E51	8:20-10:10	M W	201A	Davison
442-4	Advanced Cost Accounting 341					
	E1		6:20-8:10	M W	ANA 109	Schmitt
		B51	10:00-11:50	Tu Th	212A	Small

ANTHROPOLOGY (ANTH)

300-4	Man's Place in Nature staff					
	E1		6:20-8:10	Tu Th	SS 105	staff
		E51	8:20-10:10	Tu Th	202B	Culbert
304-4	The Origins of Civilization Culbert					
		B51	12:00-1:50	Tu Th	212	Culbert
310-4	Man and Culture E. Schusky					
	1		9:00-9:50	MTuWTh	SS 105	E. Schusky
470-4	Social Anthropology E. Schusky					
	1		11:00-11:50	MTuWTh	SS 105	E. Schusky

APPLIED SCIENCE (AP SCI)

205-3	Engineering Drawing II 101					
	1		8:00-9:50	M W F	ANA 109	Bishop
	2		10:00-11:50	M W F	ANA 109	Bishop
		51	3:00-4:50	M W F	203	staff
		E52	6:20-9:10	Tu Th	203	staff
261-3	Analytical Mechanics (Dynamics I) 260					
	E1		8:20-9:35	Tu Th	ANA 109	staff
		E51	8:20-9:35	M W	203	staff

ART (ART)

100-5	Basic Studio Marcell					
	1		2:00-3:50	MTuWTh	FAA 202	Marcell
			2:00-2:50	F	FAA 202	Marcell
	E2		6:20-9:50	Tu Th	FAA 102	Huntley
		51	1:00-2:50	MTu ThF	214	Milovich
			1:00-1:50	W	214	Milovich

Course No. & Hours	Descriptive Title	Alton	E. St. Louis	Time	Days	Place	Prerequisite Instructor
201-4	Drawing and Composition						15 hours of 100
1				8:00-9:50	MTuWTh	FAA 102	Marcell
203-4	Beginning Ceramics						15 hours of 100
1				2:00-3:50	MTuWTh	Gym 10	Howerton
E2				6:20-9:50	M W	Gym 10	Howerton
300-4	Art Education	For elementary education majors and art education majors. Students may elect up to 12 hours (Sec. 1 and E52.: 1st four hours. Sec. 51: 2nd four hours. Sec. 2 and 53: 3rd four hours.)					
1				1:00-2:50	M W F	FAA 200	Buddemeyer
2				Arranged	Arranged	FAA 200	Buddemeyer
		51		10:00-11:50	M W F	214	Milovich
		52		4:20-7:00	M W	214	Milovich
		53		Arranged	Arranged	214	Milovich
305-4	Advanced Ceramics						8 hours of 203
1				10:00-11:50	MTuWTh	Gym 10	Howerton
310-4	Oil Painting						8 hours of 201
1				1:00-2:50	MTuWTh	FAA 202	Huntley
325-4 to 12	Studio						Consent of instructor staff
1				Arranged	Arranged	Arranged	
358-4	Prints						8 hours of 201
E1				6:20-9:50	Tu Th	FAA 103	Richardson
365-4	Art Education in the Secondary Schools						For art concentrations only. Offered winter quarter only.
1				9:00-10:50	M W F	FAA 200	Buddemeyer
406-4	Studio in Painting						401 or consent of art faculty staff
1				Arranged	Arranged	Arranged	
416-4	Studio in Painting						410 or consent of art faculty staff
1				Arranged	Arranged	Arranged	Richardson
426-4	Studio in Pottery						420 or consent of art faculty staff
1				Arranged	Arranged	Arranged	Howerton

BOTANY (BOT)

101-5	General Botany	Day student enrolls in lecture and one lab.					
E1				6:20-9:50	Tu Th	SCI 100	Hewitson
	Lect			10:00-10:50	M W F	103	Davis
	Lab 51			10:00-11:50	Tu Th	116	Davis
	Lab 52			8:00-9:50	M W	116	Davis
350-4	Plants in Relation to Man						
E51				5:55-7:35	Tu Th	116	Davis
413-5	Comparative Structure of Plants						101, 202
1				Arranged	Arranged	Arranged	Hewitson

CHEMISTRY (CHEM)

111-5	Chemical Principles and Inorganic Chemistry	High school algebra and geometry or equivalent.					
1				12:00-12:50	M W F	SCI 201	Firsching
				12:00-12:50	Th	SCI 201	Firsching
				12:00-2:50	Tu	SCI 206	staff
	E51			6:20-8:10	Tu Th	112	Stallard
				9:00-12:00	Saturday	125	Stallard
112-5	Chemical Principles and Inorganic Chemistry	Student enrolls in lecture and one lab section.					
Lect				8:00-8:50	M W F	SCI 200	Cliff
Lab 1				8:00-8:50	Th	SCI 200	Cliff
				8:00-10:50	Tu	SCI 206	staff

Course No. & Hours	Descriptive Title	Time	Days	Place	Prerequisite Instructor
Alton	E. St. Louis				
CHEM 112 (Continued)					
Lab 2		8:00-8:50	Tu	SCI 200	Bardolph
		8:00-10:50	Th	SCI 206	staff
Lab 3		12:00-12:50	M	SCI 103	Cliff
		12:00-2:50	W	SCI 206	staff
Lect		8:00-8:50	MTu ThF	113	Rands
Lect		12:00-12:50	MTu ThF	113	Stallard
Lab 51		1:00-3:50	M	125	Rands
Lab 52		1:00-3:50	Tu	125	Chang
Lab 53		1:00-3:50	W	125	Chang
337-4 Analytical Chemistry					336
East St. Louis student enrolls in lecture and one lab.					
1		3:00-3:50	Tu Th	SCI 201	Firsching
		1:00-3:50	M F	SCI 207	Firsching
Lect		5:55-6:45	M W	112	Chang
Lab E51		Arranged	Arranged	125	Chang
Lab E52		Arranged	Arranged	125	Chang
342-5 Organic Chemistry					341
East St. Louis student enrolls in lecture and one lab.					
E1		6:20-7:35	M W	SCI 201	Bardolph
		7:45-10:35	M W	SCI 207	Bardolph
Lect		10:00-10:50	M W F	212A	Probst
Lab 51		8:00-10:50	Tu Th	123	Probst
Lab 52		1:00-3:50	Tu Th	123	Rands
375-1 to 3 Senior Seminar					Senior standing
1		4:00-4:50	M	SCI 201	Cliff
51		Arranged	Arranged	Arranged	Rands
432-4 Instrumental Analytical Techniques					337, 461
1		2:00-2:50	W F	SCI 201	Parrill
		1:00-3:50	Tu Th	SCI 203	
446-4 Qualitative Organic Chemistry					343
51		2:00-2:50	Tu Th	112	Probst
		Arranged	Arranged	Arranged	Probst
462-4 Physical Chemistry					461
Student enrolls in lecture and one lab.					
1		11:00-11:50	M W F	SCI 201	Parrill
		9:00-11:50	Th	SCI 203	Parrill
Lect		10:00-10:50	M W F	124a	Rands
Lab 51		1:00-3:50	Tu	123	Stallard
Lab 52		1:00-3:50	Th	123	Stallard
490-2 Chemical Literature					337, 343, reading knowledge of German or consent of instructor.
B1		1:00-2:50	M	SCI 201	Bardolph

COMPARATIVE LITERATURE (CLT)

312-4 Comparative Literature: the Drama					Sophomore literature requirement
B1		1:00-2:50	Tu Th	LL 201	Guenther

ECONOMICS (ECON)

205-5 Survey of Economic Principles					
Last year offered					
E1		5:55-8:10	Tu Th	ANA 104	staff
51		1:00-1:50	MTuWThF	204	staff
E52		5:55-8:10	Tu Th	103	Sauber
206-4 Economic Principles and Problems					205
Last year offered					
1		10:00-10:50	MTu ThF	ANB 101	staff

Course No. & Hours	Descriptive Title	Time	Days	Place	Prerequisite Instructor
Alton	E. St. Louis				
E2		8:20-10:10	Tu Th	ANA 101	staff
	51	10:00-10:50	MTuWTh	203	Luan
	E52	8:20-10:10	M W	103	staff
307-4	Economic and Business Statistics I			205; Math 106 recommended	
1		12:00-12:50	MTuWThF	ANB 101	Schwier
	51	9:00-9:50	MTuWThF	103	Luan
	E52	5:55-8:10	M W	103	staff
310-4	Labor Problems			206, or 205 and consent of instructor	
E1		8:20-10:10	M W	ANA 101	staff
315-4	Money and Banking I			205	
1		1:00-1:50	M WThF	ANA 101	Van Dahm
	51	11:00-11:50	MTu ThF	103	Cohen
330-4	Public Finance I: National			206, or 205 and consent of instructor	
	E51	6:20-8:10	Tu Th	202A	Cohen
408-4	Economic and Business Statistics II			307 or consent of instructor	
B1		9:00-10:50	M W	ANA 108	Schwier
411-4	Collective Bargaining and Dispute Settlement			310 or consent of instructor	
	B51	12:00-1:50	Tu Th	202B	Sauber
450-3	History of Economic Thought			205, and 206 or consent of instructor	
1		2:00-2:50	M W F	ANB 202	staff
470-3	Business Cycles			315 or consent of instructor	
E1		5:30-8:10	W	SS 105	Schwier
481-3	Comparative Economic Systems			205 or consent of instructor	
E1		5:30-8:10	M	S&T 101	staff

EDUCATION—ADMINISTRATION (ED AD)

355-4	Philosophy of Education				
	B1	1:00-2:50	Tu Th	S&T 101	Curry
	E2	4:20-6:10	Tu Th	AUD 103	Curry
	B51	2:00-3:50	M W	104	Lee
	E52	6:20-8:10	M W	204A	Schmid
424-4	School Administration				
	4 additional sessions to be arranged.				
	S51	9:00-11:40	Saturday	205	Wheat
500-4	Research Methods			Guid. 420 or 422 recommended	
	E1	5:30-8:10	W	ED 100	Rockwell
534-4	School Finance			424	
	E1	5:30-8:10	Tu	ANA 108	Wilkins
554-4	Contrasting Philosophies of Education				
	E51	5:30-8:10	M	204	Lee
556-4	Seminar in Educational Administration				
	E1	5:30-8:10	Th	ED 100	Wheat

EDUCATION—ELEMENTARY (ED EL)

313-4	Children's Literature				
	51	4:20-6:10	M W	105	Kelley
314-4	Elementary School Methods				
	E1	6:20-8:10	Tu Th	ANB 202	Carpenter
	B51	12:00-1:50	M W	105	Kelley
337-4	Reading in the Elementary Schools			314 or 316, and Guid 305	
	B1	1:00-2:50	Tu Th	ANB 101	Bear
	E51	6:20-8:10	Tu Th	201A	Steinkellner
350D-8 to 12	Kindergarten-Primary Student Teaching				
	Must apply to Education Division two quarters in advance.				
	1	6:20-8:10	F	ANB 101	Steinbrook
	51	6:20-8:10	F	105	Steinbrook

Course No. & Hours	Descriptive Title	Alton	E. St. Louis	Time	Days	Place	Prerequisite Instructor
350E-4 to 8	Advanced Kindergarten-Primary Student Teaching						350D
1				6:20-8:10	F	ANB 101	Steinbrook
		51		6:20-8:10	F	105	Steinbrook
351D-8 to 16	Elementary Student Teaching						Must apply to Education Division two quarters in advance
1				6:20-8:10	F	ANB 101	Steinbrook
		51		6:20-8:10	F	105	Steinbrook
351E-4 to 8	Advanced Elementary Student Teaching						351D
1				6:20-8:10	F	ANB 101	Steinbrook
		51		6:20-8:10	F	105	Steinbrook
442-4	Materials and Methods in Elementary School Science						
	4 additional sessions to be arranged						
		S51		9:00-11:40	Saturday	202B	Bliss
505-4	Improvement of Reading Instruction						Not for students who have had 337 or 437
S1				9:00-11:40	Saturday	AUD 102	Steinkellner
515-4	Special Problems in the Teaching of Arithmetic in the Elementary School						415, Math 210 or consent of instructor
E1				5:30-8:10	Th	AUD 101	Steinbrook
541-4	Selected Teaching and Curriculum Problems in Elementary School Science						Not open to students who have had 442
		S51		9:00-11:40	Saturday	202B	Bliss
543-4	Teaching the Social Studies in the Elementary School						
E1				5:30-8:10	W	S&T 101	Carpenter
559-4	Workshop in Instructional Leadership in Elementary Education						
S1				9:00-11:40	Saturday	AUD 103	Bear
561-4	The Elementary School Curriculum						Not open to students who have had Ed. Ad. 460 or Ed. El. 461
E1				5:30-8:10	Tu	ED 100	Lee

EDUCATION—SECONDARY (ED SEC)

315-4	High School Methods						Guid 305
E1				6:20-8:10	M W	SCI 2	Smyers
		51		4:20-6:10	Tu Th	105	Bliss
352D-8 to 12	Secondary Student Teaching						Must apply to Education Division two quarters in advance
1-26				4:20-6:10	F	ANA 100	Steinbrook
		51-76		4:20-6:10	F	105	Steinbrook
1	51			Agriculture			
2	52			Art			
3	53			Biology			
4	54			Business			
5	55			Chemistry			
6	56			Economics			
7	57			English			
8	58			Foreign Language			
9	59			General Science			
10	60			Geography			
11	61			Government			
12	62			Health Education			
13	63			History			
14	64			Home Economics			
15	65			Industrial Education			
16	66			Journalism			
17	67			Mathematics			
18	68			Music			
19	69			Physical Education			
20	70			Physics			

Course No. & Hours	Descriptive Title	Days	Place	Prerequisite Instructor
Alton	E. St. Louis	Time		
21	71	Sociology		
22	72	Social Studies		
23	73	Speech		
24	74	Library Service		
25	75	Psychology		
26	76	School Nursing		
352E-4 to 8	Secondary Student Teaching			352D
(See above listing under 352D)				
1-26		4:20-6:10	F	ANA 100 Steinbrook
	51-76	4:20-6:10	F	105 Steinbrook
488-4	Teaching the Social Studies in Secondary Schools			315 or consent of instructor
4 additional sessions to be arranged.				
E1		5:30-8:10	W	ANA 104 Smith
505-4	Improvement of Reading Instruction			
S1		9:00-11:40	Saturday	AUD 102 Steinkellner
508-4	Seminar: Trends in Selected Areas in Secondary Schools			
E51		5:30-8:10	W	222 Bliss
550-4	Core Curriculum in the Secondary School			
E1		5:30-8:10	Tu	AUD 101 Schmid
564-4	High School Principalship			Ed. Ad. 424 or consent of instructor
S1		9:00-11:40	Saturday	S&T 101 Brubaker
570-4	Extra-Class Activities			Not open to students who have had 470
S51		9:00-11:40	Saturday	103 Smyers

EDUCATION—SPECIAL (ED SP)

410-4	Problems and Characteristics of the Mentally Retarded			Guid 305 or Psyc 301 or 303
1		4:20-6:10	Tu Th	SS 200 Johnson
412-4	Education of Gifted Children			Guid 305 or Psyc 301 or 303
4 additional sessions to be arranged.				
51		4:10-6:50	M	222 Matthews
413-4	Directed Observation of Exceptional Children			Consent of instructor
Must be taken with 410				
1		4:20-6:10	Tu Th	SS 200 Johnson
513-4	Organization, Administration and Supervision of Special Classes			Guid 305, Psyc 301 or 303
E51		5:30-8:10	W	202A Tucker

ENGLISH (ENG)

300-4	Principles of English Grammar			
1		9:00-9:50	MTu ThF	AUD 101 Wood
E51		8:20-10:10	M W	112 Austin
309-4	A Survey of American Literature to 1860			
1		11:00-11:50	MTu ThF	AUD 101 Zanger
E2		6:20-8:10	M W	AUD 101 Doepke
E51		8:20-10:10	Tu Th	106 Hornback
316-4	English Literature, 1550-1750			
1		10:00-10:50	MTu ThF	AUD 101 Slattery
51		9:00-9:50	MTu ThF	202B Allen
E52		6:20-8:10	M W	202B My. Taylor
320-4	Early Nineteenth Century Poetry			
B51		12:00-1:50	M W	202B Graham
365-4	Shakespeare			
1		1:00-2:50	Tu Th	HUM 205 M. A. Taylor
391-3	Usage in Spoken and Written English			
1		4:20-5:45	M W	AUD 100 Mogan

Course No. & Hours	Descriptive Title	Alton	E. St. Louis	Time	Days	Place	Prerequisite	Instructor
455-4	Victorian Novel			4:20-6:10	Tu Th	AUD 102	211 or 317	Duncan
461-4	Restoration and Eighteenth Century Drama		B51	2:00-3:50	Tu Th	202A		Graham
473-4	Milton		51	10:00-11:50	M W	201A	Offered once annually	Revard
485-4	Problems in the Teaching of English		E1	6:20-8:10	M W	S&T 102		Steinman
534-4	Studies in Early Nineteenth Century American Writers			4:20-6:10	M W	AUD 101		Zanger
538-4	Problems in American Literature		E51	4:20-6:10	M W	202B		McDermott

FOREIGN LANGUAGES (FL)

French (Fr)

174C-1	French Conversation Current enrollment in the corresponding beginning section						
	1			10:00-10:50		F	HUM 100	staff
	2			11:00-11:50		F	HUM 100	staff
	3			2:00-2:50		F	HUM 100	staff
	4			4:20-5:10		F	HUM 205	staff
	E5			9:45-10:10	M	W	HUM 100	staff
202-3	Intermediate Course 201						
	1			9:00-9:50	M	W	F	SS 200
220-2	Advanced French Conversation GSD 175						
	1			9:00-9:50	Tu	Th	HUM 100	staff
302-3	Seventeenth and Eighteenth Century Drama 203 or consent of instructor						
	1			11:00-11:50	MTu	Th	ANA 101	Pellegrino
312-4	Survey of French Literature 203 or consent of instructor						
	1			4:20-6:10	Tu	Th	HUM 205	Heisner

German (Ger)

177C-1	German Conversation Current enrollment in the corresponding beginning section						
	1			10:00-10:50		F	SCI 201	staff
	2			1:00-1:50		F	HUM 100	staff
	3			2:00-2:50		F	AUD 101	staff
	E4			7:45-8:10	Tu	Th	HUM 100	staff
		51		9:00-9:50		F	212	staff
		52		10:00-10:50		F	221	staff
		53		3:00-3:50		F	221	staff
		E54		9:45-10:10	M	W	220	staff
202-3	Intermediate Course 201						
	1			4:20-5:45	M	W	S&T 102	staff
		51		2:00-2:50	M	W	F	212
220-2	Advanced German Conversation Consent of instructor						
	1			4:20-6:10		F	ANB 202	Asmyte
251-4	Scientific German 178 or equivalent						
		51		4:20-6:10	Tu	Th	212A	Ryberg
302-4	Survey of German Literature 2 years of college German or equivalent						
	1			4:20-6:10	M	W	SS 200	Guenther
312-4	Introduction to German Classical Literature 203 or equivalent						
	1			4:20-6:10	Tu	Th	ANB 202	Asmyte

Russian (Russ)

187c-1	Russian Conversation Current enrollment in the corresponding beginning section						
	1			2:25-2:50	Tu	Th	SS 200	staff
		E51		9:45-10:10	Tu	Th	201B	staff

Course No. & Hours	Descriptive Title	Alton	E. St. Louis	Time	Days	Place	Prerequisite	Instructor
202-3	Intermediate Course							201
	Offered only at East St. Louis.							
	51			4:20-5:45	M W	203		staff
220-2	Advanced Russian Conversation						GSD 188, consent of instructor	
	Offered only at East St. Louis.							
	51			4:20-6:10	F	212A		staff

Spanish (Span)

191c-1	Spanish Conversation					 Current enrollment in the corresponding beginning section	
	1			11:00-11:50	F	HUM 205		staff
	2			3:00-3:50	F	HUM 205		staff
	51			1:00-1:50	F	201A		staff
	E52			7:45-8:10	Tu Th	201B		staff
202-3	Intermediate Course							201
	Offered only at East St. Louis.							
	51			4:20-5:45	M W	201B		staff
220-2	Advanced Spanish Conversation						GSD 192	
	Offered only at East St. Louis.							
	51			4:20-6:10	F	201B		staff
303-3	Spanish Drama of the 19th and 20th Centuries							203
	Offered only at East St. Louis.							
	B51			2:00-3:25	Tu Th	212A		Pool
312-4	Survey of Spanish Literature							203
	Offered only at Alton.							
	B1			1:00-2:50	M W	LL 201		Goode

GEOGRAPHY (GEOG)

211-5	Economic Geography							
	1			11:00-11:50	MTuWTh F	ANA 110		Channer
	E2			5:55-8:10	M W	ANA 110		Channer
	51			1:00-1:50	MTuWTh F	225		Schwartz
	E52			5:55-8:10	M W	225		staff
212-3	Map Reading and Interpretation							
	B1			1:00-2:25	Tu Th	ANA 110		Baker
310-4	Meteorology						GSB 151 or equivalent	
	1			10:00-10:50	MTuW F	ANA 110		Kazeck
313-3	Geography of Illinois						GSB 151 or equivalent	
	E1			6:20-7:45	Tu Th	ANA 110		Vogel
314-4	Geography of Anglo-America						GSB 151 or equivalent	
	51			8:00-8:50	MTuW F	225		Snaden
315-4	Geography of Europe						GSB 151 or equivalent	
	51			9:00-9:50	MTuW F	225		Guffy
318-4	Geography of Asia						GSB 151 or equivalent	
	1			8:00-8:50	MTuWTh	ANA 110		Baker
322-3	Geography of the Pacific						GSB 151 or equivalent	
	51			12:00-12:50	M W F	225		Mookerjee
323-3	Geography of the Near East						GSB 151 or equivalent	
	1			9:00-9:50	M WTh	ANA 110		Channer
324-4	Restoration and Conservation of Natural Resources							
	51			10:00-10:50	MTuW F	225		Snaden
413-3	Geography of the Caribbean Lands						GSB 151 or equivalent	
	51			11:00-11:50	M W F	225		Schwartz
416-4	Cartography							212
	B51			2:00-3:50	M W	225		Guffy
444-4	Political Geography						GSB 151 or equivalent	
	E51			6:20-8:10	Tu Th	225		Mookerjee

Course No. & Hours	Descriptive Title	Time	Days	Place	Prerequisite	Instructor
470B-4	Planning Administration and the Planning Function in the Public Policy Processes Same as Government 470B-4.					
530-2	Independent Studies in Geography				10 hours of Geog	
E1		8:20-10:10	W	ANA 110		Kazeck

GOVERNMENT (GOV)

210-4	American Government					
1		11:00-11:50	MTuWTh	SCI 102		Mace
51		12:00-12:50	MTuWTh	103		Goodman
232-4	State and Local Government				190 or equivalent	
B51		2:00-3:50	M W	103		Schwab
330-2	Illinois Government				190 or equivalent	
51		3:00-3:50	Tu Th	113		Schwab
362-4	Public Personnel Administration				101 or 190 or 231	
E51		8:20-10:10	M W	105		Schwab
371-4	Problems of American Foreign Policy				243	
E1		6:20-8:10	M W	SS 200		Glaser
373-3	International Politics of Europe				370	
1		10:00-10:50	M W F	SS 200		Glaser
420-3	Pressure Groups and Politics				190 or equivalent	
51		2:00-2:50	MTu Th	202B		Goodman
456-4	Great Britain and the British Empire				390 or consent of instructor	
B1		11:00-12:50	Tu Th	ANA 109		Glaser
457-4	Government and Politics in the Near and Middle East				101 or 190 or 231	
E51		6:20-8:10	Tu Th	212A		Stahnke
470B-4	Planning Administration and the Planning Function in the Public Policy Processes 470A					
B51		2:00-3:50	M W	212A		Mann
485-4	Renaissance and Rationalist Political Theories				6 hours of Gov	
1		8:00-8:50	MTuWTh	SS 105		Mace
495-4	Constitutional Law I				190 or equivalent	
1		9:00-9:50	MTuWTh	HUM 205		Kerr

GUIDANCE (GUID)

305-4	Educational Psychology				Psyc 201 or GSB 253	
1		10:00-10:50	MTu Th F	ANB 102		staff
E2		8:20-10:10	Tu Th	ANA 110		Soper
51		4:20-6:10	Tu Th	202B		Southwood
B52		12:00-1:50	Tu Th	106		Evans
E53		8:20-10:10	M W	104		Moore
412-4	Mental Hygiene				305	
4	additional sessions to be arranged (S51 only)					
B1		9:00-10:50	Tu Th	ANB 202		Sonstegard
S51		9:00-11:40	Saturday	104		Moore
420-4	Educational Statistics				305	
4	additional sessions to be arranged					
E1		5:30-8:10	M	ANA 104		Parker
422-4	Educational Measurements I				305	
4	additional sessions to be arranged (E2 and S51 only)					
B1		1:00-2:50	Tu Th	SCI 102		Johnson
E2		5:30-8:10	M	SS 105		staff
S51		9:00-11:40	Saturday	105		staff
52		4:20-6:10	M W	224		staff
B53		10:00-11:50	M W	104		staff
511-4	Educational Implications of Learning Theories				305	
E1		5:30-8:10	M	ED 100		staff

Course No. & Hours	Descriptive Title	Days	Place	Prerequisite Instructor
Alton	E. St. Louis	Time		
522-4	Educational Measurements II		420 & 422, or consent of instructor	
	E51 5:30-8:10	Tu	113	Taliana
525-4	School Behavior Problems and Their Prevention		412 or consent of instructor	
	S51 9:00-12:00	Saturday	106	Meredith
537-4	Counseling Theory and Practice I		442 or consent of instructor	
	E51 5:30-8:10	Th	113	Sonstegard
538-4	Counseling Theory and Practice II			537
	S1 9:00-11:40	Saturday	AUD 100	Soper
545F-4	Problems in Guidance: Pupil Adjustment		Consent of instructor	
	S51 9:00-12:00	Saturday	106	Sonstegard
545J-4	Problems in Guidance: Organization and Administration			
	E1 5:30-8:10	Tu	HUM 100	Davis
562A-4	Child Development in Education		412 or consent of instructor	
	E1 5:30-8:10	Th	HUM 100	staff

HEALTH EDUCATION (H ED)

302S-4	Driver Education and Training		Valid driver's license	
	E1 6:20-8:10	M W	HUM 205	Spear
471-4	Organization and Administration of School Health			
	1 11:00-11:50	MTuW F	SCI 200	Spear

HISTORY (HIST)

201-4	The United States to 1865		Sophomore standing	
	1 11:00-11:50	TuWTh F	AUD 103	Riddleberger
	51 1:00-1:50	MTuW F	103	Weiss
202-4	The United States since 1865		Sophomore standing	
	1 12:00-12:50	TuWThF	AUD 103	Riddleberger
	E2 8:20-10:10	M W	AUD 103	Weiss
	51 11:00-11:50	MTuWTh	204	Rosenthal
	E52 6:20-8:10	Tu Th	204	McCurry
312-4	Central Europe in the Nineteenth Century		GSB 152 and 153	
	1 8:00-8:50	M W F	AUD 103	Kimball
339-3	History of Greece		304 or consent of instructor	
	51 8:00-8:50	M W F	202B	Erickson
401-4	The Old South			201
	E1 8:20-10:10	M W	SS 200	Riddleberger
412-3	Intellectual History of the United States		201, 202	
	E51 5:30-8:10	W	204	Rosenthal
419-3	English Culture in the Age of American Colonization		101, GSB 152, and 153	
	51 10:00-10:50	M W F	202B	Haas
425-4	American Colonial History			201
	1 9:00-9:50	MTuWTh	AUD 103	McCurry
441-3	American Diplomacy since 1898		201, 202	
	51 2:00-2:50	M W F	112	Weiss
452-3	Historical Research and Thesis Writing			
	E51 Arranged	Arranged	Arranged	staff
500-4	History Seminar			
	E1 Arranged	Arranged	Arranged	staff

HUMANITIES (HUM)

302-3	Humanities (Honors)		Invitation of Honors Program Committee	
	Offered once annually.			
	1 3:00-4:30	W	LL 201	M. A. Taylor

Course No. & Hours	Descriptive Title	Days	Place	Prerequisite
Alton	E. St. Louis	Time		Instructor

INSTRUCTIONAL MATERIALS (IM)

400-2	Library Research Methods				
B1		1:00-2:50	W	ANB 101	staff
417-4	Audio-Visual Methods in Education				Guid 305
4 additional sessions to be arranged (S3 and E53 only)					
1		4:20-6:10	M W	SCI 2	staff
B2		11:00-12:50	Tu Th	SCI 2	Wagner
S3		9:00-11:40	Saturday	SCI 2	staff
B51		12:00-1:50	M W	212	staff
52		4:20-6:10	Tu Th	106	staff
E53		5:30-8:10	Th	104	staff

JOURNALISM (JRNL)

103-3	News				
B1		11:00-12:15	Tu Th	SU	Lee
201-3	News Writing and Editing I				
B51		2:00-4:50	M	223	Lee
		2:00-3:50	W	223	
202-3	News Writing and Editing II				201
B1		1:00-1:50	Tu	SU	
		1:00-2:50	Th	SU	Lee
370-4	Principles of Advertising (Same as Mktg 333.)				Econ 205
E1		8:20-9:45	Tu Th	SU	staff

MANAGEMENT (MGT)

170-4	Introduction to Business Administration				
1		9:00-9:50	MTu ThF	ANA 104	Skjerseth
2		2:00-2:50	MTuWTh	ANA 101	staff
E3		6:20-8:10	M W	ANB 101	staff
E4		6:20-8:10	Tu Th	ANB 101	staff
51		12:00-12:50	MTu ThF	204	staff
52		3:00-3:50	MTu ThF	106	Thomas
E53		6:20-8:10	M W	106	Thomas
241-4	Principles of Programming for Electronic Data Processing				Mgt 240, or equivalent, or consent of instructor
Lab period for section 1 to be arranged.					
1		1:00-1:50	M W F	S&T 102	McKinney
		Arranged	Arranged	Edwardsville	
E2		5:30-8:10	F	S&T 101	McKinney
		8:00-9:50 or			
		10:00-11:50	Saturday	Edwardsville	
271-4	Business Writing				Eng 103
1		10:00-10:50	MTu ThF	S&T 101	Brady
E51		6:20-8:10	M W	124A	Motley
320-5	Corporation Finance				Acct 253 & Econ 205
1		10:00-10:50	MTuWThF	ANA 101	Pinkstaff
E51		5:55-8:10	M W	AUD	staff
323-4	Investments				320
E1		6:20-8:10	Tu Th	SS 200	Pinkstaff
51		10:00-10:50	MTu ThF	204	Meador
327-4	General Insurance				Acct 253 & Econ 206
1		9:00-9:50	MTuWTh	ANA 100	staff
E51		8:20-10:10	M W	225	Thomas
340-4	Business Organization and Management				Junior standing or consent of instructor
E1		8:20-10:10	M W	ANB 101	staff
E51		8:20-10:10	M W	212	staff

Course	No. & Hours	Descriptive Title	Days	Place	Prerequisite
Alton	E. St. Louis	Time			Instructor
361-3	Business Report Writing	51 12:00-12:50	MTu Th	124A	Junior standing Martin
371-4	Business Law I	1 12:00-12:50	MTu ThF	ANA 101	Junior standing Heath
	E2	6:20-8:10	Tu Th		Heath
	E51	6:20-8:10	Tu Th	212	staff
372-4	Business Law II	1 8:00-8:50	MTu ThF	ANA 101	Junior standing Heath
	E2	8:20-10:10	Tu Th	ANB 201	staff
	51	8:00-8:50	MTu ThF	203	staff
	E52	8:20-10:10	Tu Th	112	staff
380-4	Production Management	E1 8:20-10:10	Tu Th	ANB 101	Econ 206 Skjerseth
	51	2:00-2:50	MTu ThF	124A	Ingwersen
385-4	Personnel Management	1 11:00-11:50	MTu ThF	ANB 101	Econ 206 Blackledge
	51	11:00-11:50	MTu ThF	202B	Meador
442-4	Management of Data Processing Systems	E51 6:20-8:10	M	104	241 Tarpey
		6:00-7:50 or 8:00-9:50		Arranged	
475-4	Budgeting and Systems	E1 8:20-10:10	M W	ANB 102	320, Acct 253 Blackledge
479-4	Problems in Business and Economics	B51 10:00-11:50	Tu Th	212	Junior standing Ingwersen
480-4	Seminar in Labor Law	E1 6:20-8:10	M W	ANB 102	Two quarters of business law or Econ 310 McKinney
	51	9:00-9:50	MTu ThF	212A	Meador
481-4	Administrative Management	B1 1:00-2:50	M W	HUM 205	340 Glynn
483-4	Advanced Production Management	E51 8:20-10:10	Tu Th	212A	380 Ingwersen
485-4	Problems in Personnel Management	1 12:00-12:50	MTu ThF	S&T 101	385 Blackledge

MARKETING (MKTG)

230-5	Principles of Marketing	1 9:00-9:50	MTuWTh F	ANA 101	Econ 205 or consent of instructor Vincent
	E2	5:55-8:10	Tu Th	AUD 102	Bosse
	51	9:00-9:50	MTuWTh F	105	Bucher
331-4	Retailing	E51 6:20-8:10	Tu Th	105	230 Bucher
333-4	Principles of Advertising	E1 8:20-10:10	Tu Th	SS 200	230 Pinkstaff
	51	8:00-8:50	MTuWTh	212	Eckles
336-3	Purchasing	E1 5:30-8:10	Tu	ANB 102	230 staff
337-4	Principles of Salesmanship	51 12:00-12:50	MTu ThF	203	230 Bucher
341-4	Transportation	1 12:00-12:50	M WThF	ANB 102	230 Bosse
	E51	8:20-10:10	Tu Th	204	staff
349-3	Wholesaling	B1 1:00-2:25	M W	SS 200	230 Bosse
384-4	Advertising Media Analysis	B51 10:00-11:50	Tu Th	201A	333 Eckles

Course No. & Hours	Descriptive Title	Days	Place	Prerequisite Instructor
Alton E. St. Louis	Time			
438-4	Sales Management		230, & 337 or consent of instructor	
B1	11:00-12:50	M W	ANA 108	Vincent
451-4	Traffic Management		341	
E51	8:20-10:10	M W	212A	Eckles
595-3	Seminar in Marketing		230 or 550	
E1	5:30-8:10	M	ANB 202	Vincent

MATHEMATICS (MATH)

100-0	Elementary Mathematics			
1	12:00-12:50	MTu ThF	SCI 103	staff
51	11:00-11:50	MTu ThF	220	Wang
111-5	Elementary Analysis I		Three semesters of high school algebra and 75% on guidance test.	
1	1:00-1:50	MTuWTh F	SCI 3	Gwillim
E2	5:55-8:10	M W	SCI 3	staff
51	11:00-11:50	MTuWTh F	205	staff
E52	5:55-8:10	Tu Th	220	Rutledge
112-5	Elementary Analysis II		111 or three semesters of algebra and 90% on guidance test.	
1	9:00-9:50	MTuWTh F	SCI 103	Haimo
2	10:00-10:50	MTuWTh F	SCI 103	Haimo
3	11:00-11:50	MTuWTh F	SCI 103	Forcade
4	2:00-2:50	MTuWTh F	SCI 103	Broadbooks
E5	5:55-8:10	Tu Th	SCI 103	staff
51	9:00-9:50	MTuWTh F	220	Wang
52	11:00-11:50	MTuWTh F	221	Lindstrum
53	12:00-12:50	MTuWTh F	220	Williams
54	1:00-1:50	MTuWTh F	220	staff
55	2:00-2:50	MTuWTh F	220	Rutledge
E56	5:55-8:10	M W	220	staff
151-5	Calculus and Analytic Geometry II		150	
1	11:00-11:50	MTuWTh F	S&T 101	Pendergrass
2	3:00-3:50	MTuWTh F	SCI 3	Gwillim
E3	5:55-8:10	Tu Th	S&T 101	Forcade
51	8:00-8:50	MTuWTh F	220	Oursler
52	10:00-10:50	MTuWTh F	220	Bennewitz
E53	5:55-8:10	M W	205	Fanning
210-4	The Teaching of Elementary Mathematics		GSD 157	
1	4:20-6:10	M W	SCI 103	Gwillim
51	1:00-1:50	MTuWTh F	205	Fanning
220-4	Elementary Statistics		111 or GSD 165	
1	4:00-4:50	MTuWTh	SCI 3	Pendergrass
252-4	Calculus and Analytic Geometry III		151	
1	10:00-10:50	M WTh F	AUD 103	Phillips
2	3:00-3:50	MTu ThF	SCI 3	Broadbooks
51	10:00-10:50	MTu Th F	205	Fanning
52	1:00-1:50	MTu Th F	202A	Lindstrum
305-3	Differential Equations I		253 or Concurrent enrollment; Phys 299.	
1	1:00-1:50	M W F	S&T 101	Goering
E51	8:20-9:35	Tu Th	220	Lindstrum
311-3	The Teaching of Secondary Mathematics		320 and Ed Sec 315	
51	10:00-10:50	M W F	201B	Oursler
320-3	Fundamental Concepts of Algebra I		300 or Concurrent enrollment	
E1	6:20-8:35	M W	SCI 200	Phillips
51	9:00-9:50	M W F	205	Oursler
336-3	Concepts of Geometry II		335	
1	2:00-2:50	M W F	ANA 104	Haimo

Course	No. & Hours	Descriptive Title	Days	Place	Prerequisite
Alton	E. St. Louis	Time			Instructor
410-3	1	Statistical Analysis I	MTuWTh	S&T 101	111 or GSD 157 Pendergrass
411-3	E1	Statistical Analysis II	M W	SCI 3	410 Sturley
415-4	51	Non-Euclidean Geometric Principles	MTu ThF	112	252 Clemans
453-3	E1	Advanced Calculus	M W	SCI 103	452 Pendergrass
	51		M W F	205	Williams
455-3	E1	Programming for Digital Computers	M W	HUM 100	Consent of instructor Goering
481-3	E51	Probability and Statistics	Tu Th	205	480 Rutledge
555-3	E1	Complex Variables	M W	S&T 101	454 Goering

MUSIC (MUS)

001-1 ¹	1	University Bands	MTuWTh F	FAB 100	Audition Fjerstad
	51		M W F	AUD	Fjerstad
001C-0	1	Stage Band	Th	FAB 100	Audition Fjerstad
001E-0	1	Instrumental Laboratory	F	FAB 100	One quarter of 010, 020, or 050 or consent of instructor Fjerstad and Kendall
002C-1 ¹	1	Collegiate Singers	M W F	FAB 100	Open to all University students upon audition staff
	51		Tu Th	212	staff
002D-1/2 ¹	E1	University Chorus	M	AUD 200	Audition staff
	E51		Tu	212	staff
003-1	E1	University Symphony Orchestra	Arranged	Arranged	Audition. Credit for music concentration only Kendall
010B-1	1	Class Viola	Tu Th	FAB 100	Kendall
010A-1	1	Class Violin	Tu Th	FAB 100	Kendall
010C-1	1	Class Cello	Tu Th	FAB 100	Kendall
010D-1	1	Class String Bass	Tu Th	FAB 100	Kendall
011-1 to 4	1	Violin	Arranged	Arranged	For music concentrations only, except under unusual conditions Kendall
012-1 to 4	1	Viola	Arranged	Arranged	For music concentrations only, except under unusual conditions Kendall
013-1 to 4	1	Cello	Arranged	Arranged	For music concentrations only, except under unusual conditions Tulloss
020A-1	1	Class Flute	M W	FAB 208	Blakely
020B-1	1	Class Oboe	M W	FAB 208	Blakely
020C-1	1	Class Clarinet	M W	FAB 208	Blakely
020D-1	1	Class Bassoon	M W	FAB 208	Blakely

¹Concerts and extra rehearsals at the discretion of the director.

Credit will be granted after the student has completed three quarters.

Course No. & Hours	Descriptive Title	Days	Place	Prerequisite Instructor
Alton	E. St. Louis	Time		
020E-1	Class Saxophone			
1		9:00-9:50	M W	FAB 208 Blakely
040-1	Class Piano	Music concentration, or 200 (may be concurrent), or equivalent		
	Alton: Sec. 1 for 2nd year majors. Sec. 2 for 1st year majors. Sec. E3 for non-majors. Sec. E51 for non-majors.			
1		10:00-10:50	M W F	FAC 102 Boldt
2		12:00-12:50	M W F	FAC 102 Boldt
3		4:30-6:10	Tu	FAC 102 staff
51		4:30-6:10	M	212 Boldt
041-1 to 4	Piano	For music concentrations only, except under unusual conditions		
1		Arranged	Arranged	FAC 102 Boldt
51		Arranged	Arranged	212 Boldt
050A-1	Class French Horn			
1		8:00-8:50	M W F	FAB 100 Fjerstad
050B-1	Class Trumpet			
1		8:00-8:50	M W F	FAB 100 Fjerstad
050C-1	Class Trombone			
1		8:00-8:50	M W F	FAB 100 Fjerstad
050D-1	Class Tuba			
1		8:00-8:50	M W F	FAB 100 Fjerstad
050E-1	Class Baritone			
1		8:00-8:50	M W F	FAB 100 Fjerstad
051-1 to 4	French Horn	For music concentrations only, except under unusual conditions		
1		Arranged	Arranged	Arranged Fjerstad
052-1 to 4	Trumpet	For music concentrations only, except under unusual conditions		
1		Arranged	Arranged	Arranged Fjerstad
060-1	Class Voice			
	Must be taken in sequence beginning with the fall quarter.			
1		11:00-12:15	Tu Th	FAB 100 staff
061-1 to 4	Voice	For music concentrations only, except under unusual conditions		
1		Arranged	Arranged	Arranged Headley
106-4	Theory of Music			105
	Winter quarter only. Consult adviser for proper section number.			
1		9:00-9:50	MTuWTh F	FAC 203 Kresteff
2		10:00-10:50	MTuWTh F	FAC 203 Kresteff
200-3	Fundamentals of Music			
1		4:45-6:00	M W	FAC 203 Tulloss
206-3	Theory of Music			205
	Winter quarter only			
1		2:00-2:50	MTuWTh	FAC 203 Kresteff
300-3	Music Education—Elementary	200, or equivalent. For non-music concentrations		
51		11:00-11:50	M W F	212A Tulloss
302-3	Music Education in the Junior High School	For music concentrations only		
	Winter quarter only			
1		3:00-3:50	M WTh	FAC 203 Tulloss
309-3	Orchestration I			207
	Winter quarter only			
1		2:00-2:50	Tu Th	FAC 201 Blakely
		8:00-8:50	W	FAC 203 Blakely
318-3	Conducting—General			
	Winter quarter only			
1		9:00-9:50	M W F	FAB 100 Kendall
355-1	Chamber Music			Audition
	(String Ensemble)			
1		Arranged	Arranged	Arranged Kendall
365-1	Chamber Music			Audition
	Section 1 and 2: woodwind ensembles. Section 3: brass ensemble.			
1		10:00-10:50	Tu	FAB 208 Blakely

Course No. & Hours	Descriptive Title	Days	Place	Prerequisite Instructor
Alton	E. St. Louis	Time		
2	10:00-10:50	Th	FAB 208	Blakely
3	8:00-8:50	Tu	FAB 100	Fjerstad
465-3	Development and Teaching of Strings			
E1	5:30-8:10	M	FAB 100	Kendall
471-2 to 4	Private Piano	For music concentrations only, except under unusual conditions		
1	Arranged	Arranged	Arranged	Boldt
472-2 to 4	Private Voice	For music concentrations only, except under unusual conditions		
1	Arranged	Arranged	Arranged	staff
473A-2 to 4	Private Violin	For music concentrations only, except under unusual conditions		
1	Arranged	Arranged	Arranged	Kendall
473B-2 to 4	Private Viola	For music concentrations only, except under unusual conditions		
1	Arranged	Arranged	Arranged	Kendall
473C-2 to 4	Private Violoncello	For music concentrations only, except under unusual conditions		
1	Arranged	Arranged	Arranged	Tulloss
475A-2 to 4	Private Trumpet	For music concentrations only, except under unusual conditions		
1	Arranged	Arranged	Arranged	Fjerstad

The following courses in applied music are available for music students and for others under exceptional conditions. Consult the music adviser at Alton or East St. Louis. Each course has only one section. Times to be arranged. Registration in the 400-level private applied courses is restricted to advanced senior and graduate students.

014-1 to 4	String Bass	473D-2 to 4	Private Bass Viol
021-1 to 4	Flute	474A-2 to 4	Private Flute
022-1 to 4	Oboe	474B-2 to 4	Private Oboe
023-1 to 4	Clarinet	474C-2 to 4	Private Clarinet
024-1 to 4	Bassoon	474D-2 to 4	Private Bassoon
025-1 to 4	Saxophone	474E-2 to 4	Private Saxophone
031-1 to 4	Percussion	475B-2 to 4	Private French Horn
		475C-2 to 4	Private Baritone
053-1 to 4	Trombone	475D-2 to 4	Private Trombone
054-1 to 4	Tuba	475E-2 to 4	Private Tuba
055-1 to 4	Baritone	476 -2 to 4	Private Organ
071-1 to 4	Organ	477 -2 to 4	Private Percussion

PHILOSOPHY (PHIL)

200-4	Types of Philosophy: An Introduction				
E51	8:20-10:10	M	W	124A	Runkle
302-4	World Religions				
E51	6:20-8:10	Tu	Th	202B	Linden
382-4	Medieval and Early Modern Philosophy				
Offered once annually					
B1	2:00-3:50	Tu	Th	SS 105	Shea

PHYSICAL EDUCATION—MEN (PEM)

114-1	Methods and Materials of Teaching Wrestling	Consent of instructor			
1	10:00-10:50	Tu	Th	Gym	Hatheway
152-1	Basic Rhythms I				
1	1:00-1:50	M	Th	Gym	S. Carpenter
252-1	Required Physical Education				
(Swimming. For non-swimmers and beginners only. Pool rental is \$6.)					
1	11:00-12:50	M	W	Gym	Hatheway
2	12:00-1:50	M	W	Gym	Hatheway
51	12:00-1:50	M	W	Gym	Moehn
(Wrestling)					
3	10:00-10:50	W	F	Gym	Hatheway

Course No. & Hours	Descriptive Title	Alton	E. St. Louis	Time	Days	Place	Prerequisite Instructor
PEM 252 (Continued)							
(Wrestling)							
	52			10:00-10:50	Tu Th	Gym	Moehn
(Physical Fitness)							
	4			12:00-12:50	Tu Th	Gym	Hatheway
	5			2:00-2:50	Tu Th	Gym	Hatheway
	53			1:00-1:50	Tu Th	Gym	Moehn
(Self Defense)							
	6			3:00-3:50	M W	Gym	Hatheway
(Square Dance. Same as PEW 208.)							
	7			1:00-1:50	Tu Th	Gym	S. Carpenter
(Badminton)							
	8			11:00-11:50.	M W	Gym	Showers
	54			2:00-2:50	Tu Th	Gym	Moehn
(Fencing. Student must provide equipment. Same as PEW 255.)							
	9			9:00-9:50	Tu Th	Gym	staff
	55			10:00-10:50	W F	Gym	staff
(Life Saving. Same as PEW 317. Pool rental is \$6.)							
	E10			7:00-9:00	Th	Gym	Archangel
(Social Dance. Same as PEW 239.)							
	56			2:00-2:50	W F	Gym	S. Carpenter
254-1 Bowling							
Bowling lane rental charge \$5.50 payable first class meeting							
	1			9:00-10:50	W	Gym	Showers
	2			9:00-10:50	F	Gym	Showers
	51			9:00-9:50	Tu Th	Gym	Showers
261-1 Teaching of Individual Activities I							
	1			9:00-9:50	M W	Gym	Hatheway
350-4 Methods and Materials for Teaching Physical Education Activities in the Elementary School (Same as PEW 350.)							
	E1			6:20-8:10	Tu Th	Gym	Hatheway
	51			9:00-9:50	MTuWTh	Gym & 104	Moehn
376-3 Emergency Care and Prevention of Athletic Injuries							
	1			10:00-10:50	M W F	SCI 102	Physiology 300. Klein

PHYSICAL EDUCATION—WOMEN (PEW)

204-1 Beginning Swimming							
(Pool rental charge \$6)							
	1			11:00-12:50	M W	Gym	Archangel
	51			1:00-2:50	Tu Th	Gym	Archangel
205-1 Intermediate Swimming							
(Pool rental charge \$6)							
	1			11:00-12:50	M W	Gym	Archangel
	51			1:00-2:50	Tu Th	Gym	Archangel
208-1 American Square Dance and Mixers							
	1			1:00-1:50	Tu Th	Gym	Carpenter
212-1 Basketball							
	1			8:00-8:50	W F	Gym	staff
	51			11:00-11:50	Tu Th	Gym	Archangel
215-1 Badminton							
	1			8:00-8:50	Tu Th	Gym	staff
	51			11:00-11:50	W F	Gym	staff
233-1 Modern Dance							
	1			11:00-11:50	Tu Th	Gym	Carpenter
	2			3:00-3:50	Tu Th	Gym	Carpenter
	51			1:00-1:50	W F	Gym	Carpenter
239-1 Social Dance							

Course No. & Hours	Descriptive Title	Days	Place	Prerequisite
Alton	E. St. Louis	Time		Instructor
254-1	Bowling	51 2:00-2:50	W F Gym	Carpenter
	Bowling lane rental charge \$5.50 payable first class meeting			
	1	9:00-10:50	W Gym	Showers
	51	9:00-9:50	Tu Th Gym	Showers
255-1	Fencing			
	(Student must provide equipment)			
	1	9:00-9:50	Tu Th Gym	staff
308-5	Methods of Teaching Dancing		107, 224, & 233 or equivalent	
	1	2:00-2:50	MTuWTh F SCI 200	staff
317-1	Life Saving and Water Safety		205 or equivalent, & consent of instructor	
	(Pool rental charge \$6)			
	E1	7:00-9:00	Th Gym	Archangel
323-1	Officiating Techniques			Consent of instructor
	1	8:00-8:50	M W Gym	Archangel
350-4	Materials and Methods for Teaching Physical Education Activities in the Elementary School (Same at PEM 350)			
	E1	6:20-8:10	Tu Th Gym & 104	Moehn
	51	9:00-9:50	MTuWTh Gym	Hatheway
352-2	History of Physical Education			
	1	10:00-10:50	M W ANB 202	Archangel

PHYSICS (PHYS)

298-5	University Physics II		297, Math 252 or concurrent enrollment	
	Day student enrolls in lecture and one lab.			
	Lect	9:00-9:50	M W F SCI 200	Boedeker
	Lab 1	9:00-10:50	Tu SCI 200	Boedeker
		9:00-10:50	Th SCI 7	Boedeker
	Lab 2	9:00-10:50	Tu SCI 200	
		11:00-12:50	Th SCI 7	Boedeker
	Lab 3	9:00-10:50	Tu SCI 200	Boedeker
		1:00-2:50	Th SCI 7	Boedeker
	E4	6:00-9:05	M W SCI 7	staff
	Lect	11:00-11:50	MTu ThF 124A	staff
	Lab 51	Arranged	124	staff
	Lab 52	Arranged	124	staff
	Lab 53	Arranged	124	staff
300-5	University Physics IV		299, Math 253	
	Student enrolls in lecture and one lab.			
	Lect	9:00-9:50	MTu ThF 124A	staff
	Lab 51	Arranged	124	staff
	Lab 52	Arranged	124	staff
	Lab 53	Arranged	124	staff
301-4	Mechanics		297; Math 324 or concurrent enrollment	
	1	2:00-2:50	MTuW F SCI 2	Boedeker
	E51	6:20-8:10	Tu Th 124A	staff
303-5	Heat			320
	1	10:00-10:50	MTuWThF SCI 3	McAneny
306-4	Introduction to Electric Theory II		299; Math 324	
	E1	6:20-8:10	Tu Th SCI 3	Zurheide
	51	1:00-1:50	MTuW F 124A	staff
416-4	Modern Physics II		300; nine hours of Math numbered 300 or above	
	1	11:00-11:50	MTuW F SCI 3	McAneny
418-1 to 4	Modern Physics Laboratory		415 or concurrent enrollment and consent of instructor	
	1	12:00-1:50	Th SCI 9	Zurheide
		And two hours to be arranged.		

Course No. & Hours	Descriptive Title	Days	Place	Prerequisite
Alton	E. St. Louis	Time		Instructor

PHYSIOLOGY (PHSL)

209-5	Introduction to Physiology			
1	3:00-4:15	Tu Th	SCI 101	Ratzlaff
	12:00-1:50	Tu Th	SCI 101	Ratzlaff
316-5	Advanced College Physiology			
51	11:00-11:50	M W F	116	Ratzlaff
	12:00-1:50	M W	116	

PSYCHOLOGY (PSYC)

201-4	Introductory Psychology			
Not open to students who have had GSB 253				
1	10:00-10:50	M WThF	SCI 200	Rockwell
E2	8:20-10:10	M W	SCI 102	staff
	2:00-3:50	Tu Th	204	Tucker
	8:20-10:10	Tu Th	103	staff
211-4	Principles and Methods of Psychology I			201 or GSB 253
B51	10:00-11:50	M W	204A	Dameron
301-4	Child Psychology			201 or GSB 253
1	4:20-6:10	M W	AUD 103	Kuenzli
	8:20-10:10	Tu Th	104	Troyer
303-4	Adolescent Psychology			201 or GSB 253
51	4:20-6:10	Tu Th	222	Reed
305-4	Personality Dynamics			201 or GSB 253
B51	2:00-3:50	M W	105	Troyer
307-4	Social Psychology			201 or GSB 253
B1	1:00-2:50	Tu Th	AUD 103	Kuenzli
320-4	Introduction to Industrial Psychology			201 or GSB 253
E1	6:20-8:10	Tu Th	SCI 102	Banaghan
431-4	Psychopathology			12 hours of psychology or consent of instructor
51	4:20-6:10	M W	221	Dameron
479-4	Psychology of Industrial Conflict			320 or consent of instructor
4 additional sessions to be arranged				
E51	5:30-8:10	W	212A	Southwood

RADIO and TELEVISION (R—T)

273-4	Basic Radio Production		GSD 153 or consent of instructor	
B1	1:00-2:50	Tu Th	Studio	Hawkins
393-3	Radio, Television, and Society			
1	10:00-10:50	M W F	HUM 205	Lyle

SECRETARIAL and BUSINESS EDUCATION (SEC)

103-3	Typewriting II			102 or equivalent
1	11:00-11:50	MTu ThF	ANA 103	Brady
E2	8:20-10:10	Tu Th	ANA 103	staff
	10:00-10:50	MTuWTh	223	Motley
	8:20-10:10	M W	223	staff
106-4	Shorthand II			105 or equivalent
1	1:00-1:50	MTu ThF	ANA 103	Frost
E2	6:20-8:10	Tu Th	ANA 103	staff
	9:00-9:50	MTuWTh	223	Motley
	6:20-8:10	M W	223	staff
213-3	Typewriting IV			104 or equivalent
1	9:00-9:50	MTu ThF	ANA 103	Frost
E2	8:20-10:10	Tu Th	ANA 103	staff

Course No.	Hours	Descriptive Title	Time	Days	Place	Prerequisite
Alton	E. St. Louis					Instructor
	51		11:00-11:50	MTuWTh	223	Motley staff
	E52		8:20-10:10	M W	223	
308-4	Shorthand V					216 or equivalent
	1		10:00-10:50	MTu ThF	ANA 103	Frost staff
	E2		6:20-8:10	M W	ANA 103	staff
	51		1:00-1:50	MTuWTh	223	Martin
	E52		8:20-10:10	Tu Th	223	Martin
313-4	Calculating Machines					
	E1		6:20-8:10	M W	ANA 108	Brady
404-3	Teaching Shorthand and Transcription					308 or equivalent
	E51		6:20-7:45	Tu Th	223	Martin

SOCIOLOGY (SOC)

101-4	Introductory Sociology					
	1		8:00-8:50	MTuWTh	SS 200	staff
	51		8:00-8:50	MTuWTh	224	staff
102-4	Social Problems					
	1		3:00-3:50	MTuWTh	AUD 100	Remmling
	E51		6:20-8:10	M W	224	J. Schusky staff
241-4	Marriage and Parenthood					
	51		9:00-9:50	MTuWTh	224	D. Taylor
312-4	Sociological Research					101
	B1		1:00-2:50	M W	SS 105	J. Schusky
321-4	Socialization of the Individual					101
	51		11:00-11:50	MTuWTh	224	staff
322-4	Propaganda and Public Opinion					101
	1		11:00-11:50	MTuWTh	SS 200	staff
335-4	Urban Sociology					101
	1		10:00-10:50	MTuWTh	SS 105	Campbell
	51		1:00-1:50	MTuWTh	224	staff
340-4	The Family					
	51		10:00-10:50	MTuWTh	224	D. Taylor
373-4	Juvenile Delinquency					
	E1		8:20-10:10	M W	SS 105	staff
380-4	Introduction to Social Work					
	E51		8:20-10:10	Tu Th	224	staff
481-4	Processes in Social Work					380 or consent of instructor
	51		2:00-2:50	MTuWTh	224	staff

SPEECH (SPCH)

102-4	Public Speaking					GSD 153
	1		11:00-11:50	MTu ThF	ANB 102	Smith
	51		1:00-1:50	MTu ThF	112	Cornwell
104-4	Training the Speaking Voice					GSD 153
	51		11:00-11:50	MTu ThF	112	staff
202-3	Principles of Discussion					
	1		2:00-2:50	M W F	ANB 102	White
230-1 to 3	Speech Activities					
	Section 1 (Alton) for all activities other than theater. Section B51 (E. St. Louis) for theater					
	1		12:00-12:50	Tu	ANB 102	staff
			and arranged.			
	B51		12:00-12:50	Tu	AUD	Birdman
			and arranged.			
306-4	Teaching Speech in the Secondary Schools					16 hours of Speech
	E1		5:30-8:10	Th	ANB 102	White

Course No. & Hours	Descriptive Title	Days	Place	Prerequisite
Alton	E. St. Louis	Time		Instructor
330-1 to 3	Speech Activities			
Section 1 for all activities other than theater. Section B51 for theater activities				
1		12:00-12:50	Tu	ANB 102 staff
	B51	12:00-12:50	Tu	AUD Birdman

SPEECH CORRECTION (SP C)

428-4	Speech Correction for the Classroom Teacher			
4 additional sessions to be arranged				
	E51	5:30-8:10	W	113 staff

THEATER (THEA)

122-3	Production Techniques			
	51	2:00-2:50	M W F	AUD Bell
204-4	Acting			GSC 254 and consent of instructor
	51	1:00-2:50	Tu Th	AUD Birdman
310-3	Children's Theater			
	E51	6:20-7:35	M W	105 staff

For participation in speech activities, theater students should register for Speech 230 or 330.

ZOOLOGY (ZOOL)

102-5	General Invertebrate Zoology			100 or GSA 252
	Lect	2:00-2:50	Tu Th	SCI 201 Myer
	Lab 1	2:00-3:50	M W F	SCI 101 Myer
	Lab 2	2:00-3:50	M W F	SCI 100 Myer
	51	9:00-9:50	M W F	112 Woolridge
		8:00-9:50	Tu Th	116 Woolridge
300-5	Vertebrate Embryology			202
	1	10:00-10:50	Tu Th	SCI 100 Meyer
		10:00-11:50	M W F	SCI 100 Meyer
313-3	Evolution			one year of biology
	1	2:00-2:50	M W F	ANA 108 Broadbooks
382B-1/2	Zoology Seminar for Seniors			one year of biological sciences
	1	4:00-4:50	Tu	SCI 100 staff
480-3	Zoogeography			103 or consent of instructor
	E1	6:55-8:10	M W	SCI 100 Axtell

Course No. & Hours	Descriptive Title	Prerequisite
Alton	E. St. Louis	Instructor
Time	Days	Place

GENERAL STUDIES AREA A—MAN'S PHYSICAL ENVIRONMENT AND BIOLOGICAL INHERITANCE (GSA)

152-3 Introduction to Physical Science II			151	
Lect	9:00-9:50	Tu ThF	AUD 200	McAneny
Lab 1	3:00-4:50	Tu	SCI 7	McAneny
Lab 2	11:00-12:50	W	SCI 7	Zurheide
Lab 3	1:00-2:50	W	SCI 7	McAneny
Lab 4	3:00-4:50	W	SCI 7	McAneny
Lect	9:00-9:50	Tu ThF	113	staff
Lab 51	9:00-10:50	M	124	staff
Lab 52	9:00-10:50	W	124	staff
153-3 Introduction to Physical Science III			152	
Student enrolls in lecture and one lab.				
Lect	3:00-3:50	Tu ThF	AUD 200	Parrill
Lab 1	8:00-9:50	W	SCI 206	staff
Lab 2	11:00-12:50	Th	SCI 206	staff
Lab 3	11:00-12:50	F	SCI 206	staff
Lab 4	1:00-2:50	F	SCI 206	staff
Lab 5	3:00-4:50	M	SCI 206	staff
Lab 6	3:00-4:50	W	SCI 206	staff
Lect	3:00-3:50	Tu Th	113	Stallard
Lab 51	9:00-10:50	W	125	staff
Lab 52	10:00-11:50	F	125	staff
Lab 53	9:00-10:50	M	125	staff
Lab 54	12:00-1:50	F	125	staff
Lab 55	2:00-3:50	F	125	staff
Lab 56	11:00-12:50	M	125	staff
252-3 Man's Biological Inheritance			251	
Day student enrolls in lecture and one lab.				
Lect	10:00-10:50	Tu Th	SCI 102	Myer
Lab 1	10:00-11:50	M	SCI 101	Myer
Lab 2	10:00-11:50	W	SCI 101	Myer
Lect	8:20-9:10	M	105	staff
Lab 51	6:20-8:10	W	116	staff
Lab 52	8:20-10:10	W	116	staff
253-3 Man's Biological Inheritance			252 or 251	
Not open to students who have had Psysc 201. Day student enrolls in lecture and one lab.				
Lect	10:00-10:50	M W	SCI 200	Hewitson
Lab 1	10:00-11:50	Tu	SCI 101	staff
Lab 2	10:00-11:50	Th	SCI 101	staff
Lab 3	8:00-9:50	Th	SCI 101	staff
E4	6:20-8:10	M W	SCI 101	staff
Lect	3:00-3:50	M W	AUD	Davis
Lab 51	1:00-2:50	Th	116	staff
Lab 52	3:00-4:50	Th	116	staff
Lab 53	12:00-1:50	F	116	staff
255-3 Earth Science				
Option with 252-3 or 253-3.				
1	12:00-12:50	Tu Th	SCI 200	Baker
	12:00-1:50	F	ANA 110	Baker
2	12:00-12:50	Tu Th	SCI 200	Baker
	2:00-3:50	F	ANA 110	Baker
E3	6:20-7:45	Tu Th	ANA 104	Vogel
51	1:00-1:50	Tu Th	225	Schwartz
	1:00-2:50	F	225	Schwartz
52	1:00-1:50	Tu Th	225	Schwartz
	1:00-2:50	W	225	Schwartz

EDWARDSVILLE CAMPUIS 1961 SPRING QUARTER

Course No. & Hours	Descriptive Title	Days	Place	Prerequisite	Instructor
Alton	E. St. Louis	Time			
GSA 255 (Continued)					
	E53	8:20-9:35	Tu Th	225	staff
358-3	Analysis of Physical Systems I	9 hours of math	Tu Th	SCI 3	Boedeker
	1	9:00-9:50		SCI 7	Boedeker
		9:00-10:50	F		
363-3	Philosophy of Science				
	B1	1:00-2:25	M W	HUM 205	Morrison

GENERAL STUDIES AREA B—MAN'S SOCIAL INHERITANCE AND SOCIAL RESPONSIBILITIES (GSB)

151-3	Survey of Western Tradition—Geographic Background				
	1	8:00-9:15	Tu Th	ANA 104	Baker
	2	12:00-1:15	Tu Th	ANA 104	Channer
	51	8:00-8:50	M W F	113	Guffy
152-3	Introduction to the Western Tradition				151
	1	2:00-2:50	M W F	ANA 104	Kimball
	2	3:00-3:50	M W F	ANA 104	staff
	51	11:00-11:50	M W F	113	Keleher
	E52	6:20-7:35	Tu Th	113	Keleher
153-3	Introduction to the Western Tradition				152
	1	12:00-12:50	M W F	AUD 200	staff
	2	2:00-2:50	M W F	AUD 200	staff
	E3	6:20-7:35	Tu Th	SCI 200	staff
	51	12:00-12:50	M W F	AUD	staff
	E52	8:20-9:35	M W	104	Haas
251-3	The Study of Man: Culture, Society, and the Individual				
	1	12:00-1:15	Tu Th	AUD 200	E. Schusky
	51	1:00-1:50	M W F	AUD	Culbert
252-3	The Study of Man: Culture, Society, and the Individual				251
	1	8:00-8:50	M W F	AUD 100	staff
	E2	6:20-7:35	M W	AUD 100	Campbell
	51	8:00-8:50	M W F	224	Rudwick
	E52	8:20-9:35	M W	103	staff
253-3	The Study of Man: Culture, Society, and the Individual				
	1	10:00-10:50	M W F	AUD 200	Kuenzli
	E2	5:30-8:10	Tu	AUD 200	staff
	51	10:00-10:50	M W F	AUD	Dameron
	E52	5:30-8:10	M	105	staff
255-3	Political Economy I				
	E1	6:20-7:35	M W	ANA 104	staff
	E51	8:20-9:35	M W	106	Cohen
256-3	Political Economy II				255
	1	11:00-11:50	M W F	ANB 201	Kerr
	51	9:00-9:50	M W F	105	Stahnke
257-3	Political Economy III				256
	1	12:00-12:50	M W F	ANA 104	Mace
	E2	6:20-7:35	Tu Th	SCI 201	staff
	51	12:00-1:15	M W	212	Luan
	E52	8:20-9:35	M W	113	staff
331-3	The American Educational Systems				
	B1	11:00-12:25	Tu Th	ANB 201	Wheat
	2	4:45-6:10	M W	AUD 103	Wheat
	B51	12:00-1:25	M W	103	Jung
	E52	5:30-8:10	W	124A	Schmid
357-3	Economic Development of the United States (Replaces Econ 317-4)				
	E1	8:20-9:35	Tu Th	ANB 101	staff
	51	9:00-9:50	M W F	103	Sauber

Course No. & Hours	Descriptive Title	Prerequisite
Alton	E. St. Louis	Instructor
Time	Days	Place

GENERAL STUDIES AREA C—MAN'S INSIGHTS AND APPRECIATIONS (GSC)

151-3 Introduction to Poetry		Recommended; GSD 151, 152	
1	8:00-8:50	MTu F	AUD 101 staff
2	11:00-11:50	MTu F	AUD 102 staff
3	1:00-1:50	MTu F	AUD 102 staff
4	2:00-2:50	M W F	AUD 102 staff
5	9:00-9:50	M W F	AUD 101 staff
6	9:00-9:50	M W F	AUD 100 staff
7	10:00-10:50	M W F	AUD 102 staff
8	11:00-11:50	M W F	AUD 101 staff
9	12:00-12:50	M W F	AUD 101 staff
10	1:00-1:50	M W F	AUD 101 staff
11	2:00-2:50	M W F	AUD 101 staff
12	2:00-2:50	M W F	AUD 100 staff
13	3:00-3:50	M W F	AUD 101 staff
E14	6:20-7:35	M W	AUD 102 staff
E15	6:20-7:35	Tu Th	AUD 102 staff
	51	9:00-9:50	MTu F 222 staff
	52	11:00-11:50	M W F 222 staff
	53	1:00-1:50	M W F 201B staff
	54	8:00-8:50	M W F 201B staff
	55	9:00-9:50	M W F 201B staff
	56	10:00-10:50	M W F 201B staff
	57	12:00-12:50	MTu ThF 222 staff
	58	1:00-1:50	MTu ThF 105 staff
	59	2:00-2:50	MTu ThF 222 staff
	E60	6:20-7:35	M W 222 staff
	E61	8:20-9:35	M W 201B staff
	E62	6:20-7:35	Tu Th 222 staff
152-3 Logic			
Day student enrolls in lecture and one quiz section.			
Lect	10:00-10:50	Tu Th	ANA 104 Morrison
1	3:00-3:50	M	AUD 100 Morrison
2	3:00-3:50	W	AUD 100 Morrison
3	3:00-3:50	F	AUD 100 Morrison
E4	8:20-9:35	Tu Th	AUD 100 Shea
Lect	11:00-11:50	Tu Th	113 Linden
51	11:00-11:50	M	201B Linden
52	11:00-11:50	W	201B Linden
53	11:00-11:50	F	201B Linden
E54	8:20-9:35	Tu Th	201B Runkle
153-3 Art Appreciation			
1	10:00-10:50	M W F	FAA 100 staff
2	1:00-1:50	M W F	FAA 100 Huntley
E3	6:20-7:35	M W	FAA 100 Richardson
51	9:00-9:50	M W F	221 Kemper
52	2:00-3:15	Tu Th	221 staff
53	4:20-5:35	Tu Th	221 staff
154-3 Music Understanding			
	1:00-1:50	M W F	AUD 200 Tulloss
51	2:00-2:50	M W F	212 Warren
253-3 Literary and Philosophical Masterpieces III			
E1	6:20-7:35	M W	AUD 200 Ades
2	4:00-4:50	M W F	AUD 200 Shea
E51	8:20-9:35	Tu Th	113 Murdoch
52	2:00-2:50	M W F	113 Hornback

Course No. & Hours	Descriptive Title	Alton	E. St. Louis	Time	Days	Place	Prerequisite Instructor
254-3	Introduction to the Theater		51	1:00-1:50	M W F	112	Birdman
255-3	Music in History						
	1			11:00-11:50	M W F	FAC 203	Warren
			51	11:00-11:50	Tu Th	212	staff
353-4	History of World Art III						9 hours second level GSC
	1			12:00-12:50	MTuWTh	FAA 100	Richardson
355-3	History of the Modern Theater		51	3:00-3:50	M W F	106	Birdman
363-3	Philosophy of Science						254
	B1			1:00-2:25	M W	HUM 205	Morrison

GENERAL STUDIES AREA D—ORGANIZATION AND COMMUNICATION OF IDEAS (GSD)

151-3	English Composition						A.C.T. score necessary for all sections
	1B			8:00-8:50	MTu ThF	AUD 102	staff
	2B			3:00-3:50	MTu ThF	AUD 102	staff
	E3B			8:20-10:10	Tu Th	AUD 102	staff
			51B	8:00-8:50	MTu ThF	222	staff
			52B	3:00-3:50	MTu ThF	222	staff
			E53B	8:20-10:10	M W	222	staff
152-3	English Composition						151
	1B			9:00-9:50	MTu ThF	AUD 102	staff
	2B			12:00-12:50	MTu ThF	AUD 102	staff
	E3B			8:20-10:10	M W	AUD 102	staff
			51B	10:00-10:50	MTu ThF	222	staff
			52B	1:00-1:50	MTu ThF	222	staff
			E53B	8:20-10:10	Tu Th	222	staff
153-3	Oral Communication of Ideas						
	Day student enrolls in lecture and one practice session.						
	Lect			11:00-11:50	Tu	AUD 200	Hawkins
	1			8:00-8:50	M W F	ANB 101	Hawkins
	2			9:00-9:50	M W F	ANB 101	White
	3			9:00-9:50	M W F	ANB 201	staff
	4			10:00-10:50	M W F	ANB 201	staff
	5			10:00-10:50	M W F	ANB 202	White
	6			11:00-11:50	M W F	ANB 101	Smith
	7			1:00-1:50	M W F	ANB 101	Smith
	8			2:00-2:50	M W F	ANB 102	staff
	9			3:00-3:50	M W F	ANB 202	Smith
	10			4:20-6:00	M W	ANB 101	staff
	E11			6:20-8:00	Tu Th	ANB 101	staff
	Lect			11:00-11:50	Th	AUD	Hawkins
			51	8:00-8:50	M W F	106	Bell
			52	9:00-9:50	M W F	106	Cornwell
			53	10:00-10:50	M W F	106	Birdman
			54	10:00-10:50	M W F	105	Cornwell
			55	11:00-11:50	M W F	106	Bell
			56	1:00-1:50	M W F	106	Cornwell
			57	2:00-2:50	M W	106	staff
			58	4:20-6:00	M W	202A	staff
			E59	6:20-8:00	Tu Th	106	staff
156-3	Introduction to Mathematics						155
	Day student enrolls in lecture and one lab.						
	Lect			8:00-8:50	Tu ThF	SCI 102	Forcade
	1			8:00-8:50	M W	S&T 101	staff
	2			9:00-9:50	M W	S&T 101	staff
	E3			6:20-8:10	M W	S&T 101	Gwillim

Course No. & Hours	Descriptive Title	Time	Days	Place	Prerequisite Instructor
Alton	E. St. Louis				
	Lect	8:00-8:50	M W F	212	Williams
	51	8:00-8:50	Tu Th	106	staff
	52	12:00-12:50	M W	205	staff
	53	12:00-12:50	Tu Th	205	staff
	E54	8:20-10:10	Tu Th	104	Rutledge
157-3	Introduction to Mathematics				156
	Day student enrolls in lecture and one lab.				
	Lect	8:00-8:50	M W F	ANA 104	Phillips
	1	8:00-8:50	Tu Th	S&T 101	staff
	2	8:00-8:50	Tu Th	SCI 201	staff
	3	8:00-8:50	Tu Th	AUD 100	staff
	4	2:00-2:50	Tu Th	SCI 201	Phillips
	E5	8:20-10:10	Tu Th	SCI 103	Broadbooks
	Lect	8:00-8:50	Tu ThF	AUD	Bennewitz
	51	8:00-8:50	M W	112	staff
	52	8:00-8:50	M W	202B	staff
	53	12:00-12:50	M W	112	staff
	54	12:00-12:50	Tu Th	112	staff
	E55	8:20-10:10	M W	112	staff
165-3	College Algebra II				
	1	3:00-3:50	M W F	SCI 3	staff
	E51	8:20-9:35	Tu Th	124A	Wang
175-3	Elementary French				174
	One hour of lab per week to be arranged.				
	1	10:00-10:50	MTu Th	HUM 100	staff
	2	11:00-11:50	MTu Th	HUM 100	staff
	3	2:00-2:50	MTu Th	HUM 100	staff
	4	4:20-5:35	M W	HUM 100	staff
	E5	8:20-9:35	M W	HUM 100	staff
178-3	Elementary German				177
	One hour of lab per week to be arranged.				
	1	10:00-10:50	MTu Th	SCI 3	staff
	2	1:00-1:50	MTu Th	SCI 3	staff
	3	2:00-2:50	MTu Th	SCI 200	staff
	E4	6:20-7:45	Tu Th	HUM 100	staff
	51	9:00-9:50	MTu Th	212	staff
	52	10:00-10:50	MTu Th	202B	staff
	53	3:00-3:50	MTu Th	201B	staff
	E54	8:20-9:35	M W	202B	staff
188-3	Elementary Russian				187
	One hour of lab per week to be arranged.				
	B1	1:00-2:25	Tu Th	HUM 205	staff
	E51	8:20-9:35	Tu Th	202B	staff
192-3	Elementary Spanish				191
	One hour of lab per week to be arranged.				
	1	11:00-11:50	MTu Th	SCI 102	staff
	2	3:00-3:50	MTu Th	HUM 100	staff
	51	1:00-1:50	MTu Th	224	staff
	E52	6:20-7:35	Tu Th	201B	staff

GENERAL STUDIES AREA E—HEALTH AND PHYSICAL DEVELOPMENT (GSE)

251-3	Healthful Living				
	1	11:00-11:50	M W F	AUD 200	Spear
	51	1:00-1:50	M W F	204	Klein
	E52	4:55-6:10	M W	103	Klein

See physical education (PEM and PEW) for required physical education courses.

Course No. & Hours	Descriptive Title	Alton	E. St. Louis	Time	Days	Place	Prerequisite Instructor
--------------------	-------------------	-------	--------------	------	------	-------	-------------------------

ACCOUNTING (ACCT)

252-4	Elementary Accounting II						251
	1			11:00-11:50	MTu ThF	ANA 100	Milles
	E2			6:20-8:10	Tu Th	ANA 100	staff
		E51		8:20-10:10	M W	221	Terre
253-4	Elementary Accounting III						252
	1			8:00-8:50	MTu ThF	ANA 100	Dwyer
	2			10:00-10:50	MTu ThF	ANA 100	Dwyer
	3			2:00-2:50	MTu ThF	ANA 100	Milles
	E4			6:20-8:10	M W	ANA 100	staff
	E5			8:20-10:10	Tu Th	ANA 100	staff
		51		9:00-9:50	MTuWTh	203	Bedel
		52		11:00-11:50	MTu ThF	203	Bedel
		53		2:00-2:50	MTu ThF	203	Terre
		E54		6:20-8:10	M W	203	Terre
		E55		8:20-10:10	Tu Th	221	Small
353-4	Advanced Accounting III						253
	1			12:00-12:50	MTuWTh	ANA 100	Schmitt
	E2			8:20-10:10	M W	ANA 100	staff
		51		1:00-1:50	MTu ThF	203	Davison
		E52		6:20-8:10	Tu Th	221	Bedel
355-3	Governmental Accounting						253
		E51		5:30-8:10	M	201A	Davison
356-5	Auditing					353 or consent of instructor	
	1			11:00-11:50	MTuWThF	ANA 101	Dwyer
		51		10:00-10:50	MTuWThF	203	Davison
432-4	Problems in Federal Taxation						331
	E1			6:20-8:10	Tu Th	ANA 101	Milles
		51		3:00-3:50	MTuWTh	203	Small
442-4	Advanced Cost Accounting						341
	B1			1:00-2:50	M W	ANA 108	Schmitt
		E51		6:20-8:10	Tu Th	212A	Small
458-4	Accounting Systems						341 and 353
	B1			9:00-10:50	M W	ANA 108	Schmitt

ANTHROPOLOGY (ANTH)

314-4	Indians of North America						
	B1			1:00-2:50	M W	SS 105	E. Schusky
409-4	Anthropology and Modern Life						
	E1			8:20-10:10	M W	SS 105	staff

APPLIED SCIENCE (AP SCI)

ART (ART)

206-4	Descriptive Geometry						205
	1			10:00-11:50	MTuW F	ANA 109	Bishop
		E51		6:00-9:50	Tu Th	203	staff
262-3	Analytical Mechanics (Dynamics II)						261
	E1			8:20-9:35	Tu Th	ANA 109	staff
		E51		8:20-9:35	M W	203	staff
264-4	Surveying II						263
	1			1:00-1:50	Tu Th	ANA 109	staff
				2:00-5:00	Tu Th	ANA 109	staff
100-5	Basic Studio						
	1			2:00-3:50	MTuWTh	FAA 102	Huntley
				2:00-2:50	F	FAA 102	Huntley

Course No. & Hours	Descriptive Title	Alton	E. St. Louis	Time	Days	Place	Prerequisite Instructor
E2				6:20-9:50	Tu Th	FAA 202	Huntley
	51			1:00-2:50	MTu ThF	214	Milovich
				1:00-1:50	W	214	Milovich
203-4	Beginning Ceramics						15 hours of 100
1				10:00-11:50	MTuW F	Gym 10	Howerton
300-4	Art Education						For elementary education majors and art education majors
							Student may elect up to 12 hours. (Sec. 1 and 51: 1st four hours, Sec. 2 and 52: 2nd four hours, Sec. 3: 1st four hours, Sec. 4 and 53: 3rd four hours)
1				9:00-10:50	M W F	FAA 200	Buddemeyer
2				1:00-2:50	M W F	FAA 200	Buddemeyer
3				4:20-7:00	M W	FAA 200	Buddemeyer
4				Arranged	Arranged	FAA 200	Buddemeyer
	51			10:00-11:50	M W F	214	Milovich
	52			4:20-7:00	M W	214	Milovich
	53			Arranged	Arranged	214	Milovich
305-4	Advanced Ceramics						8 hours of 203
1				1:00-2:50	MTuW F	Gym 10	Howerton
E2				6:20-9:50	Tu Th	Gym 10	Howerton
310-4	Oil Painting						8 hours of 201
1				1:00-2:50	MTuWTh	FAA 202	staff
324-4	Watercolor						8 hours of 201
1				8:00-9:50	MTuWTh	FAA 102	staff
325-4	Studio						Consent of instructor
1				Arranged	Arranged	Arranged	staff
358-4	Prints						8 hours of 201
1				10:00-11:50	MTuWTh	FAA 103	Richardson
406-4	Studio in Painting						Consent of art faculty
1				Arranged	Arranged	Arranged	staff
416-4	Studio in Prints						Consent of art faculty
1				Arranged	Arranged	Arranged	Richardson
426-4	Studio in Pottery						Consent of art faculty
1				Arranged	Arranged	Arranged	Howerton

BOTANY (BOT)

203-5	Taxonomy of Local Seed Plants						
1				Arranged	Arranged	Arranged	staff
321-3	Elementary Botanical Microtechnique						Consent of instructor
	E51			6:00-9:00	Tu Th	114	Davis

CHEMISTRY (CHEM)

112-5	Chemical Principles and Inorganic Chemistry						111
1				12:00-12:50	M W F	SCI 200	Firshing
				12:00-12:50	Th	SCI 201	
				12:00-2:50	Tu	SCI 206	
	E51			6:20-8:10	Tu Th	112	Stallard
				9:00-12:00	Saturday	125	Stallard
113-5	Inorganic and Qualitative Analysis						112
	Student enrolls in lecture and one lab.						
	Lect			8:00-8:50	M W	SCI 201	Cliff
	Lab 1			8:00-8:50	F	SCI 201	Bardolph
				8:00-10:50	Tu Th	SCI 206	Bardolph
	Lab 2			12:00-12:50	F	SCI 200	Cliff
				12:00-2:50	M W	SCI 206	Cliff
	Lect			12:00-12:50	M W F	113	Rands
	Lab 51			1:00-3:50	M W	125	Rands
	Lab 52			12:00-2:50	Tu Th	125	Rands

Course No. & Hours	Descriptive Title	Days	Place	Prerequisite
Alton	E. St. Louis	Time		Instructor
338-4	Analytical Chemistry			337
E. St. Louis student enrolls in lecture and one lab.				
1		3:00-3:50	Tu Th	SCI 201
		1:00-3:50	M F	SCI 207
	Lect	5:55-6:45	M W	112
	Lab E51	Arranged	Arranged	Arranged
	Lab E52	Arranged	Arranged	Arranged
343-5	Organic Chemistry			341
E. St. Louis student enrolls in lecture and one lab.				
E1		6:20-7:35	M W	SCI 201
		7:45-10:35	M W	SCI 207
	Lect	10:00-10:50	M W F	112
	Lab 51	8:00-10:50	Tu Th	123
	Lab 52	1:00-3:50	M W	123
375-1 to 3	Chemistry Seminar			Senior standing
1		4:00-4:50	M	SCI 201
	51	Arranged	Arranged	Arranged
432-4	Instrumental Analytical Techniques			337, 461
Laboratory arranged.				
	51	1:00-1:50	Tu Th	112
446-4	Qualitative Organic Chemistry			343
1		2:00-2:50	M W	SCI 201
		1:00-3:50	Tu Th	SCI 207
463-4	Physical Chemistry			462
Student enrolls in lecture and one lab.				
	Lect	11:00-11:50	M W F	SCI 201
	Lab 1	9:00-11:50	Th	SCI 203
	Lect	10:00-10:50	M W F	124a
	Lab 51	1:00-3:50	Tu	123
	Lab 52	1:00-3:50	Th	123

COMPARATIVE LITERATURE (C LT)

313-4	Comparative Literature: Prose			Sophomore literature requirement
	B1	1:00-2:50	Tu Th	LL 201
314-4	The Development of Tragedy			Sophomore literature requirement
	1	4:20-6:10	Tu Th	SS 105

ECONOMICS (ECON)

205-5	Survey of Economic Principles			Sophomore standing
(Last year to be offered)				
	1	11:00-11:50	MTuWThF	ANA 104
	51	2:00-2:50	MTuWThF	103
206-4	Economic Principles and Problems			205
(Last year to be offered)				
	1	2:00-2:50	MTu ThF	SCI 2
	E2	8:20-10:10	M W	ANA 101
	51	8:00-8:50	MTuW F	221
	E52	8:20-10:10	Tu Th	103
307-4	Economic and Business Statistics I			205; recommended, Math 106
	E1	5:55-8:10	Tu Th	ANA 110
	E51	5:55-8:10	Tu Th	103
310-4	Labor Problems			206, or 205 and consent of instructor
	1	9:00-9:50	MTuWTh	ANA 100
	E51	6:20-8:10	M W	221
315-4	Money and Banking I			205
	E1	8:20-10:10	M W	ANB 101
	51	11:00-11:50	MTuW F	224

Course No. & Hours	Descriptive Title	Alton	E. St. Louis	Time	Days	Place	Prerequisite	Instructor
328-4	International Economics I					206, or 205	& consent of instructor	
B1				1:00-2:50	M W	ANA 101		Glynn
330-4	Public Finance I: National					206, or 205	& consent of instructor	
I				10:00-10:50	MTu ThF	ANB 101		Schwier
436-3	Government and Labor					205, Gov 101 or 190 or 231 or 300	or consent of instructor	
	B51			10:00-11:25	Tu Th	201A		Sauber
470-3	Business Cycles					315 or consent of instructor		
B1				11:00-12:25	M W	ANB 202		Van Dahm
	E51			5:30-8:10	W	212A		Luan

EDUCATION—ADMINISTRATION (ED AD)

355-4	Philosophy of Education							
E1				8:20-10:10	Tu Th	ANB 201		Curry
B2				1:00-2:50	Tu Th	ANB 201		Curry
	B51			10:00-11:50	M W	212		Schmid
	52			4:20-6:10	M W	224		Lee
431-4	History of Education in the United States							
	4 additional sessions to be arranged.							
	E51			5:30-8:10	M	124A		Curry
456-4	School Supervision							
	4 additional sessions to be arranged.							
	E1			5:30-8:10	Th	SCI 3		Wheat
500-4	Research Methods					Guid 420 or 422 recommended		
E1				5:30-8:10	M	ED 100		Brubaker
	S51			9:00-11:40	Saturday	201A		Steinkellner
520-4	Illinois School Law							
S1				9:00-11:40	Saturday	S&T 101		Smith
554-4	Contrasting Philosophies of Education							
E51				5:30-8:10	Th	116		staff
563-4	Workshop in School Public Relations							
E1				5:30-8:10	Tu	ANA 108		Lee

EDUCATION—ELEMENTARY (ED EL)

203-3	Understanding the Elementary School Child					Psyc 201 or GSB 253		
	2 hours per week observation arranged. Transportation is the responsibility of the student.							
1				2:00-2:50	Tu Th	S&T 101		Carpenter
	51			2:00-2:50	Tu Th	105		Kelley
314-4	Elementary School Methods						Guid 305	
E51				6:20-8:10	Tu Th	105		Kelley
316-4	Kindergarten-Primary Methods and Curriculum						Guid 305	
1				4:20-6:10	M W	S&T 101		Kelley
337-4	Reading in the Elementary Schools					314 or 316, & Guid 305		
1				4:20-6:10	Tu Th	S&T 101		Bear
350D-8 to 12	Kindergarten-Primary Student Teaching						Must apply to Education Division two quarters in advance	
1				6:20-8:10	F	S&T 101		Steinbrook
	51			6:20-8:10	F	103		Steinbrook
350E-4 to 8	Advanced Kindergarten-Primary Student Teaching						350D	
1				6:20-8:10	F	S&T 101		Steinbrook
	51			6:20-8:10	F	103		Steinbrook
351D-8 to 16	Elementary Student Teaching						Must apply to Education Division two quarters in advance	
	Sections 2 & 52 only for students enrolled in Ed. Sp. 420.							
1				6:20-8:10	F	S&T 101		Steinbrook
2				6:20-8:10	F	S&T 101		Steinbrook
	51			6:20-8:10	F	103		Steinbrook
	52			6:20-8:10	F	103		Steinbrook

Course No. & Hours	Descriptive Title	Alton	E. St. Louis	Time	Days	Place	Prerequisite Instructor
351E-4 to 8	Advanced Elementary Student Teaching						351D
1				6:20-8:10	F	S&T 101	Steinbrook
			51	6:20-8:10	F	103	Steinbrook
442-4	Materials and Methods in Elementary School Science						
	4 additional sessions to be arranged.						
E1				5:30-8:10	Tu	SCI 3	Bliss
521-4	Diagnosis and Correction of Reading Disabilities					337 or 505. Not open to students who have had 437	
E1				5:30-8:10	M	SS 200	Bear
541-4	Selected Teaching and Curriculum Problems in Elementary School Science						No credit for students who have had 442
E1				5:30-8:10	Tu	SCI 3	Bliss
542-4	Language Arts in the Elementary School						
E51				5:30-8:10	Th	201A	Steinkellner
543-4	Teaching the Social Studies in the Elementary School						
E51				5:30-8:10	W	105	Carpenter
557-4	The Elementary Principalship						
E51				5:30-8:10	Tu	201A	staff

EDUCATION—SECONDARY (ED SEC)

315-4	High School Methods						Guid 305
B1				1:00-2:50	Tu Th	ANB 102	Smyers
	E51			6:20-8:10	M W	104	Bliss
352D-8 to 12	Secondary Student Teaching						Must apply to Education Division two quarters in advance
1-26				6:20-8:10	F	S&T 101	Steinbrook
	51-76			6:20-8:10	F	103	Steinbrook
1	51			Agriculture			
2	52			Art			
3	53			Biology			
4	54			Business			
5	55			Chemistry			
6	56			Economics			
7	57			English			
8	58			Foreign Language			
9	59			General Science			
10	60			Geography			
11	61			Government			
12	62			Health Education			
13	63			History			
14	64			Home Economics			
15	65			Industrial Education			
16	66			Journalism			
17	67			Mathematics			
18	68			Music			
19	69			Physical Education			
20	70			Physics			
21	71			Sociology			
22	72			Social Studies			
23	73			Speech			
24	74			Library Service			
25	75			Psychology			
26	76			School Nursing			
352E-4 to 8	Secondary Student Teaching						352D
	(See above list under 352D)						
1-26				6:20-8:10	F	S&T 101	Steinbrook
	51-76			6:20-8:10	F	103	Steinbrook

Course No. & Hours	Descriptive Title	Time	Days	Place	Prerequisite Instructor
Alton	E. St. Louis				
407-4	The Junior High School				
	4 additional sessions to be arranged.				
	E1	5:30-8:10	M	ANB 201	M. Hileman
521-4	Diagnosis and Correction of Reading Disabilities				Ed. El. 337 or 505.
	Not open to students who have had Ed. El. 437				
	E1	5:30-8:10	M	SS 200	Bear
550-4	Core Curriculum in the Secondary School				
	E51	5:30-8:10	W	212	Schmid

EDUCATION—SPECIAL (ED SP)

414-4	The Exceptional Child				Guid 305 or Psyc 301 or 303
	4 additional sessions to be arranged.				
	E1	5:30-8:10	M	ANA 110	Johnson
420-4	Methods and Materials for Teaching Exceptional Children				410. Must be taken with Ed. El. 351D
	4 additional sessions to be arranged				
	1	4:20-6:50	Tu	ED 100	Tucker
428-4	Speech Correction for the Classroom Teacher				
	Meets with Speech Correction 428.				
	E1	5:30-8:10	Th	ANB 201	White staff
	E51	5:30-8:10	Th	AUD	

ENGLISH (ENG)

310-4	A Survey of American Literature Since 1860				
	1	11:00-11:50	MTu ThF	AUD 100	Zanger
	E2	6:20-8:10	Tu Th	AUD 100	Doepke
	51	9:00-9:50	MTu ThF	202B	Hornback
317-4	English Literature After 1750				
	1	10:00-10:50	MTu ThF	AUD 101	Duncan
	51	9:00-9:50	MTu ThF	204	Graham
	E52	6:20-8:10	M W	201B	Allen
365-4	Shakespeare				
	B51	12:00-1:50	M W	202B	Revard
391-3	Usage in Spoken and Written English				
	51	12:00-12:50	M ThF	201B	Revard
403-4	The English Language				
	B51	2:00-3:50	M W	202B	Austin
404-4	Contemporaries and Successors of Chaucer				
	1	1:00-1:50	MTu ThF	AUD 101	Mogan
441-4	The Eighteenth Century Essay				
	1	4:20-6:10	Tu Th	AUD 100	Slattery
459-4	Contemporary American Fiction				
	1	4:20-6:10	Tu Th	AUD 102	Zanger
492-4	Professional Writing I				Consent of instructor
	51	4:20-6:10	M W	AUD 102	Mooney
511-4	Studies in the Renaissance				
	E51	6:20-8:10	M W	204	M. W. Taylor
538-4	Problems in American Literature				
	51	4:20-6:10	Tu Th	222	McDermott
566-4	Studies in Shakespeare				
	E1	6:20-8:10	Tu Th	S&T 102	M. A. Taylor

FOREIGN LANGUAGES

French (Fr)

175c-1	French Conversation				Current enrollment in GSD 175 staff
	1	10:00-10:50	F	HUM 100	

Course No. & Hours	Descriptive Title	Time	Days	Place	Prerequisite Instructor
Alton	E. St. Louis				
Fr 175c (Continued)					
2		11:00-11:50		F	HUM 100 staff
3		2:00-2:50		F	HUM 100 staff
4		4:20-5:10		F	HUM 100 staff
E5		9:45-10:10	M W		HUM 100 staff
203-3	Intermediate Course				202
Offered only at Alton.					
1		9:00-9:50	M W F		S&T 102 staff
220-2	French Conversation				Consent of instructor
1		9:00-9:50	Tu Th		S&T 102 staff
304-3	French Contemporary Novel				203 or consent of instructor
1		11:00-11:50	MTu Th		HUM 205 Pellegrino
313-4	Survey of French Literature				203 or consent of instructor
1		4:20-6:10	Tu Th		AUD 103 Heisner

German (Ger)

178c-1	German Conversation				Current enrollment in GSD 178
1		10:00-10:50		F	SCI 3 staff
2		1:00-1:50		F	SCI 3 staff
3		2:00-2:50		F	SCI 200 staff
E4		7:45-8:10	Tu Th		HUM 100 staff
	51	9:00-9:50		F	212 staff
	52	10:00-10:50		F	202B staff
	53	3:00-3:50		F	201B staff
	E54	9:45-10:10	M W		202B staff
203-3	Intermediate Course				202
1		4:20-5:35	M W		HUM 205 staff
	51	2:00-2:50	M W F		124A staff
220-2	Advanced German Conversation				Consent of instructor
1		4:20-6:10		F	SS 105 Asmyte
303-4	German "Novelle" in the 19th and 20th Centuries				203 or consent of instructor
1		4:20-6:10	M W		SS 105 Guenther
313-4	German Drama in the 19th Century				203 or consent of instructor
1		4:20-6:10	Tu Th		HUM 100 Asmyte

Russian (Russ)

188c-1	Russian Conversation				Current enrollment in GSD 188
1		2:25-2:50	Tu Th		HUM 205 staff
	E51	9:45-10:10	Tu Th		202B staff
203-3	Intermediate Course				202
Offered only at East St. Louis.					
	51	4:20-5:35	M W		222 staff
220-2	Russian Conversation				GSD 188
	51	4:20-5:35		F	222 staff

Spanish (Span)

192c-1	Spanish Conversation				Current enrollment in GSD 192
1		11:00-11:50		F	SCI 102 staff
2		3:00-3:50		F	HUM 100 staff
	51	1:00-1:50		F	224 staff
	E52	7:45-8:10	Tu Th		201B staff
203-3	Intermediate Course				202
Offered only at East St. Louis.					
	51	4:20-5:45	M W		201B staff
220-2	Spanish Conversation				Consent of instructor
	51	4:20-6:10		F	201B staff
313-4	Survey of Spanish Literature				203
Offered only at Alton.					
	B1	1:00-2:50	M W		S&T 102 Goode

Course No. & Hours	Descriptive Title	Time	Days	Place	Prerequisite
Alton	E. St. Louis				Instructor
315-3	<i>Arte y Cultura</i>				203
	Offered only at East St. Louis.				
	B51	2:00-3:25	Tu Th	224	staff

GEOGRAPHY (GEOG)

211-5	Economic Geography				
	1	11:00-11:50	MTuWThF	ANA 110	Kazeck
	51	11:00-11:50	MTuWThF	225	Schwartz
310-4	Meteorology			GSB 151 or equivalent	
	51	9:00-9:50	MTuW F	225	Guffy
311-4	Geography of Soils			101 or consent of instructor	
	E51	6:20-8:10	M W	225	Guffy
312-4	Regional Climatology			GSB 151 or equivalent	
	1	10:00-10:50	MTuW F	ANA 110	Kazeck
313-3	Geography of Illinois			GSB 151 or equivalent	
	51	10:00-10:50	M W F	225	Schwartz
314-4	Geography of Anglo-America			GSB 151 or equivalent	
	1	2:00-2:50	MTuWTh	ANA 110	Vogel
315-4	Geography of Europe			GSB 151 or equivalent	
	1	3:00-3:50	MTuWTh	ANA 110	Channer
322-3	Geography of the Pacific				
	1	12:00-1:15	M W	ANA 110	Mookerjee
324-4	Restoration and Conservation of Natural Resources				
	1	9:00-9:50	MTuWTh	ANA 110	Vogel
	51	12:00-12:50	MTuWTh	225	Snaden
411-4	Urban Geography			GSB 151, 211 or consent of instructor	
	B51	2:00-3:50	M W	221	Snaden
413-3	Geography of Caribbean Lands			GSB 151 or equivalent	
	E1	5:30-8:10	W	ANA 110	Channer
420-4	Geography of Africa			GSB 151 or equivalent	
	E51	8:20-10:10	M W	225	staff
430-4	Physiographic Provinces of North America				314
	E51	6:20-8:10	Tu Th	225	Guffy
470C-4	Field Problems in Urban and Regional Planning (Same as Gov 470C-4.)				
475-4 to 8	Methods of Field Geography			Geog 101 plus 15 additional hours	
				in Geog or consent of instructor	
	S51	8:00-12:00	Saturday	Edwardsville	Snaden
522-3	Seminar in Regional Geography			12 hours of Geog	
	E51	8:20-9:35	M W	204A	Mookerjee
530-3	Independent Studies in Geography			12 hours of Geog	
	E1	8:20-9:35	M W	ANA 110	Baker

GOVERNMENT (GOV)

210-4	American Government				
	E1	6:20-8:10	Tu Th	AUD 101	Schwab
	E51	6:20-8:10	Tu Th	205	Stahnke
340-3	The Legislative Process			190 or equivalent	
	1	10:00-10:50	M W F	SCI 102	Goodman
370-4	International Relations				243
	B51	2:00-3:50	M W	112	Glaser
380-4	Political Parties			190 or equivalent	
	B1	1:00-2:50	M W	ANB 202	Goodman
390-5	Principals of Comparative and Foreign Governments			190 or equivalent	
	51	12:00-12:50	MTuWThF	224	Stahnke
435-4	Government and Business			190 or equivalent	
	E1	6:20-8:10	M W	ANB 202	Lovell

Course	No. & Hours	Descriptive Title	Days	Place	Prerequisite
Alton	E. St. Louis	Time			Instructor
461-4		Organizational Theory and Public Administration		360 or concurrent registration	
	51	1:00-1:50	MTuWTh	212A	Schwab
470C-4		Field Problems in Urban and Regional Planning		Consent of instructor	
	B51	2:00-3:50	M W	212A	Mann
473-3		Metropolitan Studies and Research		360 or 465 or consent of instructor	
	E51	5:30-8:10	W	201A	Mann
486-4		Contemporary Political Theories (Same as Phil 486.)		6 hours of Government	
	1	8:00-8:50	MTuWTh	SS 105	Mace
496-4		Constitutional Law II		190 or equivalent	
	1	9:00-9:50	MTuWTh	SS 105	Kerr

GUIDANCE (GUID)

305-4		Educational Psychology		Psyc 201 or GSB 253	
	4	additional sessions to be arranged (section S51 only)			
	1	9:00-9:50	MTu ThF	ANA 101	staff
	E2	6:20-8:10	Tu Th	ANB 102	Soper
	B3	1:00-2:50	Tu Th	ANB 202	staff
	S51	9:00-11:40	Saturday	103	Troyer
	52	4:20-6:10	Tu Th	105	Southwood
412-4		Mental Hygiene			305
	4	additional sessions to be arranged.			
	S1	9:00-11:40	Saturday	AUD 100	staff
420-4		Educational Statistics			305
	4	additional sessions to be arranged.			
	E51	5:30-8:10	M	116	staff
422-4		Educational Measurements I			305
	4	additional sessions to be arranged (sections S3 & E52 only)			
	B1	9:00-10:50	Tu Th	ANB 201	staff
	2	4:20-6:10	Tu Th	ANA 101	staff
	S3	9:00-11:40	Saturday	AUD 103	staff
	51	4:20-6:10	M W	202B	staff
	E52	5:30-8:10	Th	212	staff
442-4		Basic Principles of Guidance			305
	4	additional sessions to be arranged			
	E1	5:30-8:10	W	SS 200	Soper
	E51	5:30-8:10	Th	104	Eversull
515-4		Psychological Aspects of Education			
	E51	5:30-8:10	Tu	204	Sonstegard
520-4		Advanced Educational Statistics			420
	E1	5:30-8:10	Th	SS 200	Parker
522-4		Educational Measurements II		420 and 422, or consent of instructor	
	E1	5:30-8:10	W	ED 100	Johnson
525-4		School Behavior Problems and Their Prevention		412 or consent of instructor	
	S1	9:00-12:00	Saturday	ANA 100	Meredith
538-4		Counseling Theory and Practice II			537
	E51	5:30-8:10	M	212A	Sonstegard
541-4		Occupational Information and Guidance			412; 442
	E51	5:30-8:10	W	AUD	Eversull
545F-4		Problems in Guidance: Pupil Adjustment		525, consent of instructor	
	S1	9:00-12:00	Saturday	ANA 100	Sonstegard
562B-4		Adolescent Development in Education		412 or consent of instructor	
	E1	5:30-8:10	W	SCI 3	Troyer

HEALTH EDUCATION (H ED)

205-4		Introduction to Health Education			
	1	10:00-10:50	MTuWTh	ANA 101	Spear
350-4		Methods and Materials in Elementary Health Education			
	E1	6:20-8:10	Tu Th	AUD 103	Klein

Course No. & Hours	Descriptive Title	Days	Place	Prerequisite
Alton	E. St. Louis	Time		Instructor
400-4	Health Appraisal of Children			
E1	6:20-8:10	M W	AUD 101	Spear

HISTORY (HIST)

101-3	Survey of Western Civilization			
1	12:00-12:50	M W F	AUD 103	staff
	51	2:00-3:15	Tu Th	106 Keleher
201-4	The United States to 1865			Sophomore standing
1	10:00-10:50	MTuWTh	AUD 103	Weiss
E2	6:20-8:10	M W	AUD 103	Weiss
	51	10:00-10:50	MTuWTh	204 McCurry
	E52	6:20-8:10	Tu Th	204A Riddleberger
202-4	The United States Since 1865			Sophomore standing
1	9:00-9:50	MTuWTh	AUD 103	Riddleberger
	51	11:00-11:50	MTuWTh	204A Rosenthal
330-4	The Revolution and the Constitution			201
	51	8:00-8:50	MTuWTh	204A McCurry
332-4	Medieval History			Sophomore standing
1	2:00-2:50	MTuW F	AUD 103	staff
402-4	The New South			201
1	1:00-1:50	MTuWTh	AUD 103	Riddleberger
413-3	Intellectual History of the United States			201, 202
	51	10:00-10:50	M W F	204A Rosenthal
415-4	The Age of the Renaissance			101, GSB 152, & 153
B1	11:00-12:50	Tu Th	AUD 103	Erickson
418-3	English Constitutional History			GSB 152 & 153
	51	12:00-12:50	M W F	212A Haas
437-3	Recent United States History			202
E1	8:20-9:45	M W	AUD 103	Weiss
450-4	Europe since 1914			101, GSB 152, & 153
E1	6:20-8:10	M W	HUM 100	Kimball
452-3	Historical Research and Thesis Writing			Senior standing or consent of instructor
	B51	1:00-2:25	Tu Th	202B staff
500-4	History Seminar	U.S. History Seminar	on the Progressive movement	
	E51	Arranged	Arranged	Arranged Rosenthal

HUMANITIES (HUM)

303-3	Humanities (Honors)			Invitation of the Honors Program Committee
	Offered once annually.			
1	3:00-4:30	W	LL 201	Guenther

INSTRUCTIONAL MATERIALS (IM)

405-4	Library Materials for Children			
	4 additional sessions to be arranged			
E1	5:30-8:10	W	SCI 200	staff
417-4	Audio-Visual Methods in Education			Guid 305
	4 additional sessions to be arranged			
1	4:20-6:10	M W	SCI 2	Wagner
E2	5:30-8:10	Tu	SCI 2	staff
	B51	2:00-3:50	Tu Th	124A staff
	S52	9:00-11:40	Saturday	124A staff

JOURNALISM (JRNL)

202-3	News Writing and Editing II			201
	B51	2:00-2:50	M	105 Lee

Course No. & Hours	Descriptive Title	Alton	E. St. Louis	Time	Days	Place	Prerequisite	Instructor
203-3	News Writing and Editing III							202
	B1			1:00-1:50	Tu	SU		Lee
				1:00-2:50	Th	SU		Lee
340-3	The Law of Journalism							
	B1			11:00-12:15	Tu Th	SU		Lee

MANAGEMENT (MGT)

170-4	Introduction to Business Administration							
	1			8:00-8:50	M WThF	AUD 200		McKinney
	2			2:00-2:50	MTuWTh	ANB 101		staff
	E3			6:20-8:10	M W	ANA 101		staff
	E4			8:20-10:10	Tu Th	ANA 101		staff
		51		1:00-1:50	M WThF	113		staff
		52		3:00-3:50	M WThF	103		Thomas
		E53		6:20-8:10	M W	103		staff
		E54		6:20-8:10	Tu Th	202B		staff
240-4	Introduction to Data Processing							Sophomore standing
	E51			6:20-8:10	M W	202B		staff
271-4	Business Writing							Eng 103
	E1			8:20-10:10	M W	ANB 102		staff
		E51		8:20-10:10	M W	224		Motley
320-5	Corporation Finance						Acct 253 & Econ 205	
	E1			5:55-8:10	M W	ANB 102		Pinkstaff
		51		9:00-9:50	MTuWThF	104		Thomas
323-4	Investments							320
	E51			8:20-10:10	Tu Th	224		Meador
327-4	General Insurance						Acct 253 & Econ 206	
	E1			6:20-8:10	Tu Th	ANB 202		staff
328-3	Real Estate							
	1			9:00-9:50	M W F	ANA 104		staff
		E51		5:30-8:10	Th	202A		Thomas
340-4	Business Organization and Management						Junior standing or consent of instructor	
	1			11:00-11:50	MTuWTh	ANB 102		Skjerseth
		51		10:00-10:50	M WThF	104		Ingwersen
361-3	Business Report Writing							
	1			10:00-10:50	MTu Th	HUM 205		Brady
373-4	Business Law III							
	1			8:00-8:50	MTu ThF	ANB 201		Heath
	E2			8:20-10:10	Tu Th	AUD 103		Heath
		51		8:00-8:50	M WThF	204		staff
		E52		8:20-10:10	Tu Th	106		staff
380-4	Production Management						Econ 206	
	1			12:00-12:50	MTuWTh	ANA 101		Skjerseth
		E51		8:20-10:10	M W	124A		Ingwersen
382-3	Time and Motion Study							
	E51			5:30-8:10	Tu	202A		staff
385-4	Personnel Management						Econ 206	
	E1			6:20-8:10	Tu Th	SS 105		Heath
		51		11:00-11:50	M WThF	204		Meador
421-4	Management of Business Finance							320
	B1			1:00-2:50	M W	SCI 102		Blackledge
442-4	Management of Data Processing Systems							241
	E1			6:20-8:10	F	Alton AUD 102		Tarpey
				and 8:00-9:50				
				or 10:00-11:50	Sat.	Edws.		
472-4	Small Business							
	E1			8:20-10:10	M W	ANB 202		Skjerseth

Course No. & Hours	Descriptive Title	Time	Days	Place	Prerequisite Instructor
475-4	Budgeting and Systems				320, Act 253
	E51	8:20-10:10	M W	212	staff
480-4	Seminar in Labor Law		Two quarters	of business law or Econ	310
	B1	11:00-12:50	M W	SCI 2	McKinney
481-4	Administrative Management				340
	B51	12:00-1:50	Tu Th	221	Ingwersen
485-4	Problems in Personnel Management				385
	E1	6:20-8:10	M W	HUM 205	Blackledge
	B51	2:00-3:50	Tu Th	201A	Meador
595-4	Seminar in Personnel Management			485 or consent of instructor	
	E1	8:20-10:10	M W	SS 200	Blackledge

MARKETING (MKTG)

230-5	Principles of Marketing			Econ 205 or consent of instructor	
	1	10:00-10:50	MTuWThF	AUD 100	Vincent
	E51	5:55-8:10	M W	106	Eckles
331-4	Retailing				230
	E1	8:20-10:10	M W	AUD 100	Pinkstaff
	51	10:00-10:50	MTu ThF	103	Bucher
332-4	Store Management				331
	E1	6:20-8:10	M W	ANB 101	Vincent
	51	11:00-11:50	MTu ThF	103	Bucher
333-4	Principles of Advertising				230
	E51	8:20-10:10	Tu Th	112	staff
334-4	Credits and Collections				230
	1	1:00-1:50	MTuWTh	SCI 201	Pinkstaff
	E51	6:20-8:10	M W	113	Bucher
336-3	Purchasing				230
	B1	11:00-12:25	M W	SS 200	Vincent
337-4	Principles of Salesmanship				230
	E1	8:20-10:10	Tu Th	ANA 110	Bosse
349-3	Wholesaling				230
	E51	8:20-9:45	M W	201A	Eckles
384-4	Advertising Media Analysis				333
	1	8:00-8:50	MTu ThF	ANA 101	Bosse
451-4	Traffic Management				341
	E1	6:20-8:10	Tu Th	HUM 205	Bosse
463-3	Advertising Management				333 or 384
	B51	12:00-1:25	Tu Th	201A	Eckles

MATHEMATICS (MATH)

100-0	Elementary Mathematics				
	1	12:00-12:50	MTu ThF	SCI 103	staff
	51	11:00-11:50	MTu ThF	220	Wang
111-5	Elementary Analysis I			106 or three semesters of high school algebra and 75% on guidance test	
	51	9:00-9:50	MTuWThF	220	Wang
112-5	Elementary Analysis II			111 or three semesters of algebra and 90% on guidance test	
	1	1:00-1:50	MTuWThF	SCI 103	Haimo
	E2	5:55-8:10	M W	SCI 103	Goering
	51	11:00-11:50	MTuWThF	205	Oursler
	E52	5:55-8:10	Tu Th	220	Rutledge
150-5	Calculus and Analytic Geometry I			College preparatory mathematics in high school and high score on placement examination, or 112	
	1	10:00-10:50	MTuWThF	SCI 103	Haimo
	2	11:00-11:50	MTuWThF	SCI 103	Forcade

Course	No. & Hours	Descriptive Title	Time	Days	Place	Prerequisite Instructor
	Alton	E. St. Louis				
MATH 150 (Continued)						
	3		2:00-2:50	MTuWThF	SCI 103	Broadbooks
	E4		5:55-8:10	Tu Th	SCI 103	Sturley
		51	11:00-11:50	MTuWThF	221	Lindstrum
		52	12:00-12:50	MTuWThF	220	Williams
		53	1:00-1:50	MTuWThF	220	staff
		54	2:00-2:50	MTuWThF	220	Rutledge
		E55	5:55-8:10	M W	220	staff
210-4	The Teaching of Elementary Mathematics					GSD 157
	1		3:00-3:50	MTu ThF	SCI 103	Gwillim
		E51	8:20-10:10	M W	220	staff
220-4	Elementary Statistics					111 or GSD 165
	51		3:00-3:50	MTu ThF	220	Fanning
252-4	Calculus and Analytic Geometry III					151
	1		11:00-11:50	MTu ThF	S&T 101	Pendergrass
	E2		6:20-8:10	Tu Th	S&T 101	Forcade
		51	8:00-8:50	MTu ThF	220	Oursler
		52	10:00-10:50	MTu ThF	220	Bennewitz
		E53	6:20-8:10	M W	205	Fanning
253-4	Calculus and Analytic Geometry IV					252
	1		10:00-10:50	MTu ThF	S&T 101	Phillips
	2		3:00-3:50	MTu ThF	S&T. 101	Broadbooks
		51	10:00-10:50	MTu ThF	205	Fanning
		52	1:00-1:50	MTu ThF	205	Lindstrum
300-4	The Real Number System					253 or concurrent enrollment
	1		9:00-9:50	MTu ThF	SCI 103	Haimo
		51	8:00-8:50	MTu ThF	205	Clemans
306-3	Differential Equations II					305
	1		1:00-1:50	M W F	S&T 101	Goering
		E51	8:20-9:35	Tu Th	220	Lindstrum
311-3	The Teaching of Secondary Mathematics					320, Ed. Sec. 315
	1		2:00-2:50	M W F	S&T 101	Pendergrass
321-3	Fundamental Concepts of Algebra II					320
	E1		6:20-7:35	M W	SCI 2	Phillips
		51	9:00-9:50	M W F	205	Oursler
400-3	History of Mathematics					252 or consent of instructor
	1		9:00-9:50	M W F	SCI 3	Gwillim
412-3	Statistical Analysis III					410
	E1		8:20-10:10	M W	S&T 101	Sturley
454-3	Advanced Calculus					453
	E1		8:20-9:35	M W	SCI 103	Pendergrass
		51	2:00-2:50	M W F	205	Williams
482-3	Probability and Statistics III					481
	E51		8:20-9:35	Tu Th	205	Rutledge
556-3	Complex Variables					555
	E1		8:20-9:35	M W	SCI 2	Goering

MUSIC (MUS)

001-1 ¹	University Bands					Audition
	1		1:00-1:50	MTuWThF	FAB 100	Fjerstad
		51	11:00-11:50	M W F	AUD	Fjerstad
001C-0	Stage Band					Audition
	1		8:00-8:50	Th	FAB 100	Fjerstad
001E-0	Instrumental Laboratory					Consent of instructor
	1		9:00-9:50	M Th	FAB 100	Fjerstad and Tulloss
002C-1 ¹	Collegiate Singers					Audition

Course No. & Hours	Descriptive Title	Time	Days	Place	Prerequisite Instructor
Alton	E. St. Louis				
1		11:00-11:50	M W F	FAB 100	staff
	51	2:00-2:50	Tu Th	212	staff
002D-½ ¹	University Chorus				Audition
E1		8:15-10:15	M	AUD 200	staff
	E51	8:15-10:15	Tu	212	staff
003-1	University Symphony Orchestra				Audition. Credit for music students only
E1		Arranged	Arranged	Arranged	staff
010A-1	Class Violin				
1		2:00-2:50	M W F	FAB 100	Tulloss
010B-1	Class Viola				
1		2:00-2:50	M W F	FAB 100	Tulloss
010C-1	Class Cello				
1		2:00-2:50	M W F	FAB 100	Tulloss
010D-1	Class String Bass				
1		2:00-2:50	M W F	FAB 100	Tulloss
013-1 to 4	Cello				For music students only, except under unusual conditions
1		Arranged	Arranged	Arranged	Kresteff
020A-1	Class Flute				
1		9:00-9:50	M W F	FAB 208	Blakely
020B-1	Class Oboe				
1		9:00-9:50	M W F	FAB 208	Blakely
020C-1	Class Clarinet				
1		9:00-9:50	M W F	FAB 208	Blakely
020D-1	Class Bassoon				
1		9:00-9:50	M W F	FAB 208	Blakely
020E-1	Class Saxophone				
1		9:00-9:50	M W F	FAB 208	Blakely
030-1	Class Percussion				
1		8:00-8:50	M W F	FAB 100	Fjerstad
040-1	Class Piano				Music concentration, or 200 (may be concurrent), or equivalent
	Alton: Sec. 1 for 2nd year music majors. Sec. 2 for 1st year majors. Sec. E3 for non-majors.				
	E. St. Louis: Sec. E51 for non-majors.				
	1	10:00-10:50	M W F	FAC 102	Boldt
	2	12:00-12:50	M W F	FAC 102	Boldt
	3	4:30-5:30	Tu	FAC 102	Boldt
	51	4:30-5:30	M	212	Boldt
041-1 to 4	Piano				For music students only, except under unusual conditions
1		Arranged	Arranged	FAC 102	Boldt
	51	Arranged	Arranged	212	Boldt
051-1 to 4	French Horn				For music students only, except under unusual conditions
1		Arranged	Arranged	Arranged	Fjerstad
052-1 to 4	Trumpet				For music students only, except under unusual conditions
1		Arranged	Arranged	Arranged	Fjerstad
060-1	Class Voice				
1		11:00-12:15	Tu Th	FAB 100	staff
061-1 to 4	Voice				For music students only, except under unusual conditions
1		Arranged	Arranged	Arranged	staff
107-4	Theory of Music				106
1		9:00-9:50	MTuWThF	FAC 203	Kresteff
2		10:00-10:50	MTuWThF	FAC 203	Kresteff
207-3	Theory of Music				206
1		2:00-2:50	MTuWTh	FAC 203	Kresteff
300-3	Music Education—Elementary				200 or equivalent. For non-music students
1		4:30-5:35	M W	FAC 203	Tulloss
303-3	Music Education in the Senior High School				For music students only
1		3:00-3:50	M W	FAC 203	Blakely

¹ Concerts and extra rehearsals at the discretion of the director.

Credit will be granted after the student has completed three quarters.

Course No. & Hours	Descriptive Title	Alton	E. St. Louis	Time	Days	Place	Prerequisite Instructor
319-3	Conducting—Choral and Instrumental						
1				9:00-9:50	M W F	FAC 100	Fjerstad
326-3	Analysis I					207 or consent of instructor	
1				10:00-10:50	M W F	FAC 100	Warren
355-1	Chamber Music						Audition
	String ensemble						
1		Arranged			Arranged	Arranged	staff
365-1	Chamber Music						Audition
	Section 1 and 2: Woodwind ensembles. Section 3: brass ensemble.						
1				10:00-10:50	Tu	FAB 208	Blakely
2				10:00-10:50		Th	FAB 208
3				8:00-8:50	Tu	FAB 100	Fjerstad
443-3	Canon and Fugue						442
1				4:30-7:10	Tu	FAC 203	Warren
465-3	Development and Teaching of Strings						
E1				5:30-8:10	M	FAB 100	staff
471-2 to 8	Private Piano	For music students only, except under unusual conditions					
1		Arranged			Arranged	Arranged	Boldt
472-2 to 4	Private Voice	For music students only, except under unusual conditions					
1		Arranged			Arranged	Arranged	staff
473C-2 to 4	Private Violoncello	For music students only, except under unusual conditions					
1		Arranged			Arranged	Arranged	Kresteff
475A-2 to 4	Private Trumpet	For music students only, except under unusual conditions					
1		Arranged			Arranged	Arranged	Fjerstad

The following courses in applied music are available for music majors and minors and for others under exceptional conditions. Consult the music adviser at Alton or East St. Louis. Each course has only one section. Times to be arranged. Registration in the 400-level private applied course is restricted to advanced senior and graduate students.

011-1 to 4	Violin	473A-2 to 8	Private Violin
012-1 to 4	Viola	473B-2 to 8	Private Viola
014-1 to 4	String Bass	473D-2 to 8	Private Bass Viol
021-1 to 4	Flute	474A-2 to 8	Private Flute
022-1 to 4	Oboe	474B-2 to 8	Private Oboe
023-1 to 4	Clarinet	474C-2 to 8	Private Clarinet
024-1 to 4	Bassoon	474D-2 to 8	Private Bassoon
025-1 to 4	Saxophone	474E-2 to 8	Private Saxophone
031-1 to 4	Percussion	475B-2 to 8	Private French Horn
053-1 to 4	Trombone	475C-2 to 8	Private Baritone
054-1 to 4	Tuba	475D-2 to 8	Private Trombone
055-1 to 4	Baritone	475E-2 to 8	Private Tuba
071-1 to 4	Organ	476 -2 to 8	Private Organ
		477 -2 to 4	Private Percussion

NURSING (NURS)

230-5	Medical-Surgical Nursing I					Consent of department
	51	2:00-2:50	MTuWThF			Miss Jimison, Miss Parker
230A-5	Medical-Surgical Nursing I Practicum					Consent of department
	51	8:00-11:50	MTuWThF			Miss Jimison, Miss Parker
311-4	Interpersonal Relationships in Nursing					GSB 203
	51	5:30-8:10	MTuWTh		Arranged	staff
375-4	Principles of Public Health Nursing					Consent of department
	51	Arranged	Arranged		E.S.H.D.	Mrs. Burton
380-8	Public Health Nursing Practicum					Consent of department
	51	Arranged	Arranged		E.S.H.D.	Mrs. Burton

PHILOSOPHY (PHIL)

240-4	Ethics					
-------	--------	--	--	--	--	--

Course No.	Hours	Descriptive Title	Time	Days	Place	Prerequisite Instructor
Alton	E. St. Louis					
360-4	1	Philosophy of Art	4:20-6:10	Tu Th	AUD 101	Morrison
	B51		1:00-2:50	M W	104	Linden
383-4	1	Recent Philosophy				
	B1		2:00-3:50	Tu Th	SS 105	Shea

PHYSICAL EDUCATION—MEN (PEM)

119-1	1	Methods and Materials of Teaching Golf	9:00-9:50	Tu Th	Gym	Consent of instructor Klein
153-1	1	Teaching of Team Games II	1:00-1:50	Tu Th	Gym	Consent of instructor Hatheway
253-1		Required Physical Education				
		(Swimming. For non-swimmers and beginners only. Pool rental charge \$6.)				
	1		11:00-12:50	M W	Gym	Hatheway
	51		12:00-1:50	M W	Gym	Moehn
	52		11:00-11:50	Tu Th	Gym	Moehn
(Wrestling)	53		2:00-2:50	Tu Th	Gym	Moehn
(Softball)	2		1:00-1:50	M W	Gym	Showers
	54		1:00-1:50	Tu Th	Gym	Moehn
(Golf)	3		10:00-10:50	W F	Gym	Hatheway
	55		10:00-10:50	Tu Th	Gym	Moehn
(Tennis)	4		10:00-10:50	Tu Th	Gym	Hatheway
	5		2:00-2:50	Tu Th	Gym	Hatheway
(Physical Fitness)	6		3:00-3:50	M W	Gym	Hatheway
(Folk Dance. Meets with PEW 230.)	7		3:00-3:50	Tu Th	Gym	S. Carpenter
	56		9:00-9:50	M W	Gym	S. Carpenter
254-1		Bowling				
		Bowling lane rental charge \$5.50. Payable first class meeting.				
	1		9:00-10:50	W	Gym	Showers
	2		9:00-10:50	F	Gym	Showers
	51		9:00-9:50	Tu Th	Gym	Showers
263-1	1	Teaching of Individual Activities II	11:00-11:50	Tu Th	Gym	Hatheway
303-5	1	Kinesiology (Same as PEW 303.)	11:00-11:50	MTuWThF	SCI 200	Physiology 209 & 300 Archangel
350-4	1	Methods and Materials for Teaching Physical Education	8:00-8:50	MTuWTh	Gym & SCI 103	Moehn
	E2	School (Same as PEW 350.)	6:20-8:10	M W	Gym & SCI 102	Moehn
370-4	1	Tests and Measurements in Physical Education	1:00-1:50	MTuWTh	SCI 2	Archangel
382-3	1	Track and Field	2:00-2:50	M W F	Gym	Hatheway

PHYSICAL EDUCATION—WOMEN (PEW)

204-1	1	Beginning Swimming	11:00-12:50	M W	Gym	staff
		Pool rental charge \$6.				
205-1	1	Intermediate Swimming	11:00-12:50	M W	Gym	staff
		Pool rental charge \$6.				
						204 or equivalent

Course No. & Hours	Descriptive Title			Days	Place	Prerequisite Instructor
	Alton	E. St. Louis	Time			
206-1	Volleyball					
	1		9:00-9:50	W F	Gym	staff
213-1	Softball					
	1		2:00-2:50	Tu Th	Gym	staff
214-1	Archery					
	1		10:00-10:50	Tu Th	Gym	staff
216-1	Tennis					
	1		10:00-10:50	W F	Gym	staff
222-1	Golf					
		51	10:00-10:50	Tu Th	Gym	Moehn
230-1	Folk Dancing					
	1		3:00-3:50	Tu Th	Gym	Carpenter
		51	9:00-9:50	M W	Gym	Carpenter
233-1	Modern Dance					
	1		12:00-12:50	Tu Th	Gym	Carpenter
		51	10:00-10:50	M W	Gym	Carpenter
254-1	Bowling					
			Bowling lane rental charge \$5.50. Payable First Class meeting.			
		51	9:00-9:50	Tu Th	Gym	Showers
303-5	Kinésiology (Same as PEM 303.)					Physiology 300
	1		11:00-11:50	MTuWThF	SCI 200	Archangel
321-2 to 6	Techniques of Teaching Team Sports					
	1		2:00-3:50	W F	Gym	staff
322-2 to 6	Techniques of Teaching Individual Sports					
	1		9:00-9:50	MTuWTh	Gym	Archangel
323-1 to 3	Officiating Techniques					Consent of instructor
	1		2:00-2:50	M	ANA 109	Archangel
350-4	Materials and Methods for Teaching Physical Education Activities in the Elementary School (Same as PEM 350.)					
	1		8:00-8:50	MTuWTh	Gym & SCI 103	Moehn
	E2		6:20-8:10	M W	Gym & SCI 102	Moehn
353-4	Organization and Administration of Physical Education					
	1		8:00-8:50	MTuWTh	SS 200	staff
370-4	Tesis and Measurements in Physical Education					
	1		1:00-1:50	MTuWTh	SCI 2	Archangel

PHYSICS (PHYS)

297-5	University Physics I					Math 151, 252, 253 or concurrent enrollment
			E. St. Louis student enrolls in lecture and one lab.			
	1		3:00-3:50	M W F	SCI 2	Zurheide
			3:00-4:50	Tu	SCI 2	Zurheide
			3:00-4:50	Th	SCI 7	Zurheide
	Lect		9:00-9:50	MTu ThF	124A	staff
	Lab 51		Arranged	Arranged	124	staff
	Lab 52		Arranged	Arranged	124	staff
	Lab 53		Arranged	Arranged	124	staff
299-5	University Physics III					Math 151, 252, 253 or concurrent enrollment
			Day student enrolls in lecture and one lab.			
	Lect		9:00-9:50	M W F	SCI 200	Boedeker
	Lab 1		9:00-10:50	Tu	SCI 200	Boedeker
			9:00-10:50	Th	SCI 7	Boedeker
	Lab 2		9:00-10:50	Tu	SCI 200	Boedeker
			11:00-12:50	Th	SCI 7	Zurheide
	Lab 3		9:00-10:50	Tu	SCI 200	Boedeker
			1:00-2:50	Th	SCI 7	Boedeker
	E4		6:00-9:05	M W	SCI 7	staff

Course No. & Hours	Descriptive Title	Time	Days	Place	Prerequisite
Alton	E. St. Louis				Instructor
	Lect	11:00-11:50	MTu ThF	124A	staff
	Lab 51	Arranged	Arranged	124	staff
	Lab 52	Arranged	Arranged	124	staff
	Lab 53	Arranged	Arranged	124	staff
302-4	Mechanics		299 and Math	324, or concurrent	enrollment
1		2:00-2:50	MTuW F	SCI 3	Boedeker
	E51	6:20-8:10	Tu Th	124A	staff
303-5	Heat I				
	51	1:00-1:50	MTuWThF	124A	staff
307-2	Electrical Measurements			306 or concurrent	enrollment
E1		6:20-8:10	Tu Th	SCI 9	Zurheide
	51	Arranged	Arranged	124	staff
417-4	Modern Physics III		300; 9 hours of math	numbered 300 or above	
1		12:00-12:50	MTuW F	SCI 3	McAney
418-1 to 4	Modern Physics Laboratory			415 or concurrent	enrollment and consent of instructor
1		12:00-1:50	Th	SCI 9	Zurheide
					and two hours to be arranged

PHYSIOLOGY (PHSL)

433-4	Comparative Physiology			Zool 102, 103, & Chem 113	
	Lect	5:55-7:45	M	SCI 100	Ratzlaff
		5:55-6:45	W	SCI 100	Ratzlaff
	Lab E1	6:55-9:55	W	SCI 100	Ratzlaff

PSYCHOLOGY (PSYC)

211-4	Principles and Methods of Psychology I			201 or GSB 253	
	B1	9:00-10:50	Tu Th	SCI 201	Rockwell
301-4	Child Psychology			201 or GSB 253	
	B1	11:00-12:50	Tu Th	SCI 2	Kuenzli
	51	4:20-6:10	Tu Th	224	Troyer
303-4	Adolescent Psychology			201 or GSB 253	
	1	4:20-6:10	M W	AUD 100	Kuenzli
311-4	Experimental Psychology			201 or GSB 253	
		2 additional hours of laboratory per week required			
	E51	6:20-8:10	M W	204A	Dameron
407-4	Theories of Learning			201 or GSB 253	
		4 additional sessions to be arranged			
	E51	5:30-8:10	Tu	212	staff
421-4	Psychological Tests and Measurements			8 hours of psychology	
		4 additional sessions to be arranged			
	E51	5:30-8:10	Th	204	Taliana
431-4	Psychopathology			12 hours in psychology or consent of instructor	
	B1	1:00-2:50	Tu Th	ANA 108	Rockwell
479-4	Psychology of Industrial Conflict			320 or consent of instructor	
		4 additional sessions to be arranged			
	S1	9:00-11:40	Saturday	ANA 101	Southwood

SECRETARIAL AND BUSINESS EDUCATION (SEC)

102-3	Typewriting I				
	1	9:00-9:50	MTu ThF	ANA 103	Frost
	E2	8:20-10:10	Tu Th	ANA 103	staff
	51	11:00-11:50	MTuWTh	223	Martin
	E52	8:20-10:10	M W	223	Martin
104-3	Typewriting III			103 or equivalent	
	1	11:00-11:50	MTu ThF	ANA 103	Brady
	E2	8:20-10:10	Tu Th	ANA 103	staff

Course No. & Hours	Descriptive Title	Days	Place	Prerequisite	
Alton	E. St. Louis	Time		Instructor	
SEC 104 (Continued)					
	51	11:00-11:50	MTuWTh	223	Martin
	E52	8:20-10:10	M W	223	Martin
107-4	Shorthand III				106 or equivalent
	1	1:00-1:50	MTu ThF	ANA 103	Frost
	E2	6:20-8:10	Tu Th	ANA 103	staff
	51	9:00-9:50	MTuWTh	223	Motley
	E52	6:20-8:10	M W	223	Motley
113-1	Duplicating				102 or equivalent
	B1	11:00-11:50	M	ANA 108	Frost
	E2	8:20-9:10	W	ANA 108	staff
	51	10:00-10:50	Tu	223	Motley
307-4	Secretarial Practice				213 & 216
	1	10:00-10:50	MTu ThF	ANA 103	Frost
	E2	6:20-8:10	M W	ANA 103	staff
	E51	6:20-8:10	Tu Th	223	staff
313-4	Calculating Machines				
	E51	6:20-8:10	M W	202A	Martin
407-4	Office Management				Consent of instructor
	E1	6:20-8:10	M W	ANA 108	Brady

SOCIOLOGY (SOC)

102-4	Social Problems				
	51	10:00-10:50	MTuWTh	224	D. Taylor
241-4	Marriage and Parenthood				
	51	9:00-9:50	MTuWTh	224	D. Taylor
306-4	Social Control				
	1	9:00-9:50	MTuWTh	SS 200	staff
308-3	Statistics for Social Science				Junior standing or consent of instructor
	B51	2:00-3:25	M W	224	J. Schusky
320-4	Race and Minority Group Relations				
	B1	11:00-12:50	Tu Th	SS 200	Seymour
321-4	Socialization of the Individual				101
	B1	1:00-2:50	Tu Th	SS 200	Thomas
333-4	Community Organization				
	E51	6:20-8:10	Tu Th	224	staff
335-4	Urban Sociology				101
	E51	6:20-8:10	M W	224	staff
338-4	Industrial Sociology				
	B1	1:00-2:50	M W	SS 200	staff
371-4	Population and Migration				Consent of instructor
	1	10:00-10:50	MTuWTh	SS 200	Campbell
373-4	Juvenile Delinquency				
	51	10:00-10:50	MTuWTh	221	Rudwick
405-4	Current Sociology				12 hours of Sociology
	1	11:00-11:50	MTuWTh	SS 105	Campbell
472-4	Treatment and Prevention of Crime				372
	E1	6:20-8:10	M W	SS 105	staff
482-4	Social Work in Selected Agencies				481
	B51	2:00-3:50	M W	201A	staff

SPEECH (SPCH)

102-4	Public Speaking				153 or consent of instructor
	1	9:00-9:50	MTuW F	ANB 202	Hawkins
	51	11:00-11:50	MTu ThF	112	Cornwell
224-4	Communicative Reading				GSD 153 or consent of instructor
	1	10:00-10:50	MTu ThF	ANB 102	Smith

Course No. & Hours	Descriptive Title	Prerequisite
Alton E. St. Louis	Time Days	Instructor
230-1 to 3	Speech Activities	other than theater. Section B51 for theater activities.
1	12:00-12:50 Tu	ANB 101 staff
	B51 12:00-12:50 Tu	AUD Birdman and Bell
306-4	Teaching Speech in Secondary Schools	16 hours of Speech
E51	5:30-8:10 Tu	104 staff
330-1 to 3	Speech Activities	other than theater. Section B51 for theater activities.
1	12:00-12:50 Tu	ANB 101 staff
	B51 12:00-12:50 Tu	AUD Birdman and Bell
414-4	History and Criticism of Great Speakers and Their Speeches	GSD 153
B1	1:00-2:50 M W	ANB 201 White

SPEECH CORRECTION (SP C)

428-4	Speech Correction for the Classroom Teacher	4 additional hours to be arranged.
E1	5:30-8:10 Th	ANB 201 White
	E51 5:30-8:10 Th	AUD staff

THEATER (THEA)

203-4	Scenic Design	B51 12:00-1:50 M W	201A	Bell
310-3	Children's Theater	B1 1:00-2:15 Tu Th	ANA 101	Kochman
402-4	Directing	B51 12:00-1:50 Tu Th	AUD	Birdman

For participation in speech activities, theater students should register for Speech 230 or 330.

ZOOLOGY (ZOO)

100-5	Principles of Animal Biology	E1 6:00-7:15 Tu Th	SCI 101	Woolridge
		7:25-9:15 Tu Th	SCI 101	Woolridge
103-5	General Vertebrate Zoology		100, or GSA 252	
	Alton student enrolls in lecture and one lab.			
	Lect	2:00-2:50 Tu Th	SCI 102	Axtell
	Lab 1	1:00-2:50 M W F	SCI 100	Axtell
	Lab 2	1:00-2:50 M W F	SCI 101	Broadbooks
	51	9:00-9:50 M W F	112	Ratzlaff
		10:00-11:50 Tu Th	116	Ratzlaff
303-4	General Ornithology	1 9:00-9:50 M W	SCI 100	staff
		8:00-9:50 Tu Th	SCI 100	staff
314-4	Heredity and Eugenics	1 11:00-11:50 MTu ThF	SCI 3	100 or Botany 101
382c-½	Zoology Seminar for Seniors	1 Arranged	Arranged	SCI 100 staff
407-5	Parasitology	E1 5:55-6:45 Tu Th	SCI 100	Myer
		6:55-9:45 Tu Th	SCI 100	Myer
408-4	Herpetology	1 10:00-10:50 M W	SCI 100	One year of Zoology
		10:00-11:50 Tu Th	SCI 100	Axtell



Southern Illinois University Foundation

The Southern Illinois University Foundation is a nonprofit corporation chartered by the state and authorized by the Board of Trustees to receive gifts for the benefit of the University, to buy and sell property, and otherwise to serve the University.

It respectfully asks alumni and other citizens of Southern Illinois to consider making gifts and bequests to benefit the University. Such gifts should be conveyed to the Foundation, with proper stipulation as to their uses. The Foundation, through its officers and members, will be glad to confer with intending donors regarding suitable clauses to insert in wills and suitable forms of gifts and memorials, including bequests by means of life insurance. Large or small gifts to the library will be appreciated; likewise, gifts for special equipment, buildings, endowment of professorships in particular subjects, gifts to student loan funds and scholarship funds, gifts for the use of foreign students, and endowments for particular sorts of research. Any gifts or bequests can be given suitable memorial names.

The staff members of the Foundation are

- Mr. Kenneth R. Miller, *Executive Director*, Carbondale, Illinois
- Mrs. Lois H. Nelson, *Secretary*, Carbondale, Illinois
- Mr. Robert L. Gallegly, *Treasurer*, Carbondale, Illinois
- Mr. C. Eugene Peebles, *Assistant Treasurer*, Edwardsville, Illinois
- Mr. C. Richard Gruny, *Legal Counsel*, Carbondale, Illinois
- Mr. L. James Struif, *Assistant Legal Counsel*, Edwardsville, Illinois
- Mr. Donald Leavitt, *Patent Counsel*, St. Louis, Missouri
- Mr. Warren Stookey, *Field Representative*, Edwardsville, Illinois.