

1963

1963 Southern Illinois University Bulletin Edwardsville Campus (Summer Session)

Southern Illinois University Carbondale

Follow this and additional works at: http://opensiuc.lib.siu.edu/ua_bcc

Recommended Citation

, . "1963 Southern Illinois University Bulletin Edwardsville Campus (Summer Session)." (Jan 1963).

This Article is brought to you for free and open access by the University Archives at OpenSIUC. It has been accepted for inclusion in SIU Bulletins and Course Catalogs by an authorized administrator of OpenSIUC. For more information, please contact opensiuc@lib.siu.edu.

Southern Illinois University

Bulletin



Summer Session

EDWARDSVILLE CAMPUS

1963

1963 Summer Session

Edwardsville Campus

June 17–August 9

June 17–August 31



SOUTHERN ILLINOIS UNIVERSITY BULLETIN

Volume 5 Number 2 February, 1963

Second-class postage paid at Carbondale, Illinois.

Published by Southern Illinois University, monthly
except in September, when published semimonthly.

The following issues of the *Southern Illinois University Bulletin* may be obtained without charge from Central Publications, Southern Illinois University, Carbondale, Illinois.

General Information
Financial Assistance
Summer Session (Carbondale)
Summer Session (Edwardsville)
Schedule of Classes (Carbondale)
Schedule of Classes (Edwardsville)
General Announcements (Edwardsville)
Graduate School
College of Education
College of Liberal Arts and Sciences
School of Agriculture
School of Applied Science
School of Business
School of Communications
School of Fine Arts
School of Home Economics
University Institutes
Division of Technical and Adult Education

All intending students should have the General Information bulletin (issued once a year), plus the special bulletins of the various educational units in which they are most interested.

Board of Trustees

	TERM EXPIRES
JOHN PAGE WHAM, <i>Chairman</i> , Centralia	1965
KENNETH L. DAVIS, <i>Vice-Chairman</i> , Harrisburg	1963
MELVIN C. LOCKARD, <i>Secretary</i> , Mattoon	1965
MARTIN VAN BROWN, Carbondale	1967
HAROLD R. FISCHER, Granite City	1963
ARNOLD H. MAREMONT, Winnetka	1967
LINDELL W. STURGIS, Metropolis	1965
RAY PAGE (<i>Ex-Officio</i>), Springfield	
LOUISE MOREHOUSE, <i>Recorder</i>	

Officers of Instruction

DELYTE W. MORRIS, *President*

CHARLES D. TENNEY, *Vice-President for Instruction*

EDWARDSVILLE CAMPUS

CLARENCE W. STEPHENS, *Vice-President for Operations*

WILLIAM T. GOING, *Dean of Instruction*

JOHN H. SCHNABEL, *Registrar and Director of Admissions*

This Bulletin

contains the schedule of summer classes to be offered by the Edwardsville Campus at the Alton and East St. Louis Centers, beginning June 17, 1963. It also provides the student with information relative to advisement and registration, fees, registration calendar, and allied information. For complete information about the University the prospective student should refer to the General Information bulletin.

Table of Contents

University Calendar, 1963-1964	vi
Registrar's Calendar, Summer, 1963	vii
Final Examination Schedule	viii
 GENERAL INFORMATION	 1
Admission	1
Items Applicable to the Summer Only	2
Social Security Number	2
Required Tests	2
Registration	3
Academic Load	3
Fees	3
Withdrawals and Program Changes	4
Veterans' Information	5
Student Responsibility	5
Student Employment	6
Workshop	6
 SCHEDULE OF CLASSES	 7
Listing of Courses	7
Course Number and Hours	8
Prerequisites	8
Courses "To Be Arranged"	9
Map of the Alton Center	10
Map of the East St. Louis Center	11
The Schedule	12

University Calendar, 1963-1964

Revised January 1963

1963 SUMMER SESSION

Session Begins	Monday, June 17
Independence Day Holiday	Thursday, July 4
Final Examinations (8-week Session)	Wednesday–Thursday, August 7–8
Summer Commencements	Friday, August 9
Final Examinations (Summer Quarter)	Monday–Saturday, August 26–31

1963 FALL QUARTER

New Student Week	Sunday–Tuesday, September 22–24
Quarter Begins	Wednesday, September 25
Thanksgiving Vacation	Wednesday, 12 noon–Monday, 8 A.M. November 27–December 2
Final Examinations	Wednesday–Tuesday, December 11–17

1964 WINTER QUARTER

Quarter Begins	Thursday, January 2
Final Examinations	Wednesday–Tuesday, March 11–17

1964 SPRING QUARTER

Quarter Begins	Wednesday, March 25
Memorial Day Holiday	Saturday, May 30
Final Examinations	Thursday–Wednesday, June 4–10
Commencement (Edwardsville)	Thursday, June 11
Commencement (Carbondale)	Friday, June 12

Summer classes begin on Tuesday, June 18. During the fall, winter, and spring quarters, classes begin on the second day of the quarter.

Registrar's Calendar

Summer Session, 1963

June 17	Central registration for classes and workshops at Alton and East St. Louis. Students must register for classes at the center they plan to attend in accordance with the alphabetical registration calendar below.
	8:00 A.M.— 9:00 A.M. N-R
	9:00 A.M.—10:00 A.M. S-T
	10:00 A.M.—11:00 A.M. U-Z
	11:00 A.M.—12:00 Noon A-C
	1:00 P.M.— 2:00 P.M. D-G
	2:00 P.M.— 3:00 P.M. H-K
	3:00 P.M.— 4:00 P.M. L-M
	4:00 P.M.— 8:00 P.M. Evening students only
June 18	Classes start 7:30 A.M.
June 19	Program change day—Last day to add classes. 9:00 A.M.—12:00 noon; 1:00 P.M.—4:30 P.M.; 6:00 P.M.—8:00 P.M.
June 28	Last day to withdraw from school to be eligible for a refund of fees.
June 29	Last day for refund applications to be submitted to Registrar's Office for refund of fees.
July 4	Independence Day Holiday.
July 9	Last day to withdraw from eight-week courses (300 level and above) without receiving a letter grade.
July 16	Last day to withdraw from summer quarter courses (100 and 200 levels) without receiving a letter grade.
July 22	Last day for withdrawal from school except under exceptional conditions.
August 7-8	Final examinations for eight-week session.
August 9	Commencement (Carbondale Campus).
August 29-30	Final examinations for summer quarter.

Final Examination Schedule

All classes meeting for 3 hours or more of credit will schedule two-hour final examination periods. Classes granting less than 3 hours of credit will have final examinations at the last regularly scheduled class meeting.

SUMMER SESSION, 1963

Wednesday, August 7

- 7:30 A.M. Classes that meet at 7:30 A.M.
- 9:45 A.M. Classes that meet at 10:20 A.M.
- 1:10 P.M. Classes that meet at 1:10 P.M.
- 6:00 P.M. Classes that meet at 6:00 P.M. on Monday and Wednesday
- 8:20 P.M. Classes that meet at 8:20 P.M. on Monday and Wednesday

Thursday, August 8

- 7:30 A.M. Classes that meet at 8:55 A.M.
- 9:45 A.M. Classes that meet at 11:45 A.M.
- 1:10 P.M. Classes that meet at 2:25 P.M.
- 6:00 P.M. Classes that meet at 6:00 P.M. on Tuesday and Thursday
- 8:20 P.M. Classes that meet at 8:20 P.M. on Tuesday and Thursday

SUMMER QUARTER, 1963 100 & 200 LEVEL COURSES

Thursday, August 29

- 7:30 A.M. Classes that meet at 7:30 A.M.
- 9:45 A.M. Classes that meet at 10:20 A.M.
- 1:10 P.M. Classes that meet at 1:10 P.M.
- 6:00 P.M. Classes that meet at 6:00 P.M. on Monday and Wednesday
- 8:20 P.M. Classes that meet at 8:20 P.M. on Monday and Wednesday

Friday, August 30

- 7:30 A.M. Classes that meet at 8:55 A.M.
- 9:45 A.M. Classes that meet at 11:45 A.M.
- 1:10 P.M. Classes that meet at 2:25 P.M.
- 6:00 P.M. Classes that meet at 6:00 P.M. on Tuesday and Thursday
- 8:20 P.M. Classes that meet at 8:20 P.M. on Tuesday and Thursday

General Information

THE EDWARDSVILLE CAMPUS of Southern Illinois University has scheduled a summer quarter, June 17 to August 31 and an eight-week summer session, June 17 to August 9.

Classes on the 100 (freshman) and 200 (sophomore) levels will be offered in the summer quarter. Classes numbered 300 and above will be offered in the eight-week summer session.

Students may enroll for classes in either the eight-week session, the summer quarter, or a combination or both in accordance with regular academic load policy.

The Edwardsville Campus offers courses leading toward associate's, bachelor's, and master's degrees in selected fields.

A variety of course offerings have been scheduled to meet the specific needs of (1) teachers in service, (2) freshmen—beginning and refresher courses, (3) upperclassmen—basic requirements, (4) graduate students, and (5) liberal arts graduates and individuals on temporary certificates desiring teacher certification.

Anyone interested in complete general information about the University should obtain a copy of the General Information issue of the *Southern Illinois University Bulletin*, available free from Central Publications, Southern Illinois University, Carbondale, Illinois.

ADMISSION

Application for admission to the summer session should be initiated with the Admissions Office on or before June 1 to permit all necessary processing work to be completed by the start of the session. A general admission requirement is the filing of a transcript of record covering all previous high school and college work. Transcripts should be mailed to the

Admissions Office from the institution(s) attended and should reach the Admissions Office prior to June 10, 1963.

Complete information relative to admission of undergraduate students appears in the General Information issue of the *Southern Illinois University Bulletin*. Graduate students should refer to the Graduate School issue.

ITEMS APPLICABLE TO THE SUMMER ONLY

An undergraduate student attending another institution who expects to graduate therefrom and who desires to attend Southern during the summer only will be admitted as an unclassified student on the basis of a letter of good standing from the registrar of the institution the student is attending. The letter of good standing should be sent directly to the Admissions Office in Edwardsville and must be received prior to registration. A former student of Southern who attended the 1962 summer session and who was in good standing at the close of the session need not apply for re-entrance clearance prior to advisement and registration for the 1963 summer session. A high school senior who ranks in the lowest third (lower half for out-of-state students) of his graduating class who is permitted to enter (on scholastic probation) for the summer quarter must register for more than eight hours in order to continue in attendance during the fall quarter and must earn a C average or above during the summer quarter.

SOCIAL SECURITY NUMBER

Effective with the 1964 summer session, a student seeking admission to the University will need to present a social security number for identification purposes. Any local social security office can provide assistance in obtaining a number or replacing a lost card. At Alton the social security office is in the Germania Savings Building, 543 East Broadway, and at East St. Louis the office is at 435 Missouri Avenue.

REQUIRED TESTS

Each student entering Southern Illinois University directly from high school is required to furnish to the University scores on the test battery administered by the American College Testing Program (A.C.T.). These tests are given at regional test centers throughout the United States in November, February, and April. Information and application blanks are normally available through the high school guidance director or principal, or may be obtained by writing directly to: American College Testing Program, Box 168, Iowa City, Iowa. Each applicant taking the A.C.T. tests in Illinois will also be required to take the Strong Vocational Interest Blank at the same time the former tests are given.

A student who finds it impossible to take the A.C.T. tests may have scores from the College Entrance Examination Board (C.E.E.B.) submitted. The specific scores, which must be submitted if the C.E.E.B. tests are submitted, are Scholastic Aptitude Test, English Composition Test, and Mathematics (Intermediate) Test. In order to have identical test data, a student who submits C.E.E.B. test data will be required to submit scores from the A.C.T. and the Strong Vocational Interest Blank as soon as possible, no later than one month after registration.

Transfer students are required to furnish A.C.T. scores to the Student Counseling and Testing Center. (A transcript of these scores is available by sending one dollar and a written request to the American College Testing Program in Iowa City.) If the scores are on file at the student's former school, a request should be made for their forwarding. Test scores are not normally sent with a person's transcript of grades and must be requested separately from the appropriate office at the former school. If the A.C.T. tests have not been taken, arrangements to do so should be made.

REGISTRATION

Students registering at Alton will report to the Auditorium building to pick up authorization-to-register permits. Students registering at East St. Louis will report to the west (9th Street) door of the main building for authorization-to-register permits.

Students who know that they must miss more than three days of the summer session should not register. The brevity of this eight-week session makes it difficult for students missing more than three days to complete the required work in time.

ACADEMIC LOAD

The normal academic load for the eight-week session is 10 to 12 hours of credit. A student with special needs may, by permission of the dean of his academic unit, take a maximum of 14 hours. A student on probation may not register for more than 10 hours. A student is considered a full-time student during the summer session if he carries 8 or more hours.

The normal student load for the summer quarter is 16 hours. Except by permission of the dean, no student may enroll for more than 18 hours of credit per quarter.

FEES

The fee schedule for an eight-week summer session and a regular quarter is as follows:

REGULAR FEES	EIGHT-WEEK	QUARTER
Tuition	\$31.50 *	\$42.00 *
Student Activity Fee	7.15	9.50
University Center Fee	5.00	5.00
Book Rental Fee	5.00	5.00
	<hr/> \$48.65	<hr/> \$61.50
* Out-of-state students pay an additional	\$37.50	\$50.00

A student taking six hours or fewer during the eight-week session and eight hours or fewer during a regular quarter pays half tuition and book rental fee, full university center fee, and has an option on paying the student activity fee.

Other special fees or deposits as listed in the General Information bulletin will be assessed when applicable.

If a student enrolls in both eight-week and regular-quarter classes his tuition and fees will be assessed on the quarter basis as listed above.

Students attending under state teacher-education, military, or general-assembly scholarships are required to pay the university center fee and the book rental fee. Veterans attending under Public Laws 16 and 894 are not required to pay any of the regular fees. Students attending under Public Law 550 are required to pay fees, both regular and special, and may not use military scholarships for waiving payment of any fees.

WITHDRAWALS AND PROGRAM CHANGES

A prescribed procedure must be followed by any student desiring to change his academic program or to withdraw from the University while the period for which he is registered is still in progress.

WITHDRAWALS

A student is considered officially registered after he has cleared his payment of fees at the Business Office. If a student then finds he cannot attend college or, if after attending for a period of time finds he cannot continue, he must report to the Registrar's Office to indicate official withdrawal action.

Failure to follow the official procedure will result in academic penalty.

PROGRAM CHANGES

A student is officially registered only for those courses appearing on his registration cards. Any change to add or drop a course can be made only after fees are paid and must be made through an official program change. A student may not drop a course merely by stopping attendance. Mere attendance does not constitute registration in a class, nor will attend-

ance in a class for which a student is not registered be a basis for asking that a program change be approved permitting registration in that class.

If a student desires to drop a course during the second or third week of the summer, the change will be approved only when the reasons appear valid. If a student desires to drop a course after the third week the change will be approved only under unusual conditions. During the last three weeks of the session, changes will be approved only in extreme emergencies.

A student desiring to make a program change must initiate his request at the Enrollment Center of the Registrar's Office. He is required to present his fee receipt program card and must complete the following procedure. After having been cleared with the Enrollment Center, program changes for which a program change fee is assessed must be presented to the Business Office for payment. The student immediately returns the program change to the Enrollment Center in the Registrar's Office for final processing. *A student has not completed his program change until he presents it to the Enrollment Center.* No change is official until the preceding procedure is complete.

A program change must be made in order to drop a course. A student may not drop merely by stopping attendance. The last day for dropping a course without receiving a grade is July 9.

Program changes will be accepted at the Registrar's Office from 9:00 A.M. to 12:00 Noon, 1:00 to 4:30 P.M., and 6:00 to 8:00 P.M. on Program Change Day, June 19. After June 19 only program changes for withdrawing from a class will be accepted.

VETERANS' INFORMATION

The Edwardsville Campus is approved for veterans. Veterans eligible for benefits under the G.I. Bill should contact the University veterans' adviser during registration periods. Public Law 550 expires in 1965. War orphans should discuss Public Law 634 benefits with the veterans' adviser.

To be eligible for Public Law 550 benefits, the veteran must be fully admitted and enrolled as a regular classified student making satisfactory progress in a degree program.

VETERANS' SIGN-UP PERIOD

Veterans eligible for benefits will sign a monthly attendance certification on the following dates at the Registrar's Office in Alton or East St. Louis.

Period	Date	Time
June 17 to June 30	June 28	9:00 A.M.-12 noon, 1-4:30 P.M.
July 1 to July 31	July 31	9:00 A.M.-12 noon, 1-4:30 P.M.
August 1 to August 9	August 9	9:00 A.M.-12 noon, 1-4:30 P.M.
August 1 to August 30	August 30	9:00 A.M.-12 noon, 1-4:30 P.M.

Checks for the summer session should not be expected before September 20. Veterans who fail to sign on the specified date will probably experience delay in receiving the check for that period.

STUDENT RESPONSIBILITY

Each student must assume responsibility for his progress by keeping an up-to-date record of the courses he has taken and by checking periodically with his adviser and the Registrar's Office. Responsibility for errors in program or in interpretation of regulations of the University rests entirely with the student.

STUDENT EMPLOYMENT

Students interested in part-time employment on campus during the summer should make early application to the office of Student Employment, Southern Illinois University, Alton, Illinois, or East St. Louis, Illinois.

WORKSHOP

Workshop in Intergroup Relations (Sociology 388-3) first two weeks of the summer session, Monday through Friday, 1:00-6:00. The course offers theoretical and practical understanding of cultural, social, and psychological factors associated with intergroup tensions. Students concentrate their efforts on problem-solving activities related to their occupational, professional, or civic interests. Resource and consultative staff from the academic areas of education, psychology, sociology, and social work will be utilized. The course should be particularly valuable for the staffs of health and welfare agencies and for community leaders.

Schedule of Classes

THE FOLLOWING MATERIAL may be of value in interpreting the information appearing in the schedule.

LISTING OF COURSES

Courses are listed numerically within each subject-matter area. Areas in which courses are listed for the 1963 summer session appear below in the order of their appearance in the schedule.

SUBJECT AREA	DIVISION
General Studies (GSA), (GSB), (GSC), (GSD), (GSE)	
Accounting (ACCT)	Business
Anthropology (ANTH)	Social Sciences
Art (ART)	Fine Arts
Chemistry (CHEM)	Science and Technology
Comparative Literature (C LT)	Humanities
Economics (ECON)	Business
Education	Education
Administration (ED AD)	Education
Elementary (ED EL)	Education
Secondary (ED SEC)	Education
Special (ED SP)	Education
English (ENG)	Humanities
Foreign Languages (FL)	Humanities
French (FR)	Humanities
German (GER)	Humanities
Geography (GEOG)	Social Sciences
Government (GOV)	Social Sciences
Guidance (GUID)	Education
Health Education (H ED)	Education
History (HIST)	Social Sciences

Instructional Materials	(I M)	Education
Management	(MGT)	Business
Marketing	(MKTG)	Business
Mathematics	(MATH)	Science and Technology
Music	(MUS)	Fine Arts
Physical Education—Men	(PEM)	Education
Physical Education—Women	(PEW)	Education
Physics	(PHYS)	Science and Technology
Physiology	(PHSL)	Science and Technology
Psychology	(PSYC)	Education
Radio-Television	(R-T)	Fine Arts
Secretarial Science	(SEC SCI)	Business
Sociology	(SOC)	Social Sciences
Zoology	(ZOO)	Science and Technology

COURSE NUMBER AND HOURS

The column containing this information shows the number of the course first, followed by the number of hours of credit. Course numbers are three digit numbers. In some cases the three digits may be followed by a letter which is also part of the course number. The number appearing after the hyphen denotes the hours of credit for the course. In some cases there may be more than one number following the course number such as 599-2 to 5. This represents a variable-hour course in which the student, in consultation with his adviser, decides the number of hours for which he is going to register.

The course numbering system is as follows:

- 000-099 Courses not properly falling in the following categories
- 100-199 For freshmen
- 200-299 For sophomores
- 300-399 For juniors and seniors
- 400-499 For seniors and graduate students
- 500-600 For graduate students only

PREREQUISITES

For the guidance of students many courses list prerequisites needed before the course under question can be taken. These prerequisites may be listed in a number of different ways. If only a number appears, it refers to a course in the same subject area. If the course is in another area, that area will be listed prior to the number. On advanced levels, registration for a course may require the consent of the instructor.

COURSES “TO BE ARRANGED”

Students registering for courses listed as “to be arranged” should consult the instructor indicated or the head of the division if no instructor is listed, to determine time and place of meeting.

ALTON CENTER

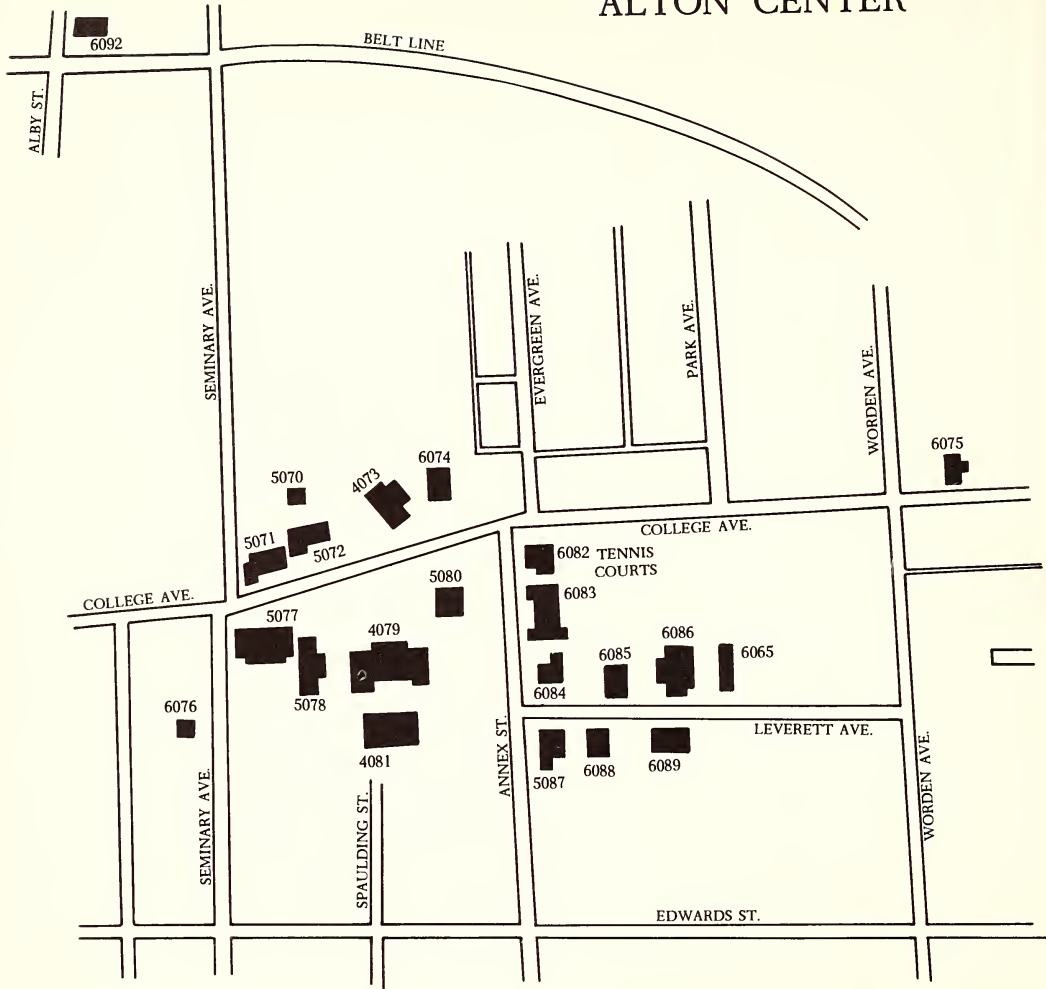

- 4073 Student Union (SU)
 - Student Affairs
 - Student Employment and Placement
 - Health Service
- 4079 Science (SCI)
- 4081 Gymnasium (GYM)
- 5070 Storage
- 5071 Registrar's Office and Business Office
- 5072 Book Store
- 5077 Library
- 5078 Fine Arts A (FAA)
- 5080 Auditorium (AUD)
- 6065 Graduate Advisement Office
- 6074 Fine Arts C (FAC)

- 6075 Education
- 6076 Language Laboratory (LL)
- 6082 Annex B (ANB)
- 6083 Annex A (ANA)
- 6084 Fine Arts B (FAB)
- 6085 Humanities (HUM)
- 6086 Administration
 - General Office
 - Division Heads' Office
- 6087 Classrooms (HH)
- 6088 Social Sciences (SS)
- 6089 Business Faculty Offices
- 6092 Brick Yard Building (BY)
 - Madison County Mental Health Clinic

EAST ST. LOUIS CENTER

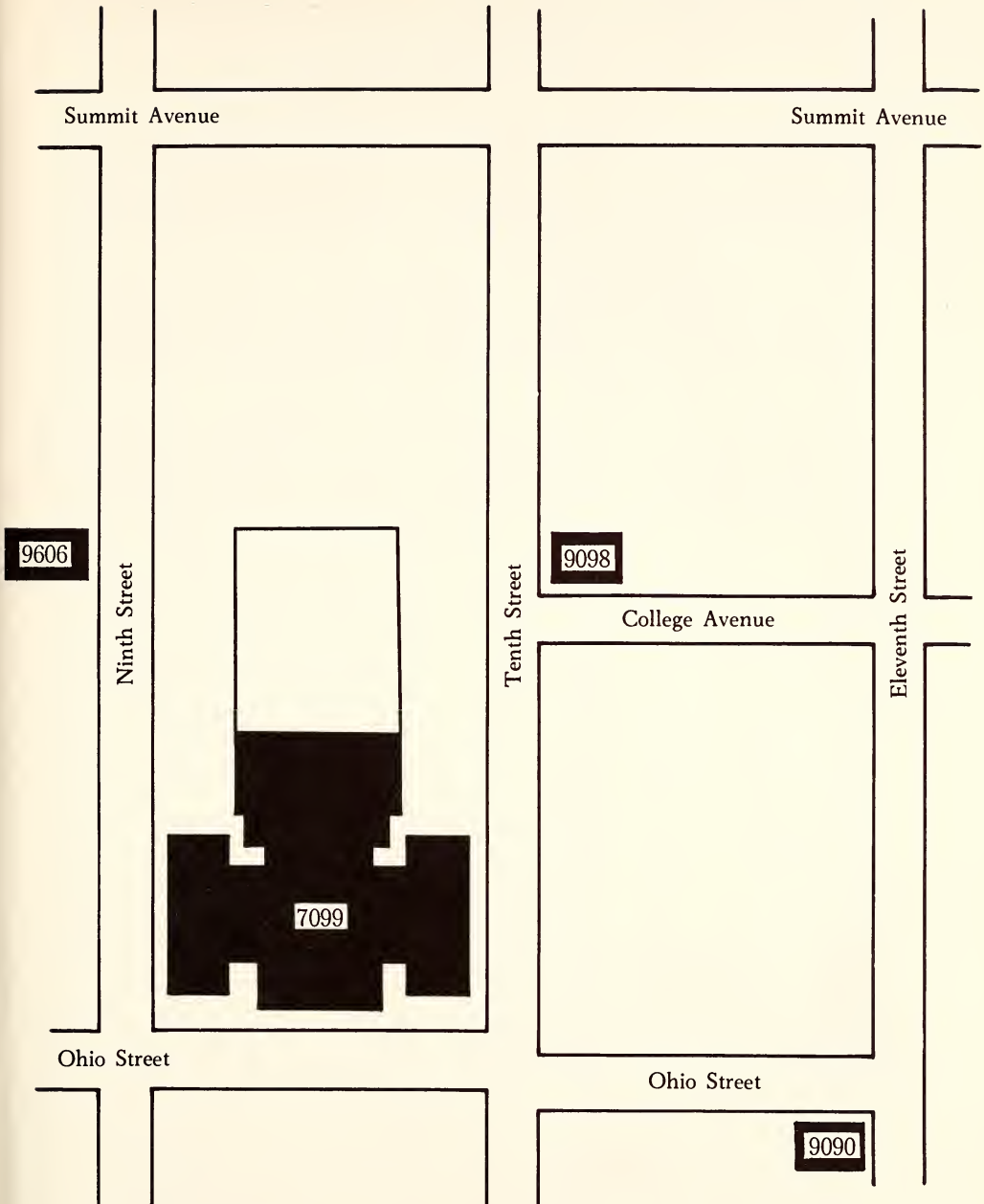

LEGEND: Building 7099: Main Building
 Building 9090: Faculty Offices
 Building 9096: Faculty Offices
 Building 9098: Faculty Offices

Title	Course No. & Hours	Remarks	Section No. Alton E. St. Louis	Time	Days	Room	Instructor
GENERAL STUDIES AREA A—MAN'S PHYSICAL ENVIRONMENT AND BIOLOGICAL INHERITANCE (GSA)							
Introduction to Physical Science III	153-3	Prereq.: 152. Students enroll in lecture and one laboratory section	Lecture 1 2	† 8:55-9:45 † 8:55-10:45 † 10:30-12:20 † 8:55-9:45 † 9:45-11:35 † 9:45-11:35 † 9:45-11:35 1:10-2:25	M F W M Tu Th Tu W Th M W F	SCI 200 SCI 206 SCI 206 113 125 125 125 125 A	Parrill Parrill Parrill Rands Staff Staff Staff Shaw
Astronomy	356-3	Prereq.: 153 or Physics 297.					
GENERAL STUDIES AREA B—MAN'S SOCIAL INHERITANCE AND SOCIAL RESPONSIBILITIES (GSB)							
A Survey of Western Tradition— Geographic Background	151-3		1	† 8:55-9:45 † 11:45-12:35	MTu Th MTu Th	ANA 110 225	Shaden Shaden
Introduction to the Western Tradition	152-3	Prereq.: 151.	E1	† 6:45-8:10 † 8:55-9:45	M W MTu Th	AUD 100 105	Kimball S Cohen
Introduction to the Western Tradition	153-3	Prereq.: 152.	1	† 1:10-2:00 † 1:10-2:00	MTu Th MTu Th	AUD 103 105	Kimball S Cohen
GENERAL STUDIES AREA C—MAN'S INSIGHTS AND APPRECIATIONS (GSC)							
Introduction to Poetry	151-3		1B	† 7:30-8:20 † 6:20-8:10	MTuWTh Tu Th	AUD 103 220	Duncan Shea
Logic	152-3		1 E2	† 10:20-11:10 † 6:20-7:45 † 10:20-11:10 † 8:20-9:45 † 7:30-8:20	MTu Th M W MTu Th Tu Th M W F	AUD 103 103 204 103 221	Shea Linden Linden Howerton Kemper
Art Appreciation	153-3		1	† 7:30-8:20	MTu Th	FAA 104	Headley
Music Understanding	154-3		1	† 8:55-9:45	M W F	FAC 203	Headley
Literary and Philosophical Masterpieces I	251-3		1 E2	† 11:45-12:35 † 8:55-9:45 † 6:20-7:45 † 10:20-11:10 † 6:20-7:45	M W F MTu Th Tu Th MTu Th Tu Th	212 AUD 103 AUD 103 203 103	Duncan Ades Murdock Linden Kresteff
Music in History	255-3		1	† 6:20-7:45 † 7:30-8:20	Tu Th M W F	103 FAC 203	
				† Summer quarter			

GENERAL STUDIES AREA D—ORGANIZATION AND COMMUNICATION OF IDEAS (GSD)

English Composition	151-3	Prereq.: Test score necessary for all sections.	IB E2B	† 10:20-11:10 † 6:20-8:10 † 11:45-12:35	MTuWTh M W MTuWTh Tu Th	Ades Ades Murdoch Murdoch
Oral Communication of Ideas	153-3		1 E2	† 8:55-9:45 † 6:20-8:10 † 8:55-9:45	MTuWTh M W MTuWTh Tu Th	101 101 106 106
Introduction to Mathematics	157-3		1	† 6:20-8:10 † 10:20-11:10	Tu Th M WTh	Smith Cornwell Cornwell Gwillim

GENERAL STUDIES AREA E—HEALTH AND PHYSICAL DEVELOPMENT (GSE)

Healthful Living	251-3		1	† 11:45-12:35 † 8:55-9:45	MTuWTh MTuWTh	Spear Spear
------------------	-------	--	---	------------------------------	------------------	----------------

ACCOUNTING (ACCT)

Elementary Accounting I	251-4		1	† 11:45-12:35 † 6:20-10:10	MTuWTh M W	Miles Small
Elementary Accounting III	253-4		E1	† 8:20-10:10	M W	Miles
Problems in Federal Taxation	432-4	Prereq.: 331.		† 8:20-10:10	Tu Th	Small
Accounting Systems	458-4	Prereq.: 341 and 353.	E1	5:30-8:10 5:30-8:10	Tu Th M W	Small Miles

ANTHROPOLOGY (ANTH)

Man and Culture	310-4		E1	6:00-8:40 1:10-2:25	M W MTuWTh	E Schusky E Schusky
-----------------	-------	--	----	------------------------	---------------	------------------------

ART (ART)

Beginning Ceramics	203-4	Prereq.: 15 hours of 100.	1	† 8:55-10:45	MTuWTh	Howerton
Art Education	300-4		1	8:55-10:45 8:55-10:45	MTuWTh MTuWTh	Buddemeyer Milovich
Studio	325-4	Prereq.: Consent of instructor.	1	1:10-3:50	MTuWTh	Richardson
				† Summer quarter		

Title	Course No. & Hours	Section No. Alton E. St. Louis	Time	Days	Room	Instructor
CHEMISTRY (CHEM)						
Inorganic and Qualitative Analysis	113-5	1	† 7:30-8:20 † 7:30-10:20 † 6:00-7:15 † 7:30-9:00 † 6:00-9:00	M W F Tu Th Tu Th W	SCI 201 SCI 206 113 125 125	Parrill Parrill Rands Rands Probst
COMPARATIVE LITERATURE (C LT)						
The Novel Since 1900	315-4					
			Prereq.: Second-level general studies requirement.		104	P Guenther
ECONOMICS (ECON)						
Survey of Economic Principles	205-5	1	† 10:20-11:10	MTuWThF	AUD 101	Schwier
Economic Principles & Problems	206-4		† 7:30-8:20	MTuWThF	104	L Cohen
Money and Banking I	315-4	1	† 8:55-9:45	MTuWTh	AUD 101	Schwier
Intermediate Theory	440-3	E1	5:30-8:10 8:20-10:20	M W Tu Th	104 AUD 101	L Cohen Schwier
Workshop in Economic Education	490-4		8:55-10:10	MTuWTh	204	L Cohen
EDUCATION—ADMINISTRATION (ED AD)						
The American Educational Systems	331-3	1	7:30-8:45	MTuW	AUD 101	Wilkins
Philosophy of Education	355-4	1	8:55-10:10 11:45-1:00 10:20-11:35	MTuWTh MTuWTh MTuWTh	AUD 200 113 105	Curry Curry Smith
Legal Basis of American Education	420-4		8:55-10:10 7:30-8:45	MTuWTh MTuWTh	104 106	Wheat Southwood
School Administration	424-4					
History of Education in the United States	431-4					
School Supervision	456-4		1:10-2:25	MTuWTh	203	Jung
Research Methods	500-4		2:35-3:50	MTuWTh	203	Steinkeller
Contrasting Philosophies of Education	554-4		11:45-1:00	MTuWTh	103	Wheat
			† Summer quarter			

EDUCATION—ELEMENTARY (ED EL)

Elementary School Methods Materials and Methods in Elementary School Science	314-4 442-4	Prereq.: Guid 305.	51 51	1:10-2:25 7:30-8:45	MTuWTh MTuWTh	204A 204	Carpenter Bliss
Improvement of Reading Instruction	505-4	Not for students who have had 337 or 437.	51	11:45-1:00	MTuWTh	204A	Steinkellner
Diagnosis and Correction of Reading Disabilities	521-4	Not open to students who have had 437.	51	11:45-1:00	MTuWTh	105	Bear
Selected Teaching and Curriculum Problems in Elementary School Science	541-4	No credit for students who have had 442.	51	7:30-8:45	MTuWTh	204	Bliss
Teaching the Social Studies in the Elementary School	543-4	No credit for students who have had 544.	51	10:20-11:35	MTuWTh	221	Carpenter
The Elementary School Curriculum	561-4	Not open to students who have had Ed El 461.	51	8:55-10:10	MTuWTh	221	Bear

EDUCATION—SECONDARY (ED SEC)

High School Methods Teaching the Social Studies in Secondary Schools	315-4 488-4	Prereq.: 315 or consent of instructor.	51 51	1:10-2:25 7:30-8:45	MTuWTh MTuWTh	103 203	Smyers Smith
Workshop in Economic Education	490-4		51	8:55-10:10	MTuWTh	204	L Cohen
Improvement of Reading Instruction	505-4		51	11:45-1:00	MTuWTh	204A	Steinkellner
Diagnosis and Correction of Reading Disabilities	521-4	Not open to students who have had 437.	51	11:45-1:00	MTuWTh	105	Bear
Workshop in High School Curriculum	562-4		51	10:20-11:35	MTuWTh	124A	Smyers

EDUCATION—SPECIAL (ED SP)

Problems and Characteristics of the Mentally Retarded	410-4	Prereq.: Guid 305 or Psych 301 or 303.	51	1:10-2:25	MTuWTh	205	Tucker
Directed Observation of Exceptional Children	413-4	Prereq.: Consent of instructor.	51	1:10-2:25	MTuWTh	205	Tucker
Methods and Materials for Teaching Exceptional Children	420-4		51	7:30-8:45	MTuWTh	225	Tucker

ENGLISH (ENG)

A Survey of American Literature since 1860	310-4		51	10:20-11:35	MTuWTh	222	Zanger
--	-------	--	----	-------------	--------	-----	--------

Title	Course No. & Hours	Remarks	Section No. Alton	E. St. Louis	Time	Days	Room	Instructor
ENGLISH (ENG) (Continued)								
English Literature, 1550 to 1750	316-4			51	11:45-1:00	MTuWTh	222	Marion Taylor
Usage in Spoken and Written English	391-3		E1	51	6:10-8:10	Tu Th	AUD 102	Marion Taylor
Eighteenth Century Nondramatic English Literature	414-4			51	7:30-8:45	MTu Th	220	Slattery
				51	8:55-10:10	MTuWTh	203	Slattery
American Humor and Satire	447-4			51	10:20-11:35	MTuWTh	224	Austin
Studies in Early Nineteenth Century American Writers. (The Transcendentalist Circle)	534-4			51	11:45-1:00	MTuWTh	106	Zanger
Studies in Later Nineteenth Century American Writers	536-4			51	7:30-8:45	MTuWTh	222	Austin
FOREIGN LANGUAGES (F L)								
FRENCH (FR)								
French Language and Culture	544-6		1		7:30-10:10	MTuWTh	HUM 100	Pellegrino
Professional Preparation	546-3		1		10:20-1:00	MTuWTh	HUM 100	Pellegrino
GERMAN (GER)								
German for Graduate Students	161-0	Meets eight weeks only.	1		7:30-8:45	MTuWTh	AUD 102	Staff
GEOGRAPHY (GEOG)								
Economic Geography	211-5			E51	† 5:55-8:10	Tu Th	225	Snaden
Geography of Illinois	313-3	Prereq.: GSB 151 or equivalent.	E1		6:00-8:00	M W	ANA 110	Vogel
Geography of Anglo-America	314-4	Prereq.: GSB 151 or equivalent.		51	8:55-10:10	MTuWTh	225	Vogel
Geography of Europe	315-4	Prereq.: GSB 151 or equivalent.	1		10:20-11:35	MTuWTh	ANA 110	Kazeck
Regional Problems in Conservation	424-4	Prereq.: GSB 151, 324, or equivalent.	1		11:45-1:00	MTuWTh	ANA 110	Kazeck
GOVERNMENT (GOV)								
American Government	210-4		E1		† 5:30-7:20	M W	SCI 102	Struif
					† Summer quarter			

Development of the American Constitution	305-4	Prereq.: 190 (210) or equivalent.	E51	6:00-8:40	Tu Th	105	Lovell
Illinois Government	330-2	Prereq.: 190 (210) or 231.	E1	5:30-8:10	Tu	SCI 2	Mann
Introduction to Public Administration	360-4	Prereq.: 190 (210) or equivalent.	1	5:30-8:10	M	103	Mann
Problems of American Foreign Policy	371-4	Prereq.: 243.		1:10-2:25	MTuWTh	AUD 102	Schwab
Great Britain and the British Empire	456-4	Prereq.: 390 or consent of instructor.	51	11:45-1:00	MTuWTh	124A	Lucatz
Metropolitan Studies and Research	473-3	Prereq.: 360 or 465 or consent of instructor.	1	2:35-3:50	MTuWTh	103	Lucatz
				10:20-11:35	MTu Th	SS 105	Schwab

GUIDANCE (GUID)

Educational Psychology	305-4	Prereq.: Psysc 201.	1 E2	11:45-1:00	MTuWTh	SCI 200	Steinbrook
				6:00-8:40	M W	SCI 200	Kuenzli
Mental Hygiene	412-4	Prereq.: 305.	51	10:20-11:35	MTuWTh	113	Southwood
Educational Measurements I	422-4	Prereq.: 305.	E52	6:00-8:40	Tu Th	204	Troyer
Basic Principles of Guidance	442-4	Prereq.: 305.	51	7:30-8:45	MTuWTh	103	Rasmussen
Counseling Theory and Practice I	537-4	Prereq.: 442 or consent of instructor.	51	2:35-3:50	MTuWTh	220	Taliana
			51	10:20-11:35	MTuWTh	204A	Soper
Adolescent Development in Education	562B-4	Prereq.: 412.	51	11:45-1:00	MTuWTh	221	Soper
				2:35-3:50	MTuWTh	221	Troyer

HEALTH EDUCATION (H ED)

Workshop in Driver Education and Traffic Safety	415S-4	Prereq.: 302S or equivalent.	51	7:30-8:45	MTuWTh	205	Spear
---	--------	------------------------------	----	-----------	--------	-----	-------

HISTORY (HIST)

The United States Since 1865	202-4		1	† 11:45-12:35	MTuWTh	AUD 100	Haas
The Age of Absolutism and the Enlightenment	314-4	Prereq.: GSB 152 and 153.	1	† 8:55-9:45	MTuWTh	103	Haas
The Revolution and the Constitution	330-4	Prereq.: 201.	51	1:10-2:25	MTuWTh	AUD 100	Erickson
				7:30-8:45	MTuWTh	105	McCurry

† Summer quarter

Title	Course No. & Hours	Remarks	Section No.		Time	Days	Room	Instructor
			Alton	E. St. Louis				
HISTORY (HIST) (Continued)								
The Age of the Renaissance	415-4	Prereq.: GSB 152 and 153.		51	10:20-11:35	MTuWTh	103	Erickson
Recent United States History	436-3	Prereq.: 202.	1		11:45-1:00	MTu Th	AUD 101	Rosenthal
Recent United States History	437-3	Prereq.: 202.		51	2:35-3:50	MTu Th	104	Riddleberger
INSTRUCTIONAL MATERIALS (IM)								
Audio-Visual Methods in Education	417-4	Prereq.: Guid 305.		51	10:20-11:35	MTuWTh	106	Bliss
MANAGEMENT (MGT)								
Production Management	380-4	Prereq.: Econ 206.		E51	5:30-8:10	M W	221	Ingwersen
Personnel Management	385-4	Prereq.: Econ 206.		E51	5:30-8:10	Tu Th	221	Ingwersen
Management of Business Finance	421-4	Prereq.: 320.	1		8:55-10:10	MTuWTh	AUD 102	Blackledge
Business Enterprise & Public Policy	473-4	Prereq.: Senior standing.	E1		5:30-8:10	Tu Th	AUD 101	Blackledge
MARKETING (MKTG)								
Principles of Marketing	230-5	Prereq.: Econ 205 or GSB 255	E1		† 5:55-8:10	M W	AUD 101	Vincent
Retailing	331-4	Prereq.: 230.	1		7:30-8:45	MTuWTh	AUD 101	Vincent
Purchasing	336-3	Prereq.: 230.		E51	8:20-10:20	M W	104	Bosse
Transportation	341-4	Prereq.: 230.		51	11:45-1:00	MTuWTh	104	Bosse
Sales Management	438-4	Prereq.: 230 and 337 or consent of instructor.	1		10:20-11:35	MTuWTh	ANA 101	Vincent
MATHEMATICS (MATH)								
Elementary Mathematics	100-0	Prereq.: 3 semesters of high school algebra, satisfactory score on placement test.	1	51	† 1:10-2:00	MTuWTh	220	Probst
Elementary Analysis I	111-5	Prereq.: 253 or concurrent enrollment.			† 8:55-10:10	MTuWThF	SCI 3	Gwillim
The Real Number System	300-4	Prereq.: 320, Ed Sec 315.	1		8:55-10:10	MTuWTh	SCI 103	Pendergrass
The Teaching of Secondary Mathematics	311-3		E1		6:10-8:10	M W	SCI 103	Pendergrass
					† Summer quarter			

Solid Analytic Geometry	313-4	Prereq.: 150.	51	10:20-11:35	MTuWTh	220	Williams
The Structure of Elementary School Mathematics	446-4	Prereq.: Experience in elementary teaching and consent of instructor.	51	11:45-1:00	MTuWTh	220	Oursler
The Structure of Secondary School Mathematics	447-4	Prereq.: Experience in secondary teaching and consent of instructor.	51	11:45-1:00	MTuWTh	204	Williams
Modern Geometry	460-4	Prereq.: 20 hours of college mathematics.	51	1:10-2:25	MTuWTh	221	Oursler

MUSIC (MUS)

Class Piano	040-1	May be taken with 200.	51	10:20-11:35	M W F	212	Warren
Piano	041-1 to 4		51	Arranged	Arranged	212	Warren
Class French Horn	050A-1		1	8:55-10:10	M W F	100	Fjerstad
Class Trumpet	050B-1		1	8:55-10:10	M W F	100	Fjerstad
Class Trombone	050C-1		1	8:55-10:10	M W F	100	Fjerstad
Class Tuba	050D-1		1	8:55-10:10	M W F	100	Fjerstad
Class Baritone	050E-1		1	8:55-10:10	M W F	100	Fjerstad
Fundamentals of Music	200-3	May be taken with 040.	51	† 11:45-12:35	M W F	212A	Kresteff
Music Education—Elementary	300-3	Prereq.: 200 or equivalent.	1	10:20-11:35	M W F	FAC	203
Music Education in the Elementary School	301-3	For music concentration only.	51	11:45-1:00	M W F	112	Fjerstad
Teaching Techniques and Materials for the Intermediate Levels (Piano)	461-2		51	10:20-11:35	M W F	FAC	203
			51	11:45-1:00	M W F	112	Blakely
			51	8:55-10:10	M W	212	Fjerstad
							Warren

PHYSICAL EDUCATION—MEN (PEM)

Required Physical Education (Tennis)	252-1		1	† 8:55-9:45	M W	Gym	Showers
(Badminton)			51	† 10:20-11:10	Tu Th	Gym	Showers
Required Physical Education (Golf)	253-1		1				
(Golf)			51	† 10:20-11:10	M W	Gym	Showers
Bowling	254-1	Bowling rental charge \$5.00.	51	† 8:55-9:45	Tu Th	Gym	Showers
			51	† 11:45-12:35	M W	Gym	Showers
			51	† 11:45-12:35	Tu Th	Gym	Showers
Methods and Materials for Teaching Physical Activities in the Elementary School	350-4	For physical education and elementary education concentration only.	51	† 10:20-11:35	MTuWTh	Gym	Klein
Curriculum in Physical Education	501-4		51	1:10-2:25	MTuWTh	104	Klein
				† Summer quarter			

SECRETARIAL SCIENCE (SEC SCI)

Teaching Bookkeeping and Accounting	408-3	Prereq.: Acct 253 or equivalent.	1	10:20-11:35	MTu Th	ANA 100	Brady
Research in Business Education	502-4		1	11:45-1:00	MTuWTh	ANA 101	Brady

SOCIOLOGY (SOC)

Social Problems	102-4						
Marriage and Parenthood	241-4		51	† 8:55-9:45	MTuWTh	224	D Taylor
Race and Minority Group Relations	320-4		51	† 11:45-12:35	MTuWTh	224	D Taylor
Juvenile Delinquency	373-4		51	7:30-8:45	MTuWTh	224	Seymour
Workshop in Inter-Group Relations	388-3	Prereq.: Consent of instructor.	1	10:20-11:10	MTuWTh	AUD 100	Rudwick
		First two weeks of summer session.	1	1:00-6:00	MTuWThF	AUD 200	Rudwick
Survey Course in Marriage Counseling	484-4	Prereq.: Consent of instructor.	E51	6:00-8:40	Tu Th	224	D Taylor

ZOOLOGY (ZOO)

Principles of Animal Biology	100-5	Students enroll in lecture and one laboratory section.	Lecture 51 52	† 7:30-8:20 † 7:30-9:20 † 8:30-10:10	M W F Tu Th M W	113 116 116	Ratzlaff Ratzlaff Ratzlaff
				† Summer quarter			

Quarter _____ Year _____

The student will prepare a program on this form to be presented to his academic adviser at the time of advisement.

STUDENT	(<i>Last</i>)	(<i>First</i>)	(<i>Middle</i>)	(<i>Record Number</i>)
---------	-----------------	------------------	-------------------	--------------------------

ADDRESS

(Number and Street)

(City and State)

(Phone Number)

CONCENTRATION	SECONDARY CONCENTRATIONS
---------------	--------------------------

CLASS _____ Day () _____ Evening () _____ Number of hours student works _____

[illegible]

Year _____

of advisement.

(Record Number)

(Phone Number)

100

[illegible]

Quarter _____ Year _____

academic adviser at the time of advisement.

STUDENT

	(<i>Last</i>)	(<i>First</i>)	(<i>Middle</i>)	(<i>Record Number</i>)
1				
2				
3				
4				
5				
6				
7				
8				
9				
10				
11				
12				
13				
14				
15				
16				
17				
18				
19				
20				
21				
22				
23				
24				
25				
26				
27				
28				
29				
30				
31				
32				
33				
34				
35				
36				
37				
38				
39				
40				
41				
42				
43				
44				
45				
46				
47				
48				
49				
50				
51				
52				
53				
54				
55				
56				
57				
58				
59				
60				
61				
62				
63				
64				
65				
66				
67				
68				
69				
70				
71				
72				
73				
74				
75				
76				
77				
78				
79				
80				
81				
82				
83				
84				
85				
86				
87				
88				
89				
90				
91				
92				
93				
94				
95				
96				
97				
98				
99				
100				

ADDRESS _____

(Number and Street) (City and State) (Phone Number)

CONCENTRATION	SECONDARY CONCENTRATIONS
100	100
90	90
80	80
70	70
60	60
50	50
40	40
30	30
20	20
10	10
0	0

CLASS _____ Day () Evening () Number of hours student works _____

[illegible]



Southern Illinois University Foundation

The Southern Illinois University Foundation is a nonprofit corporation chartered by the state and authorized by the Board of Trustees to receive gifts for the benefit of the University, to buy and sell property, and otherwise to serve the University.

It respectfully asks alumni and other citizens of Southern Illinois to consider making gifts and bequests to benefit the University. Such gifts should be conveyed to the Foundation, with proper stipulation as to their uses. The Foundation, through its officers and members, will be glad to confer with intending donors regarding suitable clauses to insert in wills and suitable forms of gifts and memorials, including bequests by means of life insurance. Large or small gifts to the library will be appreciated; likewise, gifts for special equipment, buildings, endowment of professorships in particular subjects, gifts to student loan funds and scholarship funds, gifts for the use of foreign students, and endowments for particular sorts of research. Any gifts or bequests can be given suitable memorial names.

The staff members of the Foundation are

Mr. Kenneth R. Miller, *Executive Director*, Carbondale, Illinois

Mrs. Lois H. Nelson, *Secretary*, Carbondale, Illinois

Mr. Robert L. Gallegly, *Treasurer*, Carbondale, Illinois

Mr. C. Eugene Peebles, *Assistant Treasurer*, Edwardsville, Illinois

Mr. C. Richard Gruny, *Legal Counsel*, Carbondale, Illinois

Mr. L. James Struif, *Assistant Legal Counsel*, Edwardsville, Illinois

Mr. Donald Leavitt, *Patent Counsel*, St. Louis, Missouri

Mr. Warren Stookey, *Field Representative*, Edwardsville, Illinois.

