

1962

1962 Southern Illinois University Bulletin Edwardsville Campus (Summer Session)

Southern Illinois University Carbondale

Follow this and additional works at: http://opensiuc.lib.siu.edu/ua_bcc

Recommended Citation

, "1962 Southern Illinois University Bulletin Edwardsville Campus (Summer Session)." (Jan 1962).

This Article is brought to you for free and open access by the University Archives at OpenSIUC. It has been accepted for inclusion in SIU Bulletins and Course Catalogs by an authorized administrator of OpenSIUC. For more information, please contact opensiuc@lib.siu.edu.

Southern Illinois University

Bulletin



Summer Session

EDWARDSVILLE CAMPUS

1962

Objectives of Southern Illinois University

TO EXALT BEAUTY

IN GOD,
IN NATURE,
AND IN ART;
TEACHING HOW TO LOVE THE BEST
BUT TO KEEP THE HUMAN TOUCH;

TO ADVANCE LEARNING

IN ALL LINES OF TRUTH
WHEREVER THEY MAY LEAD,
SHOWING HOW TO THINK
RATHER THAN WHAT TO THINK,
ASSISTING THE POWERS
OF THE MIND
IN THEIR SELF-DEVELOPMENT;

TO FORWARD IDEAS AND IDEALS

IN OUR DEMOCRACY,
INSPIRING RESPECT FOR OTHERS
AS FOR OURSELVES,
EVER PROMOTING FREEDOM
WITH RESPONSIBILITY;

TO BECOME A CENTER OF ORDER AND LIGHT

THAT KNOWLEDGE MAY LEAD
TO UNDERSTANDING
AND UNDERSTANDING
TO WISDOM.

1962 Summer Session

Edwardsville Campus

June 18–August 10

June 18–August 31



SOUTHERN ILLINOIS UNIVERSITY BULLETIN
Volume 4 Number 3 March, 1962
Second-class postage paid at Carbondale, Illinois.
Published by Southern Illinois University, monthly
except in September, when published semimonthly.

The following issues of the *Southern Illinois University Bulletin* may be obtained without charge from General Publications, Southern Illinois University, Carbondale, Illinois.

General Information
Summer Session (Carbondale)
Summer Session (Edwardsville)
Schedule of Classes (Carbondale)
Schedule of Classes (Edwardsville)
General Announcements (Edwardsville)
Graduate School
College of Education
College of Liberal Arts and Sciences
School of Agriculture
School of Applied Science
School of Business
School of Communications
School of Fine Arts
School of Home Economics
University Institutes
Division of Technical and Adult Education

All intending students should have the General Information Bulletin (issued once a year), plus the special bulletins of the various educational units in which they are most interested.

Board of Trustees

	TERM EXPIRES
JOHN PAGE WHAM, <i>Chairman</i> , Centralia	1965
KENNETH L. DAVIS, <i>Vice-Chairman</i> , Harrisburg	1963
MELVIN C. LOCKARD, <i>Secretary</i> , Mattoon	1965
MARTIN VAN BROWN, Carbondale	1967
HAROLD R. FISCHER, Granite City	1963
ARNOLD H. MAREMONT, Winnetka	1967
LINDELL W. STURGIS, Metropolis	1965
GEORGE T. WILKINS (<i>Ex-officio</i>), Springfield	
LOUISE MOREHOUSE, <i>Recorder</i>	

Officers of Instruction

DELYTE W. MORRIS, *President*
CHARLES D. TENNEY, *Vice-President for Instruction*

EDWARDSVILLE CAMPUS

CLARENCE W. STEPHENS, *Vice-President for Operations*
WILLIAM T. GOING, *Dean of Instruction*
MILTON B. BYRD, *Associate Dean*

Registrar JOHN H. SCHNABEL

University Calendar, 1962-1963

SUMMER SESSION

Session Begins	Monday, June 18
Independence Day Holiday	Wednesday, July 4
Final Examinations (8-week Session)	Wednesday–Thursday, August 8–9
Commencement	Friday, August 10
Final Examinations (Summer Quarter)	Thursday–Friday, August 30–31
Quarter Ends	Friday, August 31

FALL QUARTER

New Student Week	Friday–Sunday, September 21–23
Quarter Begins	Monday, September 24
Thanksgiving Recess	Wednesday, 12 noon–Monday, 8 A.M. November 21–26
Final Examinations	Wednesday–Tuesday, December 12–18

WINTER QUARTER

Quarter Begins	Wednesday, January 2
Final Examinations	Wednesday–Tuesday, March 13–19

SPRING QUARTER

Quarter Begins	Wednesday, March 27
Memorial Day Holiday	Thursday, May 30
Final Examinations	Thursday–Wednesday, June 6–12
Commencement (Carbondale)	Thursday, June 13
Commencement (Edwardsville)	Friday, June 14

Summer classes begin on Tuesday, June 19. During the fall, winter, and spring quarters, day classes begin on the second day of the quarter. Evening classes (5:30 P.M. or later) begin on the first day of the quarter.

Registrar's Calendar

Summer, 1962

June 18 General registration for classes and workshops at Alton and East St. Louis. Students must register for classes at the center they plan to attend in accordance with the alphabetical registration calendar below.

8:00 A.M.— 9:00 A.M.	S-T
9:00 A.M.—10:00 A.M.	U-Z
10:00 A.M.—11:00 A.M.	A-C
11:00 A.M.—12:00 Noon	D-G

1:00 P.M.— 2:00 P.M.	H-K
2:00 P.M.— 3:00 P.M.	L-M
3:00 P.M.— 4:00 P.M.	N-R

6:00 P.M.— 8:00 P.M. Evening students only

June 19 Classes start 7:30 A.M.
 June 20 Program change day—last day to add classes.
 9:00 A.M.—12:00 Noon, 1:00 P.M.—4:00 P.M.,
 5:00 P.M.—7:00 P.M.
 June 28 Last day to withdraw from school to be eligible for a refund of fees.
 June 29 Last day for refund applications to be submitted to Registrar's Office for refund of fees.
 July 4 Independence Day Holiday.
 July 7 Last day to withdraw from eight-week courses (200 level and above) without receiving a letter grade.
 July 14 Last day to withdraw from summer quarter courses (100 level) without receiving a letter grade.
 July 21 Last day for withdrawal from school except under exceptional conditions.
 August 8-9 Final examinations for eight-week session.
 August 10 Commencement (Carbondale Campus).
 August 30-31 Final examinations for summer quarter.

Final Examination Schedule

All classes meeting for 3 hours or more credit will schedule two hour final examination periods. Classes granting less than 3 hours credit will meet for one hour examinations.

SUMMER SESSION, 1962

Wednesday, August 8

- 7:30 A.M. Classes that meet at 7:30 A.M.
- 9:45 A.M. Classes that meet at 10:20 A.M.
- 6:00 P.M. Classes that meet at 6:00 P.M. on Monday and Wednesday

Thursday, August 9

- 7:30 A.M. Classes that meet at 8:55 A.M.
- 9:45 A.M. Classes that meet at 11:45 A.M.
- 6:00 P.M. Classes that meet at 6:00 P.M. on Tuesday and Thursday

SUMMER QUARTER, 1962 EXTENDED SESSION 100 LEVEL COURSES

Thursday, August 30

- 7:30 A.M. Classes that meet at 7:30 A.M.
- 9:45 A.M. Classes that meet at 10:20 A.M.
- 6:00 P.M. Classes that meet at 6:00 P.M. on Monday and Wednesday

Friday, August 31

- 7:30 A.M. Classes that meet at 8:55 A.M.
- 9:45 A.M. Classes that meet at 11:45 A.M.
- 6:00 P.M. Classes that meet at 6:00 P.M. on Tuesday and Thursday

Maps of Edwardsville Campus

THE FOLLOWING MAPS have been prepared to acquaint the students with the facilities of the Alton center and the East St. Louis center.

EAST ST. LOUIS CENTER

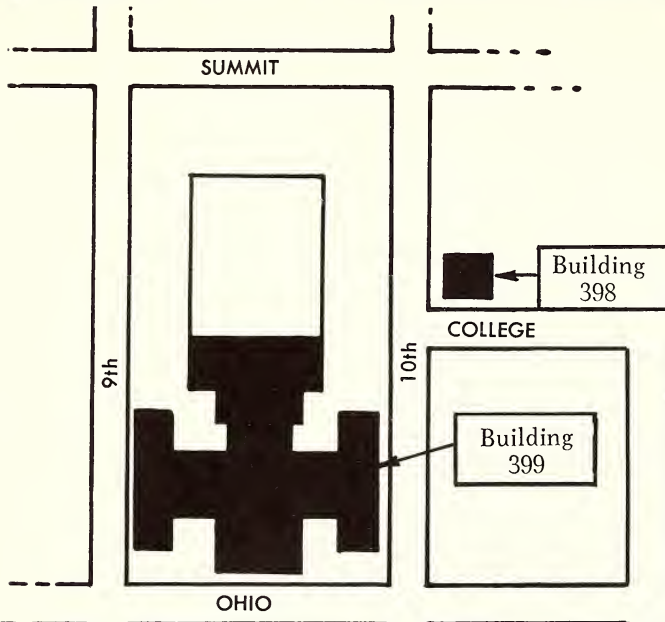

FIRST FLOOR

- A Cafeteria
- B Faculty Lounge
- C Student Lounge
- D Student Employment
- E Office of Student Affairs
- F Mechanics Room
- G Women's Gym
- H Women's Shower
- I Men's Shower
- J Men's Gym
- K Public Administration & Metropolitan Affairs
- L Library Areas
- M Librarian's Office

- ♂ —Men
- ♀ —Women

SECOND FLOOR

- N Machine Calculating Room
- O Academic Advisment
- P Evening Office
- Q Auditorium
- R Health Service
- S Divisional Offices
- T Mail Room
- U Business Office
- V Registrar's Office
- W University Store & Textbook Rental

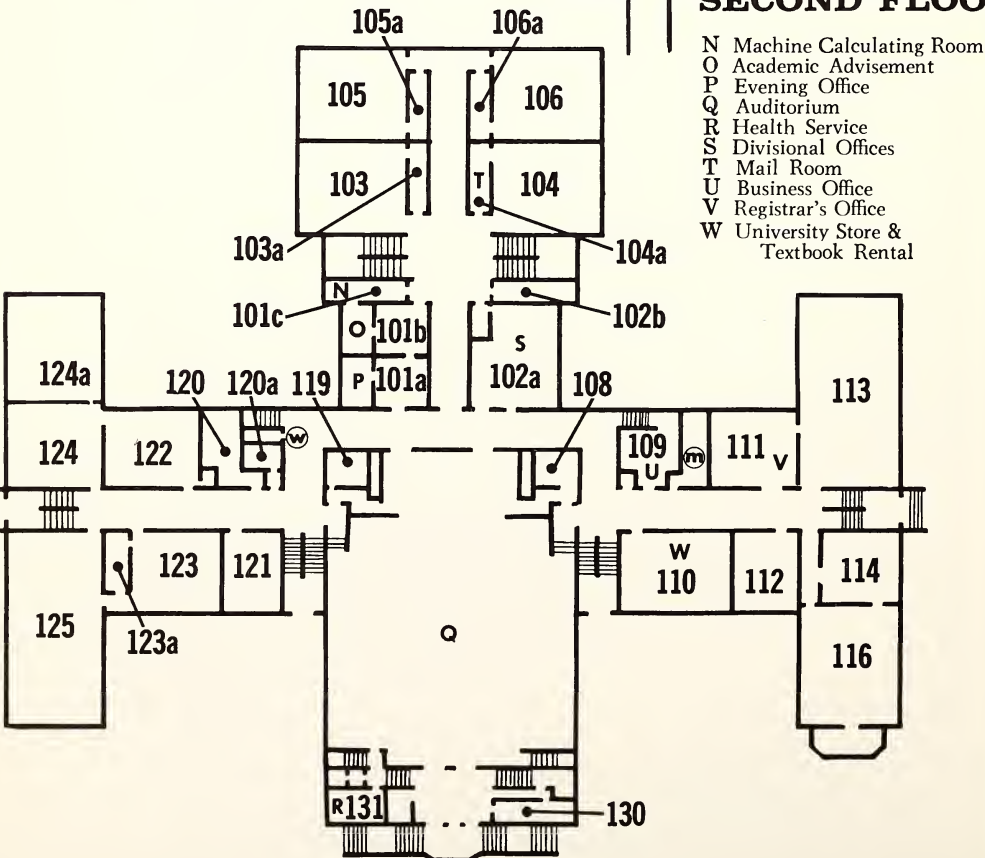

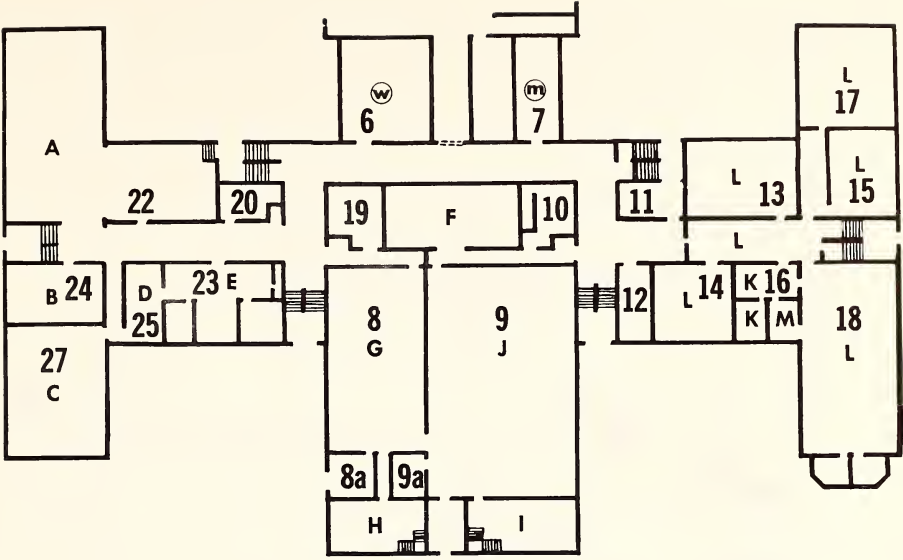

THIRD FLOOR

- X Auditorium
- Y Student Council
- Z Student Journalism
- (see below)

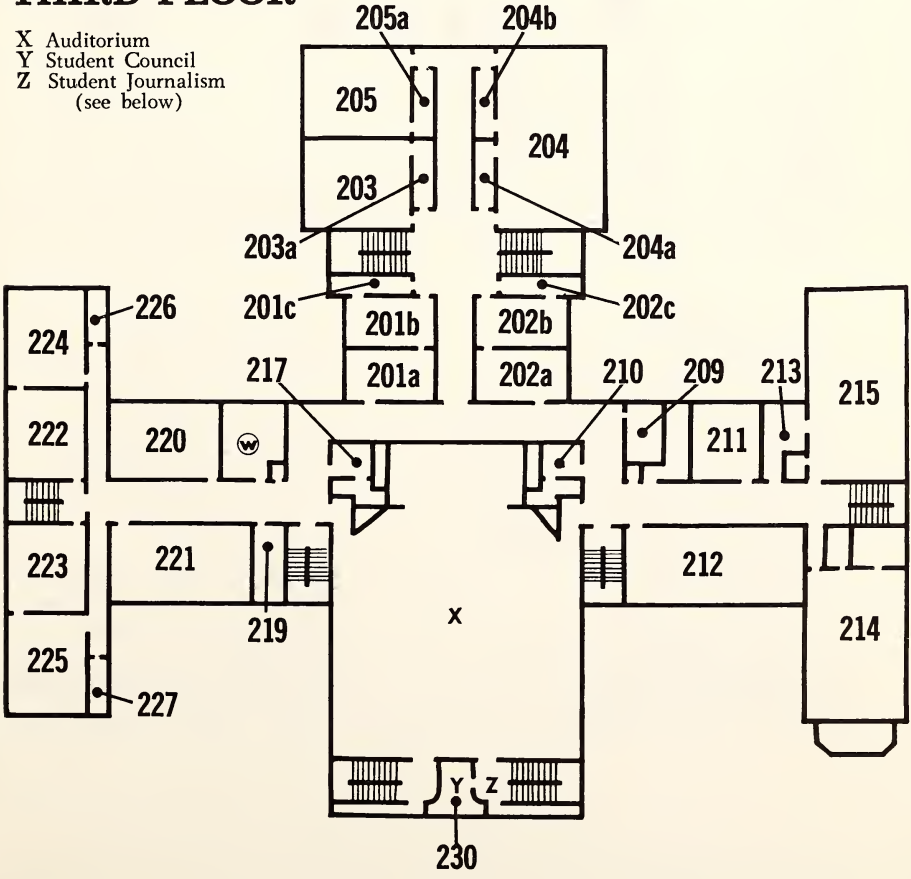

ALTON CENTER

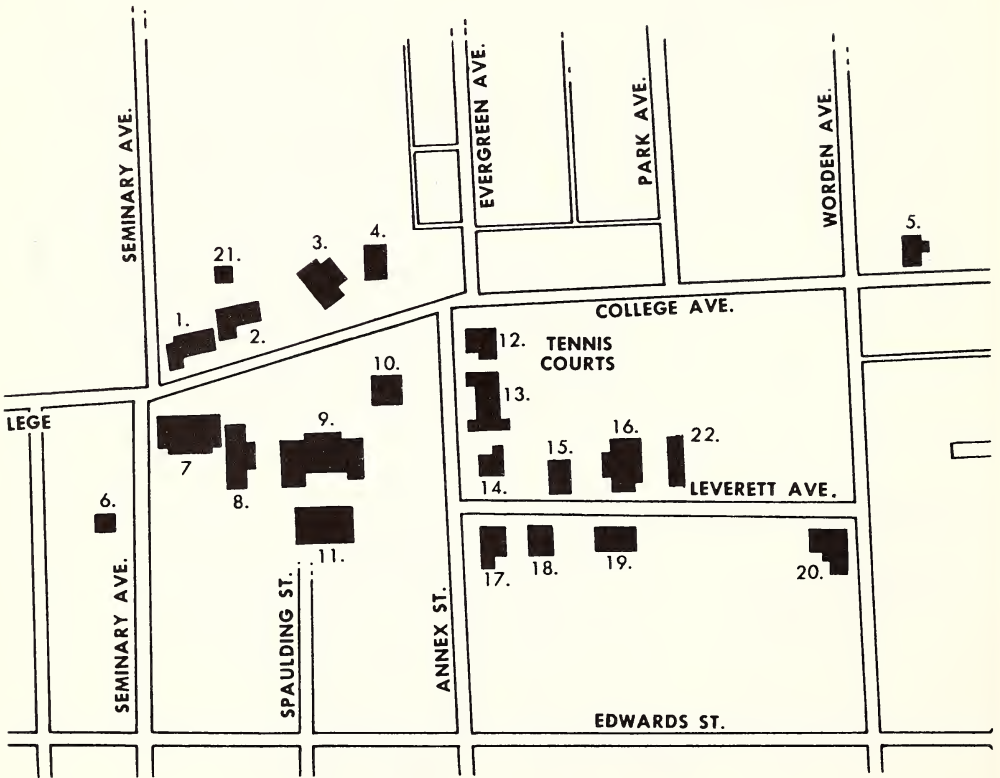

- | | |
|--|--|
| 1 Business Office | 12 Annex B (ANB) |
| 2 Registrar | 13 Annex A (ANA) |
| 3 Student Union, Student Affairs, Student Employment and Placement and Health Service (SU) | 14 Fine Arts B (FAB) |
| 4 Fine Arts C (FAC) | 15 Humanities (HUM) |
| 5 Education A—Madison County Mental Health Clinic (EDA) | 16 Administration Evening Division Offices Division Heads' Offices Graduate Office |
| 6 Language Laboratory | 17 Classrooms |
| 7 Library | 18 Social Studies (SS) |
| 8 Fine Arts A (FAA) | 19 Business Faculty Offices |
| 9 Science (SCI) | 20 Shurtleff Foundation |
| 10 Auditorium (AUD) | 21 Storage |
| 11 Gymnasium (Gym) | 22 Graduate Advisement Office |

General Information

The Edwardsville Campus of Southern Illinois University has scheduled a summer quarter, June 18 to August 31 and an eight week summer session, June 18 to August 10.

Classes on the 100 (freshman) level will be offered in the summer quarter. Classes numbered 200 and above will be offered in the eight week summer session.

Students may enroll for classes in either the eight week session, the summer quarter, or a combination of both in accordance with regular academic load policy.

The Edwardsville Campus offers courses leading toward associate's bachelor's and master's degrees in selected fields.

A variety of course offerings have been scheduled to meet the specific needs of (1) Teachers in service, (2) Freshmen—beginning and refresher courses, (3) Upperclassmen—basic requirements, (4) Graduate students, and (5) Liberal Arts graduates and individuals on temporary certificates desiring teacher certification.

In addition to the regular course offerings, a number of workshops and seminars will be held at each center.

ADMISSION

Application for admission to the summer session should be initiated with the Admission Office on or before June 1 to permit all necessary processing work to be completed by the start of the session. A general admission requirement is the filing of a transcript of record covering all previous high school and college work. Transcripts should be mailed to the Admission Office from the institution(s) attended and should reach the Admission Office prior to June 10, 1962.

An undergraduate student attending another institution who expects to graduate therefrom and who desires to attend Southern during the summer session only will be admitted on the basis of a letter of good standing from the registrar of the institution the student is attending.

ADMISSION OF FRESHMAN STUDENTS

To be eligible for admission, a person must be either a graduate of a recognized high school, at least twenty-one years of age, or a military veteran. A person twenty-one years of age and not a high school graduate is required to pass the General Educational Development Test. A military veteran who is neither a graduate of a recognized high school nor at least twenty-one years of age may qualify for admission by passing the G.E.D. Test.

A high school senior who ranks in the upper two-thirds of his graduating class will be admitted at the close of his seventh semester, subject to the completion of his high school work, and to maintaining his rank in the upper two-thirds of his class.

A student who has been graduated from an approved secondary school, and who ranks in the lowest third of his graduating class, will be permitted to enter (on scholastic probation) for the summer, winter, or spring quarters only. Exception to this rule may be made for a student desiring to enter in the fall if he shows high scores on the University's special examinations.

The above policy will apply to both in-state and out-of-state students, except that for out-of-state students, all those in the lower *half* of their graduating class will be covered by the rule.

ADMISSION OF TRANSFER STUDENTS

To be considered for admission to advanced standing, a student must present a full record of his previous academic work. This record includes evidence of graduation from high school and transcripts and evidence of good standing from every college and university attended. All such transcripts should be mailed directly from the institution to the Office of Admission.

Admission by transfer does not necessarily mean that all credits presented for transfer will be accepted. Transferable credits are determined through evaluation at the time of presentation. In all cases, at least three-fourths of transferable credits from each institution must be of "C" quality or above.

A transfer student admitted as an unclassified student will receive no transfer credit toward a degree so long as he remains in an unclassified status.

A transfer student is subject to this University's scholarship rules. A transfer student who is not in good scholastic standing under our scholarship rules can enter (on scholastic probation) the summer, winter, or spring quarters only, subject to the approval of the appropriate academic dean or his designated representative.

A transfer student suspended for poor scholarship or on academic probation at the last institution attended who would have been suspended

under Southern's scholarship rules is not eligible for admission to Southern until at least one quarter has elapsed from the date of suspension. A transfer student dropped for any reason other than academic failure must be cleared by the Office of Student Affairs before admission will be granted.

ADMISSION OF FORMER STUDENTS

A former student of Southern not in attendance on the campus at the close of the quarter preceding application for admission must apply to the Admission Office for re-entrance clearance prior to registration.

A former student who is not in good standing must clear his status before the Admission Office will prepare his registration permit. It is advisable for such a student to initiate re-entrance clearance several weeks before the quarter which he plans to attend so that all inquiries may be answered and so that the applicant can find time to complete any requirements that may be imposed upon him.

ADMISSION OF GRADUATE STUDENTS

Qualified students may apply for admission to the Graduate School any time during the calendar year. Application forms may be obtained from the Admission Office on either campus. Additional information appears in the Graduate School bulletin.

REGISTRATION

Students registering at Alton will report to the Auditorium Building to pick up authorization-to-register permits. Students registering at East St. Louis will report to the east (10th Street) door of the main building for authorization-to-register permits.

Students who know that they must miss more than three days of the summer session should not register. The brevity of this 8-week session makes it difficult for students missing more than three days to complete the required work in time.

FEES

The fee schedule for an eight-week summer session and a regular quarter is as follows:

Tuition	\$31.50*	\$42.00*
Regular Fees	Eight-Week	Quarter
Student Activity Fee	7.15	9.50
University Center Fee	5.00	5.00
Book Rental Fee	5.00	5.00
	\$48.65	\$61.50
* Out-of-state students pay an additional	\$37.50	\$50.00

A student taking six hours or fewer during the eight week session and eight hours or fewer during a regular quarter pays half tuition and book rental fee, full university center fee, and has an option on paying the student activity fee.

Other special fees or deposits as listed in the General Information issue will be assessed when applicable.

If a student enrolls in both eight-week and regular quarter classes his tuition and fees will be assessed on the quarter basis as listed above.

Students attending under state teacher-education, military, or general-assembly scholarships are required to pay the university center fee and the book rental fee. Veterans attending under Public Laws 16 and 894 are not required to pay any of the regular fees. Students attending under Public Law 550 are required to pay fees, both regular and special, and may not use military scholarships for waiving payment of any fees.

WITHDRAWALS AND PROGRAM CHANGES

A prescribed procedure must be followed by any student desiring to change his academic program or to withdraw from the University while the period for which he is registered is still in progress.

WITHDRAWALS

A student is considered officially registered after he has cleared his payment of fees at the Business Office. If a student then finds he cannot attend college or, if after attending for a period of time finds he cannot continue, he must report to the Office of Student Affairs to indicate official withdrawal action.

Failure to follow the official procedure will result in academic penalty.

PROGRAM CHANGES

A student is officially registered only for those courses appearing on his registration cards. Any change to add or drop a course can be made only after fees are paid and must be made through an official program change. A student may not drop a course merely by stopping attendance. Mere attendance does not constitute registration in a class, nor will attendance in a class for which a student is not registered be a basis for asking that a program change be approved permitting registration in that class.

If a student desires to drop a course during the second or third week of the summer, the change will be approved only when the reasons appear valid. If a student desires to drop a course after the third week the change will be approved only under unusual conditions. In the last three weeks of the session changes will be approved only in extreme emergencies.

A student processing a program change is required to present his fee receipt program card and must complete the following procedure.

A student must initiate approval for the change with his adviser. The approved program change form must then be taken by the student to the

Registrar's Office within twenty-four hours after approval by the adviser. After having been cleared with the Registrar's Office, program changes for which a program change fee is assessed must be presented to the Business Office for payment and immediately returned by the student to the Enrollment Center in the Registrar's Office for final processing. No change is official until the preceding procedure is complete.

A program change must be made in order to drop a course. A student may not drop merely by stopping attendance. The last day for dropping a course without receiving a grade is July 7.

A student has not completed his program change until he presents it to the enrollment center in the Registrar's Office.

Program changes will be accepted at the Registrar's Office from 9:00 A.M. to 12:00 Noon, 1:00 P.M. to 4:30 P.M. and 6:00 P.M. to 8:00 P.M. on Program Change Day, June 20. After June 20 only program changes for withdrawing from a class will be accepted.

VETERANS' INFORMATION

The Edwardsville Campus is approved for veterans. Veterans eligible for benefits under the G. I. Bill should contact the University veterans' adviser during registration periods. Public Law 550 expires in 1965. War orphans should discuss Public Law 634 benefits with the veterans' adviser.

To be eligible for Public Law 550 benefits, the veteran must be fully admitted and enrolled as a regular classified student making satisfactory progress in a degree program.

VETERANS' SIGN-UP PERIOD

Veterans eligible for benefits will sign a monthly attendance certification on the following dates at the Registrar's Office in Alton or East St. Louis.

<i>Period</i>	<i>Date</i>	<i>Time</i>
June 19 to July 31	August 1	9 A.M.-12 Noon, 1-4 P.M. 5:30 P.M.-8:30 P.M.
August 1 to August 9	August 9	9:00 A.M.-12 Noon, 1-4 P.M. 5:30 P.M.-8:30 P.M.
August 1 to August 31	August 31	9 A.M.-12 Noon, 1-4 P.M. 5:30 P.M.-8:30 P.M.

Checks for the summer session should not be expected before September 20. Veterans who fail to sign on the specified date will probably experience delay in receiving the check for that period.

STUDENT RESPONSIBILITY

Each student must assume responsibility for his progress by keeping an up-to-date record of the courses he has taken and by checking periodic-

ally with his adviser and the Registrar's Office. Responsibility for errors in program or in interpretation of regulations of the University rests entirely with the student.

STUDENT EMPLOYMENT

Students interested in part-time employment on campus during the summer should make early application to the Office of Student Employment, Alton Center, Alton, Illinois, or East St. Louis Center, East St. Louis, Illinois.

WORKSHOPS

EDUCATIONAL UTILIZATION OF COMMUNITY RESOURCES

The sixth annual workshop in Educational Utilization of Community Resources under the direction of David E. Bear will be held from June 18, 1962, to July 26, 1962, from Monday through Thursday in Room 208 in the Science Building on the Alton Campus.

The workshop provides an opportunity for teachers to acquire detailed knowledge of community resources; to provide teaching units utilizing these resources; to assemble files of valuable resource materials; and to become acquainted with the economic and social problems of the community. It affords participation in (1) activities which develop a broad general knowledge of the social and economic structure of the community, such as lectures, field trips, audio-visual presentations, and panel discussions and (2) small study groups which work on problems of specific interest to the individual members comprising them. Workshop members this summer may affiliate with small groups which study (1) the use of community resources to improve instruction in elementary school science, (2) the use of community resources to improve instruction in the social studies, (3) the use of community resources for vocational guidance, (4) community resources for teachers of business education, and (5) community resources as related to the economic structure of the nation.

Reservations for a place in the workshop should be sent to David E. Bear, Southern Illinois University, Alton, Illinois.

DUAL WORKSHOP IN HIGH SCHOOL AND JUNIOR HIGH SCHOOL ENGLISH

English 486-4, 487-4 (June 18-July 26, Alton Center, Monday through Thursday, 1:30-4:00).

The Dual Workshop for English teachers in high school and junior high school and for upper-class English majors that is sponsored by the Humanities Division and co-sponsored by the National Council of Teachers of English will meet for the first time on the Alton Campus.

Registrants in Workshop in High School English, English 486-4, and those in Workshop in Junior High School English, English 487-4, will attend joint lectures in which specialists in language, composition, literature, and library materials will talk to them as a group and then provide opportunities for questions and consultations. Several of these specialists and consultants will be brought in from other schools and universities. A number will be drawn from the campuses of Southern Illinois University.

After the lectures the group will form smaller units that will try to accomplish the following goals:

- (1) a discussion of each registrant's specific problems with regard to integrated programs for teaching language, composition, and literature in his own school and conferences to determine what the group can do to help solve the problems;
- (2) an examination and evaluation of better methods of teaching and integrating language, composition, and literature with demonstrations of selected methods for college preparatory, terminal, and remedial students;
- (3) the use of state and community resources for enriching the teaching of English in both the junior high and the senior high schools; and
- (4) an awareness of the correlation between junior high, senior high, and college English courses and a discussion of what can be done to enrich all of the levels of instruction.

Dr. Marion A. Taylor and Miss Gladys R. Steinman of the Humanities Division will direct the activities of the Dual Workshop for High School and Junior High School English Teachers.

INTER-GROUP RELATIONS WORKSHOP

Sociology 388-3 (June 18-29, East St. Louis Center, Monday through Friday, 1:00-6:00.

This workshop, designed to develop understanding of and skills for resolving intergroup conflict, is for teachers, members of staffs of health and welfare agencies, community leaders, and students.

It will focus on tension producing social conditions in an urban environment and the techniques and resources of amelioration. The program will consist of a survey of the literature of the field, lectures, panel discussions, films and field trips.

The Inter-group Relations Workshop is being held with the co-operation of the National Conference of Christians and Jews. Dr. Elliott Rudwick, associate professor of sociology, will serve as workshop director.

Students who earned three hours of credit in previous workshops may earn three additional hours of credit by enrolling in the course.

JUNIOR ART WORKSHOP

Art—no academic credit granted (June 18–August 9, Alton Center, Tuesday and Thursday, 2:00–4:00, Fee, \$12).

Mrs. Evelyn Buddemeyer, instructor-lecturer in Fine Arts, will offer this class for boys and girls 8 to 12 years of age. The class will include many types of introductory art projects, will employ a variety of materials, and will introduce the young students to art as a creative activity. Where possible the class will be divided into small groups by ages and compatibility of interest.

The class will be observed by future art teachers.

MARRIAGE COUNSELING WORKSHOP

Sociology 484-3 (June 18–July 13, Alton Center, Monday through Thursday, 1:00–4:00, clinical hours or appointments for supervised case analyses will be arranged).

This workshop will consist of lectures, case discussions and personal supervision of case analysis.

Persons enrolling should be actively engaged in counseling or preparing to do counseling as a part of their professional practice. An effort will be made to select representatives from various professions such as physicians, clergymen, educators, social workers, and attorneys.

Dr. Donald Taylor, associate professor, will be the director of the workshop.

EUROPEAN STUDY COURSES

History 312-3, 450-3 (June 21–September 1).

In view of the increased interest in foreign study for American students, the Edwardsville Campus of Southern Illinois University is initiating a program to be taught in Europe in the summer of 1962.

The courses taught will acquaint the student with the principal political, economic, social, and intellectual developments in Central Europe since the French Revolution. Special emphasis will be placed on the force of nationalism.

The group will spend a week traveling from London through Germany, including sightseeing in London, a "briefing" at the University of Cologne, a visit to the German Parliament and University of Bonn, sightseeing in Frankfurt, another "briefing" at Heidelberg, a trip on the Rhine River, sightseeing in Nuremburg, and a visit to the Dachau Concentration Camp near Munich. At the end of this tour, the group will locate in Vienna for six weeks. Several field trips are planned and a three-day trip to Prague, Czechoslovakia is scheduled during the course. A knowledge of German is not necessary but arrangements can be made for students who

desire to study German independently. The final three weeks of the program will consist of free time for students to use as they please.

The cost of the complete program is approximately \$650 to \$675 (depending on the number of students in the group). The price includes round trip plane transportation, all surface transportation, board and room during seven days from London to Vienna, housing and meals during the six weeks of residence in Vienna, social events arranged for the group, field trips, the excursion to Prague, and all fees and tuition.

The price does not include expenses in Europe for three weeks of independent travel, laundry, passport, medical expenses, other strictly personal expenses, and cost of transportation of excess baggage.

Prerequisite for the courses is History 103 or the consent of the instructor. Classes will meet four or five mornings a week. Guest lecturers will provide the Central European interpretation and approach to the history of this period. Student may earn from six to eight quarter hours. The instructor is Dr. Stanley B. Kimball of Alton.

This program is being offered in conjunction with a similar program at the Carbondale Campus. Students at this campus may take one of the three courses offered abroad by the Carbondale Campus. These courses are Intermediate German, taught by Dr. Helmut Liedloff; Government 454-8, Development of German Democracy, taught by Dr. Orville Alexander; and Printing and Photography 370A-1 to 3, Workshop in Still Photography, taught by Dr. C. William Horrell. Students interested in these courses should write directly to the respective instructors.

Students in all of the classes must become members of International Charter Flight Tours. This group has chartered a plane which will leave St. Louis June 21 (debarking in London) and return from Paris September 1. The cost for the round trip ticket is \$297. For further details see the special folder, Southern Illinois University's Charter Flight to Europe, Summer 1962.

Class Schedule Information

The following material may be of value in interpreting the information appearing in the schedule.

COURSE NUMBER AND HOURS

The column containing this information shows the number of the course first, followed by the number of hours of credit. Course numbers are three digit numbers. In some cases the three digits may be followed by a letter which is also part of the course number. The number appearing after the hyphen denotes the hours of credit for the course. In some cases there may be more than one number following the course number such as 599-2 to 5. This represents a variable hour course in which the student, in consultation with his adviser, decides the number of hours for which he is going to register.

The course numbering system is as follows:

000-099	For courses not properly falling within the following levels sequence.
100-199	For freshmen
200-299	For sophomores
300-399	For juniors and seniors
400-499	For seniors and graduate students
500-600	For graduate students only

ACADEMIC LOAD

The normal academic load for the eight week session is ten to twelve hours of credit. A student with special needs may, by permission of the dean of his academic unit, take a maximum of fourteen hours. A student on probation may not register for more than ten hours. A student is considered a full-time student during the summer session if he carries eight or more hours.

The normal student load for the summer quarter is sixteen hours. Except by permission of the dean, no student may enroll for more than eighteen hours of credit per quarter.

PREREQUISITES

For the guidance of students many courses list prerequisites needed before the course under question can be taken. These prerequisites may be listed in a number of different ways. If only a number appears in the column, this refers to the department's own course. If the course is another department's course, the department will be listed prior to the number. On advanced level courses registration for that course may require the consent of the instructor or the consent of the department.

COURSES "TO BE ARRANGED"

Students registering for courses listed as "to be arranged" should consult the instructor indicated or the head of the division if no instructor is listed, to determine time and place of meeting.

ACADEMIC UNITS

BUSINESS DIVISION

Accounting
Economics
Management
Marketing
Secretarial Science

EDUCATION DIVISION

Educational Administration and
Supervision
Elementary
Secondary
Guidance
Health Education
Instructional Materials
Physical Education
Psychology
Special Education

FINE ARTS DIVISION

Art
Music
Speech
Theater

HUMANITIES DIVISION

English
Foreign Language
Philosophy

SCIENCE AND TECHNOLOGY DIVISION

Astronomy
Chemistry
Mathematics
Physics
Physiology
Zoology

SOCIAL SCIENCES DIVISION

Anthropology
Geography
Government
History
Sociology

Title	Course No. & Hours	Remarks	Section No.		Time	Days	Room	Instructor
			Alton	E. St. Louis				
ACCOUNTING (ACCT)								
Elementary Accounting I	251-4			E51	6:00-8:40	Tu Th	203	Small
Elementary Accounting III	253-4	Prereq.: 252.	E1	E51	6:00-8:40 6:00-8:40	Tu Th Tu Th	ANA 100 221	Milles Davison
Governmental Accounting Auditing	355-3 356-5	Prereq.: 253. Prereq.: 353.	1	E51	6:00-8:00 10:20-11:35	M W MTuWThF	221 ANA 100	Davison Milles
ANTHROPOLOGY (ANTH)								
Indians of North America	314-4		1		8:55-10:10	MTuWTh	SS 200	Schusky
ART (ART)								
Art Appreciation	120-3	Fulfills general University requirement. Extended Session.	1		7:30-8:20	M W F	FAA 100	Kemper
Beginning Ceramics	203-4	Prereq.: 15 hours Art 100. Recommended for elementary school majors.	1		8:55-10:55	MTuWTh	FAA 103	Howerton
Art Education Studio	300-4 325-4	Prereq.: junior or senior standing and consent of instructor.	1 1		8:55-10:55 8:55-10:55	MTuWTh MTuWTh	FAA 102 Alby St. Stud.	Buddemeyer Richardson
ASTRONOMY (ASTR)								
Introduction to Astronomy	201-4	Several evening field trips will be required.	1		10:20-11:35	MTuWTh	SCI 3	Zurhede

CHEMISTRY (CHEM)

General Chemistry	101-4	Extended Session.	I	51	10:20-11:10 8:55-10:45 11:45-12:35 1:10-3:00 7:30-8:20 7:30-10:20 6:00-7:15 6:00-9:00 7:25-9:00	MTu Th W F MTu Th Tu Th M W F Tu Th Tu Th W Tu Th	SCI 200 SCI 206 112 125 SCI 200 SCI 206 124 A 125 125	White White Stallard Stallard White White Rands Rands	
Inorganic and Qualitative Analysis	113-5	Prereq.: 112. Extended Session.	I	E51					
Organic Chemistry	240-4	Prereq.: 101 or 111.		E51	6:00-8:00 6:00-10:00	Tu Th W	112 125	Probst Probst	

ECONOMICS (ECON)

Survey of Economic Principles	205-5		E1	51	6:00-9:30 10:20-11:35 6:00-8:40 6:00-8:40	M W MTuWThF Tu Th Tu Th	ANA 101 221 ANA 101 224	Van Dahm Luan Van Dahm Luan
Economic Principles and Problems	206-4	Prereq.: 205.	E1	E51				
Money and Banking I	315-4	Prereq.: 205.						

EDUCATIONAL ADMINISTRATION AND SUPERVISION (ED AD)

The American Educational Systems	331-3		I	51	7:30-8:45 10:20-11:35 10:20-11:35 6:00-8:40	M WTh M WTh MTuWTh M W	ANA 104 105 AUD 100 106	Staff Kelley Shea Shea
Philosophy of Education	355-4		I	E51				
School Administration	424-4	4 additional sessions to be arranged.	I		11:45-1:00	MTuWTh	HUM 100	Brubaker
School Supervision	456-4	Prereq.: graduate standing.	I		7:30-8:45	MTuWTh	ANB 202	Jung
Workshop in Educational Utilization of Community Resources	485-4	June 18-July 26.	I		1:20-4:00	MTuWTh	SCI 102	Bear
Research Methods	500-4	Prereq.: 422 recommended.	I		8:55-10:10	MTuWTh	SS 105	Steinkellner

Title	Course No. & Hours	Remarks	Section No.		Time	Days	Room	Instructor
			Alton	E. St. Louis				
EDUCATIONAL ADMINISTRATION AND SUPERVISION (ED AD) (Continued)								
Illinois School Law	520-4		1		7:30-8:45	MTuWTh	ANB 201	Smith
Contrasting Philosophies of Education	554-4		1		10:20-11:35	MTuWTh	SCI 2	Wheat
Individual Research	575-2 to 4	Prereq.: consent of instructor.	1		Arranged	Arranged	Arranged	Staff
EDUCATION—ELEMENTARY (ED EL)								
Elementary School Methods	314-4	Prereq.: Guidance 305.	1		8:55-10:10	MTuWTh	ANB 201	Carpenter
Elementary Student Teaching	351D-8 to 12	Prereq.: must apply to Education Division two quarters in advance.	1		Arranged	Arranged	Arranged	Steinbrook
Materials and Methods in Elementary School Science	442-4		1		8:55-10:10	MTuWTh	SCI 2	Bliss
Improvement of Reading Instruction	505-4	Not for students who have had 337 or 437.	1		11:45-1:00	MTuWTh	SCI 9	Steinkellner
Readings in Reading	507-2 to 4	Prereq.: consent of instructor.	1		Arranged	Arranged	Arranged	Steinkellner
Selected Teaching and Curriculum Problems in Elementary School Science	541-4	No credit for students who have had 442.	1		8:55-10:10	MTuWTh	SCI 2	Bliss
Teaching the Social Studies in the Elementary School	543-4		1		10:20-11:35	MTuWTh	ANB 202	Carpenter
Individual Research	575-2 to 4	Prereq.: consent of instructor.	1		Arranged	Arranged	Arranged	Staff
EDUCATION—SECONDARY (ED SEC)								
High School Methods	315-4	Prereq.: Guidance 305.	1		8:55-10:10	MTuWTh	ANB 202	Smyers
Secondary Student Teaching	352D-8 to 12	Prereq.: must apply to Education Division two quarters in advance.	1		Arranged	Arranged	Arranged	Steinbrook

Improvement of Reading Instruction
 Workshop in High School Curriculum
 Individual Research

505-4
 562-4
 575-2 to 4

1
 1
 1
 Prereq.: consent of instructor.

11:45-1:00
 10:20-11:35
 Arranged

MTuWTh
 MTuWTh
 Arranged

SCI 9
 ANA 108
 Arranged

Steinkellner
 Smyers
 Staff

EDUCATION—SPECIAL (ED SP)

Elementary Student Teaching (Sp. Ed.) 351D-8

Prereq.: consent of instructor. Application two quarters in advance. Must be taken with 420.

51

Arranged

Arranged

Tucker

Problems and Characteristics of the
 Mentally Retarded
 Directed Observation of Exceptional
 Children

410-4
 413-4

Prereq.: Guidance 305 or Psychology 301 or 303.
 Prereq.: consent of instructor. Must be taken with 410.

51 8:55-10:10
 51 8:55-10:10

MTuWTh
 MTuWTh

205
 205

Tucker
 Tucker

Methods and Materials for Teaching
 Exceptional Children

420-4

Prereq.: 410. Must be taken with 351D.

51 7:30-8:45

MTuWTh

201 A

Staff

ENGLISH (ENG)

Composition

101-3

Prereq.: test score necessary for all sections. Extended Session.

8:55-9:45

MTuWTh

AUD 102

Graham

Introduction to Poetry
 Introduction to World Literature
 Introduction to Fiction
 Introduction to Modern Literature

205-3
 209-3
 211-3
 212-3

Prereq.: 103.
 Prereq.: 103.
 Prereq.: 103.
 Prereq.: 103.

51 7:30-8:45
 E51 6:00-8:00
 52 10:20-11:35
 E51 6:00-8:00

M WTh
 M W
 M WTh
 Tu Th

112
 AUD 101
 AUD 102
 103

Byrd
 Ades
 Zanger
 Austin

Title	Course No. & Hours	Remarks	Section No. Alton E. St. Louis	Time	Days	Room	Instructor
ENGLISH (ENG) (Continued)							
A Survey of American Literature to 1860	309-4	Prereq.: sophomore literature requirement. Required of English majors and minors.		6:00-8:40	Tu Th	AUD 101	Hensley
Usage in Spoken and Written English	391-3	Prereq.: sophomore literature requirement. Required of education majors.	E2	8:55-10:10	M W F	AUD 100	Duncan
			51	6:00-8:00 12:05-1:20	Tu Th M WTh	AUD 100 103	Jones Austin
English Renaissance	424-4	Prereq.: sophomore literature requirement.	1	12:05-1:20	MTuWTh	AUD 102	Duncan
Contemporary British Fiction	457-4	Prereq.: sophomore literature requirement.	1	7:30-8:45	MTuWTh	AUD 102	Zanger
Workshop in High School English	486-4	Prereq.: sophomore literature requirement and consent of instructor. Four additional sessions to be arranged. June 18-July 26.	1	1:30-4:00	MTuWTh	AUD 103	Steinman
Workshop in Junior High School English	487-4	Prereq.: sophomore literature requirement. Four additional sessions to be arranged. June 18-July 26.	1	1:30-4:00	MTuWTh	SCI 7	M. A. Taylor
Individual English Writers (Jonathan Swift)	523-4		1	10:20-11:35	MTuWTh	AUD 101	Graham
FOREIGN LANGUAGE (F-L)							
GERMAN (GER)							
Advanced German Conversation	220-4	Prereq.: Consent of instructor.	1	10:20-11:35	MTuWTh	HUM 100	Guenther

SPANISH (SPAN) Spanish Conversation	220-4	Prereq.: 103.	E51	6:00-8:40	Tu Th	202 B	Beardsley
GEOGRAPHY (GEOG)							
Cultural Geography	100-5	Extended Session.	1	7:30-8:20	MTuWThF	ANA 110	Vogel
Physical Geography	101-5	Natural science credit for education majors. Extended Session.	51	8:55-9:45	MTuWThF	222	Snaden
			51	10:20-11:10	MTuWThF	222	Snaden
Geography of Anglo America	314-4	Prereq.: 100 or consent of instructor. Natural science credit for education majors.	1	11:45-1:00	MTuWTh	ANA 110	Vogel
Geography of Europe	315-4	Prereq.: 100 or consent of instructor. Natural science credit for education majors.	51	7:30-8:45	MTuWTh	222	Brooks
The Soviet Union	402-4	Prereq.: 100 or consent of instructor. Natural science credit for education majors.	E51	6:00-8:40	M W	222	Snaden
Regional Problems in Conservation	424-4	Prereq.: 100 or consent of instructor. Natural science credit for education majors.	1	8:55-10:10	MTuWTh	ANA 110	Kazack
GOVERNMENT (GOV)							
American Government	190-5	Extended Session.	51	8:55-9:45	MTuWThF	104	Lovell
			E52	5:55-8:10	Tu Th	104	Schwab
			1	11:45-12:35	MTuWThF	AUD 100	Baker
Development of the American Constitution	305-4	Prereq.: 101, 190 or 231.	1	7:30-8:45	MTuWTh	SS 200	Baker
Problems of American Foreign Policy	371-4	Prereq.: 101, 190 or 231.	51	11:45-1:00	MTuWTh	105	Lucatz
Principles of Comparative and Foreign Governments	390-5	Prereq.: 101, 190 or 231.	1	8:55-10:10	MTuWThF	SCI 201	Glaser
Great Britain and the British Empire	456-4	Prereq.: 390 or consent of instructor.	51	8:55-10:10	MTuWTh	105	Lucatz

Title	Course No. & Hours	Remarks	Section No. Alton E. St. Louis	Time	Days	Room	Instructor
GUIDANCE (GUID) Educational Psychology	305-4	Prereq.: Psychology 201.	1 E51	11:45-1:00 6:00-8:40	MTuWTh Tu Th	SCI 102 106	Steinbrook Troyer
Mental Hygiene	412-4	Prereq.: 305.	1	11:45-1:00	MTuWTh	SCI 201	Dameron
Educational Statistics	420-4	Prereq.: 305.	1	10:20-11:35	MTuWTh	ANA 101	Taliana
Educational Measurements I	422-4	Prereq.: 305.	1	7:30-8:45	MTuWTh	AUD 100	Taliana
Workshop in Educational Utilization of Community Resources	485-4	June 18-July 26.	1	1:20-4:00	MTuWTh	SCI 102	Bear
Special Research Problems	501-2 to 6	Prereq.: consent of instructor.	1	Arranged	Arranged	Arranged	Taliana
School Behavior Problems and their Prevention	525-4	Prereq.: 412 or consent of instructor.	1	7:30-8:45	MTuWTh	SCI 200	Meredith
Problems in Guidance: Pupil Adjustment	545F-4	Prereq.: 412, 525 and consent of instructor.	1	7:30-8:45	MTuWTh	SCI 200	Meredith
Child Development in Education	562A-4	Prereq.: 412 or consent of instructor.	1	10:20-11:35	MTuWTh	ANB 201	Kuenzli
Adolescent Development in Education	562B-4	Prereq.: 412 or consent of instructor.	1	8:55-10:10	MTuWTh	SCI 3	Troyer
HEALTH EDUCATION (H ED) Healthful Living	100-4	Extended Session.	1 E51	10:20-11:10 6:20-8:10	MTuWTh M W	SCI 201 105	Klein Klein
Health Appraisal of Children	400-4	Prereq.: 302S.	1	11:45-1:00	MTuWTh	ANB 201	Klein
Workshop in Driver Education and Traffic Safety	415S-4		1	7:30-8:45	MTuWTh	ANA 100	Spear
Workshop in Safety Education	480S-4	Prereq.: 313 or 325 or consent of instructor.	1	8:55-10:10	MTuWTh	ANA 100	Spear

HISTORY (HIST)

The United States to 1865	201-5	Prereq.: sophomore standing.	51	7:30-8:45	MTuWThF	104	McCurry
Central Europe in the Nineteenth Century	312-3	Prereq.: freshman survey.					
The Age of Absolutism and the Enlightenment	314-3	Prereq.: freshman survey. I		E U R O P E A N 1:10-2:25	T O U R M WTh	— — — — AUD 100	— — — — Kimball Haas
English History (1603 to 1815)	323-4	Prereq.: freshman survey. I		11:45-1:00	MTuWTh	AUD 103	Haas
The Far East and Modern Imperialism	368-3	Prereq.: freshman survey.	51	8:55-10:10	M WTh	112	Erickson
Age of Jackson	428-4	Prereq.: 201.		10:20-11:35	MTuWTh	AUD 103	Riddleberger
Recent United States History	436-3	Prereq.: 202.	51	10:20-11:35	MTu Th	103	McCurry
Europe Since 1914	450-3	Prereq.: freshman survey.		E U R O P E A N	T O U R	— — — —	— — — — Kimball

INSTRUCTIONAL MATERIALS (IM)

Audio-Visual Methods in Education	417-4	Prereq.: Guidance 305.	1	11:45-1:00	MTuWTh	SCI 2	Bliss
-----------------------------------	-------	------------------------	---	------------	--------	-------	-------

MANAGEMENT (MGT)

Corporation Finance	320-5	Prereq.: Accounting 253 and Economics 205.	E51	6:00-9:30	Tu Th	205	Schmitt
Business Enterprise and Public Policy	473-4	Prereq.: senior standing. I		8:55-10:10	MTuWTh	ANA 101	Blackledge
Budgeting and Systems	475-4	Prereq.: 320 and Accounting 253.		11:45-1:00	MTuWTh	ANA 101	Blackledge

MARKETING (MKTG)

Principles of Marketing	230-5	Prereq.: Economics 205 or E1 consent of instructor.	E51	6:00-9:30	M W	ANA 100	Vincent
				6:00-9:30	M W	104	Small

Title	Course No. & Hours	Remarks	Section No.		Time	Days	Room	Instructor
			Alton	E. St. Louis				
MARKETING (MKTG) (Continued)								
Transportation	341-4	Prereq.: 230.		E51	6:00-8:40	M W	224	Bosse
Sales Management	438-4	Prereq.: 230 and 337 or 1 consent of instructor.			7:30-8:45	MTuWTh	ANA 101	Vincent
MATHEMATICS (MATH)								
General Mathematics I								
	106-4	Student will not receive 1 credit for 106 if he has had 3 semesters of high school algebra or any college math. Extended Session.			11:45-12:35	MTu ThF	SCI 103	Phillips
Elementary Analysis II								
	112-5	Prereq.: 111 or 1½ years of high school algebra and 90% on guidance test. Extended Session.	51		10:20-11:10	MTu ThF	220	Williams
			51		11:45-12:35	MTuWThF	220	Williams
Elementary Statistics								
	220-4	Prereq.: 106 or 1½ years of high school algebra or consent of instructor.	1		11:45-1:00	MTu ThF	SCI 3	Holden
Calculus and Analytical Geometry IV								
	253-4	Prereq.: 252.	1		8:55-10:10	MTu ThF	AUD 101	Holden
Statistical Analysis I								
	410-3	Prereq.: 106 or 1½ years of high school algebra or consent of instructor.	1		11:45-1:00	MTu ThF	SCI 3	Holden
Theory of Numbers								
Projective Geometry	425-3	Prereq.: 251.	E51		6:00-8:00	M W	220	Oursler
The Structure of Elementary School Mathematics	430-4	Prereq.: 251.	E51		6:00-8:40	Tu Th	220	Oursler
	446-4	Prereq.: experience in elementary teaching and consent of instructor.	1		7:30-8:45	MTuWTh	SCI 103	Phillips

MUSIC (MUS)

Class Piano	040-1	Prereq.: 200 or equivalent for non-music majors. Required of kindergarten-primary education majors.	10:20-11:35	MTu Th	FAC 102	Staff
Class Brass A—French Horn B—Trumpet C—Trombone D—Tuba E—Baritone	050-1	Prereq.: none. Two quarters or proficiency required of majors.	7:30-8:45	MTu Th	FAB 100	Fjerstad
Class Voice	060-1	Prereq.: none. Three quarters or proficiency required of music majors.	10:20-11:35	MTu Th	FAB 100	Headley
Music Understanding	100-3	For general University students. (Music majors should take 101, 102, 103 sequence.) Extended Session.	8:55-10:10 8:55-9:45	Tu Th M W F	FAC 203 212	Staff Staff
Fundamentals of Music	200-3		10:20-11:35	M W F	212	Staff
Music Education—Elementary	300-3	Prereq.: 200 or equivalent. Non-music majors.	10:20-11:35	MTu Th	FAC 203	Blakely
Music Education in the Elementary School	301-3	Prereq.: junior standing. Music majors only.	10:20-11:35	MTu Th	FAC 203	Blakely
Church Music II	348-3	Prereq.: audition.	8:55-10:10	MTu Th	FAB 207	Headley
Chamber Music—Woodwind and Brass	365-1		8:55-10:10	MTu Th	FAB 100	Fjerstad

The following courses in applied music are available for music majors and minors and for others under exceptional conditions. Consult the music adviser in Alton. Each of these courses has only one section. Times to be arranged.

013-2 Private Violoncello	051-2 Private French Horn	054-2 Private Tuba
023-2 Private Clarinet	052-2 Private Trumpet	055-2 Private Baritone
025-2 Private Saxophone	053-2 Private Trombone	061-2 Private Voice
041-2 Private Piano		

Title	Course No. & Hours	Section No.	Alton	E. St. Louis	Time	Days	Room	Instructor
PHILOSOPHY (PHIL) Philosophy of Education	355-4	E51			6:00-8:40	M W	106	Shea
			1		10:20-11:35	MTuWTh	AUD 100	Shea
PHYSICAL EDUCATION—MEN (PEM)								
Required Physical Education (Tennis)	251-1		1		8:55-10:10	M W	GYM	Showers
Required Physical Education	252-1		1		10:20-11:35	M W	GYM	Nesbitt
Required Physical Education (Swimming)	253-1		1		7:30-8:45	Tu Th	GYM	Nesbitt
Required Physical Education (Golf)	253-1		2		10:20-11:35	Tu Th	GYM	Nesbitt
Bowling	254-1		1		8:55-10:10	Tu Th	GYM	Showers
					Fee \$4.00			
Methods and Materials for Teaching Physical Education Activities in the Elementary School	350-4		1		7:30-8:45	MTuWTh	GYM	Marks
Curriculum in Physical Education	501-4		1		8:55-10:10	MTuWTh	GYM	Nesbitt
PHYSICAL EDUCATION—WOMEN (PEW)								
Tennis	216-1		1		8:55-10:10	M W	GYM	Showers
			2		10:20-11:35	M W	GYM	Nesbitt
Golf	222-1		1		10:20-11:35	Tu Th	GYM	Nesbitt
Bowling	254-1		1		8:55-10:10	Tu Th	GYM	Showers
					Fee \$4.00.			
Materials and Methods for Teaching Physical Education Activities in the Elementary School	350-4		1		7:30-8:45	MTuWTh	GYM	Marks
					Prereq.: physical education majors and elementary education majors.			

Curriculum in Physical Education	501-4	1	8:55-10:10	MTuWTh	GYM	Nesbitt
PHYSICS (PHYS) Survey of Physics	101-4	1	7:30-8:20 7:30-8:20 8:55-9:45	MTuW Th Th	SCI 3 SCI 7 SCI 7	Zurheide
University Physics	213-5	1	7:20-8:45 7:20-10:10	MTu Th W	SCI 2 SCI 7	McAnery
PSYCHOLOGY (PSYC) Introductory Psychology	201-4	1	11:45-1:00 6:00-8:40	MTuWTh Tu Th	ANA 104 105	Kuenzli Dameron
Child Psychology	301-4	1	10:20-11:35	MTuWTh	ANB 201	Kuenzli
Adolescent Psychology	303-4	1	8:55-10:10	MTuWTh	SCI 3	Troyer
Mental Hygiene	432-4	1	11:45-1:00	MTuWTh	SCI 201	Dameron
SECRETARIAL SCIENCE (SEC SCI) Teaching Clerical Practice and Office Machines	406-4	1	7:30-8:45	MTuWTh	ANA 108	Brady
Principles and Problems of Business Education	506-4	1	8:55-10:10	MTuWTh	ANA 108	Brady

Title	Course No. & Hours	Remarks	Section No.		Time	Days	Room	Instructor
			Alton	E. St. Louis				
SOCIOLOGY (SOC)								
Introductory Sociology	101-5	Extended Session.	1	51 E52	8:55-9:45 5:55-8:10 11:45-12:35 5:55-8:10	MTuWThF M W MTuWThF M W	204 112 SS 105 SS 105	Thomas Seymour Schusky Schusky
The Family	340-4	Prereq.: 101.	1	51	10:20-11:35	MTuWTh	SS 105	Taylor
Juvenile Delinquency	373-4	Prereq.: 101.		51	7:30-8:45	MTuWTh	204	Rudwick
Workshop in Inter-Group Relations	388-3	June 18-June 29.		51	1:00-6:00	MTuWThF	224	Rudwick
Survey Course in Marriage Counseling— Workshop	484-3	Prereq.: consent of instructor. June 18-July 13.	1		1:00-4:00	MTuWTh	SS 200	Taylor
SPEECH (SPCH)								
Principles of Speech	101-4	Required for speech, education, and business majors. Also required for associate degree in business. Extended Session.	1		8:55-9:45	MTuWTh	ANB 102	Hawkins
Oral Interpretation	103-4	Prereq.: Speech 101 or consent of instructor. Extended Session.		51 51	8:55-9:45 7:30-8:20	MTuWTh MTuWTh	106 106	Cornwell Cornwell
THEATER. (THEA)								
Directing	402-4	Recommended for high school theater directors.	1		8:55-10:10	MTuWTh	SCI 209	Kochman

ZOOLOGY (ZOOL)

Principles of Animal Biology

100-5 Extended Session. 1 7:30-8:20
7:30-9:20 M W F SCI 102
Tu Th SCI 101

Parasitology

407-5 Prereq.: 102. 1 10:20-11:35
10:20-1:40 Tu Th SCI 100
M W F SCI 100

Myer

Myer

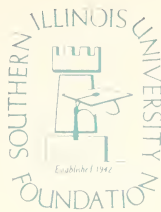

Southern Illinois University Foundation

The Southern Illinois University Foundation is a nonprofit corporation chartered by the state and authorized by the Board of Trustees to receive gifts for the benefit of the University, to buy and sell property, and otherwise to serve the University.

It respectfully asks alumni and other citizens of Southern Illinois to consider making gifts and bequests to benefit the University. Such gifts should be conveyed to the Foundation, with proper stipulation as to their uses. The Foundation, through its officers and members, will be glad to confer with intending donors regarding suitable clauses to insert in wills and suitable forms of gifts and memorials, including bequests by means of life insurance. Large or small gifts to the library will be appreciated; likewise, gifts for special equipment, buildings, endowment of professorships in particular subjects, gifts to student loan funds and scholarship funds, gifts for the use of foreign students, and endowments for particular sorts of research. Any gifts or bequests can be given suitable memorial names.

The staff members of the Foundation are

- Mr. Kenneth R. Miller, *Executive Director*, Carbondale, Illinois
- Mrs. Lois H. Nelson, *Secretary*, Carbondale, Illinois
- Mr. Robert L. Gallegly, *Treasurer*, Carbondale, Illinois
- Mr. C. Eugene Peebles, *Assistant Treasurer*, Edwardsville, Illinois
- Mr. C. Richard Grunf, *Legal Counsel*, Carbondale, Illinois
- Mr. L. James Struif, *Assistant Legal Counsel*, Edwardsville, Illinois
- Mr. Donald Leavitt, *Patent Counsel*, St. Louis, Missouri
- Mr. Warren Stookey, *Field Representative*, Edwardsville, Illinois.

