

1962

1962 Southern Illinois University Bulletin Edwardsville Campus (Schedule of Classes for the Fall Quarter)

Southern Illinois University Carbondale

Follow this and additional works at: http://opensiuc.lib.siu.edu/ua_bcc

Recommended Citation

, . "1962 Southern Illinois University Bulletin Edwardsville Campus (Schedule of Classes for the Fall Quarter)." (Jan 1962).

This Article is brought to you for free and open access by the University Archives at OpenSIUC. It has been accepted for inclusion in SIU Bulletins and Course Catalogs by an authorized administrator of OpenSIUC. For more information, please contact opensiuc@lib.siu.edu.

Southern Illinois University

Bulletin

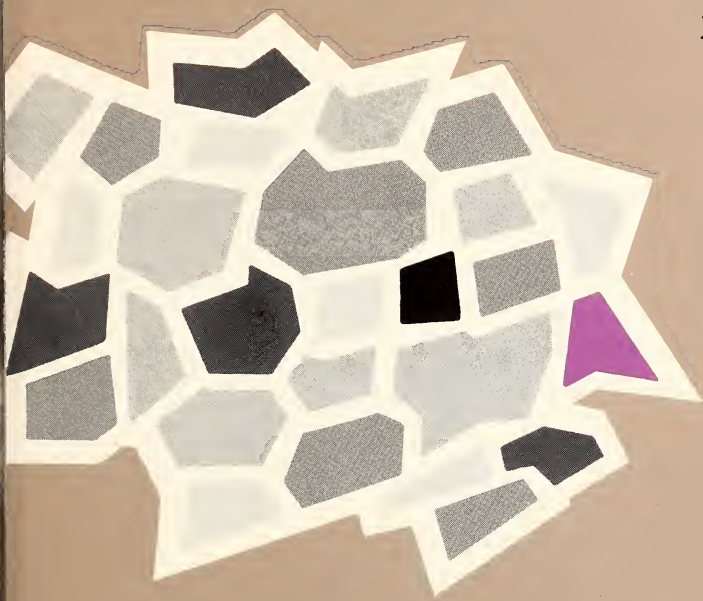

Schedule of Classes

EDWARDSVILLE CAMPUS

1962

Objectives of Southern Illinois University

TO EXALT BEAUTY

IN GOD,
IN NATURE,
AND IN ART;
TEACHING HOW TO LOVE THE BEST
BUT TO KEEP THE HUMAN TOUCH;

TO ADVANCE LEARNING

IN ALL LINES OF TRUTH
WHEREVER THEY MAY LEAD,
SHOWING HOW TO THINK
RATHER THAN WHAT TO THINK,
ASSISTING THE POWERS
OF THE MIND
IN THEIR SELF-DEVELOPMENT;

TO FORWARD IDEAS AND IDEALS

IN OUR DEMOCRACY,
INSPIRING RESPECT FOR OTHERS
AS FOR OURSELVES,
EVER PROMOTING FREEDOM
WITH RESPONSIBILITY;

TO BECOME A CENTER OF ORDER AND LIGHT

THAT KNOWLEDGE MAY LEAD
TO UNDERSTANDING
AND UNDERSTANDING
TO WISDOM.

Schedule of Classes

Fall Quarter, 1962

Edwardsville Campus



SOUTHERN ILLINOIS UNIVERSITY BULLETIN
Volume 4 Number 5 May, 1962
Second-class postage paid at Carbondale, Illinois.
Published by Southern Illinois University, monthly
except in September, when published semimonthly.

The following issues of the *Southern Illinois University Bulletin* may be obtained without charge from General Publications, Southern Illinois University, Carbondale, Illinois.

General Information
Summer Session (Carbondale)
Summer Session (Edwardsville)
Schedule of Classes (Carbondale)
Schedule of Classes (Edwardsville)
General Announcements (Edwardsville)
Graduate School
College of Education
College of Liberal Arts and Sciences
School of Agriculture
School of Applied Science
School of Business
School of Communications
School of Fine Arts
School of Home Economics
University Institutes
Division of Technical and Adult Education

All intending students should have the General Information bulletin (issued once a year), plus the special bulletins of the various educational units in which they are most interested.

Board of Trustees

	TERM EXPIRES
JOHN PAGE WHAM, <i>Chairman</i> , Centralia	1965
KENNETH L. DAVIS, <i>Vice-Chairman</i> , Harrisburg	1963
MELVIN C. LOCKARD, <i>Secretary</i> , Mattoon	1965
MARTIN VAN BROWN, Carbondale	1967
HAROLD R. FISCHER, Granite City	1963
ARNOLD H. MAREMONT, Winnetka	1967
LINDELL W. STURGIS, Metropolis	1965
GEORGE T. WILKINS (<i>Ex-officio</i>), Springfield	
LOUISE MOREHOUSE, <i>Recorder</i>	

Officers of Instruction

DELYTE W. MORRIS, *President*
 CHARLES D. TENNEY, *Vice-President for Instruction*

EDWARDSVILLE CAMPUS

CLARENCE W. STEPHENS, *Vice-President for Operations*
 WILLIAM T. GOING, *Dean* (on leave)
 MILTON B. BYRD, *Associate Dean*
 S. D. LOVELL, *Executive Officer General Studies Program*

Business Division, JOHN J. GLYNN, *Head*
 Education Division, CAMERON MEREDITH, *Head*
 Fine Arts Division, ANDREW J. KOCHMAN, *Head*
 Humanities Division, NICHOLAS T. JOOST, *Head*
 Science and Technology Division, KERMIT G. CLEMENS, *Head*
 Social Sciences Division, HERBERT H. ROSENTHAL, *Head*

GERALD J. T. RUNKLE, *Chief Academic Adviser, East St. Louis*
 ERIC A. STURLEY, *Chief Academic Adviser, Alton* (on leave)
 LLOYD G. BLAKELY, *Acting Chief Academic Adviser, Alton*
 JOHN H. SCHNABEL, *Registrar*

This Bulletin . . .

contains the schedule of classes to be offered on the Edwardsville Campus for the fall quarter of the 1962-63 school year. It also provides information relative to advisement and registration. It does not cover all questions concerning Southern Illinois University. For additional information about the Edwardsville Campus the prospective student should refer to the General Information bulletin and General Announcements (Edwardsville).

Table of Contents

University Calendar, 1962-1963	vii
Registration Calendar, Fall Quarter, 1962	viii
Calendar of Events, 1962-1963	xi
Final Examination Schedule, Fall Quarter, 1962	xiii
 GENERAL INFORMATION	 1
Admission	1
Admission of Freshman Students	1
Admission of Transfer Students	2
Admission of Former Students	3
Admission of Foreign Students	4
Admission of Unclassified Students	4
Admission of Graduate Students	5
Advisement and Registration	5
Current Students	5
Advisement	6
Registration	6
Social Security Identification Number	6
Required Tests	6
Testing Calendar	7
Fees	7
Auditing of Courses	8
Program Changes and Withdrawals	8
Program Changes	9
Withdrawal From School	9
Cancellation of Registration	10
Personal Data Changes	10
Veterans Information	10
Sign-Up Periods	11
Academic Load	11
Responsibility of the Student	12
 MAPS OF THE EDWARDSVILLE CAMPUS	 13
East St. Louis Center	14
Alton Center	16

CLASS SCHEDULE INFORMATION	17
Course Numbers and Hours	17
Prerequisites	17
Courses "To Be Arranged"	18
Free Bus Transportation	18
Bus Schedule	18
General Studies Program	19
Academic Units	20
CLASS SCHEDULE	22

University Calendar, 1962-1963

SUMMER SESSION

Session Begins	Monday, June 18
Independence Day Holiday	Wednesday, July 4
Final Examinations (8-week Session)	Wednesday–Thursday, August 8–9
Commencement	Friday, August 10
Final Examinations (Summer Quarter)	Thursday–Friday, August 30–31
Quarter Ends	Friday, August 31

FALL QUARTER

New Student Week	Friday–Sunday, September 21–23
Quarter Begins	Monday, September 24
Thanksgiving Recess	Wednesday, 12 noon–Monday, 8 A.M. November 21–26
Final Examinations	Wednesday–Tuesday, December 12–18

WINTER QUARTER

Quarter Begins	Wednesday, January 2
Final Examinations	Wednesday–Tuesday, March 13–19

SPRING QUARTER

Quarter Begins	Wednesday, March 27
Memorial Day Holiday	Thursday, May 30
Final Examinations	Thursday–Wednesday, June 6–12
Commencement (Carbondale)	Thursday, June 13
Commencement (Edwardsville)	Friday, June 14

Summer classes begin on Tuesday, June 19. During the fall, winter, and spring quarters, day classes begin on the second day of the quarter. Evening classes (5:30 P.M. or later) begin on the first day of the quarter.

Registration Calendar

Fall Quarter, 1962

May 21-22	East St. Louis students, juniors and seniors, enrolled in the 1962 spring quarter may register 8:30 A.M. to 11:30 A.M., 1:30 P.M. to 4:00 P.M. Evening and graduate students 5:00 P.M. to 7:00 P.M.
May 23-25	East St. Louis students, freshmen and sophomores, enrolled in the 1962 spring quarter may register 8:30 A.M. to 11:30 A.M., 1:30 P.M. to 4:00 P.M. Evening and graduate students 5:00 P.M. to 7:00 P.M.
May 28-29	Alton students, juniors and seniors, enrolled in the 1962 spring quarter may register 8:30 A.M. to 11:30 A.M., 1:30 P.M. to 4:00 P.M. Evening and graduate students 5:00 P.M. to 7:00 P.M.
May 31-June 1	Alton students, freshmen and sophomores, enrolled in the 1962 spring quarter may register 8:30 A.M. to 11:30 A.M., 1:30 P.M. to 4:00 P.M. Evening and graduate students 5:00 P.M. to 7:00 P.M.
July 1-13	Re-entering students may advance register at both centers, Alton and East St. Louis, 1:00 P.M. to 4:00 P.M. daily, Monday through Friday.
July 16	Advisement Day for all new students, Alton Center, 4:00 P.M. to 6:00 P.M., Alton Auditorium.
July 18	Advisement Day for all new students, East St. Louis Center, 4:00 P.M. to 6:00 P.M., East St. Louis Auditorium.
July 16-August 3 and August 13-24	New and re-entering students may be advised and advance register 9:00 A.M. to 12:00 Noon, 1:00 P.M. to 4:00 P.M.
August 17	Students will receive fee statements by mail if registered by this date.
August 20-24	Students must pay fees at time of registration if registering between these dates.

September 7	Students will have their advance registrations cancelled if fees are not paid at the Bursar's Office by 4:00 P.M. CDST on this date.
September 17	Program change day for students advance registered. 9:00 A.M. to 12:00 Noon; 1:30 P.M. to 4:30 P.M.; 5:00 P.M. to 7:00 P.M.
September 21	Freshman and new student testing. (See Testing Calendar)
September 22	New Student Orientation begins.
September 23	New Student Orientation ends.
September 24	Fall quarter begins General registration for classes at Alton and East St. Louis. Students must register for classes at the center they plan to attend in accordance with the alphabetical registration calendar. Students registering at Alton will report to the Auditorium Building to pick up authorization-to-register permits. Students registering at East St. Louis will report to the west (9th street) door of the main building for the authorization-to-register permits.

<i>Class</i>	<i>Hours Completed</i>
Freshman	47 or fewer
Sophomore	48 to 95
Junior	96 to 143
Senior	144 or more
Graduate	Degree completed
Unclassified	Nondegree seeking

<i>SENIORS</i>		<i>JUNIORS</i>	
A-C	8:00-8:15	A-C	10:00-10:15
D-G	8:15-8:30	D-G	10:15-10:30
H-K	8:30-8:45	H-K	10:30-10:45
L-M	8:45-9:00	L-M	10:45-11:00
N-R	9:00-9:15	N-R	11:00-11:15
S-T	9:15-9:30	S-T	11:15-11:30
U-Z	9:30-9:45	U-Z	11:30-11:45

*SOPHOMORES**FRESHMEN*

A-C	12:00-12:15	A-C	1:45-2:00
D-G	12:15-12:30	D-G	2:00-2:15
H-K	12:30-12:45	H-K	2:15-2:30
L-M	12:34- 1:00	L-M	2:30-2:45
N-R	1:00- 1:15	N-R	2:45-3:00
S-T	1:15- 1:30	S-T	3:00-3:15
U-Z	1:30- 1:45	U-Z	3:15-3:45

- 4:00-7:00 Graduate Students, Students taking evening and Saturday only classes may register at this time.
- 7:00-8:00 Unclassified (nondegree) Students register at this time.

- September 25 Classes begin 8:00 A.M.
- September 27 Program Change Day: 9:00 A.M.-12:00 Noon, 1:00 P.M.-4:00 P.M., 5:00 P.M.-7:00 P.M. All program changes must be completed this day. Only class drops will be accepted after this date.
- October 6 Last day to withdraw from school to be eligible for a refund of fees.
- October 8 Last day for refund applications to be submitted to the Registrar's Office for refund of fees.
- October 20 Last day to withdraw from a course without receiving a letter grade.
- December 4 Last day to drop a class or withdraw from school except under exceptional conditions.

Calendar of Events, 1962-1963

SEPTEMBER

- 8 Saturday American College Test 8:00 A.M., Alton Student Union Building
- 7 Friday American College Test 8:00 A.M., East St. Louis Office of Student Affairs
- 21 Friday New Student Orientation
9:00 A.M.-3:30 P.M., Edwardsville Campus
4:00 P.M.-8:00 P.M., Social Activity
Bus Schedule for first day of orientation:
8:00 A.M. Buses leave Alton and East St. Louis Centers for Edwardsville
3:30 P.M. Buses leave Edwardsville for Social Activity (Place to be determined)
8:00 P.M. Buses return to Alton and East St. Louis Centers
- 22 Saturday Orientation continues at respective Centers in Alton and East St. Louis
9:00 A.M. Interpretation of test scores
10:30 A.M. Advisement

OCTOBER

- 27 Saturday Leadership Training Program. Bus leaves at 8:00 A.M. from each Center. Returns at 4:00 P.M. (Place to be determined)
Homecoming activities begin (East St. Louis)
- 28 Sunday Homecoming (Alton)
through Nov. 3

NOVEMBER

- 2 Friday Graduate Admission Examination (Objective Test), 6 P.M., Alton
- 10 Saturday American College Test 8:00 A.M., Alton Student Union Building
- 10 Saturday American College Test 8:00 A.M., East St. Louis Office of Student Affairs

- | | | |
|----|----------|---|
| 10 | Saturday | Graduate Admission Examination (Objective Test),
8:30 A.M., East St. Louis |
| 23 | Friday | Graduate Admission Examination (Essay Test), 6 P.M.,
Alton |

DECEMBER

- | | | |
|----|-----------|---|
| 1 | Saturday | Graduate Admission Examination (Essay Test), 8:30
A.M., East St. Louis |
| 19 | Wednesday | Christmas Dance |
| 28 | Friday | Orientation 1:00 P.M.—8:00 P.M. at Alton and East St.
Louis Centers |

JANUARY

- | | | |
|----|----------|--|
| 26 | Saturday | Graduate Admission Examination (Objective Test),
8:30 A.M., Alton |
|----|----------|--|

FEBRUARY

- | | | |
|----|----------|--|
| 16 | Saturday | Graduate Admission Examination (Essay Test), 8:30
A.M., Alton |
| 23 | Saturday | American College Test 8:00 A.M., Alton Student Union
Building |
| 23 | Saturday | American College Test 8:00 A.M., East St. Louis Office
of Student Affairs |

MARCH

- | | | |
|----|--------|--|
| 22 | Friday | Orientation 1:00 P.M.—8:00 P.M. at Alton and East St.
Louis Centers |
|----|--------|--|

APRIL

- | | | |
|----|----------|---|
| 13 | Saturday | Graduate Admission Examination (Objective Test),
8:30 A.M., East St. Louis |
| 20 | Saturday | American College Test 8:00 A.M., Alton Student Union
Building |
| 20 | Saturday | American College Test 8:00 A.M., East St. Louis Office
of Student Affairs |

MAY

- | | | |
|----|----------|---|
| 4 | Saturday | Graduate Admission Examination (Essay Test), 8:30
A.M., East St. Louis |
| 20 | Monday | Spring Festival (Extends through Sunday, May 26.) |

JULY

- | | | |
|----|----------|--|
| 6 | Saturday | Graduate Admission Examination (Objective Test),
8:30 A.M., Alton |
| 27 | Saturday | Graduate Admission Examination (Essay Test), 8:30
A.M., Alton |

Final Examination Schedule

Fall Quarter, 1962

Wednesday, December 12

- 8:00 A.M. Classes that meet at 8:00 A.M.
- 10:10 A.M. GSD Speech 103
- 1:00 P.M. Classes that meet at 1:00 P.M.
- 3:10 P.M. PEW 101, 107, 208, 215, 216, 223, 230, 233, 254, 255
PEM 215, 254, 262
- 4:20 P.M. Classes that meet at 4:00 P.M.
Classes that meet at 4:20 P.M. on Monday and Thursday
- 7:00 P.M. Classes that meet before 8:00 P.M. on Wednesday and
Saturday and Wednesday only classes

Thursday, December 13

- 8:00 A.M. GSD English Composition 101, Day Sections
- 11:00 A.M. PEW 321, 323
- 1:00 P.M. Classes that meet at 2:00 P.M.
- 4:20 P.M. Classes that meet at 4:20 P.M. on Tuesday and Friday
- 7:00 P.M. Classes that meet before 8:00 P.M. on Monday and Thursday
and Thursday only classes

Friday, December 14

- 8:00 A.M. Classes that meet at 9:00 A.M.
- 10:10 A.M. GSC Logic 102
- 12:50 P.M. Classes that meet at 12:00 Noon
- 3:00 P.M. Classes that meet at 3:00 P.M.
- 7:00 P.M. Classes that meet before 8:00 P.M. on Tuesday and Friday
and Friday only classes

Saturday, December 15

- 8:00 A.M. GSB Geography 101 Day Sections and classes that meet
after 8:00 P.M. on Wednesday and Saturdays
- 10:10 A.M. Saturday only classes

Monday, December 17

8:00 A.M. Classes that meet at 10:00 A.M.

1:00 P.M. Classes that meet at 11:00 A.M.

5:00 P.M. Classes that meet Monday only

7:00 P.M. Classes that meet after 8:00 P.M. on Monday and Thursday

Tuesday, December 18

8:00 A.M. Make-up examination period for day classes

5:00 P.M. Classes that meet Tuesday only

7:00 P.M. Classes that meet after 8:00 P.M. on Tuesday and Friday
Make-up examination period for evening classes

NOTE: Classes granting less than 3 hours credit will meet for one hour examinations. All classes meeting for 3 hours or more of credit will schedule two hour final examination periods.

General Information

This bulletin contains the schedule of classes to be offered at the Alton and East St. Louis centers of the Edwardsville Campus for the fall quarter of the 1962-63 school year. It also provides the student with information relative to advisement and registration, fees, various calendars of events, and allied information.

A student must be officially admitted to the University before registration in classes will be permitted. *Students who have not completed the admission requirements by the start of the registration period will not be permitted to register.* The student, to be permitted to attend classes at Southern Illinois University, must have completed registration, which includes admission, advisement, sectioning, and payment of fees.

Inquiries concerning admission to Southern Illinois University should be directed to the Admission Office at Edwardsville. Applications for admission are accepted any time during the calendar year but must be initiated on or before August 15, 1962, for the fall quarter.

Admission to Southern Illinois University constitutes admission to a particular college or instructional unit except in the case of a person who is admitted as an unclassified student. A student may also indicate the particular major field in which he is interested.

Classes offered during the winter, spring and summer sessions on the Edwardsville Campus will continue to appear in separate bulletins. Class schedule information for the University's Carbondale Campus may be secured from the General Publications Office, Carbondale.

ADMISSION

ADMISSION OF FRESHMAN STUDENTS

To be eligible for admission, a person must be either a graduate of a recognized high school, at least twenty-one years of age or a military veteran. A person twenty-one years of age and not a high school graduate is required to pass the General Educational Development Test. A military

veteran who is neither a graduate of a recognized high school nor at least twenty-one years of age may qualify for admission by passing the G.E.D. Test.

A high school senior who ranks in the upper two-thirds of his graduating class will be admitted at the close of his seventh semester, subject to the completion of his high school work, and to maintaining his rank in the upper two-thirds of his class.

A student who has been graduated from an approved secondary school, and who ranks in the lowest third of his graduating class, will be permitted to enter (on scholastic probation) for the summer, winter, or spring quarters only. Exception to this rule may be made for a student desiring to enter in the fall if he shows high scores on the University's special examinations.

The above policy will apply to both in-state and out-of-state students, except that for out-of-state students, all those in the lower *half* of their graduating class will be covered by the rule.

ADMISSION PROCEDURE

1. A high school student should apply to the Admission Office for the proper forms early in the senior year. These consist of a personnel information form (application), a secondary-school record form, a housing application (Carbondale campus only) and general information about the University.

2. When the personnel form and secondary-school record form are received in the Admission Office, the student will receive admission to the University if he ranks in the upper two-thirds of his graduating class (the ranking must be in the upper *half* for out-of-state students). The records for a high school senior should not be submitted to the Admission Office until after seventh semester grades are recorded.

3. The admission status of a student who ranks in the lowest third of his graduating class cannot be determined until after receipt of his test scores.

4. A high school senior will receive a supplementary transcript form which should be completed by the high school and returned to the Admission Office after graduation.

5. The student will receive information about advisement, testing and registration with his Certificate of Admission.

ADMISSION OF TRANSFER STUDENTS

To be considered for admission to advanced standing, a student must present a full record of his previous academic work. This record includes evidence of graduation from high school and transcripts and evidence of good standing from every college and university attended. All such tran-

scripts should be mailed directly from the institution to the Office of Admission.

Admission by transfer does not necessarily mean that all credits presented for transfer will be accepted. Transferable credits are determined through evaluation at the time of presentation. In all cases, at least three-fourths of transferable credits from each institution must be of "C" quality or above.

A transfer student admitted as an unclassified student will receive no transfer credit toward a degree so long as he remains in an unclassified status.

A transfer student is subject to this University's scholarship rules. A transfer student who is not in good scholastic standing under our scholarship rules can enter (on scholastic probation) the summer, winter, or spring quarters only, subject to the approval of the appropriate academic dean or his designated representative.

A transfer student suspended for poor scholarship or on academic probation at the last institution attended who would have been suspended under Southern's scholarship rules is not eligible for admission to Southern until at least one quarter has elapsed from the date of suspension. A transfer student dropped for any reason other than academic failure must be cleared by the Office of Student Affairs before admission will be granted.

A transfer student must take the American College Testing Program or submit to the Testing Service the results of such tests taken at another institution.

ADMISSION PROCEDURE

1. A transfer student should apply to the Admission Office for the transfer personnel information form and general information about the University.

2. A transfer student must have an official transcript from each college or university attended sent to the Admission Office. When *all* transcripts and the personnel information form have been received, the student will be advised of his admission status.

3. If he is eligible for admission in good standing, he will receive a Certificate of Admission and information about advisement, testing and registration.

4. If he must be admitted on probation, he will be referred to the dean (or his designated representative) of the academic unit which he expects to enter. If the student is not eligible for admission, he will be notified.

ADMISSION OF FORMER STUDENTS

A former student of Southern not in attendance on the campus at the

close of the quarter preceding application for admission must apply to the Admission Office for re-entrance clearance prior to registration.

A former student who is not in good standing must clear his status before the Admission Office will prepare his registration permit. It is advisable for such a student to initiate re-entrance clearance several weeks before the quarter which he plans to attend so that all inquiries may be answered and so that the applicant can find time to complete any requirements that may be imposed upon him.

ADMISSION PROCEDURE

1. A re-entering student should inform the Admission Office either personally or by mail about his desire to re-enter Southern. He will receive an application form which must be completed and returned to the Admission Office.

2. If the student is in good standing he will receive authorization to register, along with information on dates for advisement and registration for the quarter he plans to attend the University.

3. If the student cannot be re-admitted in good standing, but might possibly be re-admitted on probation, he will be referred to the dean or his designated representative of the academic unit he plans to enter for decision on the student's admission status. If the student is not eligible for readmission he will be so notified by the Admission Office.

ADMISSION OF FOREIGN STUDENTS

A foreign student is subject to all admission regulations and procedures described above. In addition, every foreign student is subject to the following requirements.

1. A foreign student must complete a questionnaire for foreign students indicating the years of attendance for all previous schooling.

2. He must pass an English proficiency examination which can be taken at the American Consulate or a similar agency operated by the American government.

3. He must show evidence of having adequate financial support; the University does not assume responsibility for a student who is without adequate resources.

ADMISSION OF UNCLASSIFIED STUDENTS

A person not working toward a degree at Southern or elsewhere who wishes to register for particular courses offered in any of the departments and divisions of the University without undertaking all of the regular plans of study may be admitted as an unclassified student. Such a student

must present satisfactory evidence (high school or college transcript) that he is prepared to take advantageously the work required.

Application for admission as an unclassified student should be made at the Registrar's Office. Such a student must sign a statement indicating that he is not a degree student and that credit received cannot be applied toward a degree at this University while he is enrolled as an unclassified student.

ADMISSION OF GRADUATE STUDENTS

Qualified students may apply for admission to the Graduate School any time during the calendar year. Application forms may be obtained from the Admission Office. Official admission to the Graduate School will not be granted until complete transcripts of all previous college work are on file in the Admission Office. Transcripts must reach the Admission Office at least one month prior to the time the applicant expects to enter Southern Illinois University in the case of one seeking the master's degree, and four months for one whose aim is the doctorate.

ADMISSION PROCEDURE

1. A graduate student should apply to the Admission Office for the necessary application forms. If a student writes, he should include in his letter the date he plans to enter Southern, the name of the last institution attended, and his plans for graduate work, including a statement of whether or not he plans to work toward a graduate degree at Southern.

2. The student should complete the application forms as directed and return them to the Admission Office. He should request one (1) transcript of credits for *each* college and/or university attended and three (3) transcripts from the institution which granted the baccalaureate degree. (On the Carbondale campus only one (1) transcript from the institution which granted the baccalaureate degree is required.) All transcripts should be sent directly to the Admission Office from the institutions attended and must reach the Admission Office at least one month prior to the student's desired matriculation date if he is seeking a master's degree and four months prior to matriculation if he is seeking a doctor's degree.

ADVISEMENT AND REGISTRATION

CURRENT STUDENTS

All students currently registered in the University will be continued in their present curriculum unless a change of major is made. A change of major is initiated with the student's adviser. This change should be made

at the time of advisement, and the registrar's copy of the change form should accompany the student's registration. Changes of major made after a registration has been processed will not be reflected in the student's record until the next registration.

ADVISEMENT

Advisement of students is the responsibility of the University faculty. A chief academic adviser is located at each academic center. Upper division students who have declared a major field will be assigned to divisional advisers. Arrangements for a conference with the major adviser should be scheduled as early as possible by the student in planning his program. Lower division students and those undecided as to a major field will be advised by the chief academic adviser.

During the registration periods a staff of faculty advisers will be available for consultation with students.

REGISTRATION

The Edwardsville Campus follows a pattern of advance registration during the summer prior to the fall quarter. A general registration is also held on the first day of each quarter. It is to the student's advantage to advance register in having choice of classes and times.

Students must register for classes at the location where they plan to attend in accordance with the registration calendar on page viii.

SOCIAL SECURITY IDENTIFICATION NUMBER

The University will require students to present social security numbers for student identification in the fall of 1964. Students should be prepared to present their social security card bearing the identification number at the time of registration for the Fall, 1962, quarter. Persons who do not have social security numbers should apply for information on how to obtain one at their local post office.

REQUIRED TESTS

All entering freshmen must take the American College Testing Program prior to advisement and registration. Illinois residents who ranked in the lowest third of their graduating class must take the test battery before they can be considered for admission. Out-of-state students who rank in the lower one-half of their graduating classes must take the tests prior to admis-

sion. High School students are encouraged to take the American College Testing Program during the spring of their senior year and thus be ready for academic advisement during the summer. A complete set of dates and test centers is available from the Registrar's Office. Students who are not able to take the tests in the spring may make arrangements to be tested on one of the dates listed in the testing calendar.

TESTING CALENDER

Saturday, June 23, 1962	Alton
Saturday, June 23, 1962	East St. Louis
Wednesday, July 25, 1962	East St. Louis
Thursday, July 26, 1962	Alton
Saturday, August 4, 1962	East St. Louis
Saturday, August 11, 1962	Alton
Thursday, August 23, 1962	East St. Louis
Friday, August 24, 1962	Alton
Friday, September 7, 1962	East St. Louis
Saturday, September 8, 1962	Alton
Thursday, September 20, 1962 (Only by very special permission)	Alton and East St. Louis

Transfer students are expected to take the tests unless they have their scores forwarded from their former school. These scores are not normally sent with one's transcript and should be requested from the appropriate office of the former school before the registration period.

FEES

A student who advance registers will receive his fee statement and receipt card by mail and his fees may be paid either by mail or in person by the deadline date specified in the Registration Calendar. Upon payment of fees, the fee statement and receipt card will be stamped by the bursar and returned to the student. This card which serves as the official authorization to attend classes as scheduled must be presented to obtain textbooks and activity cards and to process program changes. It should be carried at all times. If fees are paid in person, the card will be given to the student at the time of payment. If paid by mail, the card may be picked up at any time thereafter at the bursar's office.

A student who does not advance register must pay his fees at the time he registers.

Illinois students taking more than 8 hours will pay the following regular fees:

Tuition	\$42.00
Book rental	5.00
Activity fee	9.50
Student union building fund	5.00
TOTAL	\$61.50

Illinois students taking 8 or fewer hours will pay the following fees:

Tuition	\$21.00
Book rental	2.50
Student union building fund	5.00
TOTAL	\$28.50

(Optional activity fee \$9.50 for part-time students)

Once an option has been made by a student at the time of registration as to whether or not to pay the activity fee, such option is irrevocable.

Out-of-state students will pay an additional \$50 if they take more than eight hours, or an additional \$25 if they take eight hours or less.

In addition to the above, there are some physical education classes that require a special fee.

Students having special fee status such as scholarship holders, faculty and staff, will pay their respective fees according to the particular status.

The University reserves the right to change fees and have the change go into effect whenever the proper authorities so determine.

AUDITING OF COURSES

A student may register for courses in an "audit" status. He receives no letter grade and no credit for such courses. An auditor's registration card must be marked accordingly. He pays the same fees as though he were registering for credit. He is expected to attend regularly and is to determine from the instructor the amount of work expected of him. If an auditing student does not attend regularly, the instructor may determine that the student should not have the audited course placed on his record card maintained in the Registrar's Office. A student registering for a course for credit may not later change to an audit status or vice versa except for fully justified reasons. Such a change will ordinarily require the academic dean's approval.

PROGRAM CHANGES AND WITHDRAWALS

A student is officially registered for only those courses appearing on his registration cards. Any change therefrom can be made only after fees are

paid and must be made through an official program change. A student is considered officially registered after he has cleared his payment of fees at the Business Office.

A prescribed procedure must be followed by any student desiring to change his academic program or to withdraw from the University while the period for which he is registered is still in progress. Failure to follow the prescribed procedure will result in academic penalty.

PROGRAM CHANGES

Mere attendance does not constitute registration in a class, nor will attendance in a class for which a student is not registered be a basis for asking that a program change be approved permitting registration in that class.

A program change must be made in order to drop or add a course. A student may not drop a course merely by stopping attendance. If a student desires to drop a course during the second, third, or fourth week of a quarter, the change will be approved only when the reasons appear valid. If a student desires to drop a course after the fourth week, the change will be approved only under unusual conditions. In the last three weeks of a quarter changes will be approved only in extreme emergencies.

A student processing a program change is required to present his fee receipt program card at the Registrar's Office and must complete the following procedure.

The student must initiate approval for the change with his adviser. For changes made after the regularly scheduled program change day, the approved program change form must then be taken by the student to the Registrar's Office within twenty-four hours after approval by the adviser. After having been cleared with the Registrar's Office, program changes for which a program change fee is assessed must be presented to the Business Office for payment. The student immediately returns the program change to the Enrollment Center in the Registrar's Office for final processing. *A student has not completed his program change until he presents it to the Enrollment Center in the Registrar's Office.* No change is official until the preceding procedure is complete.

A program change day is listed in the registration calendar.

WITHDRAWAL FROM SCHOOL

A student who finds it necessary to withdraw from school while the quarter is in progress must report to the Registrar's Office to initiate official withdrawal action. No withdrawal will be permitted during the last two weeks of a quarter except under exceptional conditions. A refunding of fees

is permitted only if a withdrawal is officially completed within the first two weeks of a quarter and if the application for a refund is received in the Registrar's Office within two weeks following the last regular registration period. See the registration calendars for the specific dates concerning withdrawal and refunding of fees.

CANCELLATION OF REGISTRATION

A registration including the payment of tuition and fees may be considered invalid if the student is declared to be ineligible to register due to scholastic reasons. The same situation may exist due to financial or disciplinary reasons if certified to the registrar by the director of the Office of Student Affairs.

PERSONAL DATA CHANGES

1. A CHANGE IN ADDRESS, whether local, home, or parents', is to be reported by the student to the Registrar's Office as soon as possible after the change occurs. The above addresses for a student are obtained from his Number 7 registration card when he first registers for a quarter during the year. Address changes are not made thereafter during the year unless they are reported by the student.

2. A CHANGE IN NAME is to be reported to the Enrollment Center in the Registrar's Office. A change for marital reasons will be made on the basis of a signed statement. Other changes may require the presenting of legal evidence.

3. A CHANGE IN MARITAL STATUS is to be reported to the Registrar's Office. A change will be made if it is based upon incorrect coding or punching. Any other change must be accompanied by a signed statement.

4. A CHANGE IN LEGAL RESIDENCE (whether an Illinois or out-of-state resident) is to be requested on the Application to be Declared an Illinois Resident form in the Registrar's Office. Before the request is honored, the registrar must be satisfied that the student has met the regulations governing residency status as established by the Board of Trustees.

VETERANS' INFORMATION

The Edwardsville Campus of Southern Illinois University is approved for veterans. Veterans eligible to receive benefits under the GI bill should contact the University veterans' adviser during registration periods. Public Law 550 expires in 1965. War orphans should discuss Public Law 634 benefits with the veterans' adviser.

Veterans enrolled under Public Law 550 and war orphans under Public Law 634 are subject to the following regulations regarding academic load required for proportional subsistence for the regular quarter.

<i>Type of Enrollment</i>	NUMBER OF HOURS REQUIRED			
	<i>Undergraduate</i>		<i>Graduate</i>	
	<i>Quarter</i>	<i>Summer</i>	<i>Quarter</i>	<i>Summer</i>
Full-time enrollment	14	10	10	7
$\frac{3}{4}$ -time enrollment	10-13	7-9	8-9	6
$\frac{1}{2}$ -time enrollment	7-9	5-6	5-7	4-5
Less than $\frac{1}{2}$ -time enrollment	6 or less	4 or less	4 or less	3 or less

To be eligible for the benefits of Public Law 550 or Public Law 634, the student must be fully admitted and enrolled as a regular classified student making satisfactory progress in a degree program.

Veterans attending under one of the public laws should note that the Registrar's Office will certify enrollment and attendance to the Veteran's Administration for subsistence purposes only as of the date when fees were cleared at the Bursar's Office.

SIGN-UP PERIODS

Veterans and war orphans eligible for benefits will sign a monthly attendance certification on the last Tuesday of each month starting October 30, 1962 at the Registrar's Office in Alton or East St. Louis.

Checks for the first sign-up period should not be expected before November 20. Veterans who fail to sign on the specified date will probably experience delay in receiving the check for that period.

ACADEMIC LOAD

1. The normal class load for a student is sixteen quarter hours, with a maximum of eighteen hours.
2. A student with a 4.25 average or above for the preceding quarter may be allowed by the chief academic adviser of the center or by the head of his division to take as many as twenty-one hours. In no case may a student carry or be credited with more than twenty-one hours in any quarter.
3. A student on probation may not take more than fourteen hours.
4. A person may not register for more than eight quarter hours if he is employed full time.
5. Veterans and war orphans must carry a minimum of 14 quarter hours to qualify for full-time training allowance.

6. The Selective Service System requires a minimum of 12 quarter hours to qualify for a student deferment.
7. The National Defense Education Act requires a minimum of 12 quarter hours to qualify for a student loan.

RESPONSIBILITY OF THE STUDENT

Each student must assume responsibility for his progress by keeping an up-to-date record of the courses he has taken and by checking periodically with his adviser and the Registrar's Office. Responsibility for errors in program or in interpretation of regulations of the University rests entirely with the student.

Maps of Edwardsville Campus

THE FOLLOWING MAPS have been prepared to acquaint the students with the facilities of the Alton center and the East St. Louis center.

EAST ST. LOUIS CENTER

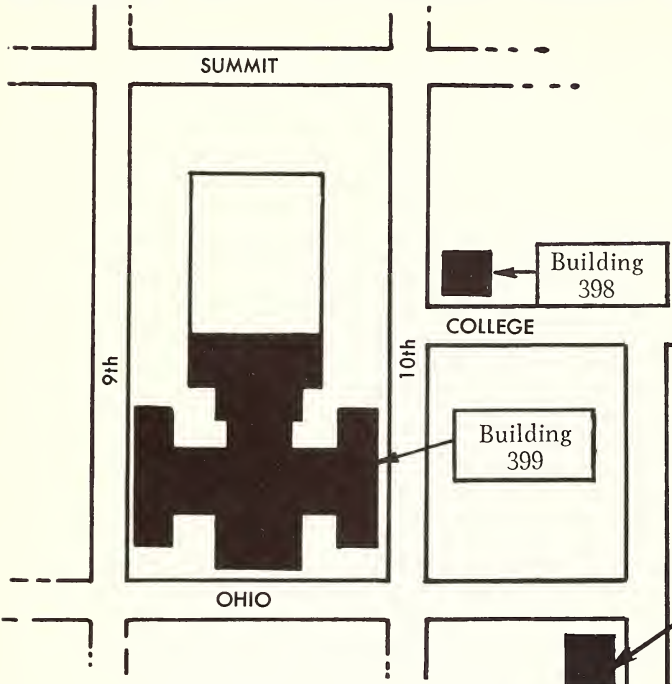

FIRST FLOOR

- A Cafeteria
- B Faculty Lounge
- C Student Lounge
- D Student Employment
- E Office of Student Affairs
- F Mechanics Room
- G Women's Gym
- H Women's Shower
- I Men's Shower
- J Men's Gym
- K Public Administration & Metropolitan Affairs
- L Library Areas
- M Librarian's Office

♂ —Men
 ♀ —Women

SECOND FLOOR

- N Machine Calculating Room
- O Academic Advisement
- P Evening Office
- Q Auditorium
- R Health Service
- S Divisional Offices
- T Mail Room
- U Business Office
- V Registrar's Office
- W University Store & Textbook Rental

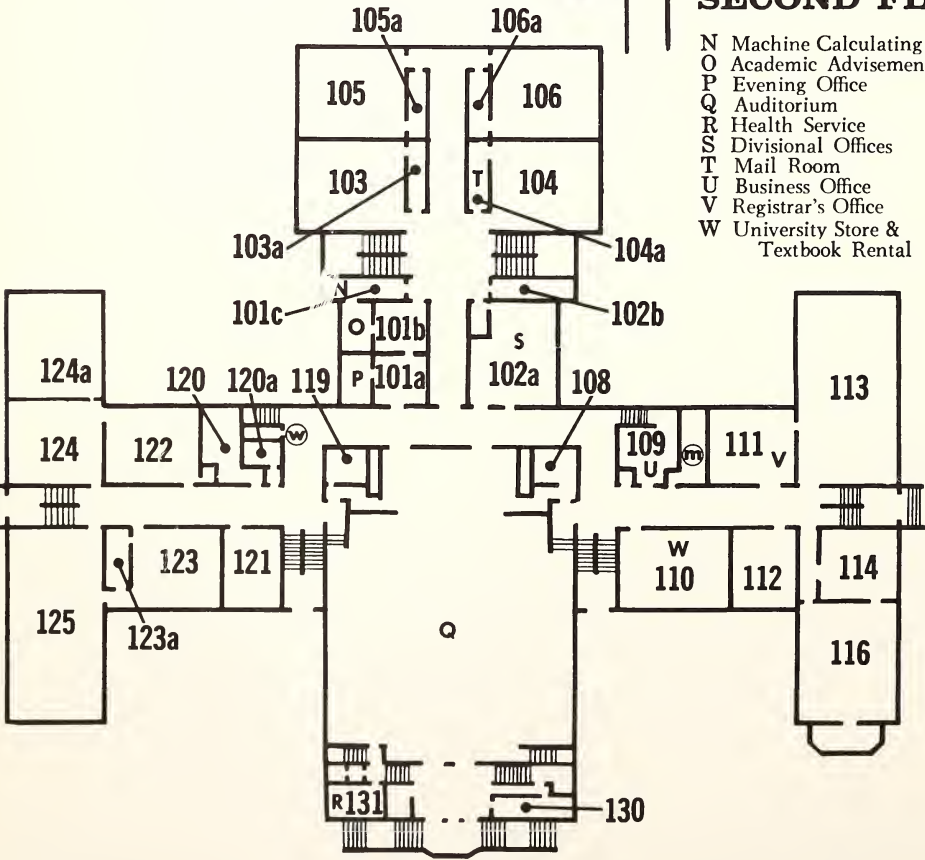

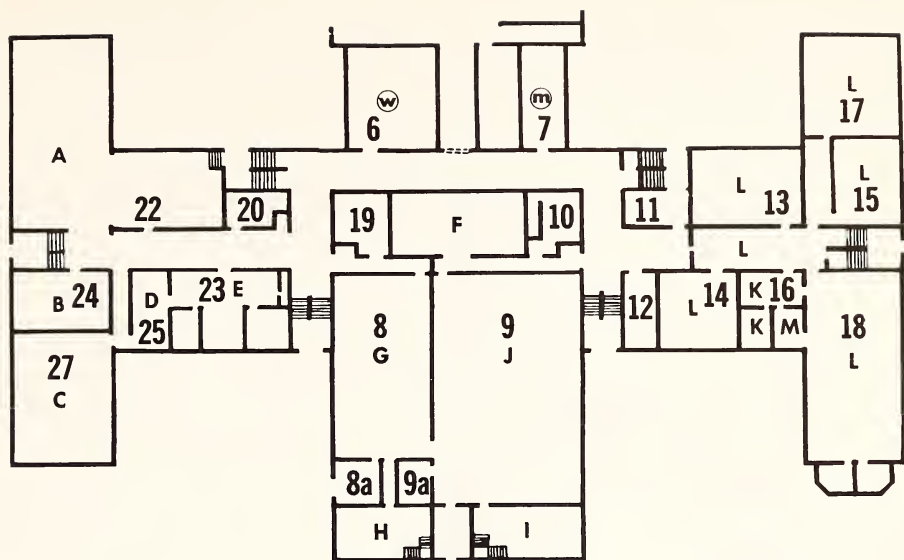

THIRD FLOOR

- X Auditorium
- Y Student Council
- Z Student Journalism
(see below)

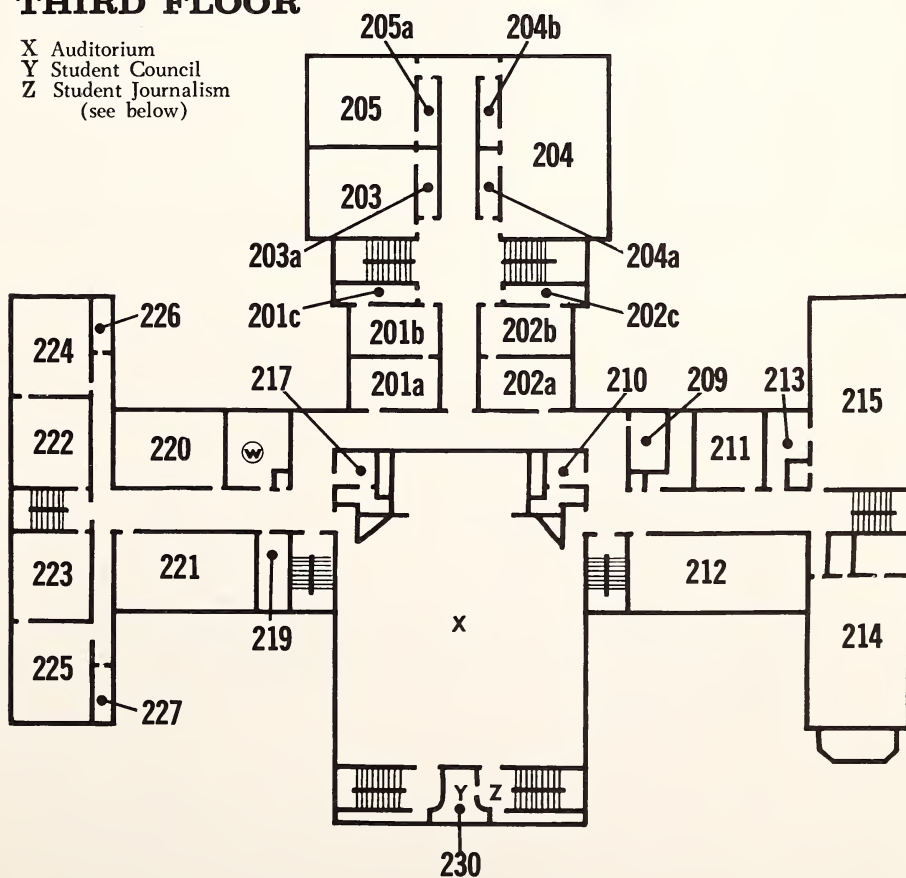

ALTON CENTER

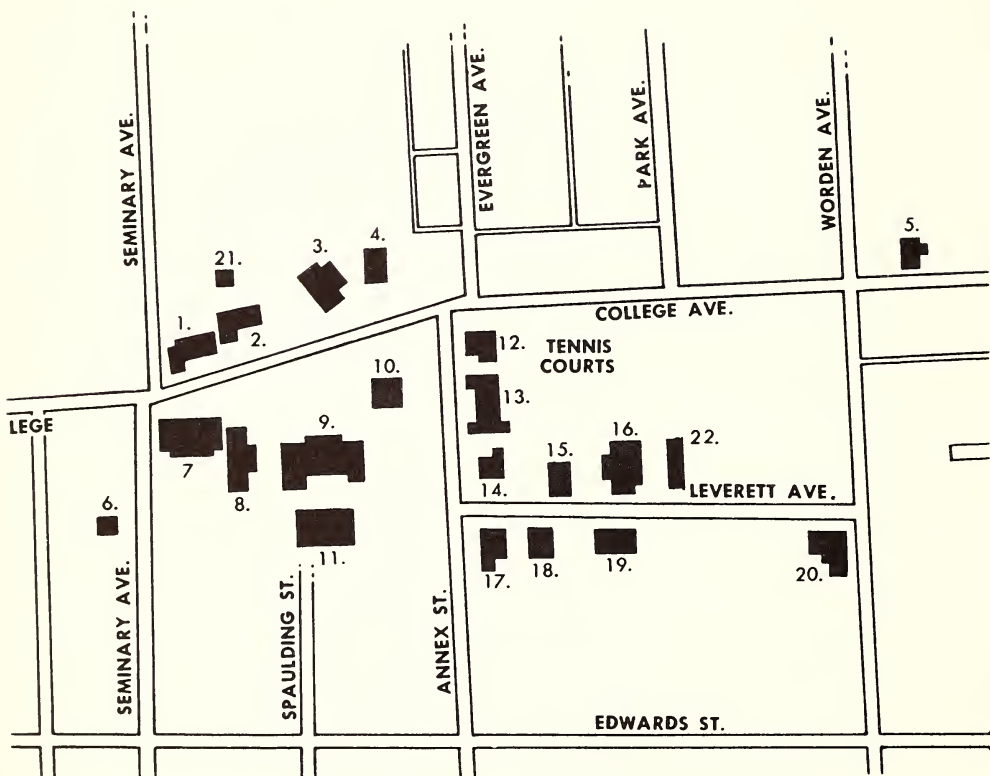

- | | |
|--|---|
| 1 Business Office | 12 Annex B (ANB) |
| 2 Registrar | 13 Annex A (ANA) |
| 3 Student Union, Student Affairs, Student Employment and Placement and Health Service (SU) | 14 Fine Arts B (FAB) |
| 4 Fine Arts C (FAC) | 15 Humanities (HUM) |
| 5 Education A—Madison County Mental Health Clinic (EDA) | 16 Administration
Evening Division Offices
Division Heads' Offices
Graduate Office |
| 6 Language Laboratory | 17 Classrooms |
| 7 Library | 18 Social Studies (SS) |
| 8 Fine Arts A (FAA) | 19 Business Faculty Offices |
| 9 Science (SCI) | 20 Shurtleff Foundation |
| 10 Auditorium (AUD) | 21 Storage |
| 11 Gymnasium (Gym) | 22 Graduate Advisement Office |

Class Schedule Information

The following material may be of value in interpreting the information appearing in the class schedule.

The University reserves the right to change or cancel any class.

COURSE NUMBER AND HOURS

The column containing this information shows the number of the course first, followed by the number of hours of credit. Course numbers are three-digit numbers. In some cases the three digits may be followed by a letter which is also part of the course number. The number appearing after the hyphen denotes the hours of credit for the course. In some cases there may be more than one number following the course number such as 599-2 to 5. This represents a variable-hour course in which the student decides the number of hours for which he is going to register in consultation with his adviser.

The course numbering system is as follows:

- 000-099 Course not properly falling in freshman, sophomore, etc. sequence.
- 100-199 For freshman
- 200-299 For sophomores
- 300-399 For juniors and seniors
- 400-499 For seniors and graduate students
- 500-600 For graduate students only

PREREQUISITES

For the guidance of students many courses list the courses which need to have been taken before the one under question can be taken. These prerequisites may be listed in a number of different ways. If only a number

appears in the column, this refers to the division's own course. If the course is another division course, the division will be listed prior to the number. On advanced course levels registration in a course may require the consent of the instructor or of the department.

COURSES "TO BE ARRANGED"

Students registering for courses listed as "to be arranged" should consult with the division head to determine time and place of meeting.

FREE BUS TRANSPORTATION

To provide students with a broader program, certain upper division classes have been scheduled around a bus transportation schedule. Free bus service will be provided between Alton and East St. Louis on Mondays, Tuesdays, Thursdays, and Fridays.

Classes scheduled for inter-campus bus transportation meet twice weekly for periods of one and one-half or two hours.

The bus will depart from East St. Louis on the Ohio Street side and from Alton on College and Seminary streets.

Students taking courses on the bus schedule will not need to travel during the week of final examinations to take their tests. The examination will be proctored at the center at which the course does not meet by the chief academic adviser or a member of his staff.

Likewise, students will not need to travel to return their textbooks. The bookstore personnel will accept texts for courses on the bus schedule at the location different from the one at which the course meets, provided that the student makes clear this situation to the attendant at the time of book return; otherwise record confusion will result.

BUS SCHEDULE

DEPART	ARRIVE	DEPART	ARRIVE
EAST ST. LOUIS	ALTON	ALTON	EAST ST. LOUIS
8:00 A.M.	8:50 A.M.	9:00 A.M.	9:50 A.M.
10:00 A.M.	10:50 A.M.	11:00 A.M.	11:50 A.M.
12:00 Noon	12:50 P.M.	1:00 P.M.	1:50 P.M.
2:00 P.M.	2:50 P.M.	3:00 P.M.	3:50 P.M.
4:00 P.M.	4:50 P.M.		

GENERAL STUDIES PROGRAM

The University is requiring all new students to participate in a vital general studies program starting with the fall quarter, 1962. Under study by the University faculty for a period of years, the first stages of the program are now ready.

Freshmen entering in the fall of 1962 are expected to complete the general studies program as part of the University general degree requirement. Five areas of study are included in the program:

Area A Man's Physical Environment and Biological Inheritance

Area B Man's Social Inheritance and Social Responsibilities

Area C Man's Insights and Appreciations

Area D Organization and Communication of Ideas

Area E Health and Physical Development

A typical freshman schedule of classes for the fall quarter will consist of from three to five general studies courses, one of which should be GSD 101-3, English Composition. The courses should be selected from the following list:

GSA 101-3 Introduction to Physical Science I—Physics

GSB 101-3 Introduction to Western Tradition—Geographic Background

GSC 102-3 Logic, or 103-3 Art Appreciation, or 104-3 Music Understanding

GSD 101-3 English Composition, 103-3 Oral Communication of Ideas, 105-3 Introduction to Mathematics, or 123-3 Elementary French, or 126-3 Elementary German, or 136-3 Elementary Russian, or 140-3 Elementary Spanish

GSE 201-3 Healthful Living

A student may waive the first level general studies sequence in Area A, B, or C to begin immediate work in his major field. Proficiency examinations may also be used to gain admission to advance level courses.

A special advisement period for freshmen and new students has been arranged for July 16 at Alton and July 18 at East St. Louis to counsel students on registering for the fall quarter. The registration calendar lists time and place.

ACADEMIC UNITS

BUSINESS DIVISION

Accounting
Economics
Management
Marketing
Secretarial Science

EDUCATION DIVISION

Administration
Elementary
Industrial
Secondary
Special
Guidance
Health Education
Instructional Materials
Physical Education
Psychology

FINE ARTS DIVISION

Art
Music
Speech
Theater

HUMANITIES DIVISION

Comparative Literature
English
Foreign Languages
Journalism
Philosophy

SCIENCE AND TECHNOLOGY DIVISION

Applied Science
Astronomy
Botany
Chemistry
Mathematics
Physics
Physiology
Zoology

SOCIAL SCIENCES DIVISION

Anthropology
Geography
Government
History
Sociology

Schedule of Classes

Title	Course No. & Hours	Section No. Alton E. St. Louis	Remarks	Time	Days	Room	Instructor
GENERAL STUDIES AREA A—MAN'S PHYSICAL ENVIRONMENT AND BIOLOGICAL INHERITANCE (GSA)							
Introduction to Physical Science I—Physics	101-3	Lecture	Prereq.: One year of high school algebra, Mathematics 100 or satisfactory score on mathematics placement test. Students enroll for the lecture and one laboratory section. The Friday classes and laboratory sections meet every other week.	3:00-3:50	Tu ThF	AUD 200	Staff
		1		1:00-2:50	Tu	SCI 7	Staff
		2		1:00-2:50	Tu	SCI 7	Staff
		3		3:00-4:50	F	SCI 7	Staff
		4		3:00-4:50	M	SCI 7	Staff
		5		3:00-4:50	M	SCI 7	Staff
		Lecture		3:00-3:50	Tu ThF	204	Staff
		51		1:00-2:50	Tu	124	Staff
		52		1:00-2:50	Tu	124	Staff
		53		3:00-4:50	F	124	Staff
		54		3:00-4:50	M	124	Staff
		55		3:00-4:50	M	124	Staff
GENERAL STUDIES AREA B—MAN'S SOCIAL INHERITANCE AND SOCIAL RESPONSIBILITIES (GSB)							
Introduction to Western Tradition—Geographic Background	101-3	Voluntary discussion groups 1 and map work at 8:00, 10:00 and 2:00 on Thursdays for sections 1, 2, 51 and 52.		8:00-8:50	M W F	AUD 200	Harper
		2		10:00-10:50	M W F	AUD 200	Kazeck
		E3		6:20-7:45	M Th	AUD 200	Harper
		51		8:00-8:50	M W F	215	Guffy
		52		2:00-2:50	M W F	215	Guffy
		E53		6:20-7:45	Tu F	215	Brooks
GENERAL STUDIES AREA C—MAN'S INSIGHTS AND APPRECIATIONS (GSC)							
Logic	102-3	Day students enroll for the lecture section and one quiz section.		10:00-10:50	Tu Th	AUD 200	Staff
		1		8:00-8:50	M	SCI 2	Staff
		2		9:00-9:50	M	AUD 100	Staff
		3		1:00-1:50	F	ANA 100	Staff
		E4		8:20-9:45	Tu F	AUD 100	Staff
		Lecture		10:00-10:50	Tu Th	204	Staff
		51		8:00-8:50	M	103	Staff
		52		9:00-9:50	M	205	Staff
		53		1:00-1:50	F	116	Staff
		E54		6:20-7:45	M Th	112	Staff

Title	Course No. & Hours	Remarks	Section No. Alton E. St. Louis	Time	Days	Room	Instructor
GENERAL STUDIES AREA D—ORGANIZATION AND COMMUNICATION OF IDEAS (GSD) (Continued)							
English Composition	101-3	Prereq.: Test score necessary for all sections.	58B	12:00-12:50	MTu ThF	201 b	Staff
			59B	1:00-1:50	MTu ThF	225	Staff
			60B	2:00-2:50	MTu ThF	201 b	Staff
			61B	3:00-3:50	MTu ThF	201 b	Staff
			E62B	6:20-8:10	M Th	201 b	Staff
			E63B	8:20-10:10	M Th	201 b	Staff
			E64B	8:20-10:10	M Th	225	Staff
			E65B	6:20-8:10	Tu F	201 b	Staff
			E66B	8:20-10:10	Tu F	201 b	Staff
			E67B	6:20-8:10	Tu F	225	Staff
			E68B	6:20-8:10	W	201 b	Staff
				9:00-10:50	Saturday	201 b	Staff
			69C	8:00-8:50	MTuWThF	225	Staff
English Composition	102-3	Prereq.: English 102.	70C	12:00-12:50	MTuWThF	225	Staff
			71C	2:00-2:50	MTuWThF	225	Staff
			1B	2:00-2:50	MTu ThF	AUD 102	Staff
			ES2B	6:20-8:10	W	AUD 100	Staff
				9:00-10:50	Saturday	AUD 100	Staff
			ES51B	8:20-10:10	W	225	Staff
Oral Communication of Ideas	103-3	Day students enroll for the lecture and one practice section.	52B	11:00-12:50	Saturday	225	Staff
				8:00-8:50	MTu ThF	124 a	Hawkins
				11:00-11:50	Tu	AUD 200	Staff
				8:00-8:50	M W	ANB 102	Staff
				9:00-9:50	M W	ANB 102	Staff
				9:00-9:50	M W	ANB 201	Staff
				10:00-10:50	M W	ANB 201	Staff
				11:00-11:50	M W	ANB 102	Smith
				1:00-1:50	M W	ANB 102	Smith
				1:00-1:50	M W	ANB 101	Staff
				2:00-2:50	M W	ANB 201	Staff
				6:00-7:50	M Th	ANB 102	Smith
			Lecture	11:00-11:50	Th	AUD	Hawkins
			51	9:00-9:50	M W	106	Birdman
			52	10:00-10:50	M W	106	Birdman
			53	10:00-10:50	M W	203	Staff
			54	11:00-11:50	M W	106	Staff
			55	11:00-11:50	M W	112	Staff
			56	1:00-1:50	M W	106	Birdman
			57	2:00-2:50	M W	106	Staff

Title	Course No. & Hours	Remarks	Section No.		Time	Days	Room	Instructor
			Alton	E. St. Louis				
ACCOUNTING (ACCT)								
Elementary Accounting I	251-4		1		8:00-8:50	MTu	ThF	Milles
			2		10:00-10:50	MTu	ThF	Schmitt
			3		2:00-2:50	MTu	ThF	Staff
			E4		6:20-8:10	M	Th	Schmitt
			E5		8:20-10:10	Tu	F	Staff
	253-4	Prereq.: 252.		51	9:00-9:50	MTu	ThF	Small
				52	1:00-1:50	MTu	ThF	Staff
				E53	6:20-8:10	M	Th	Staff
				E54	6:20-8:10	Tu	F	Small
				E55	8:20-10:10	Tu	F	Staff
Elementary Accounting III	253-4	Prereq.: 252.	1		11:00-11:50	MTu	ThF	Staff
				E51	8:20-10:10	M	Th	Davison
Tax Accounting	331-5	Prereq.: 253.	1		9:00-9:50	MTuWThF	ANA 100	Milles
Cost Accounting	341-3	Prereq.: 253.	E1		8:20-10:35	M	Th	Staff
Advanced Accounting I	351-4	Prereq.: 253.		51	6:20-7:45	Tu	F	Staff
				51	10:00-10:50	MTu	Th	Small
		E2		51	12:00-12:50	MTuW	F	Milles
Governmental Accounting	B355-3	Prereq.: 253. Offered at Alton. See bus schedule on back cover.	1		8:20-10:10	M	Th	Schmitt
				E52	11:00-11:50	MTu	ThF	Davison
Governmental Accounting	355-3				6:20-8:10	M	Th	Davison
					11:00-12:25	M	Th	Schmitt
Accounting Systems	458-4	Prereq.: 341 and 353.		E51	5:30-8:10	W	221	Staff
			E1		6:20-8:10	M	Th	Staff
ANTHROPOLOGY (ANTH)								
Ways of Mankind	110-4		1		9:00-9:50	MTuWTh	SS 200	Schusky
The Origins of Civilization	304-4		E1		8:20-10:10	M	Th	Schusky

APPLIED SCIENCE (AP SCI)

Engineering Drawing I

101-3

1
2
E3

8:00-9:50
10:00-11:50
6:20-9:10
3:00-4:50
6:20-9:10

M W F
M W F
M Th
M W F
Tu F

ANA 109
ANA 179
ANA 109
211
211

Staff
Staff
Staff
Staff
Staff

Analytical Mechanics (Statics)

260-3

Prereq.: Mathematics 251
(or concurrent enrollment)
and Physics 211 (or concurrent enrollment).

51

6:20-7:45
2:00-2:50

Tu W F
M W F

ANA 109
211

Staff
Staff

ART (ART)

Basic Studio

100-5

15 hours of 100 required for
all studio courses other than
300.

1
E2

1:00-2:50
1:00-1:50
6:20-9:50
9:00-10:50
9:00-9:50

MTuWTh F
M Th
MTu ThF
W

FAA 202
FAA 202
FAA 202
214
214

Staff
Staff
Staff
Milovich
Milovich

Beginning Ceramics

203-4

Prereq.: 15 hours of 100.

1

10:00-11:50

MTu ThF

FAA 103

Howerton

Figure

Oil Painting

245-4
250-4

Prereq.: 15 hours of 100.
Prereq.: 12 hours of 245
or consent of instructor.

1
1

10:00-11:50
2:00-3:50

MTu ThF
MTu ThF
MTu ThF

FAA 103
FAA 103
FAA 200
Alby St. Studio

Howerton
Howerton
Staff
Staff

Title	Course No. & Hours	Remarks	Section No.		Time	Days	Room	Instructor
			Alton	E. St. Louis				
ART (ART) (Continued)								
Art Education	300-4	For elementary education majors and art education majors. Student may elect up to 12 hours. At E. St. Louis, students taking this course for the first time should enroll for the fall or spring quarter.	1		9:00-10:50	M W F	FAA 102	Buddemeyer
			2	51	1:00-2:50	M W F	FAA 102	Buddemeyer
				E52	1:00-2:50	M W F	214	Milovich
					4:20-7:15	M Th	214	Milovich
Beginning and Advanced Ceramics	302-4	Prereq.: 12 hours of 203 or consent of instructor.	E1		6:20-9:50	M Th	FAA 103	Howerton
Advanced Painting	320-4	Prereq.: 12 hours of 250 or consent of instructor.	1		2:00-3:50	MTu ThF	Alby St. Studio	Staff
Studio	325-4	Prereq.: Consent of instructor.	1		Arranged	Arranged	Arranged	Staff
History of World Art I	326-4	Prereq.: Art major or consent of instructor.	E1		6:20-8:10	Tu F	FAA 100	Richardson
Prints	358-4	Prereq.: 245 and 250 or consent of instructor.	1		10:00-11:50	MTu ThF	Alby St. Studio	Richardson
Research in Painting	401-4	Prereq.: Consent of art faculty.	1		Arranged	Arranged	Arranged	Staff
Research in Prints	410-4	Prereq.: Consent of art faculty.	1		Arranged	Arranged	Arranged	Staff
BOTANY (BOT)								
General Botany	101-5		1		8:00-8:50	Tu ThF	SCI 2	Staff
			2		8:00-9:50	M W	SCI 100	Staff
					8:00-8:50	Tu ThF	SCI 2	Staff
					12:00-1:50	M W	SCI 100	Staff
			51	10:00-10:50	M W F	215	Staff	
			52	10:00-11:50	Tu Th	116	Staff	
				10:00-10:50	M W F	215	Staff	
				8:00-9:50	M W	116		
General Botany	202-5		1		10:00-10:50	M W F	SCI 100	Staff
					10:00-11:50	Tu Th	SCI 100	Staff

CHEMISTRY (CHEM)

General Chemistry

101-4

E1

6:00-7:15
7:25-10:15

M

Th

SCI 200
SCI 200 and
SCI 206

Staff

Chemical Principles and
Inorganic Chemistry

111-5

1

ES51

8:20-9:35
9:00-11:50
8:00-8:50
8:00-8:50

M

Th

SCI 200

Staff

2

8:00-8:50
8:00-8:50

M

W

SCI 200

Staff

3

8:00-8:50
8:00-10:50

M

Th

SCI 200

Staff

4

12:00-12:50
12:00-2:50

M

W

SCI 200

Staff

5

12:00-12:50
12:00-2:50

M

W

SCI 200

Staff

6

12:00-12:50
2:00-2:50

M

Th

SCI 200

Staff

E7

6:00-7:15
7:25-8:55

M

F

SCI 200

Staff

51

8:00-8:50
10:00-11:50

M

Th

SCI 206

Staff

52

8:00-8:50
1:00-2:50

M

Th

SCI 206

Staff

53

8:00-8:50
1:00-2:50

M

Th

SCI 206

Staff

54

8:00-8:50
3:00-4:50

M

Th

SCI 206

Staff

55

12:00-12:55
10:00-11:50

M

Th

SCI 206

Staff

Title	Course No. & Hours	Remarks	Section No. Alton E. St. Louis	Time	Days	Room	Instructor
CHEMISTRY (CHEM) (Continued)							
Chemical Principles and Inorganic Chemistry	111-5		56	12:00-12:50 1:00-2:50	MTu ThF M W	113 125	Staff
			57	12:00-12:50	MTu ThF	113	Staff
			58	1:00-2:50 12:00-12:50	Tu Th MTu ThF	125 113	Staff
				3:00-4:50	Tu Th	125	
Qualitative Analysis	221-3	Prereq.: 113.	E1	6:00-6:50 6:50-9:20	Tu F Tu	SCI 201 SCI 207	Staff
			51	10:00-10:50	Tu Th	113	Staff
			52	1:00-3:50 10:00-10:50 1:00-3:50	Tu Th Tu Th Th	123 113 123	Staff
Organic Chemistry	341-4	Prereq.: 113. Laboratory period for section E51 ar- ranged.	1	1:00-1:50 1:00-3:50	M W F Tu	SCI 201 SCI 207	Staff
Senior Seminar	375-0 to 1	Prereq.: Open to majors in junior year for no credit. Required each quarter of senior year for majors.	1	6:00-7:30 Arranged Arranged	M Th Arranged Arranged	202 a Arranged Arranged	Staff Staff Staff
Intermediate Inorganic Chemistry Physical Chemistry	411-3 461-4	Prereq.: 331. Prereq.: 331, 343, Mathe- matics 253 and Physics 213.	E1 E1	8:20-9:35 6:20-7:35 6:20-9:10	M Th M Th W	SCI 200 SCI 201 SCI 203	Staff Staff
			51	10:00-10:50	M W F	113	Staff
			52	1:00-3:50 10:00-10:50 1:00-3:50	M M W F W	123 113 123	Staff
COMPARATIVE LITERATURE (C LT)							
Comparative Literature before the Renaissance	B301-4	Prereq.: Sophomore litera- ture requirement. Offered at Alton. See bus schedule on back cover.	1	1:00-2:50	Tu F	AUD 101	Guenther

ECONOMICS (ECON)

Survey of Economics Principles	205-5	1 E2	9:00-9:50 5:55-8:10	MTuWThF Tu F	SCI 200 ANA 101 104	Wassen Staff Cohen Luan Van Dahm Staff Saubier Staff
Economic Principles and Problems	206-4	1 E2	Prereq.: 205. 51 E52	9:00-9:50 5:55-8:10 2:00-2:50 8:20-10:10 11:00-11:50 8:20-10:10	MTuWThF M Th MTu ThF M Th MTu ThF M Th	ANA 101 ANA 101 ANA 101 ANA 101 104 104
Economic and Business Statistics I	307-4	1 E2	Prereq.: 205, Mathematics 106 recommended.	10:00-10:50 5:55-8:10	MTuWThF M Th	ANA 101 ANB 202
Labor Problems	310-4	51	Prereq.: 206 or 205 and consent of instructor.	8:00-8:50	MTuWThF	Luan
Money and Banking I	315-4	1 E2	Prereq.: 205.	2:00-2:50 6:20-8:10 1:00-1:50 8:20-10:10 9:00-9:50 12:00-12:50 12:00-1:50	ThF Tu F MTu ThF Tu F MTu ThF MTu ThF Tu F	Saubier Saubier Van Dahm Van Dahm Luan Schwier Glynn
Economic History of the United States International Economics I	317-4 B328-4	1	Prereq.: 205. Prereq.: 206 or 205 and consent of instructor. Offered at East St. Louis. See bus schedule on back cover.	51	51	Schwie
Public Finance I: National	B330-4	51	Prereq.: 206 or 205 and consent of instructor. Offered at East St. Louis. See bus schedule on back cover.	10:00-11:50	Tu F	Cohen
Intermediate Theory	440-3	E51	Prereq.: 206 or 205 and consent of instructor.	5:30-8:10	W	Cohen
History of Economic Thought	450-3	E1	Prereq.: 206 or 205 and consent of instructor.	5:30-8:10	W	Wassen
Economic Theories	B451-3	1	Prereq.: 450 or consent of instructor. Offered at Alton. See bus schedule on back cover.	11:00-12:25	M Th	Wassen

Title	Course No. & Hours	Remarks	Section No. Alton E. St. Louis	Time	Days	Room	Instructor
EDUCATIONAL ADMINISTRATION AND SUPERVISION (ED AD)							
The American Educational Systems	331-3		1 E2	8:00-8:50 5:30-8:10 12:00-1:25	M W F Tu M	SCI 102 HUM 100 104	Carpenter Van Horn Staff
The American Educational Systems	B331-3	Offered at East St. Louis. See bus schedule on back cover.	51				
Philosophy of Education	B355-4	Offered at Alton and East St. Louis. See bus schedule on back cover.	1 51	9:00-10:50 10:00-11:50	Tu F M Th	SS 105 104	Curry Southwood
Philosophy of Education	355-4		E2	6:20-8:10	M Th	SS 105	Curry
School Administration	424-4	4 additional sessions to be arranged.	E1	5:30-8:10	M	AUD 101	Brubaker
School Supervision	456-4	4 additional sessions to be arranged.	E51	5:30-8:10	Th	105	Jung
Research Methods	500-4	Prereq.: Guidance 422 recommended.	E51	5:30-8:10	Th	212	Steinkellner
Illinois School Law	520-4		E51	5:30-8:10	M	212	Smith Staff
School Buildings	533-4		E1	5:30-8:10	W	HUM 100	
Contrasting Philosophies of Education	554-4		E1	5:30-8:10	W	AUD 101	Wheat Staff
Individual Research	575-2 to 4	Prereq.: Consent of instructor.	1 51	Arranged Arranged Arranged	Arranged Arranged Arranged	Arranged Arranged Arranged	Staff
EDUCATION—ELEMENTARY (ED EL)							
Understanding the Elementary School Child	203-3	Prereq.: Psychology 201. 2 hours per week observation arranged.	1 51	1:00-1:50 1:00-2:50	M Th W	HUM 100 105	Carpenter Kelley
Children's Literature	313-4		E1	4:20-6:10	Tu F	SS 105	Carpenter
Elementary School Methods	B314-4	Prereq.: Guidance 305. Offered at Alton. See bus schedule on back cover.	1	1:00-2:50	Tu F	ANA 108	Carpenter

Kindergarten-Primary Methods and Curriculum	316-4	Prereq.: Guidance 305.	E51	4:20-6:10	M	Th	106	Kelley
Reading in the Elementary Schools	B337-4	Prereq.: 314 or 316, and Guidance 305. Offered at East St. Louis. See bus schedule on back cover.	51	2:00-3:50	M	Th	105	Steinkellner
Kindergarten-Primary Student Teaching	350D-8 to 12	Prereq.: Must apply to education division 2 quarters in advance.	1	Arranged	Arranged	Arranged	Arranged	Steinbrook
Advanced Kindergarten-Primary Student Teaching	350E-4 to 8	Prereq.: 350D.	1	Arranged	Arranged	Arranged	Arranged	Steinbrook
Elementary Student Teaching	351D-8 to 12	Prereq.: Must apply to education division 2 quarters in advance.	1	Arranged	Arranged	Arranged	Arranged	Steinbrook
Advanced Elementary Student Teaching	351E-4 to 8	Prereq.: 351D.	1	Arranged	Arranged	Arranged	Arranged	Steinbrook
Improvement of Instruction in Arithmetic in the Elementary School	415-4	Prereq.: Mathematics 210 or consent of instructor. 4 additional sessions to be arranged.	E1	5:30-8:10	F		HUM 100	Steinbrook
Problems in Reading	437-4	Prereq.: 337. 4 additional sessions to be arranged.	E1	5:30-8:10	Tu		ANA 108	Bear
Materials and Methods in Elementary School Science	442-4	4 additional sessions to be arranged.	E51	5:30-8:10	F		106	Bliss
The Elementary School Curriculum	461-4	4 additional sessions to be arranged. Not open to students who have had Educational Administration 460.	E51	5:30-8:10	M		105	Bear
Improvement of Reading Instruction	505-4	Not for students who have had 337 or 437.	E51	5:30-8:10	W		201 a	Steinkellner
Readings in Reading	507-2 to 4	Prereq.: Consent of instructor.	1	Arranged	Arranged	Arranged	Arranged	Bear
Language Arts in the Elementary School	542-4		E1	5:30-8:10	W		ANA 101	Steinkellner
Individual Research	575-2 to 4	Prereq.: Consent of instructor.	1	Arranged	Arranged	Arranged	Arranged	Bear
			51					Steinkellner

Title	Course No. & Hours	Remarks	Section No. Alton E. St. Louis	Time	Days	Room	Instructor
EDUCATION—SECONDARY (ED SEC)							
High School Methods	315-4	Prereq.: Guidance 305.	1 E2	11:00-11:50 4:20-6:10	MTu M Th	SCI 102 ANA 108	Curry Smyers
High School Methods	B315-4	Prereq.: Guidance 305. Offered at East St. Louis. See bus schedule on back cover.	51	2:00-3:50	M Th	103	Staff
Secondary Student Teaching	352D-8 to 12	Prereq.: must apply to education division 2 quarters in advance.		Arranged	Arranged	Arranged	Steinbrook
Sec. Student Teaching Agriculture			1				
Sec. Student Teaching Art			2				
Sec. Student Teaching Biology			3				
Sec. Student Teaching Business			4				
Sec. Student Teaching Chemistry			5				
Sec. Student Teaching Economics			6				
Sec. Student Teaching English			7				
Sec. Student Teaching Foreign Language			8				
Sec. Student Teaching General Science			9				
Sec. Student Teaching Geography			10				
Sec. Student Teaching Government			11				
Sec. Student Teaching Health Education			12				
Sec. Student Teaching History			13				
Sec. Student Teaching Home Economics			14				
Sec. Student Teaching Industrial Education			15				
Sec. Student Teaching Journalism			16				
Sec. Student Teaching Mathematics			17				
Sec. Student Teaching Music			18				
Sec. Student Teaching Physical Education			19				
Sec. Student Teaching Physics			20				
Sec. Student Teaching Sociology			21				
Sec. Student Teaching Social Studies			22				
Sec. Student Teaching Speech			23				
Sec. Student Teaching Library Service			24				
Sec. Student Teaching Psychology			25				
Sec. Student Teaching School Nursing			26				
Secondary Student Teaching (See above list under 352D)	352E-4 to 8	Prereq.: 352D.	1-26 51-76	Arranged Arranged	Arranged Arranged	Arranged Arranged	Steinbrook Steinbrook

The Junior High School	407-4	4 additional sessions to be arranged.	E51	5:30-8:10	Tu	103	Bliss
Extra-Class Activities	470-4	4 additional sessions to be arranged.	E1	5:30-8:10	W	AUD 102	Schnabel
Teaching the Natural Sciences in Secondary School	487-4	Prereq.: 315 or consent of instructor. 4 additional sessions to be arranged.	E1	5:30-8:10	Th	AUD 101	Bliss
Improvement of Reading Instruction Workshop in High School Curriculum Individual Research	505-4 562-4 575-2 to 4	Prereq.: Consent of instructor.	E51 S51 51	5:30-8:10 9:00-11:40 Arranged Arranged	W Saturday Arranged Arranged	203 201 a Arranged Arranged	Steinkellner Smyers Smyers Bliss

EDUCATION—SPECIAL (ED SP)

Problems and Characteristics of the Mentally Retarded	410-4	Prereq.: Guidance 305 or Psychology 301 or 303. 4 additional sessions to be arranged.	E51	5:30-8:10	Tu	224	Tucker
Education of Gifted Children	412-4	Prereq.: Guidance 305 or Psychology 301 or 303. 4 additional sessions to be arranged.	E1	5:30-8:10	M	ANB 201	Tucker
Directed Observation of Exceptional Children	413-4	Prereq.: Consent of instructor. Must be taken with 410. 4 additional sessions to be arranged.	E51	5:30-8:10	Tu	224	Tucker
The Exceptional Child	414-4	Prereq.: Guidance 305 or Psychology 301 or 303. 4 additional sessions to be arranged.	E51	5:30-8:10	W	225	Tucker

ENGLISH (ENG)

Introduction to Poetry	205-3	Prereq.: 103 or equivalent.	E1	6:20-7:45	Tu	F	AUD 200	Staff
Introduction to Drama	206-3	Prereq.: 103 or equivalent.	51	9:00-9:50	M	W	212	Staff
Introduction to World Literature	209-3	Prereq.: 103 or equivalent.		10:00-10:50	M	W	F	Staff
Introduction to Fiction	211-3	Prereq.: 103 or equivalent.	E51	6:20-7:45	Tu	F	113	Staff

Title	Course No. & Hours	Remarks	Section No.		Time	Days	Room	Instructor
ENGLISH (ENG) (Continued)								
Principles of English Grammar	300-4	Prereq.: Sophomore literature requirement.	E1	51	8:20-10:10 1:00-1:50	Tu F MTu ThF	HUM 100 103	Staff Staff
English Literature to 1550	302-4	Prereq.: Sophomore literature requirement.	1 E2		10:00-10:50 6:20-8:10	MTu ThF M Th	AUD 102 HUM 205	Staff Staff
Modern British Poetry	B330-4	Prereq.: Sophomore literature requirement. Offered at Alton. See bus schedule on back cover.	1	51	9:00-9:50 11:00-12:50	MTu ThF Tu F	224 AUD 101	Staff Staff
Development of the English Novel	B354-4	Prereq.: Sophomore literature requirement. Offered at East St. Louis. See bus schedule on back cover.		51	10:00-11:50	M Th	201 a	Staff
Usage in Spoken and Written English	391-3	Prereq.: Sophomore literature requirement.	1	51	4:00-4:50 4:00-4:50	MTu Th MTu Th	AUD 100 202 b	Staff Staff
Chaucer	402-4	Prereq.: Sophomore literature requirement.	E1		8:20-9:45	M Th	HUM 100	Staff
American Literature to 1789	431-4	Prereq.: Sophomore literature requirement.	E1		6:20-8:10	Tu F	HUM 205	Staff
Individual American Writers (Whitman)	501-4		ES1		8:20-10:10 11:00-12:50	W Saturday	HUM 205 HUM 205	Staff
FOREIGN LANGUAGE (F L)								
FRENCH (FR)								
French Conversation	101c-1	Elected only by students enrolled in the corresponding beginning sections.	1 2 3 E4		10:00-10:50 11:00-11:50 2:00-2:50 7:45-8:10	F F F Th	HUM 100 HUM 100 HUM 100 HUM 100	Staff Staff Staff Staff

Intermediate Course	201-3	Prereq.: 103. Offered once annually and only at Alton.	E1	4:20-5:45	Tu	F	HUM 205	Staff
Advanced French Conversation	B220-4	Prereq.: 103. Offered at Alton. See bus schedule on back cover.	1	11:00-12:50	Tu	F	LL 201	Ball
Survey of French Literature	311-4	Prereq.: 153.	E1	8:20-10:10	M	Th	LL 201	Ball
GERMAN (GER) German Conversation	101c-1	Elected only by students in the corresponding beginning sections.	1 2 3 E4	10:00-10:50 1:00-1:50 2:00-2:50 7:45-8:10	F F F Th	F	HUM 205 HUM 205 HUM 205 ANA 108	Staff Staff Staff Staff
				51 52 53 E54	F F F Th	F	202 b 202 b 202 b 202 b	Staff Staff Staff Staff
Intermediate Course	201-3	Prereq.: 103.	E1	4:20-5:45	M	Th	HUM 205	Staff
Advanced German Conversation	220-4	Prereq.: Consent of instructor.	E1	2:00-2:50 6:20-8:10	MTu M	Th	201 a LL 201	Staff Staff Staff
Goethe's Faust, Part I	401-2	Prereq.: 2 years of German or equivalent. Offered once annually and only at Alton.	E1	4:20-6:10	Tu		LL 201	Staff
RUSSIAN (RUSS) Russian Conversation	101c-1	Elected only by students enrolled in the corresponding beginning sections.	51 E52	12:00-12:50 7:45-8:10	Tu	F	221 221	Staff Staff
Intermediate Course	201-3	Prereq.: 103. Offered once annually and only at East St. Louis.	51	4:20-5:45	M	Th	201 a	Staff

Title	Course No. & Hours	Remarks	Section No.		Time	Days	Room	Instructor
FOREIGN LANGUAGE (F L) (Continued)								
SPANISH (SPAN) Spanish Conversation	101c-1	Elected only by students enrolling in the corresponding beginning section.	51	E54	11:00-11:50	F	205	Staff
					2:00-2:50	F	205	Staff
					3:00-3:50	F	201 a	Staff
					7:45-8:10	Tu	201 a	Staff
Intermediate Course	201-3	Prereq.: 103. Offered once annually and only at East St. Louis.	E51		4:20-5:45	M	201 b	Staff
Spanish Phonetics	415-3	Prereq.: 2 years of Spanish or equivalent.	E51		8:20-9:45	M	201 a	Staff
GEOGRAPHY (GEOG)								
Cultural Geography	100-5	Meets old social studies requirement.	1	51	9:00-9:50	MTuWThF	ANA 110	Vogel
Physical Geography	101-5	Natural science credit for education majors.	1	51	9:00-9:50	MTuWThF	AUD	Snaden
					10:00-10:50	MTuWThF	ANA 108	Vogel
					1:00-1:50	MTuWThF	222	Snaden
Economic Geography	211-5	Required for business majors.	1	51	11:00-11:50	MTuWThF	ANA 110	Gonzalez
					11:00-11:50	MTuWThF	222	Brooks
Geography of Illinois	313-3	Prereq.: 100 or consent of instructor.	E1		8:20-9:45	M	ANA 110	Harper
		Natural science credit for education majors.						
Geography of South America	316-4	Natural science credit for education majors.	E51		6:20-8:10	M	222	Gonzalez
Geography of Asia	318-4	Natural science credit for education majors.	51		10:00-10:50	MTu	222	Snaden

Historical Geography of the United States	319-4	1	1:00-1:50	MTuWTh	ANA 110	Vogel
Restoration and Conservation of Natural Resources	324-4	51	9:00-9:50	MTu ThF	222	Staff
Geography of the Caribbean Lands	413-3	1	12:00-12:50	M WTh	ANA 110	Gonzalez
Political Geography	444-4	51	2:00-2:50	MTuW F	222	Brooks
GOVERNMENT (GOV)						
American Government	190-5	Lecture 1	8:00-8:50	MTuWTh	ANA 104	Glaser
		2	8:00-8:50	F	ANA 108	Staff
		3	9:00-9:50	F	SS 200	Staff
		4	10:00-10:50	F	SCI 2	Staff
		E5	12:00-12:50	F	SS 105	Staff
			5:55-8:10	Tu F	ANA 104	Baker
			11:00-11:50	MTuWThF	204	Goodman
		E52	5:55-8:10	M Th	204	Lucatz
State and Local Government	232-4	1	1:00-1:50	MTuWTh	ANA 100	Schwab
Introduction to American Foreign Policy	243-3	51	10:00-10:50	M W F	224	Lucatz
The Legislative Process	B340-3	51	2:00-3:25	M Th	104	Goodman
Introduction to Public Administration	360-4	E1	6:20-8:10	M Th	AUD 100	Schwab
Selected Problems in Public Administration and Policy Formulation	361-3	51	2:00-3:25	Tu F	103	Mann
International Relations	370-4	1	11:00-11:50	MTuWTh	AUD 102	Glaser
Political Parties	380-4	1	9:00-9:50	MTuWTh	HUM 205	Baker
Principles of Comparative and Foreign Governments	390-5	51	12:00-12:50	MTuWThF	103	Lucatz

Title	Course No. & Hours	Remarks	Section No.		Time	Days	Room	Instructor
			Alton	E. St. Louis				
GOVERNMENT (GOV) (Continued)								
American Chief Executive	406-4	Prereq.: 101 or 190 or 231. 4 additional sessions to be arranged.		51	5:30-8:10	W	104	Lovell
GUIDANCE (GUID)								
Educational Psychology	B305-4	Prereq.: Psychology 201. Offered at Alton and East St. Louis. See bus schedule on back cover.	1		11:00-12:50 2:00-3:50	Tu F M Th	SCI 3 124 a	Staff Evans
Educational Psychology	305-4		2 E3	E52	9:00-9:50 8:20-10:10 6:20-8:10	MTu ThF M Th F Tu F	SCI 208 SCI 201 220	Johnson Staff Staff
Mental Hygiene	412-4	Prereq.: 305. 4 additional sessions to be arranged.	E1		5:30-8:10	W	ANB 201 105	Rasmussen
Educational Measurements I	422-4	Prereq.: 305. 4 additional sessions to be arranged.	S1		9:00-11:40	Tu Saturday	SCI 201 204	Johnson Johnson
Basic Principles of Guidance	442-4	Prereq.: 305. 4 additional sessions to be arranged.	E1		5:30-8:10	W Th	AUD 103	Tallana Davis
Special Research Problems	501-2 to 6	Prereq.: Consent of instructor.	1		Arranged	Arranged	Arranged	Rasmussen
Psychological Aspects of Education	515-4		E1	51	Arranged	Arranged	Arranged	Troyer
School Behavior Problems and their Prevention	525-4	Prereq.: 412 or consent of instructor.		S51	5:30-8:10	M	AUD 103	Rasmussen
Counseling Theory and Practice I	537-4	Prereq.: 442 or consent of instructor.	E1		9:00-11:40	Saturday	204	Meredith
Occupational Information and Guidance	541-4			E51	5:30-8:10	Tu	ANB 202	Banaghan
Problems in Guidance: Pupil Adjustment	545F-4	Prereq.: 412, 525, and consent of instructor.		S51	5:30-8:10	W	106	Eversull
Problems in Guidance: Organization and Administration	545J-4		S1		9:00-11:40	Saturday	204	Meredith
					9:00-11:40	Saturday	AUD 103	Eversull

Child Development in Education	562A-4	Prereq.: 412 or consent of instructor.	E51	5:30-8:10	F	105	Troyer
Adolescent Development in Education	562B-4	Prereq.: 412 or consent of instructor.	E51	5:30-8:10	F	105	Troyer

HEALTH EDUCATION (H ED)

Methods and Materials in Secondary School Health Education	460-4		E1	6:20-8:10	M	Th	SCI 3	Spear
--	-------	--	----	-----------	---	----	-------	-------

HISTORY (HIST)

Survey of Western Civilization	101-3		1 E2	1:00-1:50 8:20-9:45 2:00-2:50	MTu M	Th	AUD 200 AUD 102	Erickson Jarard
			51 E52	8:20-9:45	Tu	Th	204	Cohen
				1:00-1:50	M	F	203	Cohen
Survey of Western Civilization	103-3	Prereq.: 102.	1 E2	8:20-9:45	M	W	ANA 104	Kimball
			51 E52	11:00-11:50	Tu	F	AUD 101	Kimball
				8:20-9:45	M	W	215	Haas
					M	Th	203	Haas

The United States to 1865	201-5		1 E2	12:00-12:50 5:55-8:10	MTuWThF Tu	Th	AUD 102 AUD 102	Jarard Jarard
			51 E52	9:00-9:50	MTuWThF	Th	203	Rosenthal
				5:55-8:10	Tu	F	203	McCurry
The United States Since 1865	202-5		1	10:00-10:50	MTuWThF	Th	AUD 101	Riddleberger
				11:00-11:50	MTuWThF	Th	203	McCurry

History of the Ancient Near East	B304-3	Prereq.: Freshman survey. Offered at E. St. Louis. See bus schedule on back cover.	51	12:00-1:25	M	Th	203	Cohen
The Negro in America	B309-4	Prereq.: 201 or 202. Offered at Alton. See bus schedule on back cover.	1	1:00-2:50	Tu	F	SS 200	Riddleberger

Title	Course No. & Hours	Remarks	Section No. Alton E. St. Louis	Time	Days	Room	Instructor
HISTORY (HIST) (Continued)							
Russian History to 1905	372-3	Prereq.: Freshman survey.	E1	6:20-7:45	Tu F	AUD 101	Kimball
English Constitutional History	418-3	Prereq.: Freshman survey.	E51	6:20-7:45	M Th	203	Haas
American Colonial History	425-3	Prereq.: 201.	51	8:00-8:50	M W F	203	McCurry
Historiography	B451-3	Prereq.: Freshman survey. Offered at Alton. See bus schedule on back cover.	1	11:00-12:25	Tu F	SS 200	Erickson
History Seminar	500-4	Seminar on 17th century history.	E51	Arranged	Arranged	Arranged	Erickson
HUMANITIES (HUM)							
Humanities I (Honors Program)	B301-3	Prereq.: Sophomore literature requirement. Under- graduate credit only. En- trance by invitation of the Honors Program Committee. Offered at Alton. See bus schedule on back cover.	1	9:00-10:30	Tu	LL 201	Staff
INSTRUCTIONAL MATERIALS (IM)							
School Libraries as Information Centers	306-4	Four additional sessions to be arranged.	E1	5:30-8:10	Tu	ANA 110	Staff
Audio-Visual Methods in Education	417-4	Prereq.: Guidance 305. Four additional sessions to be ar- ranged.	S51	9:00-11:40	Saturday	103	Staff

JOURNALISM (JRNL)

News Writing and Editing I

B201-3	Offered at Alton. See bus schedule on back cover.	I	1:00-1:50 1:00-2:50	Tu	F	SU SU	Lee
B345-3	Offered at Alton. See bus schedule on back cover.	I	1:00-2:25	M	Th	SU	Lee

History of Journalism

MANAGEMENT (MGT)

Introduction to Business Administration

170-4		I E2 E3	10:00-10:50 6:20-8:10 8:20-10:10 10:00-10:50 8:20-10:10	MTuW M Th Tu F MTu ThF M Th	F	ANA 104 ANA 104 ANA 108 204 204	Skjerseth Skjerseth Staff Ingwersen Ingwersen
			51 E52				

Principles of Programming For Electronic Data Processing

241-4	Prereq.: Management 240 or equivalent or consent of instructor. Meets at East St. Louis on Wednesday and at Edwardsville on Saturday.	I E2	5:30-8:10 9:00-10:50	W Saturday		205 (Edws.)	Small
271-4	Prereq.: English 103 or equivalent.	I E2	11:00-11:50 6:20-8:10 6:20-8:10	MTu ThF Tu F M Th		ANB 101 ANB 101 201 a	Brady Staff Burkhead

Corporation Finance

320-5	Prereq.: Accounting 253 and Economics 205.	I E2	12:00-12:50 5:55-8:10 11:00-11:50	MTuWThF Tu F MTuWThF		ANB 101 ANB 102 202 b	Pinkstaff Staff Staff
323-4	Prereq.: 320.	I	11:00-11:50	MTuW F		ANB 202	Skjerseth Staff
327-4	Prereq.: Accounting 253 and Economics 206.		9:00-9:50	MTuWTh		211	

Investments

General Insurance

Real Estate

Business Organization And Management

328-3	Prereq.: Junior standing or consent of instructor.	I	5:30-8:10 9:00-9:50 6:20-8:10 8:20-9:45	W MTuW Tu F Tu F		202B ANB 101 202 b ANB 101	Staff McKinney Staff Staff
340-4			1:00-1:50	M WTh		202 b	Staff
361-3		E1					

Title	Course No. & Hours	Remarks	Section No.		Time	Days	Room	Instructor
MANAGEMENT (MGT) (Continued)								
Business Law I	371-4		1 E2		8:00-8:50 8:20-10:10	M WThF M Th	ANB 101 ANB 101	Staff Staff
Production Management	380-4	Prereq.: Economics 206.	E1	51 E52	8:00-8:50 8:20-10:10	MTuWTh M Th	221 106	Staff Staff
Personnel Management	385-4	Prereq.: Economics 206.	E1		6:20-8:10 8:20-10:10	M Th M Th	AUD 102 ANB 102	McKinney McKinney
				51	10:00-10:50	MTu ThF	104	Staff
Management of Business Finance	421-4	Prereq.: 320.	E1		6:20-8:10	M Th	ANA 110	Blackledge
Small Business	B472-4	Offered at Alton. See bus schedule on back cover.	1		1:00-2:50	M Th	ANA 108	Blackledge
Business Enterprise and Public Policy	473-4			E51	6:20-8:10	M Th	211	Ingwersen
Problems In Business and Economics	B479-4	Offered at East St. Louis. See bus schedule on back cover.		51	12:00-1:50	Tu F	212	Ingwersen
Problems in Personnel Management	485-4	Prereq.: 385.	1		10:00-10:50	M WThF	ANB 101	Blackledge
MARKETING (MKTG)								
Principles of Marketing	230-5	Prereq.: Economics 205 or consent of instructor.	1 E2		11:00-11:50 5:55-8:10 11:00-11:50	MTuWThF M Th MTuWThF	SCI 2 SS200 103	Vincent Vincent Staff
				E52	5:55-8:10	M Th	225	McCauley
Retailing	331-4	Prereq.: 230.	1		10:00-10:50	MTuWTh	SCI 102	Pinkstaff
Principles of Advertising	333-4	Prereq.: 230.	1		1:00-1:50 8:20-10:10	MTu ThF Tu F	ANA 101 202 b	Pinkstaff Staff
Purchasing	336-3	Prereq.: 230.		E51	10:00-10:50	M WTh	103	McCauley
Principles of Salesmanship	337-4	Prereq.: 230.	1	51	8:00-8:50	MTu ThF	ANA 101	Bosse
Transportation	341-4	Prereq.: 230.	E1	E51	8:20-10:10	M Th	202 a	McCauley
Wholesaling	349-3	Prereq.: 230.	E1		6:20-8:10 8:20-9:45	Tu F Tu F	SS200 ANA 101	Bosse Bosse

Wholesaling	B349-3	Prereq.: 230. Offered at East St. Louis. See bus schedule on back cover.	51	12:00-1:25	Tu	F	211	Staff
Traffic Management Advertising Management	451-4 B463-3	Prereq.: 341. Prereq.: 333 or 384. Offered at Alton. See bus schedule on back cover.	E51	6:20-8:10 9:00-10:25	Tu M	F Th	124 a SS 105	Staff Vincent
MATHEMATICS (MATH) Elementary Mathematics	100-0		1 2	1:00-1:50 2:00-2:50 8:00-8:50 9:00-9:50 10:00-10:50	MTu MTu MTu MTu MTu	ThF ThF ThF ThF ThF	SCI 103 SCI 103 220 220 220	Staff Staff Staff Staff Staff
	107B-4	Prereq.: 106 or intermediate algebra in high school.			MTuWThF		SCI 103	Staff
	111-5	Prereq.: 106 or 3 semesters of high school algebra and percentile on guidance test.	1 2 3 4 5 E6 E7	10:00-10:50 11:00-11:50 12:00-12:50 1:00-1:50 2:00-2:50 5:55-8:10 5:55-8:10	MTuWThF MTuWThF MTuWThF MTuWThF M Th Tu F		SCI 103 SCI 103 SCI 2 SCI 2 SCI 103 SCI 103	Staff Staff Staff Staff Staff Staff
			51 52 54 55 E56	10:00-10:50 11:00-11:50 12:00-12:50 1:00-1:50 2:00-2:50 5:55-8:10	MTuWThF MTuWThF MTuWThF MTuWThF MTuWThF M Th		205 220 220 220 220 220	Staff Staff Staff Staff Staff Staff
		Prereq.: 112 or 1/2 year of high school trigonometry and 97% on guidance test.	1 E2	1:00-1:50 5:55-8:10 8:00-8:50 8:20-10:35	MTuWThF M Th MTuWThF M Th		SCI 3 SCI 2 205 220	Staff Staff Staff Staff
	113-5							
	Calculus and Analytic Geometry I							
Elementary Statistics	220-4	Prereq.: 106.	1	4:00-4:50 1:00-1:50 8:20-10:10	MTu MTu Tu	ThF ThF F	SCI 103 205 220	Staff Staff Staff

Title	Course No. & Hours	Remarks	Section No.		Time	Days	Room	Instructor
			Alton	E. St. Louis				
MATHEMATICS (MATH) (Continued)								
Calculus and Analytic Geometry II	251-4	Prereq.: 113.	1 E2		8:00-8:50 6:20-8:10	MTu ThF Tu F	SCI 103 SCI 2	Staff Staff
				51 52	8:00-8:50 10:00-10:50	MTu ThF MTu ThF	202 b 225	Staff Staff
Calculus and Analytical Geometry IV	253-4	Prereq.: 252.	1		1:00-1:50	MTu ThF	SCI 102	Staff
Fundamental Concepts of Algebra I	320-3	Prereq.: 252	1		10:00-10:50 8:20-9:35	M WTh M Th	SCI 2 205	Staff Staff
Vector Analysis	324-3	Prereq.: 253.	E1	E51	6:20-7:35	Tu F	SCI 3	Staff
Vector Analysis	B324-3	Offered at East St. Louis. See bus schedule on back cover.		51	10:00-11:15	Tu F	202 a	Staff
Concepts of Geometry I	B335-3	Prereq.: 252. Offered at East St. Louis. See bus schedule on back cover.		51	12:00-1:15	Tu F	202 b	Staff
Statistical Analysis I	410-3	Prereq.: 106.	1		4:00-4:50 1:00-1:50	MTu ThF MTu ThF	SCI 2 202 a	Staff Staff
Advanced Calculus	452-3	Prereq.: 253.	E1	E52	8:20-10:10	Tu F	205	Staff
Advanced Calculus	B452-3	Offered at East St. Louis. See bus schedule on back cover.		51	8:20-9:35 2:00-3:15	M Th Tu F	SCI 103 202 a	Staff Staff
Probability and Statistics	480-3	Prereq.: 253.	E1		8:20-9:35	M Th	SCI 3	Staff
MUSIC (MUS)								
University Band	001-1	Open to all University students upon audition.	1		1:00-1:50	MTuWThF	FAB 100	Fjerstad
Collegiate Singers	002C-1	Open to all University students upon audition.	1	51	11:00-11:50 11:00-11:50	M W F MTuWThF	AUD FAB 100	Fjerstad Headley
University Chorus	002D-1/2	Open to all University students upon audition.	E1	51	2:00-3:00 8:15-10:15 8:15-10:15	M W F M Tu	212 AUD 200 212	Headley Headley Headley

Orchestra	003-1	Open by audition. Credit for music majors only.	El	Arranged	Arranged	Staff
Class Strings	010-1	Two quarters or proficiency required of majors.	1	9:00-9:50	FAB 208	Staff
Class Piano	040-1	Six quarters or proficiency required of majors. Prereq.: for non-majors 200 or equivalent. 200 and 040 may be taken concurrently. Altton: Sec. 1 for 2nd year music majors, Sec. 2 for non-majors, Sec. 3 for 1st year music majors. E. St. Louis: Sec. 51 for non-majors.	1 2 3	12:00-12:50 1:00-1:50 2:00-2:50 4:20-5:35	M W F M W F M W F M Th	Boldt Boldt Boldt Boldt
Private Piano	041-1 to 4	For music majors or minors. Open to others under exceptional conditions.	1	51 Arranged	Arranged	Boldt Boldt
A French Horn B Trumpet Class Brass - C Trombone D Tuba E Baritone	050-1	Two quarters or proficiency required of majors.	1	8:00-8:50	M W F	Fierstad
Class Voice	060-1	Three quarters or proficiency required of majors.	1	9:00-9:50	M W F	Staff
Theory of Music	105-4	Fall quarter only.	1	9:00-9:50	MTuWThF	Kresteff
Fundamentals of Music	200-3	May be taken concurrently with 040 class piano.	El	4:20-5:35	M Th	Warren
Theory of Music	205-4	Prereq.: 107. Fall quarter only.	1	10:00-10:50	MTuWThF	Warren
Music Education in The Elementary School	301-3	For music majors only. Fall quarter only.	1	10:00-10:50	M W F	Blakely
Orchestration I	309-2	Prereq.: 207. Fall quarter only.	1	11:00-11:50	Tu Th	Kresteff
Analysis I	326-2	Prereq.: 207. To be taken concurrently with 330. Fall quarter only.	1	2:00-2:50	M Th	Warren
Music History and Literature	330-2	Prereq.: 103. To be taken concurrently with 326. Fall quarter only.	1	2:00-2:50	Tu F	Kresteff

Title	Course No. & Hours	Remarks	Section No.		Time	Days	Room	Instructor
			Alton	E. St. Louis				
MUSIC (MUS) (Continued)								
Madrigal Singers	345-1	Prereq.: Audition.	1		3:00-3:50	MTu	FAB 100	Staff
Chamber Music—Strings	355-1	Prereq.: Audition.	1		4:00-4:50	Arranged	FAC 201	Staff
Chamber Music—Brass	365-1	Prereq.: Audition.	1		8:00-8:50	Tu	FAB 100	Fjerstad
Chamber Music—Woodwinds	365-1	Prereq.: Audition.	2		12:00-12:50	Tu	FAC 203	Kresteff
Sixteenth Century Counterpoint	441-2	Prereq.: 207. Fall quarter only.	E1		4:20-6:00	M	FAC 203	Kresteff
Teaching Techniques for the Intermediate Levels—Piano	461-2	Prereq.: Permission of instructor.	1		10:00-10:50	Tu	FAC 102	Boldt
String Development and Techniques	465-3	May be repeated for credit.	E1		5:30-8:10	Tu	FAB 100	Staff

The following courses in applied music are available for music majors and minors and for others under exceptional conditions. Consult the music adviser at Alton or East St. Louis. Each of these courses has only one section. Times to be arranged.

011-1 to 4	Private Violin	031-1 to 4	Private Percussion	472-2 to 8	Private Voice	474E-2 to 8	Private Saxophone
012-1 to 4	Private Viola	051-1 to 4	Private French Horn	473A-2 to 8	Private Violin	475A-2 to 8	Private Trumpet
013-1 to 4	Private Violoncello	052-1 to 4	Private Trumpet	473B-2 to 8	Private Viola	475B-2 to 8	Private French Horn
014-1 to 4	Private Double Bass	053-1 to 4	Private Trombone	473C-2 to 8	Private Violoncello	475C-2 to 8	Private Baritone
021-1 to 4	Private Flute	054-1 to 4	Private Tuba	473D-2 to 8	Private Double Bass	475D-2 to 8	Private Trombone
022-1 to 4	Private Oboe	055-1 to 4	Private Baritone	474A-2 to 8	Private Flute	475E-2 to 8	Private Tuba
023-1 to 4	Private Clarinet	061-1 to 4	Private Voice	474B-2 to 8	Private Oboe	476-2 to 8	Private Organ
024-1 to 4	Private Bassoon	071-1 to 4	Private Organ	474C-2 to 8	Private Clarinet		
025-1 to 4	Private Saxophone	471-2 to 8	Private Piano	474D-2 to 8	Private Bassoon		

PHILOSOPHY (PHIL)

Types of Philosophy: An Introduction	B200-4	Offered at Alton. See bus schedule on back cover.	1		1:00-2:50	M	Th	AUD 101	Staff
Greek and Early Christian Philosophy	B381-4	Prereq.: Junior standing or 4 hours of philosophy. Offered once annually and only at East St. Louis. See bus schedule on back cover.		51	1:00-2:50	Tu	F	104	Staff

PHYSICAL EDUCATION—MEN (PEM)

Methods and Materials of Teaching Swimming	117-1	Required for majors and minors in PEM.	1	11:00-12:50	M	W	Arranged	Staff
Teaching of Team Games I	151-1	For majors and minors only.	1	10:00-10:50	M	W	Gym	Staff
Required Physical Education (Fencing)	251-1	Student must provide equipment.	1	10:00-10:50	W	F	Gym	Marks
(Swimming)		For non-swimmers and beginners only. Pool rental charge \$6.00.	2	11:00-12:50	M	W	Arranged	Staff
(Swimming)		For non-swimmers and beginners only. Pool rental charge \$6.00.	3	12:00-1:50	M	W	Arranged	Staff
(Soccer)			4	1:00-1:50	M	Th	Gym	Staff
(Soccer)			5	10:00-10:50	Tu	Th	Gym	Staff
(Tennis)			6	9:00-9:50	Tu	Th	Courts	Staff
(Square Dance)			E7	6:20-8:10	W		Gym	Marks
(Folk Dance)			8	2:00-2:50	Tu	Th	Gym	Marks
(Swimming)		For non-swimmers and beginners only. Pool rental charge \$6.00.	51	10:00-11:50	M	W	Arranged	Staff
(Soccer)			52	1:00-1:50	M	W	Gym	Staff
(Golf)			53	1:00-1:50	Tu	Th	Gym	Staff
(Flag Football)			54	2:00-2:50	Tu	Th	Gym	Staff
(Square Dance)			55	2:00-2:50	W	F	Gym	Marks
Bowling	254-1	Bowling lane rental charge \$4.00. Meets university physical education requirements.	1	9:00-10:50	W		Arranged	Showers
		Prereq.: 152. For majors and minors only.	2	9:00-10:50	Tu	Th	Arranged	Showers
Basic Rhythms II	262-1		1	2:00-2:50	Tu	Th	Gym	Marks
Methods and Materials for Teaching Physical Education Activities in the Elementary School	350-4	For physical education majors and elementary education majors.	1	8:00-8:50	MTuW	F	Gym	Marks
Emergency Care and Prevention of Athletic Injuries	376-3	Prereq.: Physiology 300. For majors and minors only.	1	9:00-9:50	M	W	ANA 108	Staff
Football	384-3	For majors and minors only.	1	10:00-10:50	Tu	Th	ANA 110	Staff
				3:00-5:30	M	W	Arranged	Staff

Title	Course No. & Hours	Remarks	Section No.		Time	Days	Room	Instructor
PHYSICAL EDUCATION—WOMEN (PEW)								
Orientation	025-0	For physical education majors and minors only.	1	51	11:00-11:50 11:00-11:50	Tu Th	ANA 108 103	Marks Archangel
Soccer	101S-1		1	51	11:00-11:50 10:00-10:50 3:00-4:00 9:00-9:50	M W Tu Th Tu Th M W	Gym Gym Gym Gym	Marks Archangel Staff Staff
Fundamental Rhythms	107-1		1	51				
Beginning Swimming	204-1	Pool rental charge \$6.00.	1 2		11:00-12:50 12:00-1:50 3:00-4:50	M W M W Tu Th	Arranged Arranged Arranged	Archangel Archangel Archangel
Intermediate Swimming	205-1	Prereq.: 204 or equivalent. Pool rental charge \$6.00.	1	51	11:00-12:50 3:00-4:50 6:20-8:10	M W Tu Th W	Arranged Arranged Gym	Archangel Archangel Archangel
American Square Dance and Mixers	208-1		E1		2:00-2:50 9:00-9:50	W F Tu Th	Gym Gym	Marks Staff
Badminton	215-1	Meets until Nov. 23.	1	51	2:00-2:50	TuW F	Gym	Archangel
Tennis	216-1	Meets until Nov. 23.	1		1:00-1:50	TuW F	Gym	Marks
Field Hockey	223-1		1		2:00-2:50	M W F	Gym	Archangel
Folk Dance	230-1		1		2:00-2:50	Tu Th	Gym	Staff
Modern Dance	233-1		1		11:00-11:50	Tu Th	Gym	Staff
Bowling	254-1	Bowling lane rental charge \$4.00.	1	51	10:00-10:50	M W	Gym	Staff
Fencing	255-1	Student must provide equipment.	1	52	3:00-3:50	W F	Gym	Staff
			1	51	9:00-10:50 9:00-9:50 10:00-10:50	W Tu Th W F	Arranged Arranged Gym	Showers Showers Marks
Techniques of Teaching Team Sports I	321-2	For physical education majors and minors only.	1		9:00-10:50	M W	Gym	Archangel
Officiating Techniques I	323-1	Prereq.: Consent of instructor.	1		2:00-2:50	M W	ANA 110	Marks
Materials and Methods for Teaching Physical Education Activities in the Elementary School	350-4	For physical education and elementary education majors.	1		8:00-8:50	MTuW F	Gym	Marks

University Physics

Mechanics I

Atomic Ph

Electronics

Introduction

PHYSIOLOGY
Human Anatomy

PSYCHOLOGY (P)
Introductory Psychology

Title	Course No. & Hours	Remarks	Section No.		Time	Days	Room	Instructor
PSYCHOLOGY (PSYC) (Continued)								
Introductory Psychology	201-4		E2	51 ES52	8:20-10:10 11:00-11:50 8:20-10:10 11:00-12:50	Tu F MTuWTh W Saturday	ANA 104 113 113 113	Staff Dameron Troyer
Child Psychology	301-4	Prereq.: 201.	ES1		8:20-10:10 11:00-12:50 2:00-3:50	W Saturday M Th	AUD 101 AUD 101 202	Kuenzli Troyer
Child Psychology	B301-4	Prereq.: 201. Offered at East St. Louis. See bus schedule on back cover.		51				
Personality Dynamics	305-4	Prereq.: 201.	1		11:00-12:50 12:00-1:50	Tu F M Th	SCI 201 105	Kuenzli Dameron
Social Psychology	B307-4	Prereq.: 201. Offered at East St. Louis. See bus schedule on back cover.		51				
Experimental Psychology	311-4	Prereq.: 201.	E1		6:20-8:10 8:20-10:10	Tu F M Th	SS 105 103	Rockwell Southwood
Introduction to Industrial Psychology	320-4	Prereq.: 201		E51				
Mental Hygiene	432-4	Prereq.: 305 or consent of instructor. 4 additional sessions to be arranged.	E1	E51	5:30-8:10 5:30-8:10	W Tu	ANB 201 105	Rasmussen Johnson
Fundamentals of Counseling	437-3	Prereq.: 305 or consent of instructor.	E1		5:30-8:10	Tu	ANB 201	Banaghan
Independent Projects	490-1 to 8	Prereq.: consent of instructor.	1	51	Arranged Arranged	Arranged Arranged	Arranged Arranged	Kuenzli Dameron
SECRETARIAL SCIENCE (SEC SCI)								
Typewriting I	102-3		1 E2		9:00-9:50 8:20-10:10	MTuWTh Tu F	ANA 3 ANA 3	Frost Staff
				51 E52	9:00-9:50 8:20-10:10	MTu ThF M Th	223 223	Burkhead Burkhead
					9:00-9:50 8:20-10:10	MTuWTh Tu F	ANA 3 ANA 3	Frost Staff
Typewriting III	104-3	Prereq.: 103 or equivalent.	1 E2	51 E52	9:00-9:50 8:20-10:10	MTu ThF M Th	223 223 223	Burkhead Burkhead Burkhead

Shorthand I	105-4	1 E2	10:00-10:50 6:20-8:10 51 E52	MTuWTh Tu F MTuWTh M Th	ANA 3 ANA 3 223 223	Frost Staff Staff Burkhead
Typewriting IV Shorthand IV	213-3 216-4	E1 1 E2	Prereq.: 104 or equivalent. Prereq.: 107 or equivalent.	M Th MTuWTh M Th MTuWTh	ANA 3 ANA 3 ANA 3 223	Staff Frost Frost Staff
Calculating Machines	B313-4	1	Offered at Alton. See bus schedule on back cover.	M Th	ANA 3	Brady
Teaching Typewriting Teaching Shorthand and Transcription	403-3 404-3	E1 E51	Prereq.: 213 or equivalent. Prereq.: 308 or equivalent.	M Th M Th	223 ANB 101	Staff Brady
SOCIOLOGY (SOC)						
Introductory Sociology	101-5	1 E2		MTuWThF M Th	ANA 104 SCI 102	Remmling Staff
Social Problems	102-5	1		MTuWThF M Th MTuWThF MTuWThF	204 113 SS 200 224	Rudwick Staff Staff Taylor
Marriage and Parenthood	241-4		Prereq.: 101 or consent of instructor.	MTuWTh	224	Taylor
Social Control Sociological Research	306-4 B312-5	1	Prereq.: 101. Prereq.: 101. Laboratory work to be arranged. Of- fered at East St. Louis. See bus schedule on back cover.	MTuWTh M Th	SS 105 224	E. Schusky J. Schusky
Socialization of the Individual	B321-4		Prereq.: 101. Offered at East St. Louis. See bus schedule on back cover.	M Th	224	Thomas
Community Organization	333-4	E51	Prereq.: 101.	M Th	215	Seymour

Title	Course No. & Hours	Remarks	Section No.			Time	Days	Room	Instructor
SOCIOLOGY (SOC) (Continued)									
Urban Sociology	335-4	Prereq.: 101.	1			1:00-1:50	MTuWTh	SS 105	Staff Remmling Frankel
Sociology of Religion	351-4	Prereq.: 101.	1			12:00-12:50	MTuWTh	SS 105	
Criminology	372-4	Prereq.: 101. 4 additional sessions to be arranged.	E1			5:30-8:10	W	SS 105	
Introduction to Social Work	B380-4	Prereq.: 101. Offered at East St. Louis. See bus schedule on back cover.		51		10:00-11:50	M Th	202 a	Rudwick
Current Sociology	400-2	Prereq.: 8 hours of sociology.		51		1:00-2:50	W	201 b	Staff Staff
Integrated Sociology	407-4	Prereq.: 15 hours of sociology. 4 additional sessions to be arranged.		E51		5:30-8:10	W	103	
SPEECH (SPCH)									
Public Speaking	102-4	Prereq.: 101 or consent of instructor.	1			10:00-10:50	MTu ThF	ANB 102	Smith Staff Staff
Oral Interpretation	103-4	Prereq.: 101 or consent of instructor.		51		1:00-1:50	MTu ThF	204	
				51		9:00-9:50	MTu ThF	105	
Principles of Argumentation and Debate	205-3	Prereq.: 101.	1			2:00-2:50	M W F	ANB 102	Staff
Fundamentals of Broadcast Writing	257-4	Prereq.: 101.	1			9:00-9:50	MTuW F	ANB 202	Hawkins
Persuasion	301-4	Prereq.: Psychology 201 and 12 hours of speech or consent of instructor.	1			1:00-1:50	MTuW F	ANB 201	Staff
Business and Professional Speaking	303-4			E51		6:20-8:10	M Th	106	Staff
Speech Correction for the Classroom Teacher	428-4	Prereq.: 101. Recommended for education majors. 4 additional sessions to be arranged.	E1			5:30-8:10	Th	ANB 201	Staff

THEATER (THEA)

Staging Techniques

Acting

111-3	51	3:00-3:50	M W F	AUD	Staff
204-4	1	Prereq.: Speech 101 or consent of instructor.	Tu Th MTuW F	ANA 110 AUD	Kochman Birdman

ZOOLOGY (ZOO)

Principles of Animal Biology

100-5	1	One field trip.	M W F	SCI 201	Staff
	2		Tu Th	SCI 101	Staff
	3		M W F	SCI 201	Staff
	4		Tu Th	SCI 101	Staff
	E5		M W F	SCI 102	Staff
			Tu Th	SCI 101	Staff
			M W F	SCI 102	Staff
			Tu Th	SCI 101	Staff
			M W F	SCI 100	Staff
			Tu Th	SCI 101	Staff
	51		M W F	215	Staff
			Tu Th	116	Staff
	52		M W F	215	Staff
			Tu Th	116	Staff
	E53		Tu F	116	Staff
			Tu F	116	Staff
202-5	1	Prereq.: 103.	Tu Th	SCI 201	Staff
			M W F	SCI 101	Staff
321-5	1	Prereq.: One year of biology.	Tu Th	SCI 100	Staff
382A-1½	1	Prereq.: One year of zoology. Required each quarter of seniors majoring in zoology.	M W F Tu	SCI 100 SCI 100	Staff
401-5	1	Prereq.: 12 hours of biology.	Tu Th	SCI 100	Staff
461-4	1	Prereq.: 103. Several field trips.	M W F Tu Th M W	SCI 100 SCI 100 SCI 101	Staff Staff Staff

Genetics

Mammalogy



Quarter _____ Year _____

of advisement.

Journal of Management Inquiry 26(1) 3-16 | DOI: 10.1177/1056492616676101 | © The Author(s) 2016

(Record Number)

(Phone Number)

MINORS

1000 JOURNAL OF CLIMATE

Number of hours student works

[illegible]



Quarter _____ Year _____

[illegible]

(Phone Number)

MINORS

Day () Evening () Number of hours student works

[illegible]



Quarter _____ Year _____

The student will prepare a program on this form to be presented to his academic adviser at the time of advisement.

(Record Number)

(Phone Number)

MINORS

CLASS _____ Day () Evening () Number of hours student works _____

[illegible]

Quarter _____ Year _____

academic adviser at the time of advisement.

STUDENT	(Last)	(First)	(Middle)	(Record Number)
---------	--------	---------	----------	-----------------

ADDRESS

(Number and Street)

(City and State)

(Phone Number)

MAJOR _____ MINORS _____

CLASS _____ Day () Evening () Number of hours student works _____

[illegible]



Year _____

of advisement.

(Record Number)

(Last)

(Record Number)

(Phone Number)

(Phone Number)

MINORS

[illegible]



Southern Illinois University Foundation

The Southern Illinois University Foundation is a nonprofit corporation chartered by the state and authorized by the Board of Trustees to receive gifts for the benefit of the University, to buy and sell property, and otherwise to serve the University.

It respectfully asks alumni and other citizens of Southern Illinois to consider making gifts and bequests to benefit the University. Such gifts should be conveyed to the Foundation, with proper stipulation as to their uses. The Foundation, through its officers and members, will be glad to confer with intending donors regarding suitable clauses to insert in wills and suitable forms of gifts and memorials, including bequests by means of life insurance. Large or small gifts to the library will be appreciated; likewise, gifts for special equipment, buildings, endowment of professorships in particular subjects, gifts to student loan funds and scholarship funds, gifts for the use of foreign students, and endowments for particular sorts of research. Any gifts or bequests can be given suitable memorial names.

The staff members of the Foundation are

Mr. Kenneth R. Miller, *Executive Director*, Carbondale, Illinois

Mrs. Lois H. Nelson, *Secretary*, Carbondale, Illinois

Mr. Robert L. Gallegly, *Treasurer*, Carbondale, Illinois

Mr. C. Eugene Peebles, *Assistant Treasurer*, Edwardsville, Illinois

Mr. C. Richard Gruny, *Legal Counsel*, Carbondale, Illinois

Mr. L. James Struif, *Assistant Legal Counsel*, Edwardsville, Illinois

Mr. Donald Leavitt, *Patent Counsel*, St. Louis, Missouri

Mr. Warren Stookey, *Field Representative*, Edwardsville, Illinois.

BUS SCHEDULE

DEPART
EAST ST. LOUIS
8:00 A.M.
10:00 A.M.
12:00 M.
2:00 P.M.
4:00 P.M.

ARRIVE
ALTON
8:50 A.M.
10:50 A.M.
12:50 P.M.
2:50 P.M.
4:50 P.M.

DEPART
ALTON
9:00 A.M.
11:00 A.M.
1:00 P.M.
3:00 P.M.

ARRIVE
EAST ST. LOUIS
9:50 A.M.
11:50 A.M.
1:50 P.M.
3:50 P.M.