

# BARTONVILLE COMMUNITY CENTER

AUTHOR: KELSEY KAUFFMAN

FACTUALITY ADVISOR: CHAD SCHWARTZ



INDOOR COMMON AREA



INTERACTIVE WALKWAY

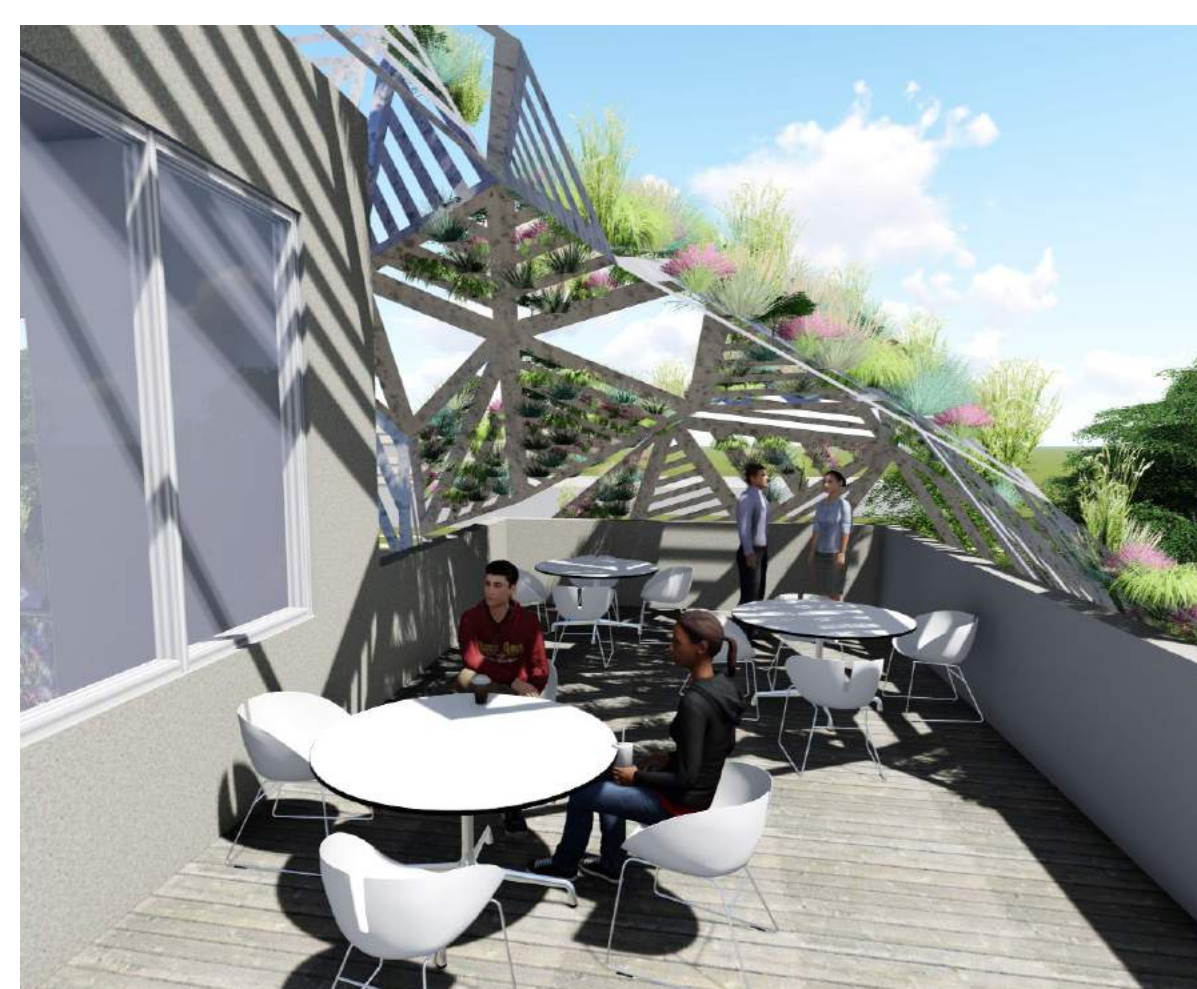

INTERACTIVE BALCONY

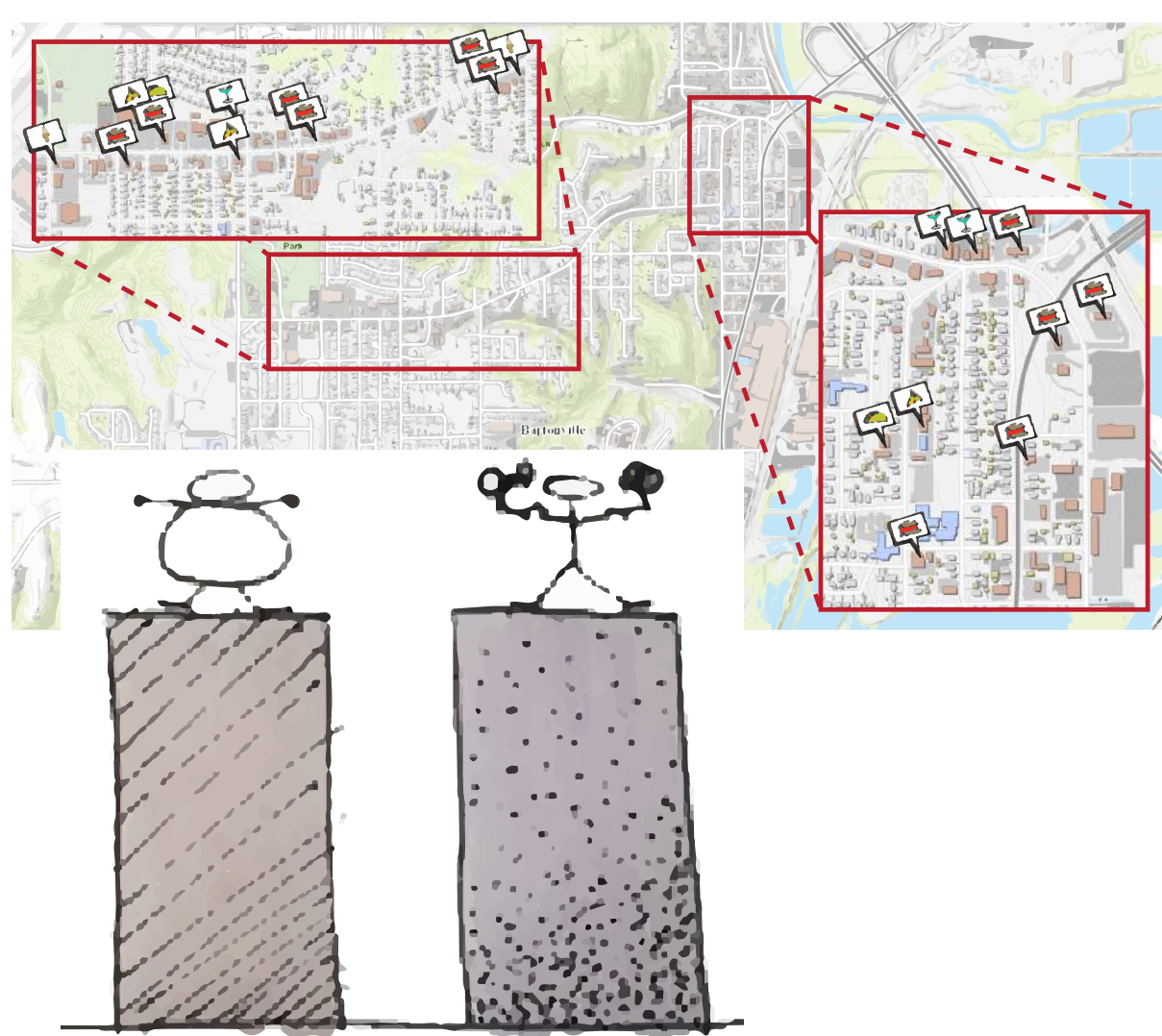

## HEALTH

In Bartonville, 38% of the residents are overweight obese, but there are equally as many people doing moderate and intense workout activities.<sup>1</sup> The study was inconclusive in knowing if there was any overlap in participants who were overweight and also worked out, but regardless when "reaching a healthy weight, what you eat is much more important [than working out]."<sup>2</sup>

When it comes to healthy food choices in Bartonville, there are 21 fast food restaurants and bars in town, but only one place to purchase healthy food: Kroger. Bartonville may be able to combat the understanding of a healthy lifestyle by incorporating a community garden. "Community gardens may offer physical and mental health benefits by providing opportunities to: Eat healthy fresh fruits and vegetables, engage in physical activity, skill building, and creating green space, beautify vacant lots, revitalize communities in industrial areas, revive and beautify public parks, decrease violence in some neighborhoods, and improve social well-being through strengthening social connections."<sup>3</sup>

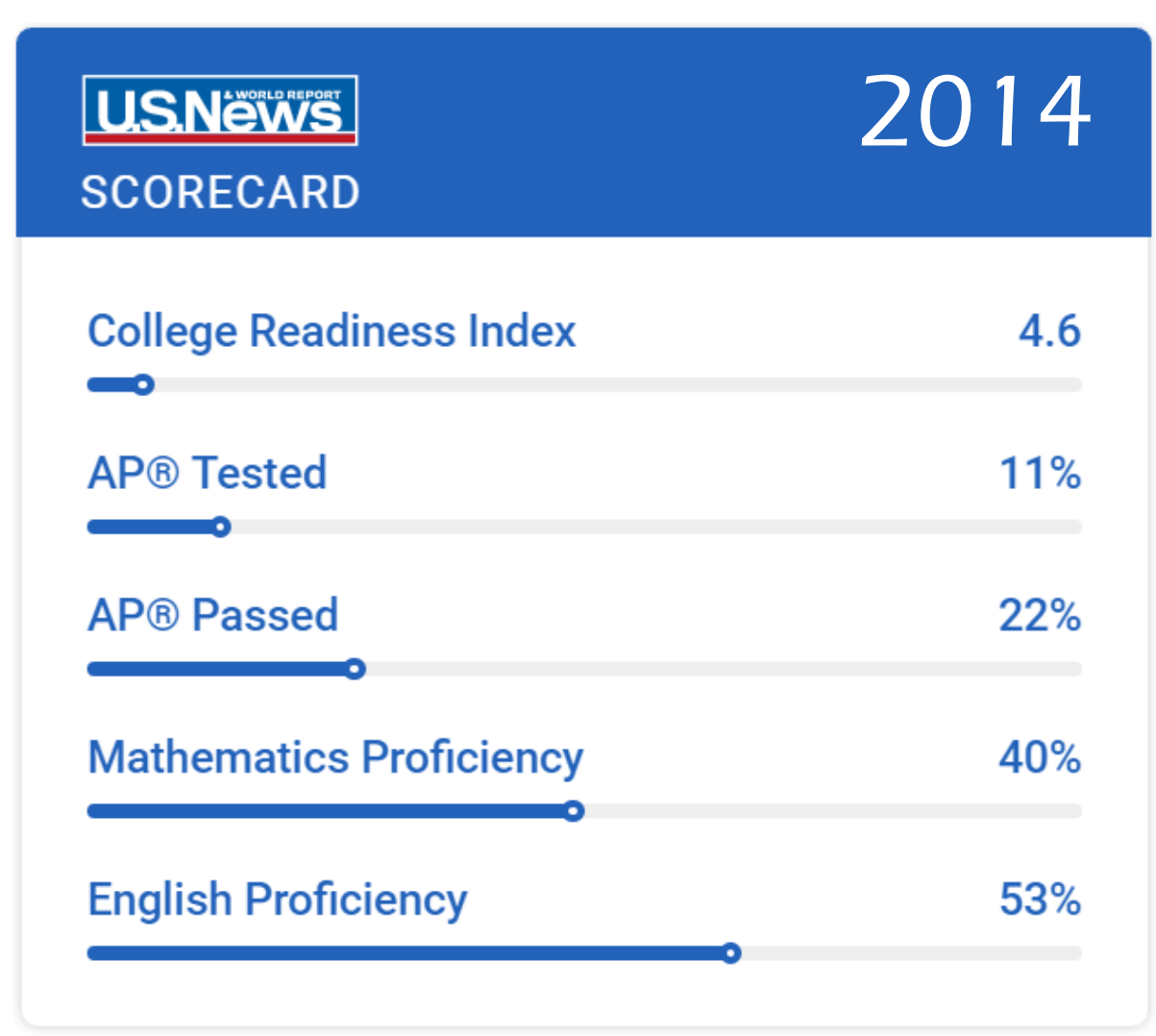

## ADVANCEMENT

One in ten people in Bartonville are below the growing poverty line and the poverty levels in Bartonville schools are doubling.<sup>4</sup> With the amount of students in school under the poverty level increasing, the test scores are decreasing. In 2010 at Limestone Community High School, 51% of the students that attended Limestone met or exceeded in Reading and Mathematics on their PSAT test, but in 2011 only 47% of students met or exceeded and in 2012 only 44% of students met or exceeded.<sup>5</sup> In a three-year timeframe, students of Limestone Community High School dropped seven percentage points on their scores. As noted in the U.S. News Educational Scorecard, Limestone Community High School students ranked 4.6 out of 100 points on the college readiness index and in Bartonville only twelve percent of residents twenty-five years old and over have obtained a bachelor's degree and only four percent have obtained a graduate or professional degree.<sup>6</sup>

The students of Bartonville are in need of educational empowerment and career guidance. One way that students could receive educational empowerment is through afterschool tutoring. In a controlled study on the effects of afterschool tutoring on students, students who received tutoring in math and reading substantially outperformed their initial test results and students who did not receive tutoring at all.<sup>7</sup>



## PRESERVATION

With the turn of the 21st century, many of the original historic buildings in Bartonville of the Peoria State Hospital have been demolished. Currently, 1 of the 13 remaining buildings on the grounds of the Old Peoria State Hospital, the Bowen Building as noted in the figures, is scheduled to be razed.<sup>8</sup>

"Preservation is often the catalyst for community change. People who being that they have no interest in planning and zoning issues react emotionally to the threatened demolition of a childhood landmark."<sup>9</sup> With 90% of Bartonville's residents being born in the Peoria area, it would be nostalgic for the community to encompass parts of its history.<sup>10</sup> One way residents of Bartonville can find value in a new community center would be to use the original stones from the Bowen Building to tie the heritage of the community into a new building.

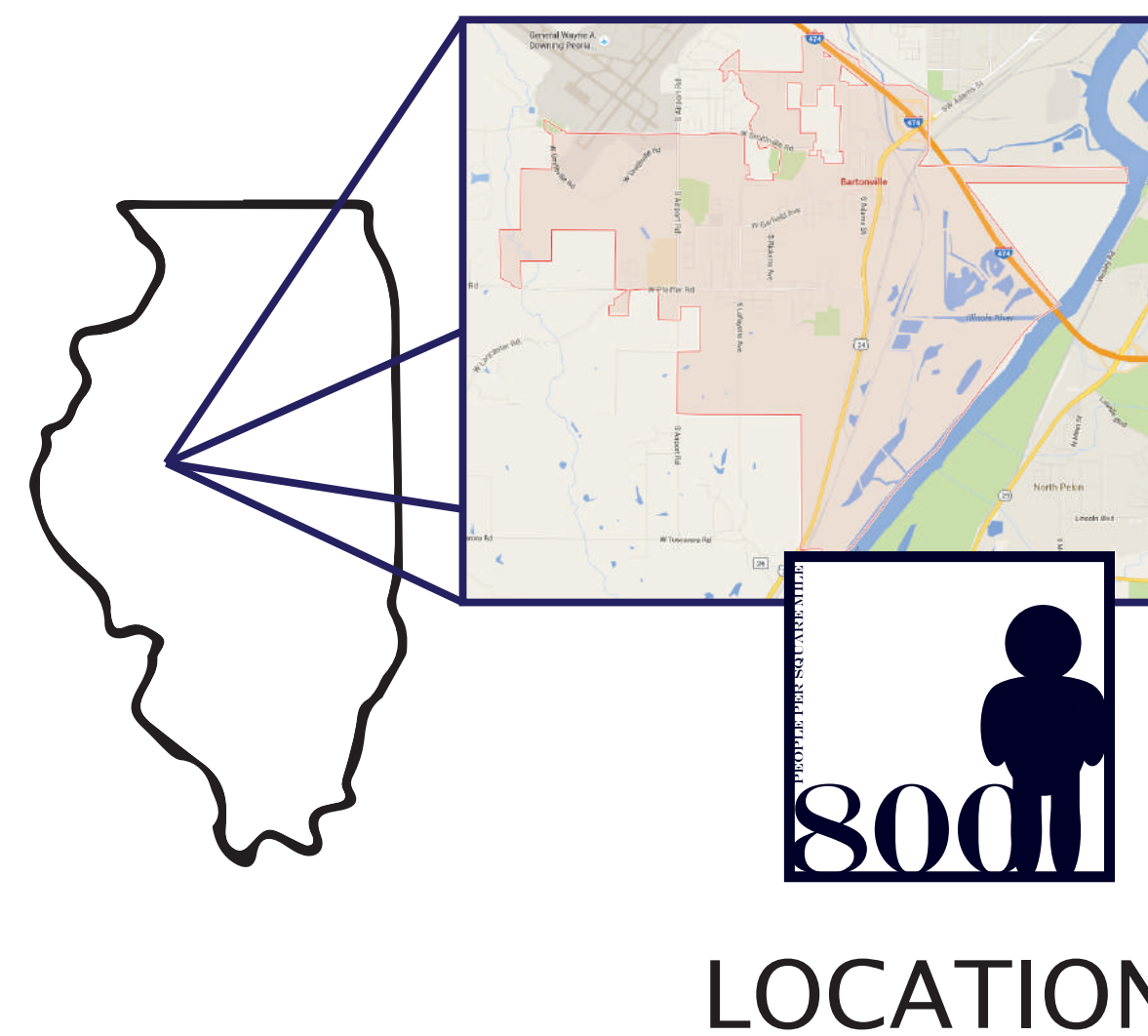

LOCATION

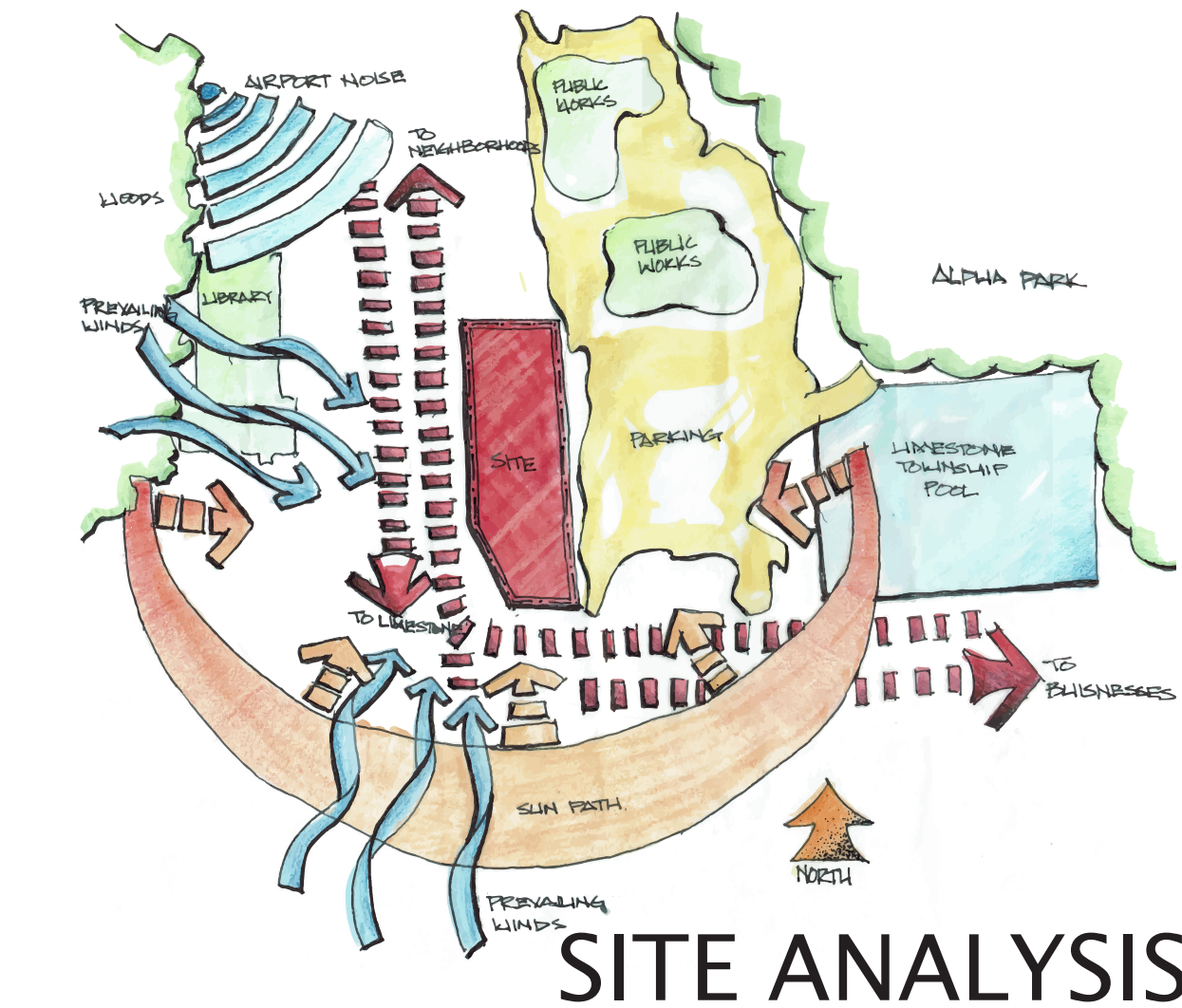

SITE ANALYSIS

One in four residents of Bartonville, Illinois are depressed; one in two students are testing below average; and one in ten individuals are below the poverty line.<sup>11</sup> These statistics are affecting residents in multiple ways including physiologically, physically, and educationally. While working to solve the underlying multiplicity of issues, Bartonville will need to focus on being HAPPY.<sup>12</sup> that is the residents will need to actively engage in health, advancement, purpose, preservation, and youth. The core concepts of HAPPY are for the betterment of the community and could be expressed architecturally in the form of a community center. Residents of Bartonville face a multiplicity of issues on a daily basis that could be solved through community-based programs at a community center. In a study conducted on the Effectiveness of Community Engagement, mental health and physical activity improved for participants when they were involved in community-based psychiatric programs.<sup>13</sup> These programs could help with the number of depressed residents. Educationally at-risk youth who participated in community-based programs would have the opportunity to advance their self-esteem and career prospects. It would also give the youth in the village an afterschool and summer engagement so they remain active in advancing themselves in a positive way. Programs focused on the youth could help at-risk students pass their tests and raise their test scores.

With the implementation of a community center, Bartonville residents will more easily be able to focus on being HAPPY. The proposal of community garden space could bring village members collaboratively together to work towards HAPPY with multiple people working together to grow food and engage in a healthier lifestyle. The community center would also be able to focus on the youth while preserving the heritage many longtime residents identify strongly with. "Another benefit that comes from preserving cultural heritage is communal support. Those that identify strongly with a certain heritage are often more likely to help out others in that same community."<sup>14</sup> With the concept of HAPPY, community members engaging in assisting one another, and the implementation of a community center, the residents of Bartonville will have the opportunity to thrive for years to come.

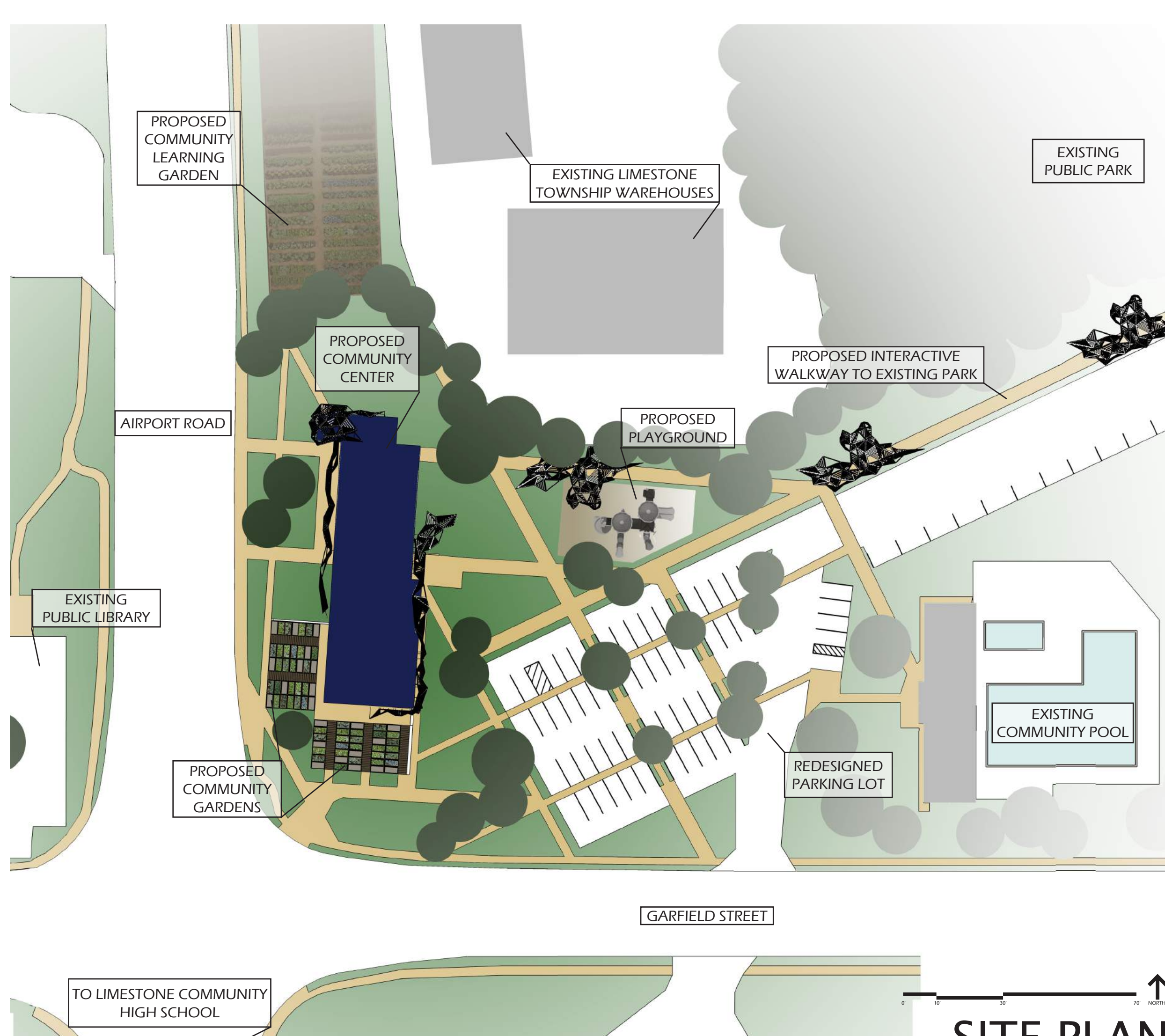

SITE PLAN

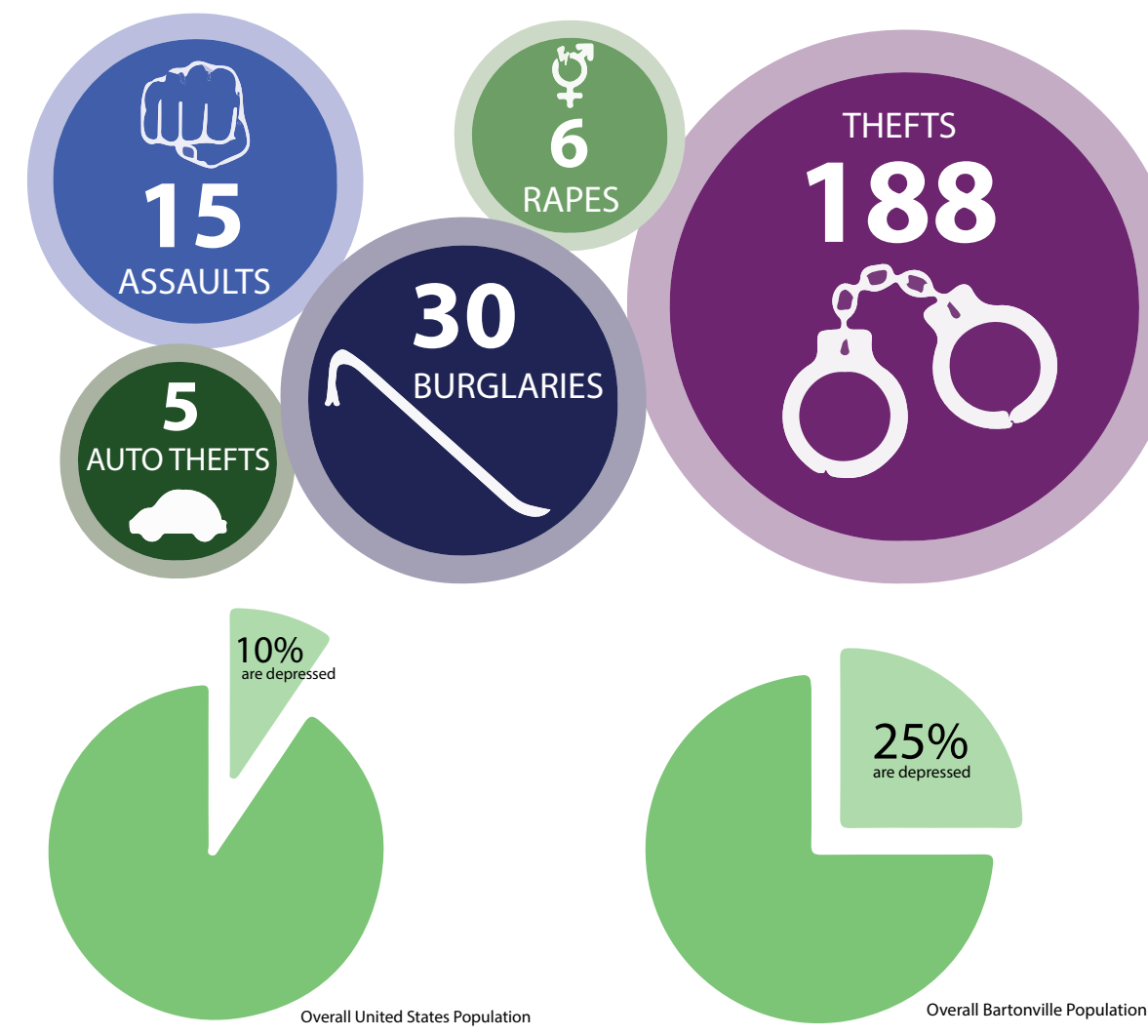

Two teens indicted on residential burglary charges  
 Former Limestone youth baseball coach accused of sexual abuse  
 Bartonville man sentenced to 10 years in prison for Hanna City robbery  
 Teenager could face 8 years in Bartonville break-ins conviction  
 Limestone basketball player arrested on felony drug charges

## PURPOSE

As noted above, depression effects one in ten adults in the United States however, in Bartonville depression effects over double the national average with one in four adults falling victim to depression.<sup>15</sup>

The key findings in a 2010-2011 study on the Effectiveness of Community Engagement and Planning for Services to Address Depression found, "Incorporating community programs...can help improve people's quality of life and lower the risk of a life crisis."<sup>16</sup>

With the findings of the study on the Effectiveness of Community Engagement, Bartonville could serve as a catalyst to improve depression in the form of a community center. The community center could serve as one common location for residents to attend much needed services. The services provided could in turn strengthen the mental and physical health of Bartonville residents, open advancement opportunities, and give residents a sense of purpose in their lives.

## YOUTH

Since there is not much for the youth to do, some of the youth find themselves surrounded by bad influences. Some entertain themselves in positive ways with a job, dirt biking, or riding horses, and others find themselves in bad company and entertain themselves with drugs, alcohol, and theft. Around 70% of people in Bartonville have tried marijuana in their lifetime and theft has increased throughout the past ten years.<sup>17</sup>

Some of this could relate back to the lack of programs that Bartonville has to offer, but there are no hard statistics or studies that have been conducted in Bartonville on the age of the offenders. The only evidence to corroborate the bad influences that the youth have pressured on them are headlines from the local paper or news stations. An example of the headlines are noted above.<sup>18</sup>

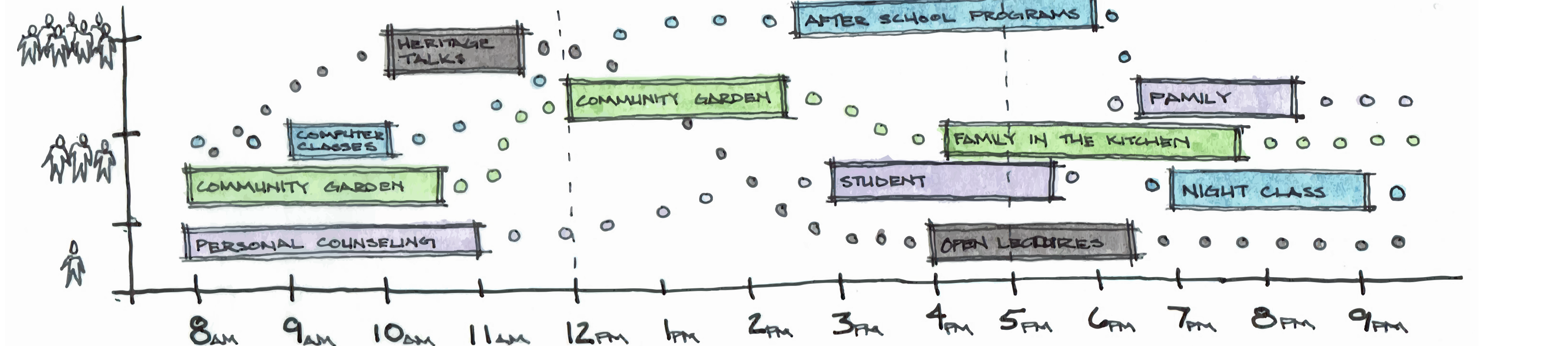

DAILY ACTIVITIES

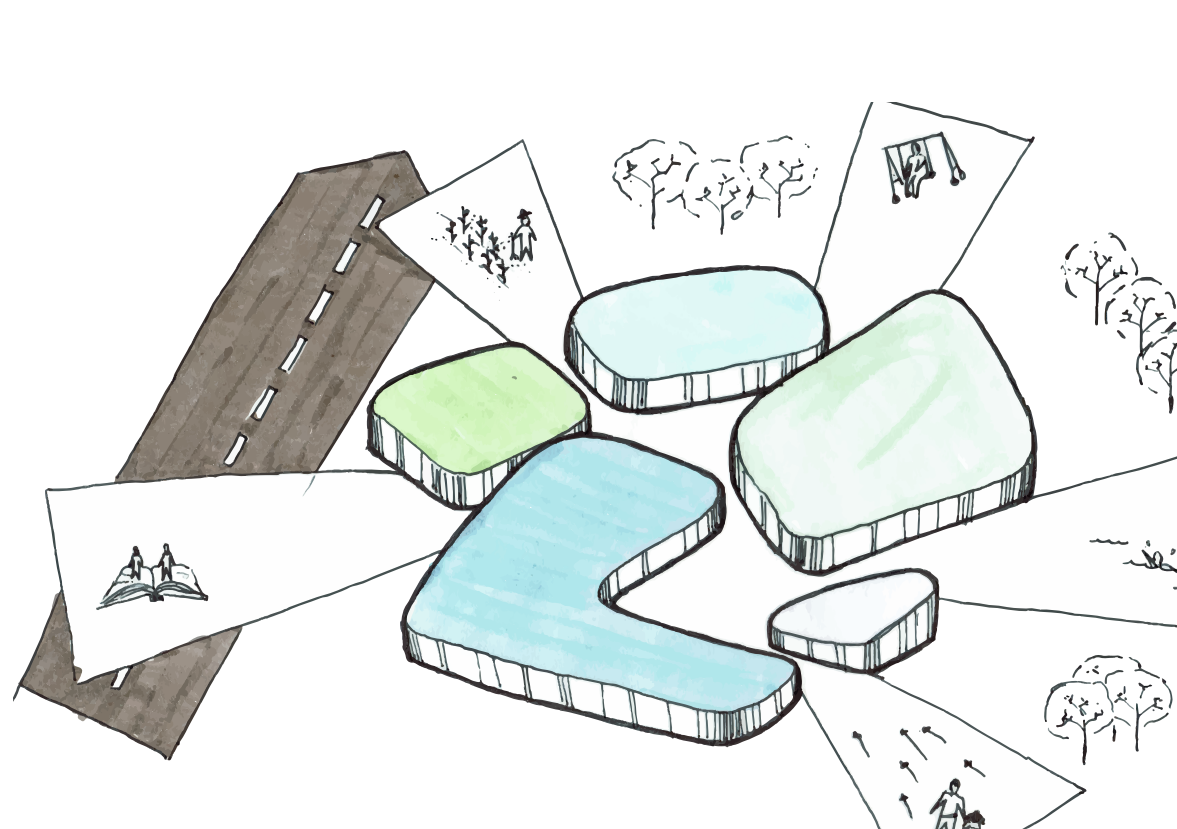

SURROUNDING CONTEXT

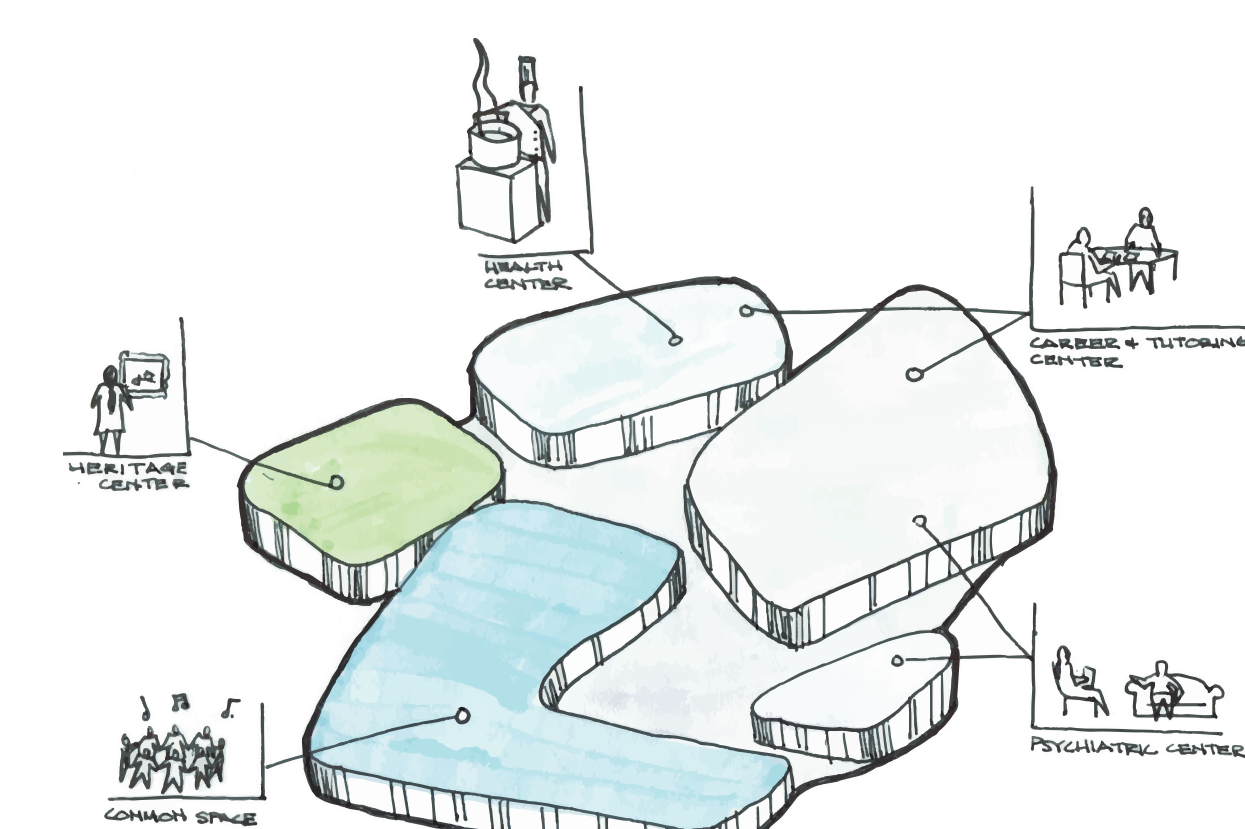

PROPOSED CENTERS

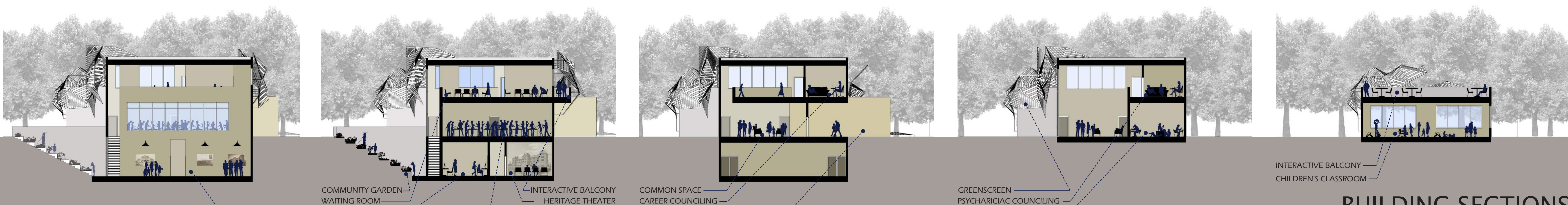

BUILDING SECTIONS

PROPOSED INTERVENTION TOPICS OF CONSIDERATION

<sup>1</sup> Bartonville, Illinois. (n.d.). Retrieved June 28, 2016, from <http://www.fdu.edu/~city/Bartonville/060816.html>  
<sup>2</sup> Crotwell, A. J. (2014, June 16). Limestone High School's new fitness center is a boon for students. Retrieved July 28, 2016, from <http://www.fox17.com/story/25155910/16/Limestone-high-schools-new-fitness-center-is-a-boon-for-students>  
<sup>3</sup> Community Gardens. (2016, June 03). Retrieved June 28, 2016, from <http://www.communitygardens.org/health-benefits-of-community-gardens/>  
<sup>4</sup> Bartonville, Illinois. (n.d.). Retrieved June 28, 2016, from <http://www.fdu.edu/~city/Bartonville/060816.html>  
<sup>5</sup> Bartonville, Illinois. (n.d.). Retrieved June 28, 2016, from <http://www.fdu.edu/~city/Bartonville/060816.html>  
<sup>6</sup> U.S. News & World Report. (2014). Limestone Community High School. Retrieved July 28, 2016, from <http://www.usnews.com/education/best-colleges/limestone-community-high-school-11333>  
<sup>7</sup> Bartonville, Illinois. (n.d.). Retrieved June 28, 2016, from <http://www.fdu.edu/~city/Bartonville/060816.html>  
<sup>8</sup> Bartonville, Illinois. (n.d.). Retrieved June 28, 2016, from <http://www.fdu.edu/~city/Bartonville/060816.html>  
<sup>9</sup> Bartonville, Illinois. (n.d.). Retrieved June 28, 2016, from <http://www.fdu.edu/~city/Bartonville/060816.html>  
<sup>10</sup> Bartonville, Illinois. (n.d.). Retrieved June 28, 2016, from <http://www.fdu.edu/~city/Bartonville/060816.html>  
<sup>11</sup> Bartonville, Illinois. (n.d.). Retrieved June 28, 2016, from <http://www.fdu.edu/~city/Bartonville/060816.html>  
<sup>12</sup> Bartonville, Illinois. (n.d.). Retrieved June 28, 2016, from <http://www.fdu.edu/~city/Bartonville/060816.html>  
<sup>13</sup> Bartonville, Illinois. (n.d.). Retrieved June 28, 2016, from <http://www.fdu.edu/~city/Bartonville/060816.html>  
<sup>14</sup> Bartonville, Illinois. (n.d.). Retrieved June 28, 2016, from <http://www.fdu.edu/~city/Bartonville/060816.html>  
<sup>15</sup> Bartonville, Illinois. (n.d.). Retrieved June 28, 2016, from <http://www.fdu.edu/~city/Bartonville/060816.html>  
<sup>16</sup> Bartonville, Illinois. (n.d.). Retrieved June 28, 2016, from <http://www.fdu.edu/~city/Bartonville/060816.html>  
<sup>17</sup> Bartonville, Illinois. (n.d.). Retrieved June 28, 2016, from <http://www.fdu.edu/~city/Bartonville/060816.html>  
<sup>18</sup> Bartonville, Illinois. (n.d.). Retrieved June 28, 2016, from <http://www.fdu.edu/~city/Bartonville/060816.html>